

J:\PROJECTS\2019\1901010483_COW_10TH-15TH BRIDGES_190483_CAD\SHOTS\05 CIVIL\PAV\19483-05-5000.DWG
 PLOTTED: Wednesday, October 13, 2021 @ 03:29PM

PLANS FOR 10TH STREET - 15TH STREET BRIDGES

CITY OF WICHITA
SEDGWICK COUNTY, KANSAS

GARY L. JANZEN, P.E. - CITY ENGINEER

CITY OF WICHITA PAVING PROJECT NO. 472-2021-085711
 ORG CODE 40250721
 MUNIS NUMBER E1029

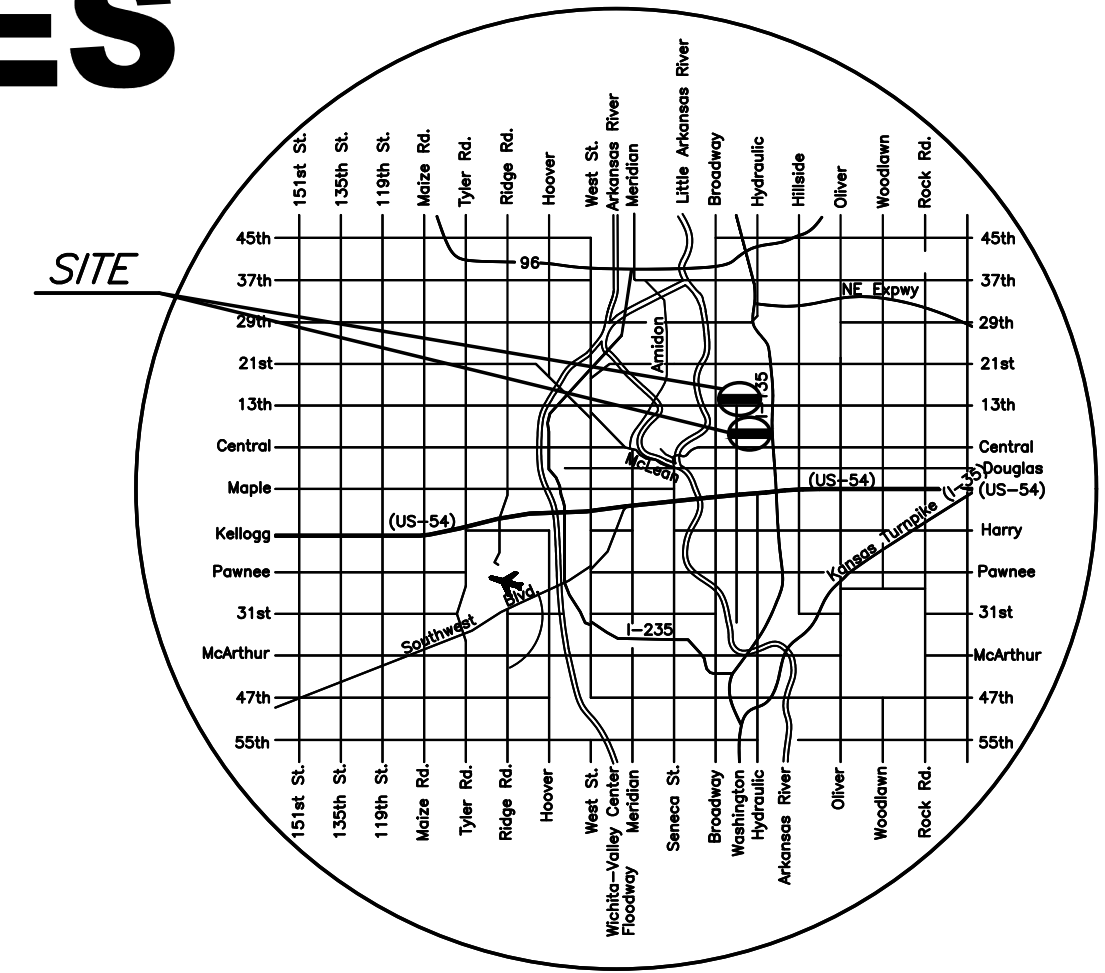

LOCATION MAP

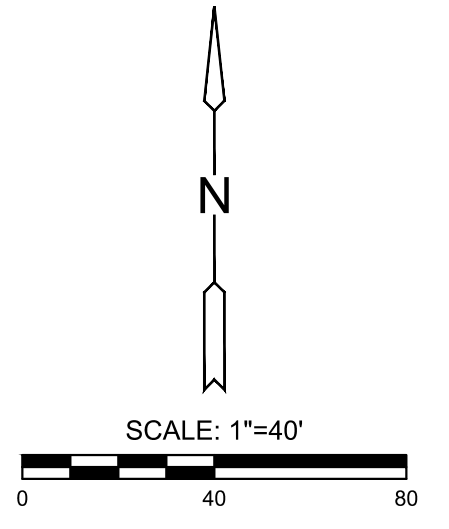
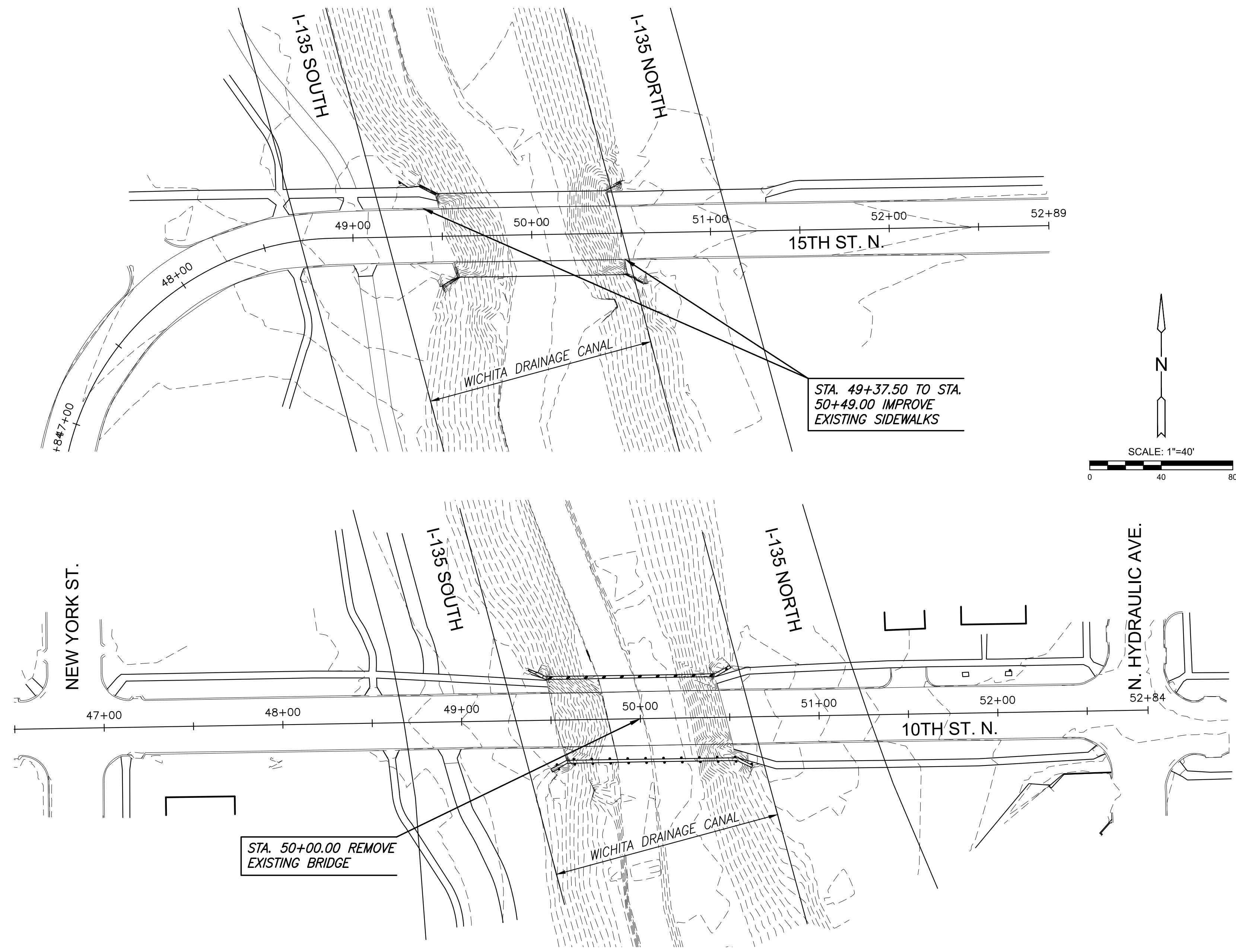

INDEX TO DRAWINGS

SHEET NO.	DESCRIPTION
1	TITLE SHEET
2	GENERAL NOTES & SUMMARY OF QUANTITIES
3	10TH ST PLAN
4	BRIDGE DEMO PLAN & ELEVATION - 10TH ST
5	CHANNEL RESTORATION PLAN - 10TH ST
6	15TH ST PLAN
7	15TH ST STRUCTURAL DETAILS
8-10	PAVING DETAILS
11	SITE RESTORATION & EROSION CONTROL PLAN - 10TH & 15TH ST
12-17	EROSION CONTROL DETAILS
18	SIGNING DETAILS
19	TRAFFIC CONTROL PLAN - 10TH & 15TH ST
20-23	TRAFFIC CONTROL DETAILS
24-27	CROSS SECTIONS



PLANS FOR
10TH STREET - 15TH STREET BRIDGES
 WICHITA, KS

©2021
 MKEC Engineering
 All Rights Reserved
 www.mkec.com
 These drawings and their contents, including, but not limited to, all concepts, designs, & ideas are the exclusive property of MKEC Engineering (MKEC), and may not be used or reproduced in any way without the express consent of MKEC.

TITLE SHEET

PROJECT NO.	1901010483	
DATE	JUNE 2021	
SCALE	1"=40'	
DESIGNED	DRAWN	CHECKED
JRA	RAM	JRA

NO.	REVISION	DATE

SHEET NO.
 1 OF 27

