

J:\PROJECTS\2019\1001010483\_COW\_10TH-15TH BRIDGES\_190483\_CAD\SHS\505 CIVIL\EROSION\19483\_05\_5450.DWG  
 PLOTTED: Wednesday, October 13, 2021 @ 03:50PM

**EROSION CONTROL NOTES**

This project will not disturb more than 0.7 acres area within construction limits.

Refer to City of Wichita standards for bmp installation, inspection and maintenance details and specifications.

Cost for each erosion and sediment control item shall include maintenance, inspection and eventual removal. Besides keeping each device in working order, maintenance shall include, at a minimum, sediment removal before 50% of the device's capacity is reached.

Contractor shall adjust erosion and sediment control plans to conform to actual construction operations. All changes to plan shall be approved by the city.

Stabilized entrances shall be provided as directed by the city. 2 total entrances are anticipated on the project. Locations shown on the plan are approximate.

Stockpiling of excavated material on the project site is generally prohibited. Small and interim stock piles not immediately hauled off-site should be enclosed and protected with biodegradable log around the entire circumference of the stock pile. Installing and maintaining this barrier shall be considered *subsidiary* to the bid item "BMP, Biodegradable Log". The bid quantities do not account for barrier for this purpose.

Erosion control devices will need to be installed as applicable for the appropriate construction phase. Contractor shall adjust erosion and sediment control plan to conform to actual construction operations. Once installed, the devices shall remain in-place and continue to be maintained until no longer necessary as determined by the city.

All areas disturbed by construction that are adjacent to developed properties shall be restored with sod to match existing turf type. Restoration of disturbed areas shall include but not be limited to, top soil preparation and sodding. All sodding work shall be in accordance with city standard specifications and the city administrative regulation no. AR6.5, which governs cleanup and restoration or replacement following construction. The "Recapitulation of Quantities" shows the estimated square yards of sodding, with a bid item for the same. When the weather/season prevents the installation of sod, the contractor shall be responsible for installing erosion control blanket (curlex 1, or approved equal) at the back of curb (8" wide minimum). All cost for erosion mat installation shall be *subsidiary* to "Sodding".

For Information Only

SITE RESTORATION SUMMARY		
ITEMS	QUANTITY	UNIT
SEEDING	1,650	S.Y.
SODDING, BUFFALO	1,038	S.Y.
TURF REINFORCEMENT MAT	1,650	S.Y.

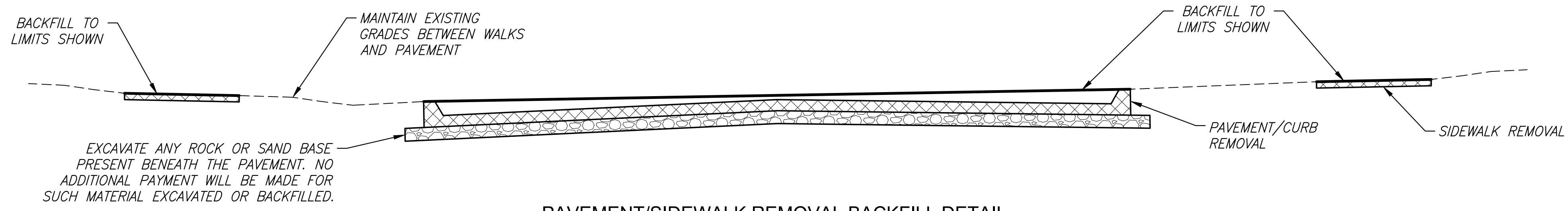

NOTE:  
 BACKFILL AREAS WITH REMOVED PAVEMENT OR SIDEWALK WITH SUITABLE SOIL AND GRADE TO DRAIN. THE TOP 6" OF BACKFILL SHALL BE SELECT SOIL (TOPSOIL) CAPABLE OF SUPPORTING VEGETATION PER THE CITY SPEC. SOIL MATERIAL FROM CHANNEL EXCAVATION MAY BE USED TO BACKFILL PAVEMENT PAVEMENT/SIDEWALK REMOVAL AREAS IF APPROVED BY THE ENGINEER.

**SEED MIX NOTES**

Designated areas shall receive a detention pond seed mix and fertilizer as follows:

SMOOTH BROME	75LB/ACRE PLS
K-31 FESCUE	300LB/ACRE PLS
ANNUAL RYE	100LB/ACRE PLS
FERTILIZER (10-20-10)	350LB/ACRE

**PAVEMENT/SIDEWALK REMOVAL BACKFILL DETAIL**

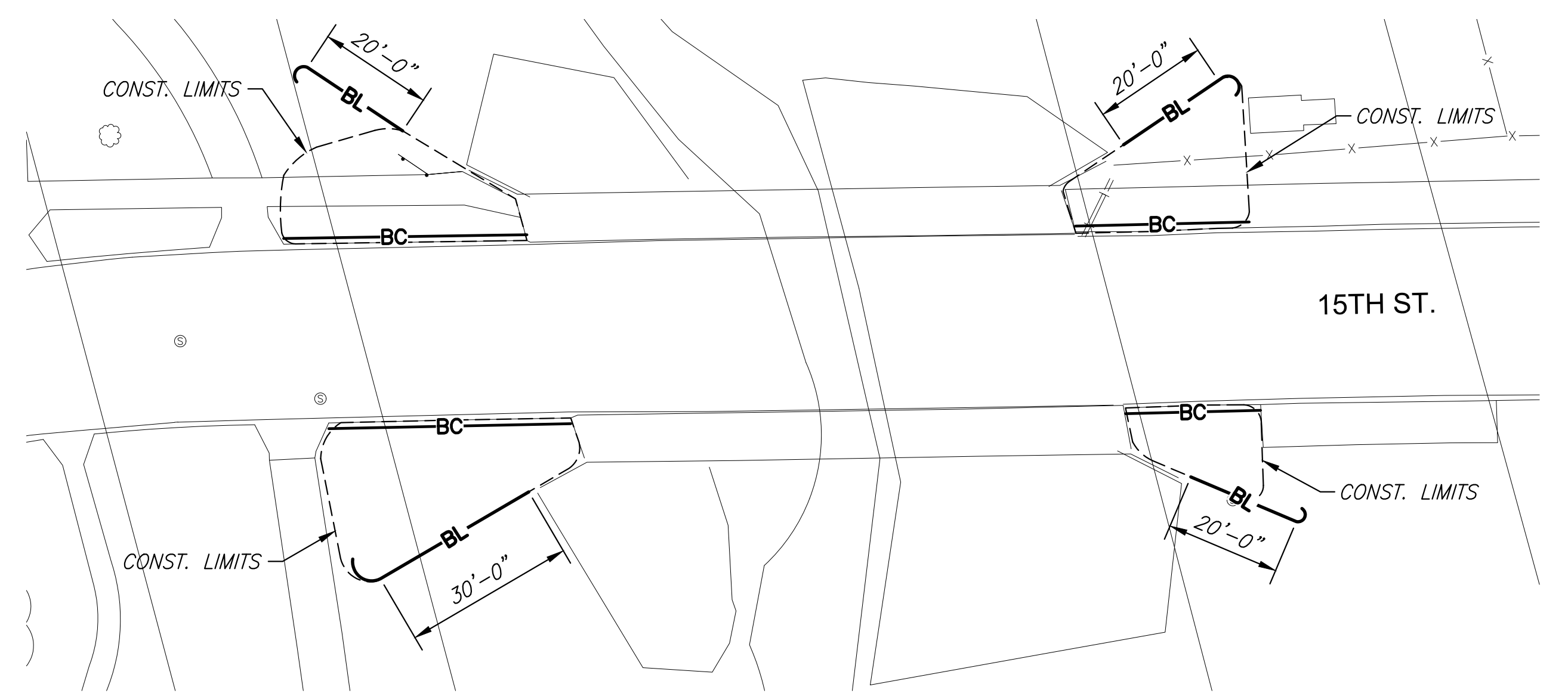

**PLAN**

NOTE:  
 SOD NON-PAVED AREAS WITHIN THE CONSTRUCTION LIMITS (EXCEPT WITHIN THE CHANNEL) IF DISTURBED. QUANTITY SHOWN ASSUMES SEEDING WILL OCCUR IN ALL NON-PAVED AREAS WITHIN THE CONSTRUCTION LIMITS. SEEDING OR SODDING WILL NOT BE REQUIRED UNDER THE ELEVATED HIGHWAY.

NOTE:  
 SEE SHEET 5 FOR SITE RESTORATION WITHIN THE CHANNEL.

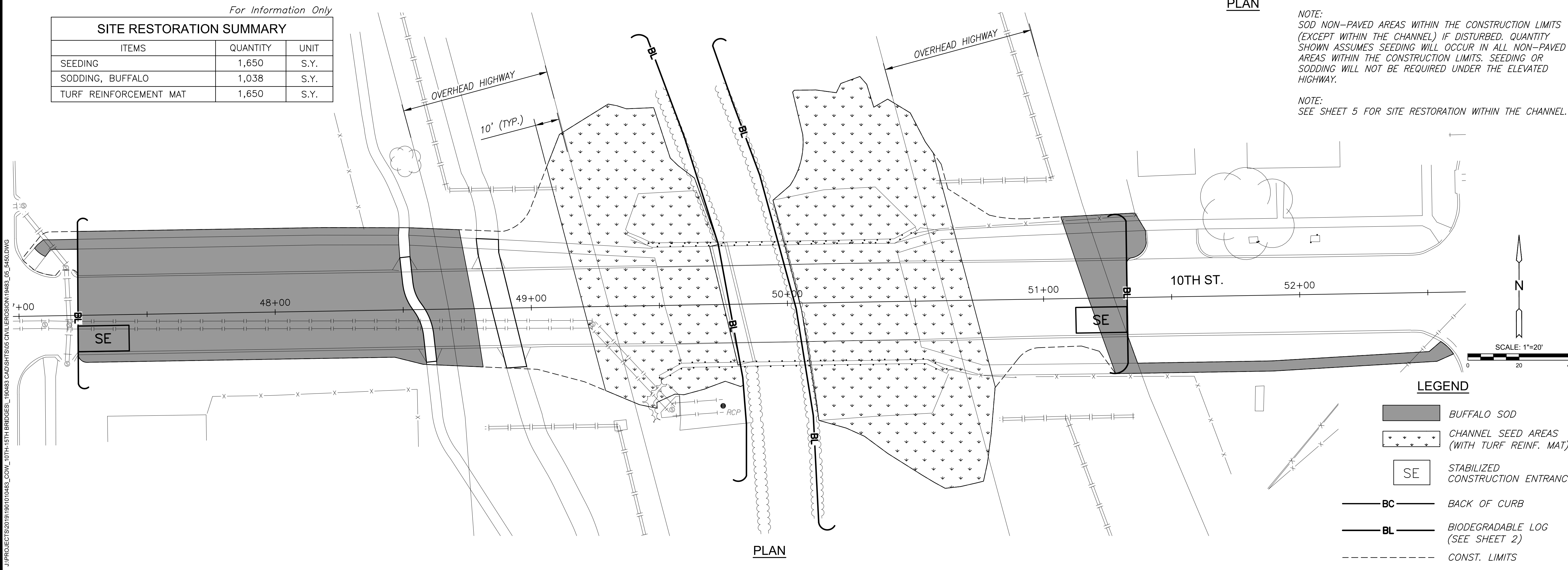

**LEGEND**

- BUFFALO SOD
- CHANNEL SEED AREAS (WITH TURF REINF. MAT)
- SE STABILIZED CONSTRUCTION ENTRANCE
- BC BACK OF CURB
- BL BIODEGRADABLE LOG (SEE SHEET 2)
- CONST. LIMITS



**PLANS FOR**  
**10TH STREET - 15TH STREET BRIDGES**  
**WICHITA, KS**

©2021 MKEC Engineering All Rights Reserved  
 www.mkec.com  
 These drawings and their contents, including, but not limited to, all concepts, designs, & ideas are the exclusive property of MKEC Engineering (MKEC), and may not be used or reproduced in any way without the express consent of MKEC.

**SITE RESTORATION & EROSION CONTROL PLAN - 10TH & 15TH ST**

PROJECT NO.	1901010483	
DATE	JUNE 2021	
SCALE	1"=20'	
DESIGNED	DRAWN	CHECKED
JRA	RAM	JRA
NO.	REVISION	DATE
SHEET NO.		
11 OF 27		