

PLOTTED: Wednesday, October 13, 2021 @ 03:15PM

J:\PROJECTS\2019\1901010483_COW_10TH-15TH BRIDGES_190483_CAD\SHOTS\005 CIVIL\TRAFFIC\19483_05_3750.DWG

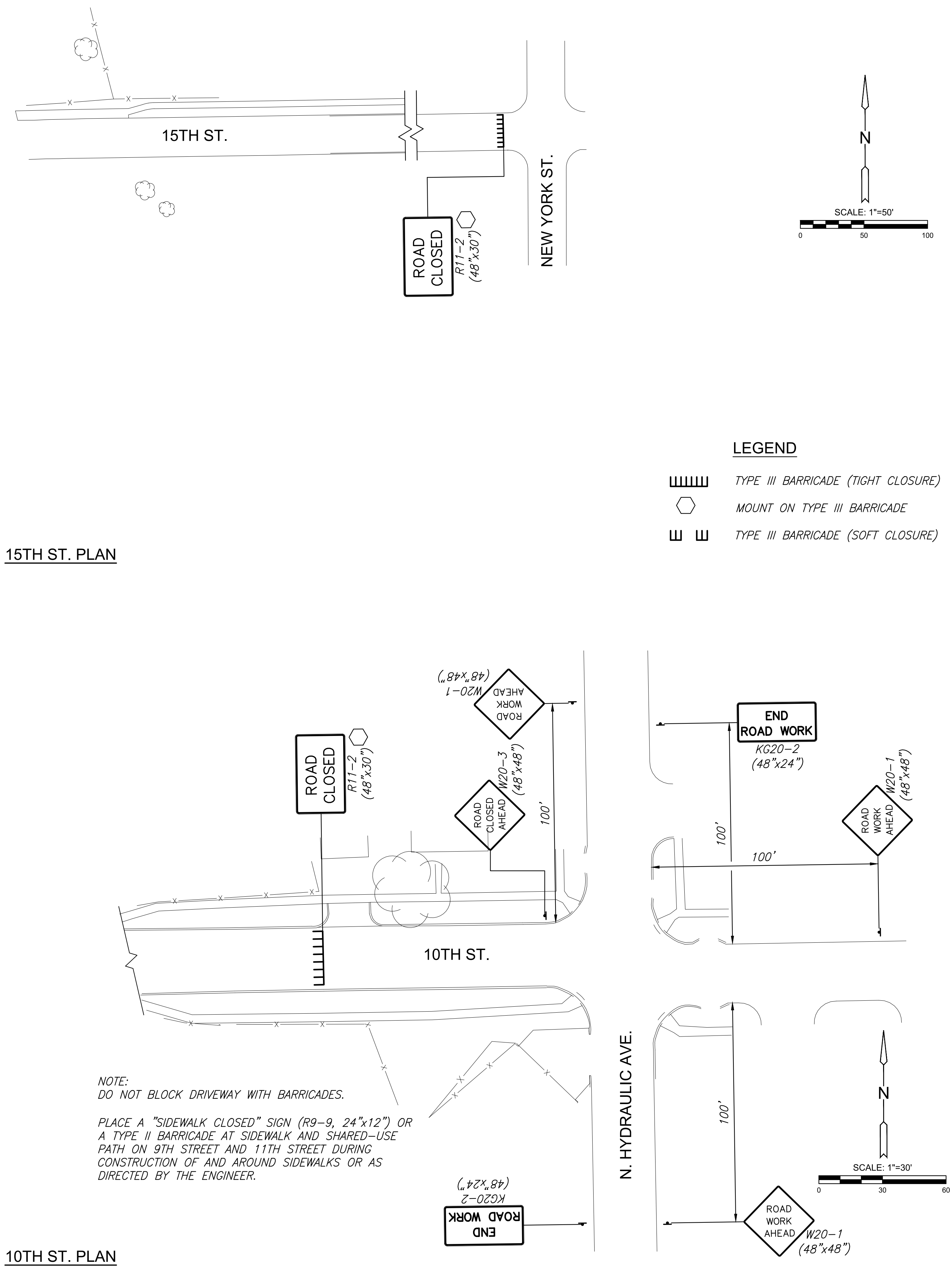

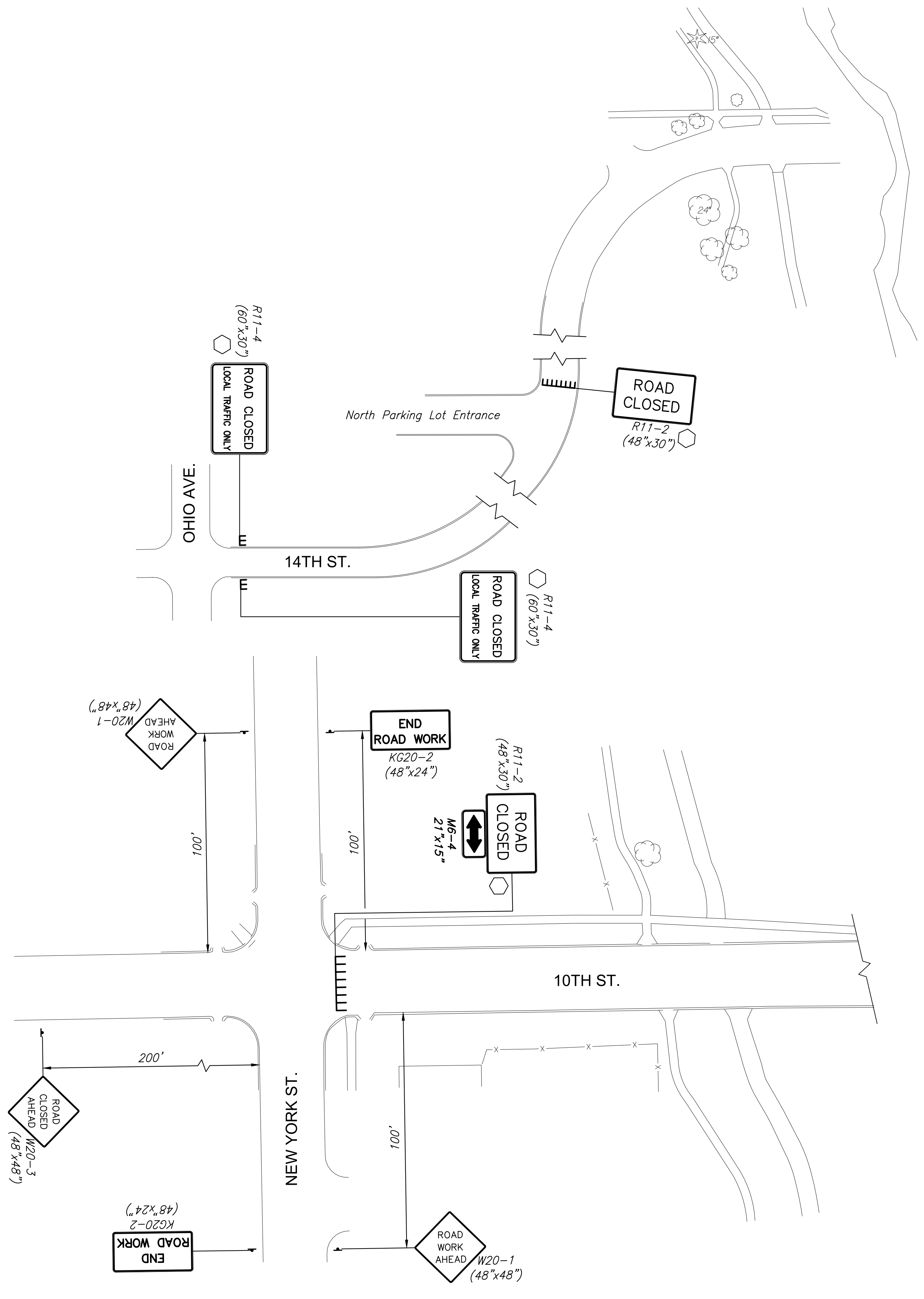

15TH ST. PLAN

10TH ST. PLAN

NOTE:
DO NOT BLOCK DRIVEWAY WITH BARRICADES.

PLACE A "SIDEWALK CLOSED" SIGN (R9-9, 24"x12") OR A TYPE II BARRICADE AT SIDEWALK AND SHARED-USE PATH ON 9TH STREET AND 11TH STREET DURING CONSTRUCTION OF AND AROUND SIDEWALKS OR AS DIRECTED BY THE ENGINEER.

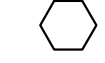
LEGEND

-  TYPE III BARRICADE (TIGHT CLOSURE)
-  MOUNT ON TYPE III BARRICADE
-  TYPE III BARRICADE (SOFT CLOSURE)

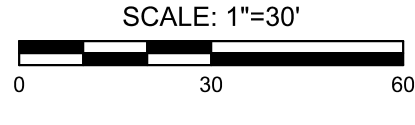
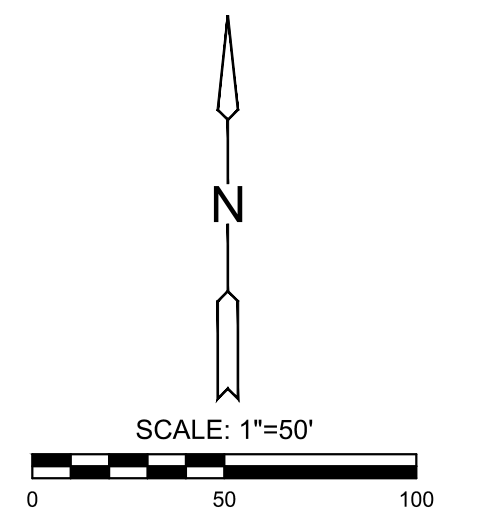

PLANS FOR
10TH STREET - 15TH STREET BRIDGES
WICHITA, KS

©2021
MKEC Engineering
All Rights Reserved
www.mkec.com
These drawings and their contents, including, but not limited to, all concepts, designs, & ideas are the exclusive property of MKEC Engineering (MKEC), and may not be used or reproduced in any way without the express consent of MKEC.

TRAFFIC CONTROL PLAN - 10TH & 15TH ST

PROJECT NO.	1901010483	
DATE	JUNE 2021	
SCALE	AS SHOWN	
DESIGNED	DRAWN	CHECKED
JRA	RAM	JRA

NO.	REVISION	DATE

SHEET NO.
19 OF 27