

WATER MAIN EXTENSION

RIDGE ROAD & 45TH STREET NORTH

CITY OF WICHITA, KANSAS

Gary Janzen, P.E. City Engineer

Project Number
448-2020-011351
OCA Number
820031

September 2021

SHEET INDEX

- | | |
|-------|---------------------------|
| 1 | Title Sheet |
| 2 | Keysheet |
| 3 | General Notepage |
| 4-5 | Water Line 1 Plan/Profile |
| 6-8 | Water Line 2 Plan/Profile |
| 9-11 | Standard Water Details |
| 12-13 | Erosion Control Plan |
| 14-18 | Erosion Control Details |

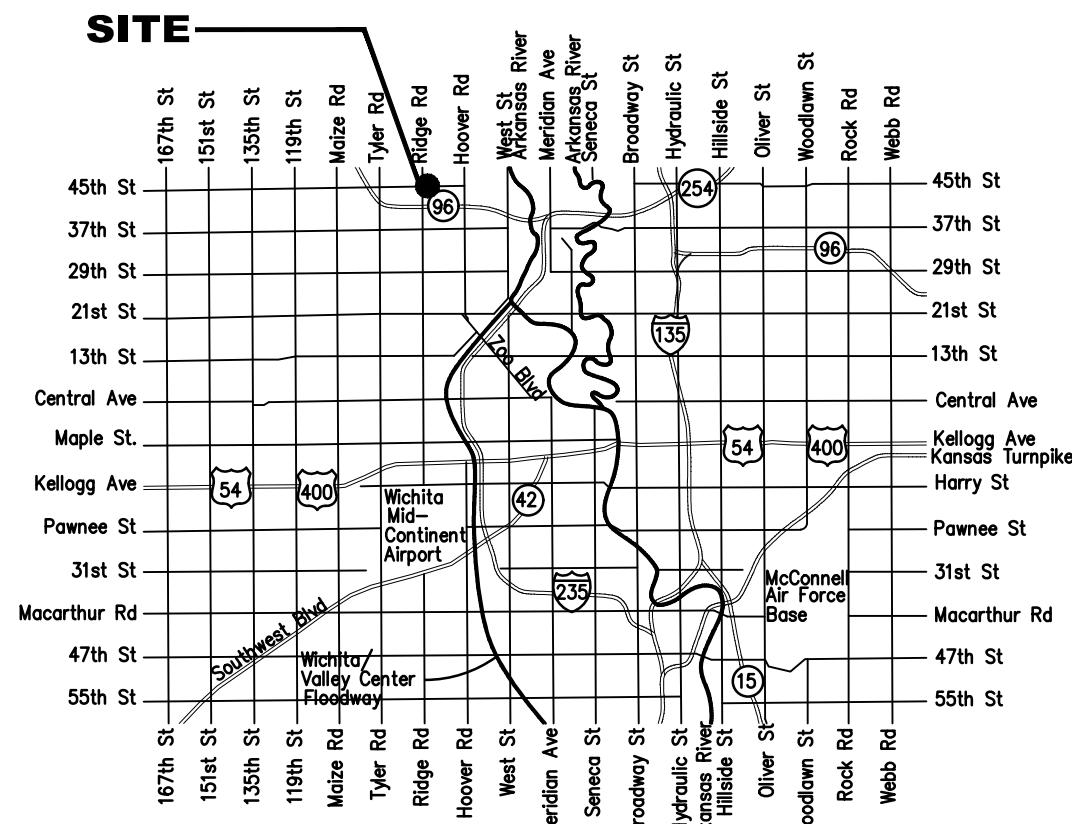

VICINITY MAP

B.L. Sta. 50+00.00, Ridge Road
B.L. Sta. 100+00.00, 45th Street North
Thimble
NW Corner, NW 1/4, Sec. 27
Township 26 South, Range 1 W
N=1714639.870, E=1622613.773

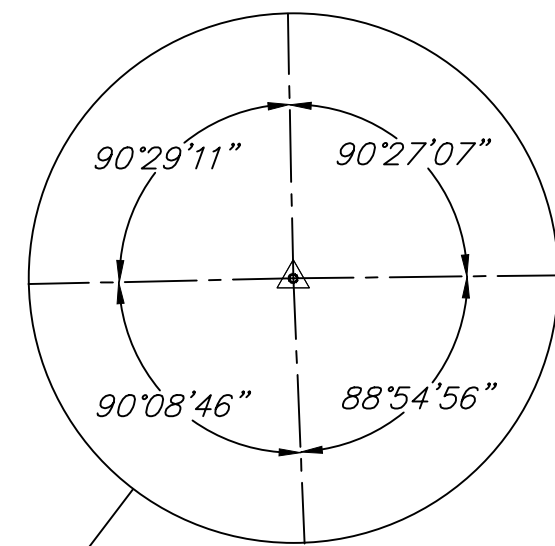

B.L. Sta. 126+51.81, 45th Street North
Stone
NE Corner, NW 1/4, Sec. 27
Township 26 South, Range 1 W
N=1714683.028, E=1625265.223

16" Water Main
City of Wichita
Project No. 448-90312

DODD ADDITION

NORTH
FORTY
FIFTH
ADDITION

MIDLAND
BAPTIST
CHURCH
2ND
ADDITION

EDGEWATER
ADDITION

VILLAGE
CHARTERS 3RD
ADDITION

Proposed 20" Water

WATER LINE 1

20" Water Main
City of Wichita
Project No. 2019-005421

B.L. Sta. 23+67.85, Ridge Road
Thimble
SW Corner, NW 1/4, Sec. 27
Township 26 South, Range 1 W
N=1712008.749, E=1622686.757

Proposed 16" Water

WATER LINE 2

SCALE: 1" = 200'



BENCHMARKS

- BM #1 - Chiseled "L" at the Centerline of the Inlet on the East Side of Ridge Road, Across the Street from 4419 Ridge Road.
Elev. = 1333.85 (NAVD 88)
- BM #2 - Chiseled Crow's Foot at the Middle of the South East Curb Return at the Intersection of Ridge Road and 45th Street North.
Elev. = 1337.09 (NAVD 88)
- BM #3 - Railroad Spike in the South Face of the Power Pole on the North Side of 45th Street North at the East Property Line of North Forty-Fifth Addition.
Elev. = 1336.53 (NAVD 88)
- BM #4 - 60d Step in the South Face of the Power Pole on the North Side of 45th Street North, on the West Side of the Driveway to 6700 W. 45th Street North.
Elev. = 1340.80 (NAVD 88)

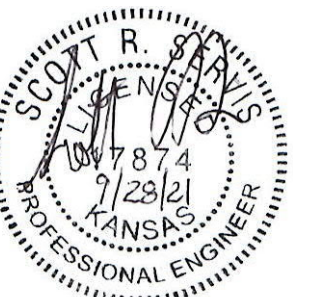

B 315 ELLIS | WICHITA, KS 67211
[P] 316-262-7271
[BaughmanCo.com]