

BM #1 "□" on Top of Curb Located at the East Side of Shefford 12.5' South of the North Line of Pawnee Mesa Addition. Elevation = 143.56 (City Datum)

BM #2 "□" on Top of Curb Located at 14.5' East of the Southeast Corner of Lot 3, Block B, Lark 2nd Addition. Elevation = 143.10 (City Datum)

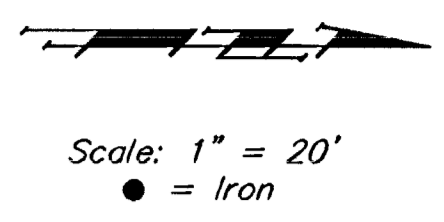

CURVE #1L
Curve Data Based on Face
Rad. = 800' Delta = 45° 16' Tangent = 34.03'
Arc = 68.01' L.C. = 67.99' Def/Ft. = 2.14870 Min.

Station	Arc	FACE CHORD LENGTHS	Defl.	T. Defl.
		8 Lt.		
A	-	-	0'00"00"	0'00"00"
B	22.67'	22.90'	0'48"43"	0'48"43"
C	22.67'	22.90'	0'48"43"	1'37"12"
0+86.87	22.67'	22.90'	0'48"43"	2'26"08"

CURVE #1R
Curve Data Based on Face
Rad. = 230' Delta = 90° 38' Tangent = 18.39'
Arc = 36.71' L.C. = 36.67' Def/Ft. = 7.47253 Min.

Station	Arc	FACE CHORD LENGTHS	Defl.	T. Defl.
		8 Rt.		
0+00.00	-	-	0'00"00"	0'00"00"
D	18.36'	17.72'	2'17"12"	2'17"12"
E	18.35'	17.71'	2'17"07"	4'34"19"

CURVE #2R
Curve Data Based on Centerline
Rad. = 800' Delta = 15° 14' 38" Tangent = 107.05'
Arc = 212.84' L.C. = 212.22' Def/Ft. = 2.14864 Min.

Station	Arc	FACE CHORD LENGTHS	Defl.	T. Defl.
		8 Rt.		
E	-	-	0'00"00"	0'00"00"
0+62.13(IRON)	26.70(Back)	27.53'	0'57"22"	0'57"22"
0+75.00	12.87'	13.27'	0'27"39"	1'25"01"
1+00.00	25.00'	25.78'	0'53"43"	2'18"44"
1+25.00	25.00'	25.78'	0'53"43"	3'12"27"
1+50.00	25.00'	25.78'	0'53"43"	4'06"10"
1+75.00	25.00'	25.78'	0'53"43"	4'59"53"
2+00.00	25.00'	25.78'	0'53"43"	5'53"36"
2+25.00	25.00'	25.78'	0'53"43"	6'47"19"
2+48.27	23.27'	24.00'	0'50"00"	7'37"19"

CURVE #2L
Curve Data Based on Centerline
Rad. = 800' Delta = 11° 33' 34" Tangent = 80.97'
Arc = 161.40' L.C. = 161.13' Def/Ft. = 1.14596 Min.

Station	Arc	FACE CHORD LENGTHS	Defl.	T. Defl.
		8 Lt.		
0+86.87	-	-	0'00"00"	0'00"00"
1+00.00	13.13'	12.71'	0'28"12"	0'28"12"
1+25.00	25.00'	24.22'	0'53"43"	1'21"55"
1+50.00	25.00'	24.22'	0'53"43"	2'15"38"
1+75.00	25.00'	24.22'	0'53"43"	3'09"21"
2+00.00	25.00'	24.22'	0'53"43"	4'03"04"
2+25.00	25.00'	24.22'	0'53"43"	4'56"47"
2+48.27	23.27'	22.54'	0'50"00"	5'46"47"

CURVE #3
Curve Data Based on Centerline
Rad. = 1500' Delta = 6° 12' 44" Tangent = 81.40'
Arc = 162.63' L.C. = 162.56' Def/Ft. = 1.14596 Min.

Station	Arc	FACE CHORD LENGTHS	Defl.	T. Defl.
		8 Lt.		
2+48.27	-	-	0'00"00"	0'00"00"
2+50.00	1.73'	1.76'	0'01"59"	0'01"59"
2+75.00	25.00'	25.42'	0'28"39"	0'30"38"
3+00.00	25.00'	25.42'	0'28"39"	0'59"17"
3+25.00	25.00'	25.42'	0'28"39"	1'27"55"
3+50.00	25.00'	25.42'	0'28"39"	1'56"34"
3+75.00	25.00'	25.42'	0'28"39"	2'25"13"
4+00.00	25.00'	25.42'	0'28"39"	2'53"52"
4+05.93	5.93'	6.03'	0'06"48"	3'00"40"
4+10.90	4.97'	5.84'	0'05"42"	3'06"22"

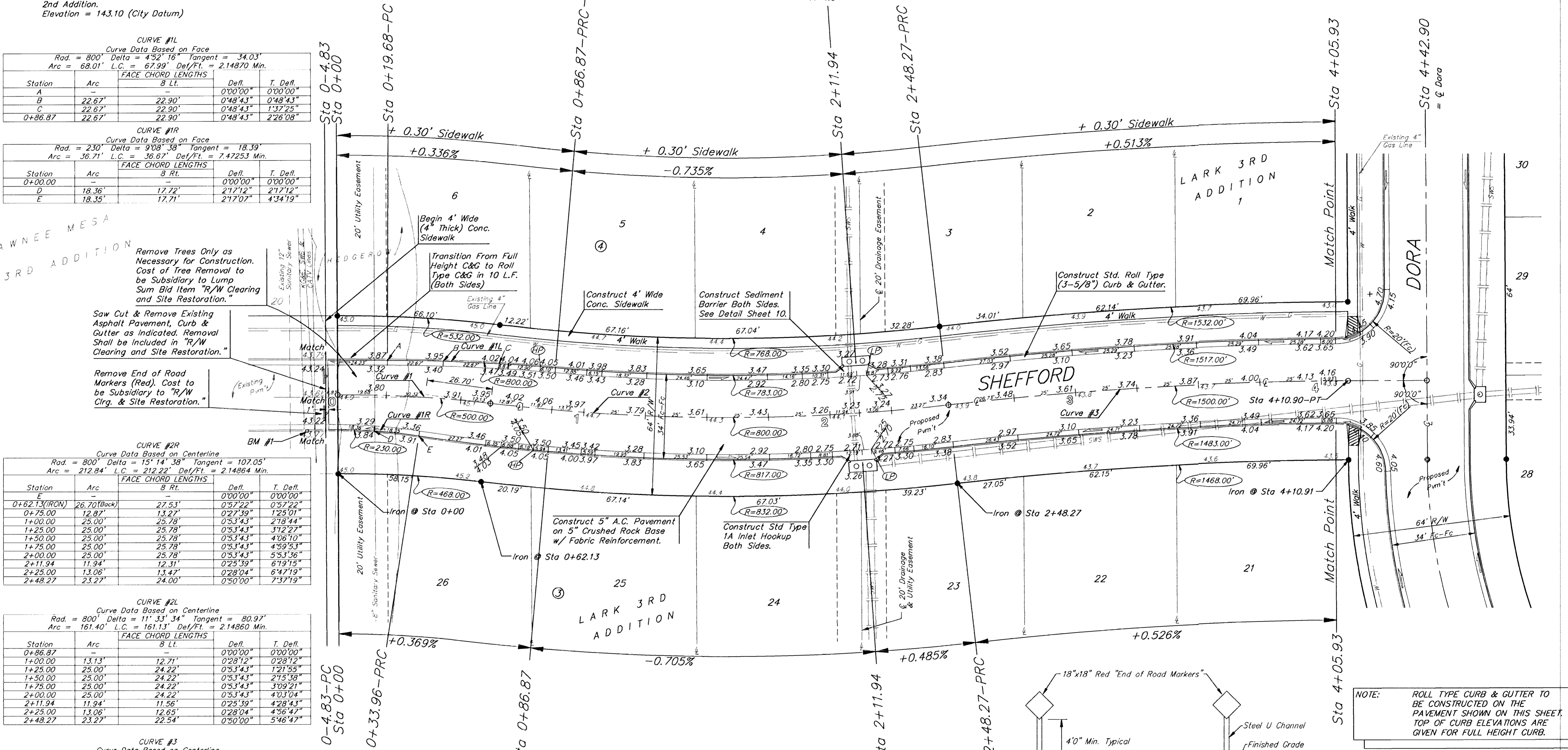

PROJECT EARTHWORK TOTALS

Excavation	2998.6 C.Y.
Loose Fill	2505.1 C.Y.
Compacted Fill	1776.5 C.Y.
Total Project Length	2736.4 L.F.

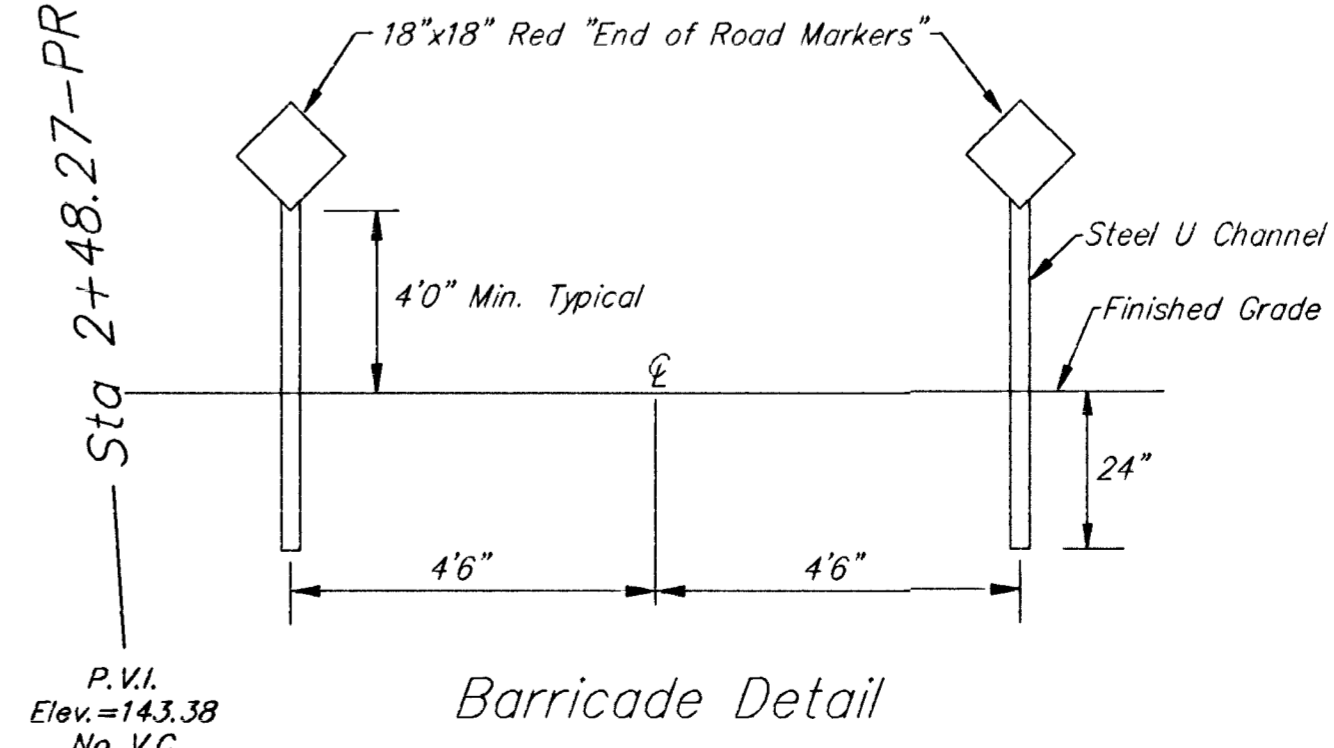

NOTE: ROLL TYPE CURB & GUTTER TO BE CONSTRUCTED ON THE PAVEMENT SHOWN ON THIS SHEET. TOP OF CURB ELEVATIONS ARE GIVEN FOR FULL HEIGHT CURB.

LARK 3RD ADDITION SHEFFORD
Sta 0+00 to Sta 4+05.93

BAUGHMAN COMPANY P.A.
ENGINEERING, SURVEYING, & PLANNING
316-282-7271 • 315 ELLIS • WICHITA, KANSAS 67211

PROJECT NUMBER: 472-78-245-82728-000-000-001

DESIGN: BP DRAWN: TMG APPROVED: DATE: 7-96 SCALE: 1" = 20'

SHEET 6 OF 21