

BENCHMARKS:
 Square Cut On Top of South Curb of 21st St. N.
 334'± West and 32'± South of the Intersection of 21st St. N. and Cleveland Ave.
 Elev. = 1307.56(NAVD88)

Square Cut On Top of South Concrete Pad of Monitoring Well 26'± East and 51'± South of The Intersection of 21st St. N. and Cleveland Ave.
 Elev. = 1308.70(NAVD88)

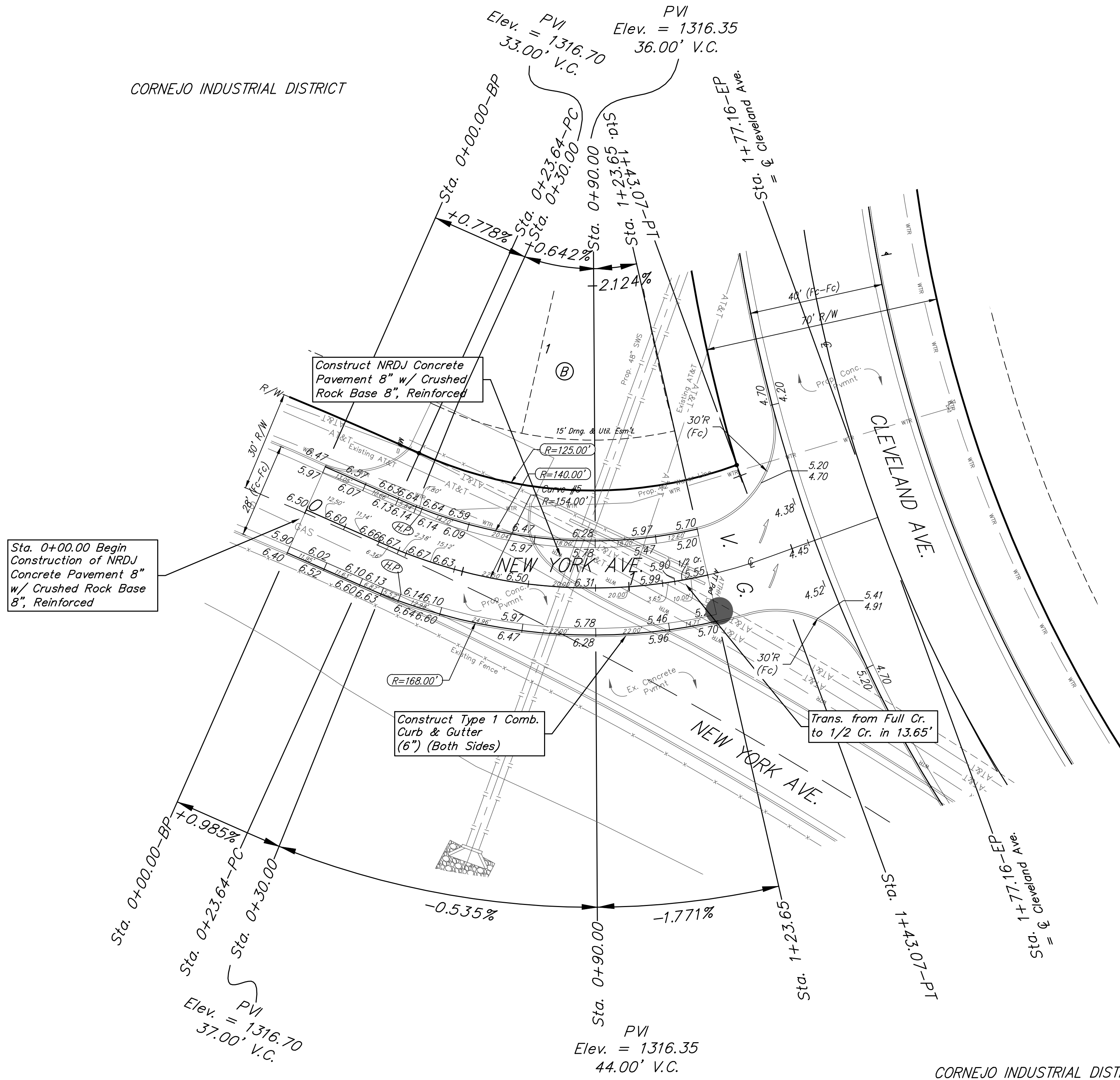
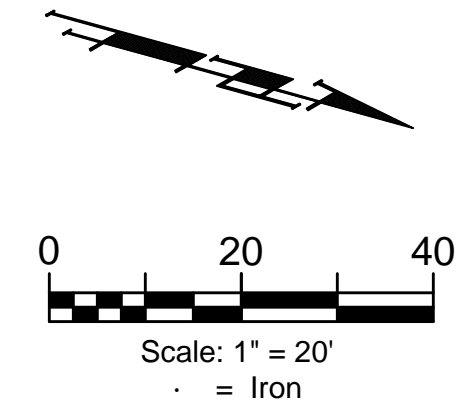

Sta. 0+00.00 Begin Construction of NRDJ Concrete Pavement 8" w/ Crushed Rock Base 8", Reinforced

Construct Type 1 Comb. Curb & Gutter (6") (Both Sides)

Trans. from Full Cr. to 1/2 Cr. in 13.65'

Curve #5

Curve Data Based on Centerline

Rad. = 200' Delta = 44°25'59" Tangent = 81.69'
 Arc = 119.43' L.C. = 151.24' Def./Ft. = 11.16128 Min.

| Station | Arc | Face Chord Lengths | | Defl. | Total Defl. |
|---------|--------|--------------------|----------|----------|-------------|
| | | 8' Left | 8' Right | | |
| 0+23.64 | - | - | - | 0'00'00" | 0'00'00" |
| 0+50.00 | 26.36' | 30.43' | 37.95' | 4'54'13" | 4'54'13" |
| 0+75.00 | 25.00' | 28.86' | 36.00' | 4'39'02" | 9'33'15" |
| 1+00.00 | 25.00' | 28.86' | 36.00' | 4'39'02" | 14'12'17" |
| 1+25.00 | 25.00' | 28.86' | 36.00' | 4'39'01" | 18'51'18" |
| 1+43.07 | 18.07' | 20.87' | 26.03' | 3'21'41" | 22'12'59" |

Roll type curb & gutter to be constructed on the pavement on this sheet.
 Top of curb elevation are given for full height curb.

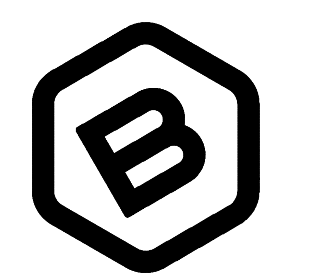
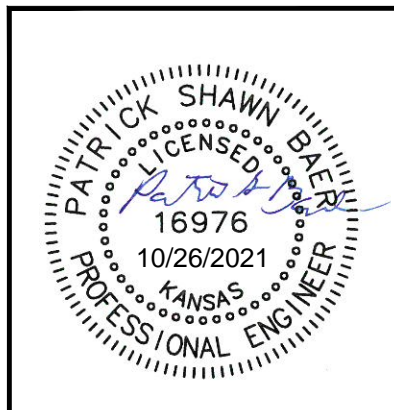

BAUGHMAN COMPANY

315 Ellis St.
 Wichita, KS 67211
 316-262-7271
 BaughmanCo.com

CORNEJO INDUSTRIAL DISTRICT

NEW YORK

Sta. 0+00.00 to 1+23.65
 Street Paving Improvements

PROJECT NUMBER:
 472-2021-085726

DESIGN: PSB DRAWN: HJW
 DATE: Oct. 26, 2021

SHEET OF
 19 62

File: E:\Projects\Comajo Industrial District_20-11-P603\Engineering\Phase 1 (only if Multiple Phases)\STR Plans\STR.dwg