

BENCHMARKS:
 Square Cut On Top of South Curb
 of 21st St. N.
 33'± West and 32'± South of the
 Intersection of 21st St. N. and
 Cleveland Ave.
 Elev. = 1307.56(NAVD88)

Square Cut On Top of South
 Concrete Pad of Monitoring Well
 26'± East and 51'± South of The
 Intersection of 21st St. N. and
 Cleveland Ave.
 Elev. = 1308.70(NAVD88)

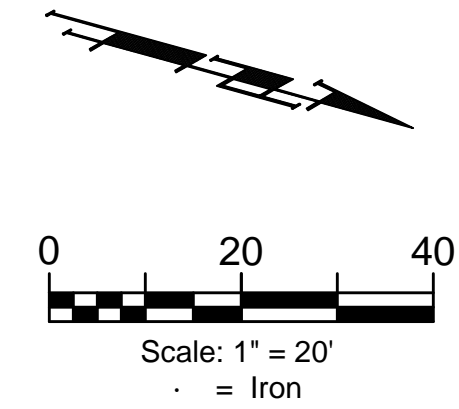

CORNEJO INDUSTRIAL DISTRICT

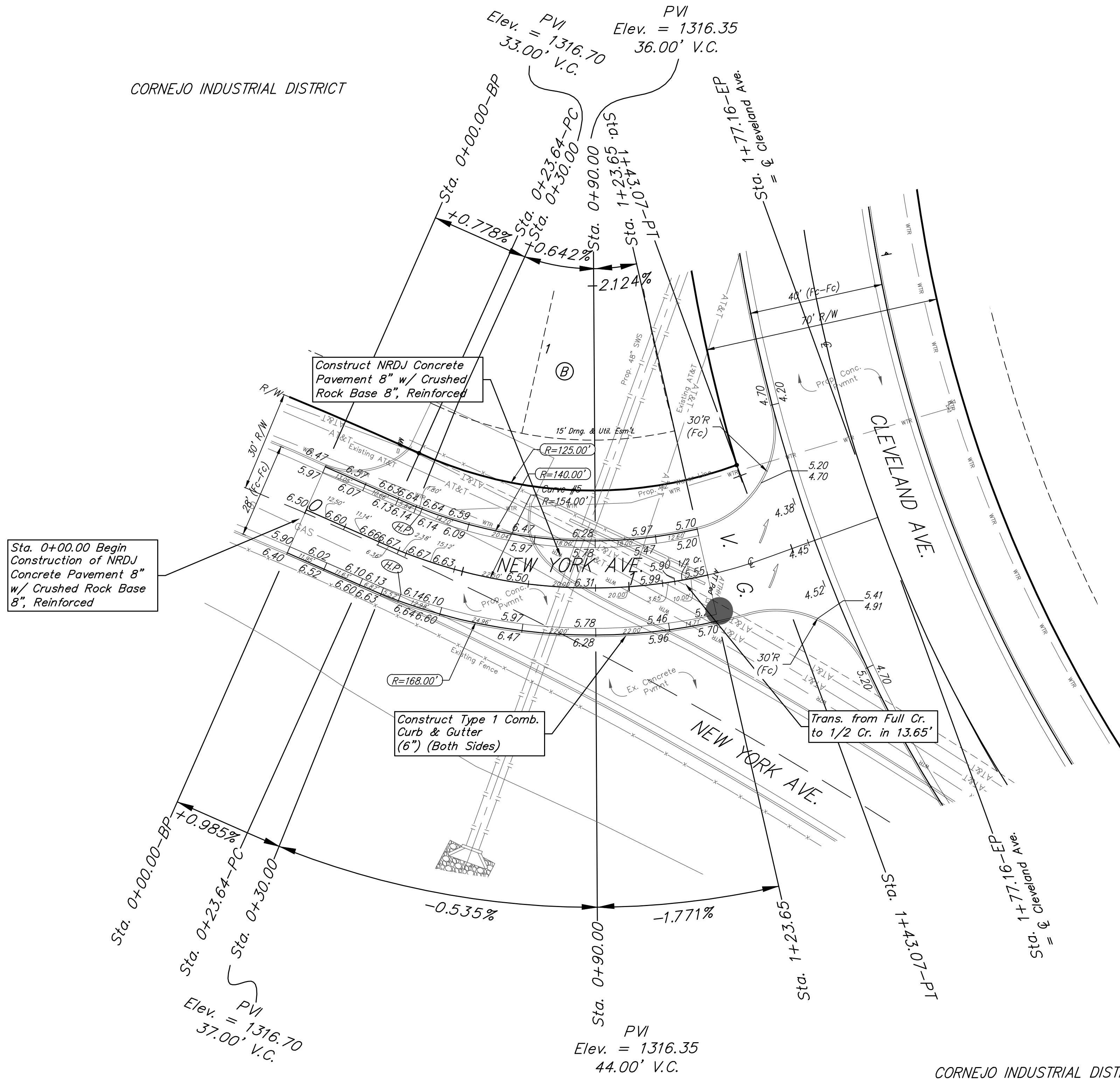

Sta. 0+00.00 Begin
 Construction of NRDJ
 Concrete Pavement 8"
 w/ Crushed Rock Base
 8", Reinforced

Construct Type 1 Comb.
 Curb & Gutter
 (6") (Both Sides)

Trans. from Full Cr.
 to 1/2 Cr. in 13.65'

Curve #5

Curve Data Based on Centerline

Rad. = 200' Delta = 44°25'59" Tangent = 81.69'
 Arc = 119.43' L.C. = 151.24' Def./Ft. = 11.16128 Min.

Station	Arc	Face Chord Lengths		Defl.	Total Defl.
		8' Left	8' Right		
0+23.64	-	-	-	0'00'00"	0'00'00"
0+50.00	26.36'	30.43'	37.95'	4'54'13"	4'54'13"
0+75.00	25.00'	28.86'	36.00'	4'39'02"	9'33'15"
1+00.00	25.00'	28.86'	36.00'	4'39'02"	14'12'17"
1+25.00	25.00'	28.86'	36.00'	4'39'01"	18'51'18"
1+43.07	18.07'	20.87'	26.03'	3'21'41"	22'12'59"

CORNEJO INDUSTRIAL DISTRICT

Roll type curb & gutter to
 be constructed on the pavement
 on this sheet.
 Top of curb elevation are given
 for full height curb.

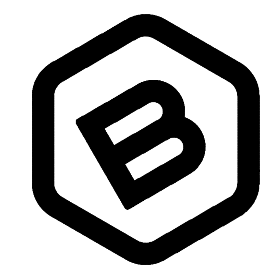
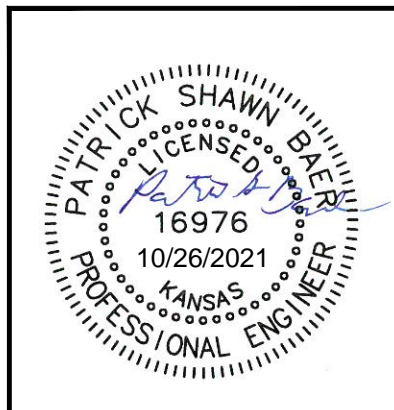

**BAUGHMAN
 COMPANY**

315 Ellis St.
 Wichita, KS 67211
 316-262-7271
 BaughmanCo.com

CORNEJO INDUSTRIAL
 DISTRICT

NEW YORK

Sta. 0+00.00 to 1+23.65
 Street Paving Improvements

PROJECT NUMBER:
 472-2021-085726

DESIGN: PSB DRAWN: HJW

DATE: Oct. 26, 2021

SHEET OF
 17 62