

SCALE:
1" = 20' HORIZONTAL
1" = 5' VERTICAL

Remove & Replace Concrete Sidewalk As Necessary For Storm Sewer Construction Contractor To Remove Concrete Sidewalk To The Nearest Construction Joint If Within 3' Of Joint. Saw Cut If Over 3' From Joint. Removal And Replacement Of Pavement Shall Not Be Paid For Directly, But Shall Be Considered Incidental To Other Items In The Project. See Note #4 Replacement.

Bench Mark:
Sheridan and McCormick
City of Wichita Bench Mark. Southeast corner of intersection.
24.00 Ft. East of center line
46.30 Ft. South of center line
Elevation = 1299.76 (MSL)

Contractor Shall Follow All Applicable Best Management Practices (BMP) For Erosion Control.

Contractor To Use Extreme Caution When Excavating Near Utility Lines. Contractor To Hand Dig To Expose All Utility Lines Prior To Construction. Verify Depth To Determine Conflict If Any.

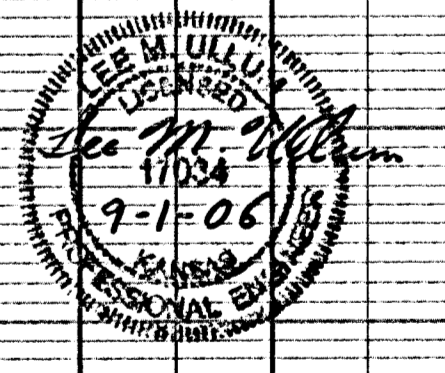
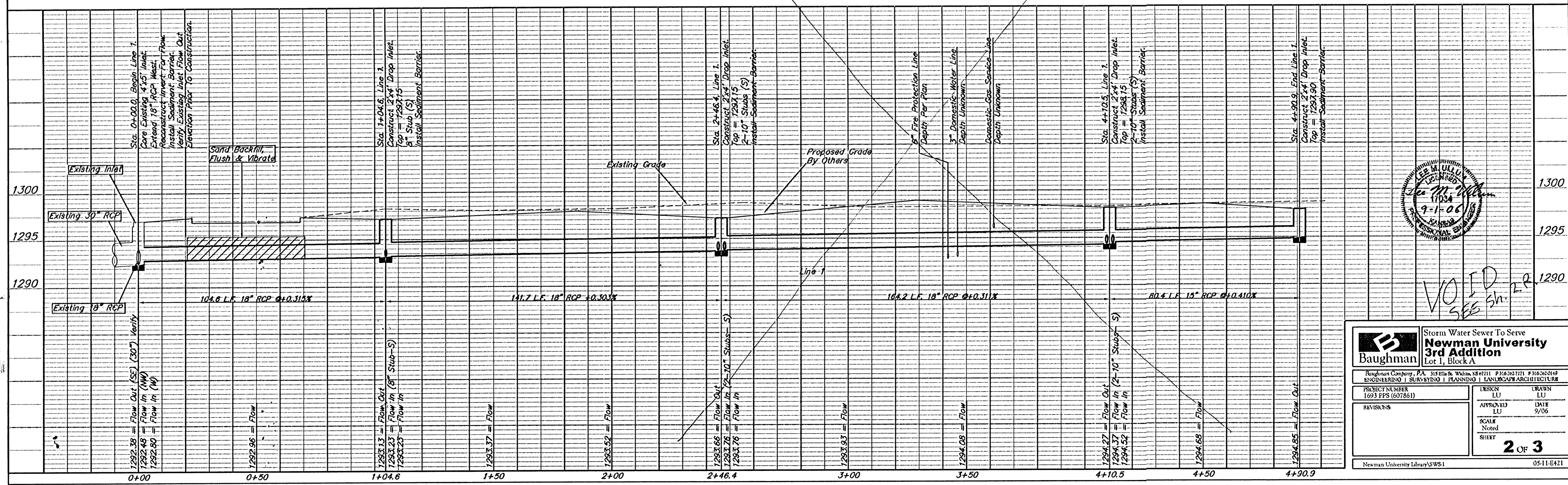

Baughman		Storm Water Sewer To Serve Newman University 3rd Addition Lot 1, Block A	
Baughman Company, P.A. 315 E. 15th & W. 15th, KS 67111 P316-262771 F316-2620149 ENGINEERING SURVEYING PLANNING LANDSCAPE ARCHITECTURE			
PROJECT NUMBER 1693 PPS (607861)	DESIGN LU	DRAWN LU	DATE 9/06
REVISIONS	APPROVED LU	SCALE Noted	SHEET
		2 OF 3	
Newman University Library/SWS-1		05-11-E421	

VOID SEE SH 2R

VOID SEE SH 2R