

INDEX OF DRAWINGS

SHEET NO.	DESCRIPTION
1	Title Sheet
2	Typical Section
3	Plan and Profile
4-9	Pavement Details
10	Bridge General Notes and Quantities
11	Contour Map
12	Construction Layout
13-23	Bridge Details
24	Standard Pile Details
25	Bridge Excavation
26	Supports and Spacers
27	Summary of Quantities
28-32	Temporary Project Water Pollution Control
33	Seeding
34-38	Traffic Control
39	Cross Sections

MURDOCK AVENUE BRIDGE OVER THE WICHITA DRAINAGE CANAL

PROJ. NO. 472-82784

CITY OF WICHITA, KANSAS
 MICHAEL E. LINDEBAK, CITY ENGINEER
 FEBRUARY 1999

INDEX CODE 715675

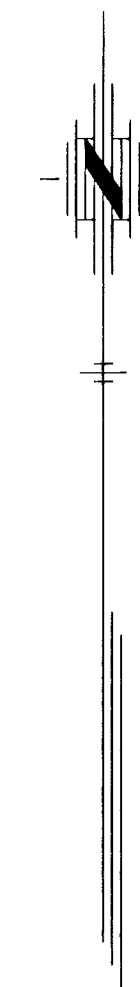

BENCH MARKS

BM #1 "□" Cut on the N.W. corner of the west abutment of the Burlington Northern Bridge Elev. 396.965

BM #2 "□" Cut on the N.E. corner of an overhead drain box, at the 8th column south of 9th Street N. right bank. Elev. 396.548

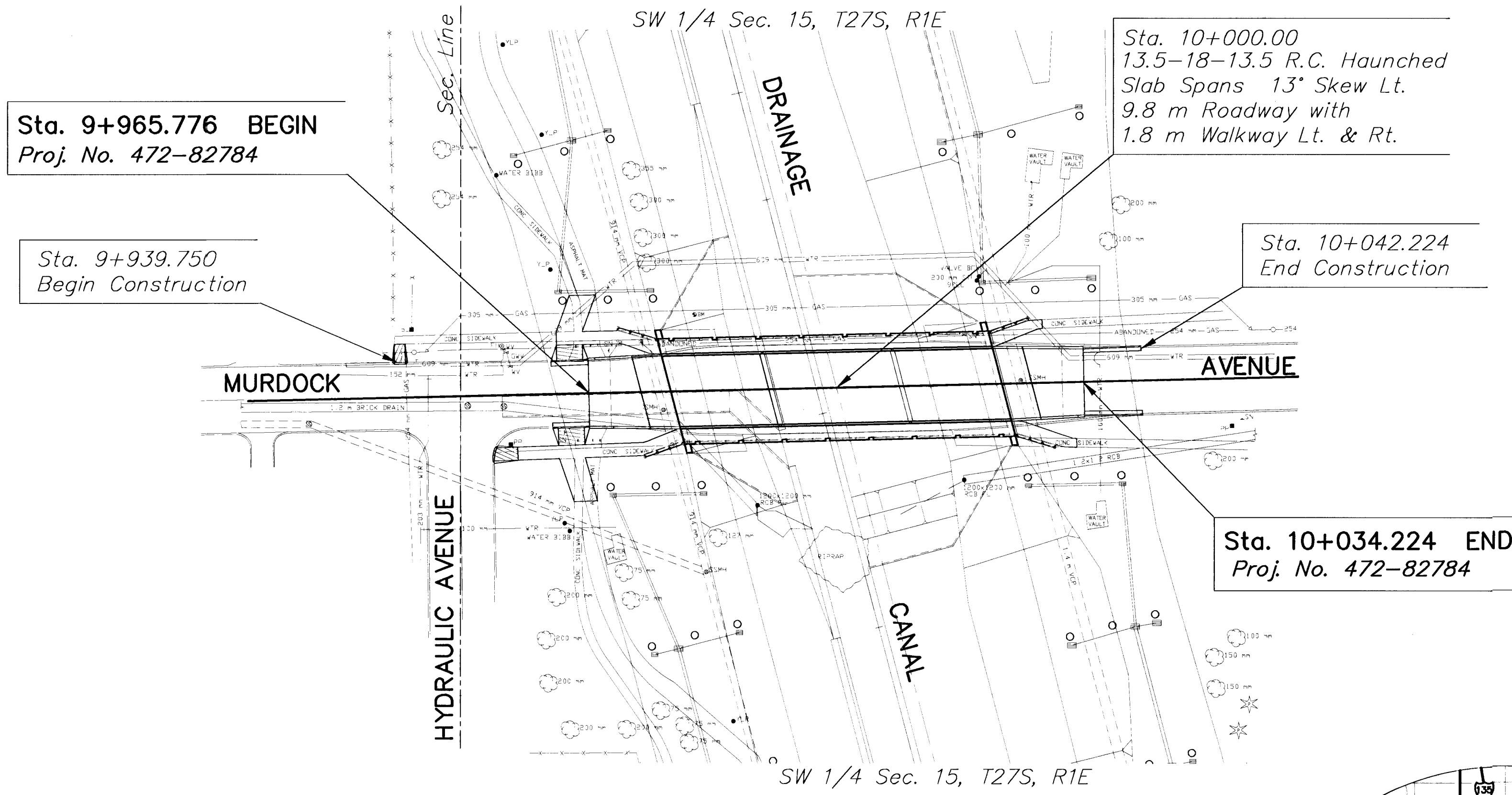

SCALE 1: 500

DESIGN DESIGNATION

AADT (1998) =	1,200
AADT (2018) =	1,460
DHV =	10
D =	60%
T =	12%
V =	50 km/h
C OF A =	NONE

CONVENTIONAL SIGNS

COUNTY LINE	-----	CENTER LINE OF PROJECT	-----
CITY LIMITS	=====	TERRACE	-----
STATE OR NATIONAL LINE	-----	CULVERTS	-----
TOWNSHIP, SECTION or GRANT LINE	-----	DROP INLET & STORM SEWER	-----
PROPERTY LINE	-----	ACCESS CONTROL	-----
HIGHWAY FENCE	-----	POWER POLE	-----
EXISTING FENCE	-----	TELEPHONE POLE	-----
GUARD FENCE	-----	MARSH	-----
CONSTRUCTION LIMITS	-----	HEDGE	-----
RIGHT OF WAY LINE	-----	TREES	-----
TRAVELED WAY	-----	PROFILE ELEVATION	-----
RAILROADS	-----	STREAM or CREEK	-----

GROSS LENGTH OF PROJECT	68.448 m
EXCEPTIONS	NONE
ADDITIONS	NONE
NET LENGTH OF PROJECT	68.448 m
NET LENGTH OF BRIDGES	45.770 m
NET LENGTH OF ROAD	22.678 m

PROJECT LOCATION

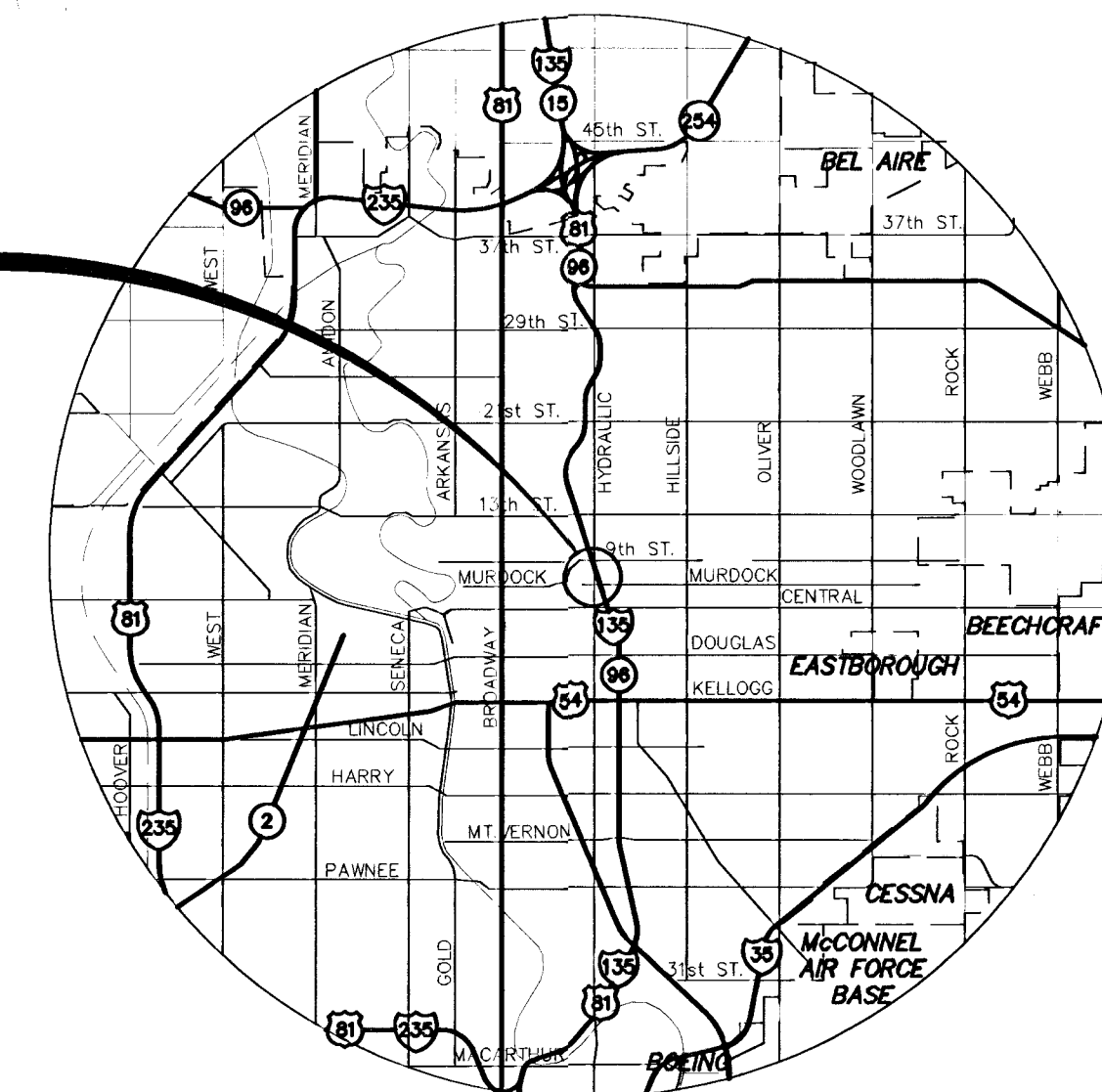

POPULATION: 310,238

NOTE: Street shall be closed to traffic during construction.

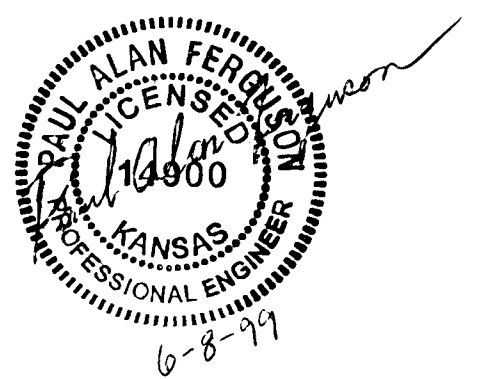

PREPARED AND SUBMITTED BY
 MID-KANSAS ENGINEERING CONSULTANTS, INC.
 WICHITA, KANSAS



All dimensions shown, without a SI suffix, are in millimeters. All elevations shown are in meters.

RECOM. FOR APPROVAL-DATE

WICHITA CITY ENGINEER
 MICHAEL E. LINDEBAK, P.E.