

BENCHMARKS:
 BM #1: "□" Cut in top of curb, east return of SE corner of Lotus & Parkridge.
 Elev. = 145.99 (City Datum)
 BM #2: "X" Cut on walk at NW corner of Lot 1, Block F, Flat Creek Addition
 Elev. = 146.22 (City Datum)
 BM #3: "□" Cut in top of curb at the NW corner of Lot 1, Block B, Hunter's Ridge Addition.
 Elev. = 146.63 (City Datum)

Scale: 1" = 20'
 • = Iron

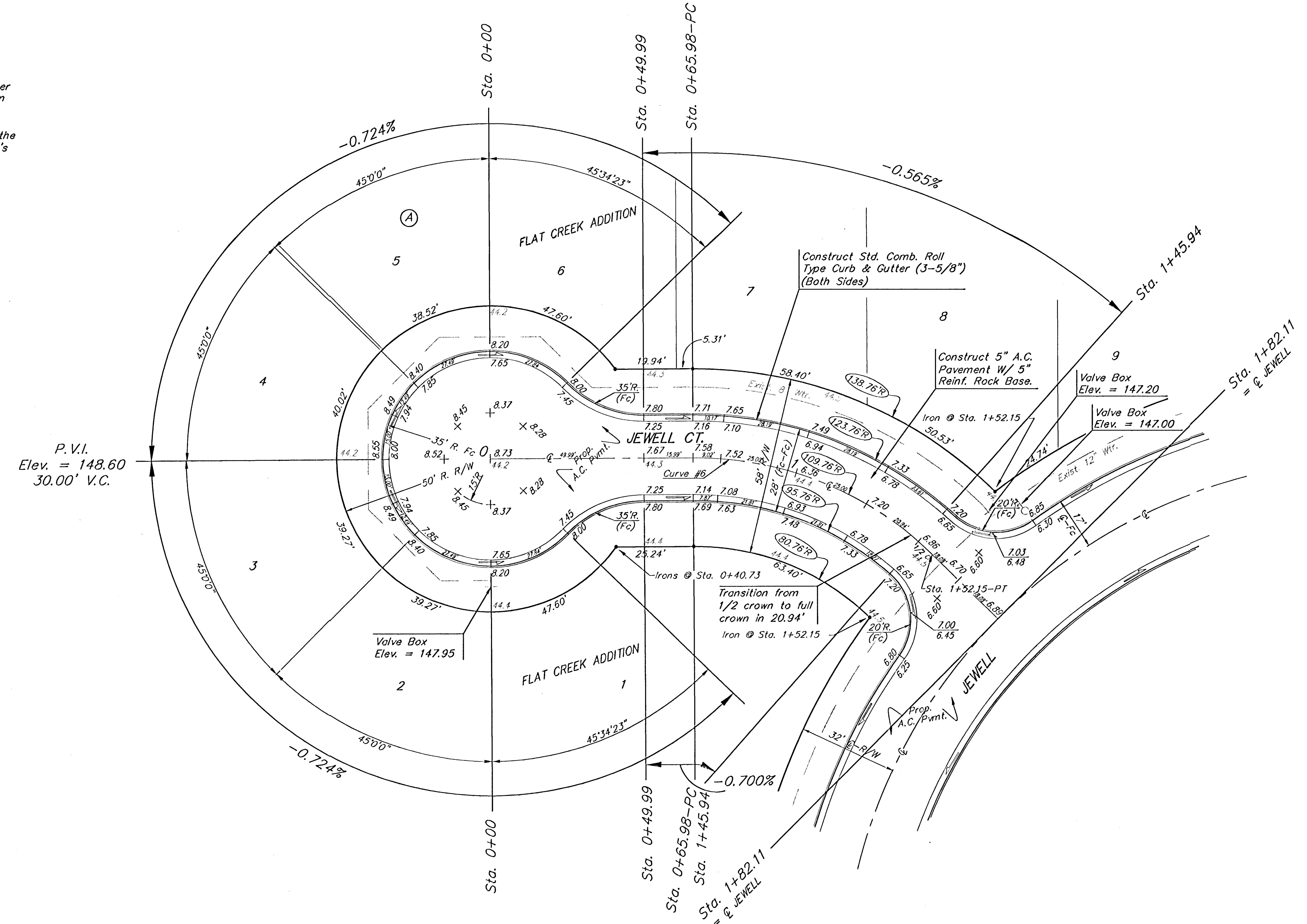

Curve #6
 Curve Data Based on Centerline
 Rad. = 109.76' Delta = 41°44'37" Tangent = 41.85'
 Arc = 79.96' L.C. = 78.21' Def/Ft. = 15.66169 Min.

Station	Arc	FACE CHORD LENGTHS		Defl.	T. Defl.
		8' Lt.	8' Rt.		
0+65.98	-	-	-	0°00'00"	0°00'00"
0+75.00	9.02'	10.83'	7.21'	2°21'16"	2°21'16"
1+00.00	25.00'	29.95'	19.95'	6°31'33"	8°52'49"
1+25.00	25.00'	29.95'	19.95'	6°31'32"	15°24'21"
1+45.94	20.94'	25.10'	16.72'	5°27'58"	20°52'19"

NOTE: ROLL TYPE CURB & GUTTER TO BE CONSTRUCTED ON THE PAVEMENT SHOWN ON THIS SHEET. TOP OF CURB ELEVATIONS ARE GIVEN FOR FULL HEIGHT CURB.

FLAT CREEK ADDITION
JEWELL CT.
 STA. 0+00 TO STA. 1+82.11

BAUGHMAN COMPANY P.A.
 ENGINEERING, SURVEYING, & PLANNING
 315-262-7271 • 315 ELLIS • WICHITA, KANSAS 67211

PROJECT NUMBER
472-83383

DESIGN: BP/TMG DRAWN: DC APPROVED: _____ DATE: 08-01 SCALE: Noted

SHEET **11** OF **39**