

**BENCH MARKS:**  
 City Disc - 34.3' E. & 3.3' N. of  
 S.W. Corner of N.W. 1/4, Sec. 25,  
 T-27-S, R-2-W.  
 Elev. = 156.63 City Datum

City Disc - 135TH St. W. & Maple,  
 30' N. & 15' E. @ Both.  
 Elev. = 150.20 City Datum

SCALE: 1" = 20'  
 • = Iron

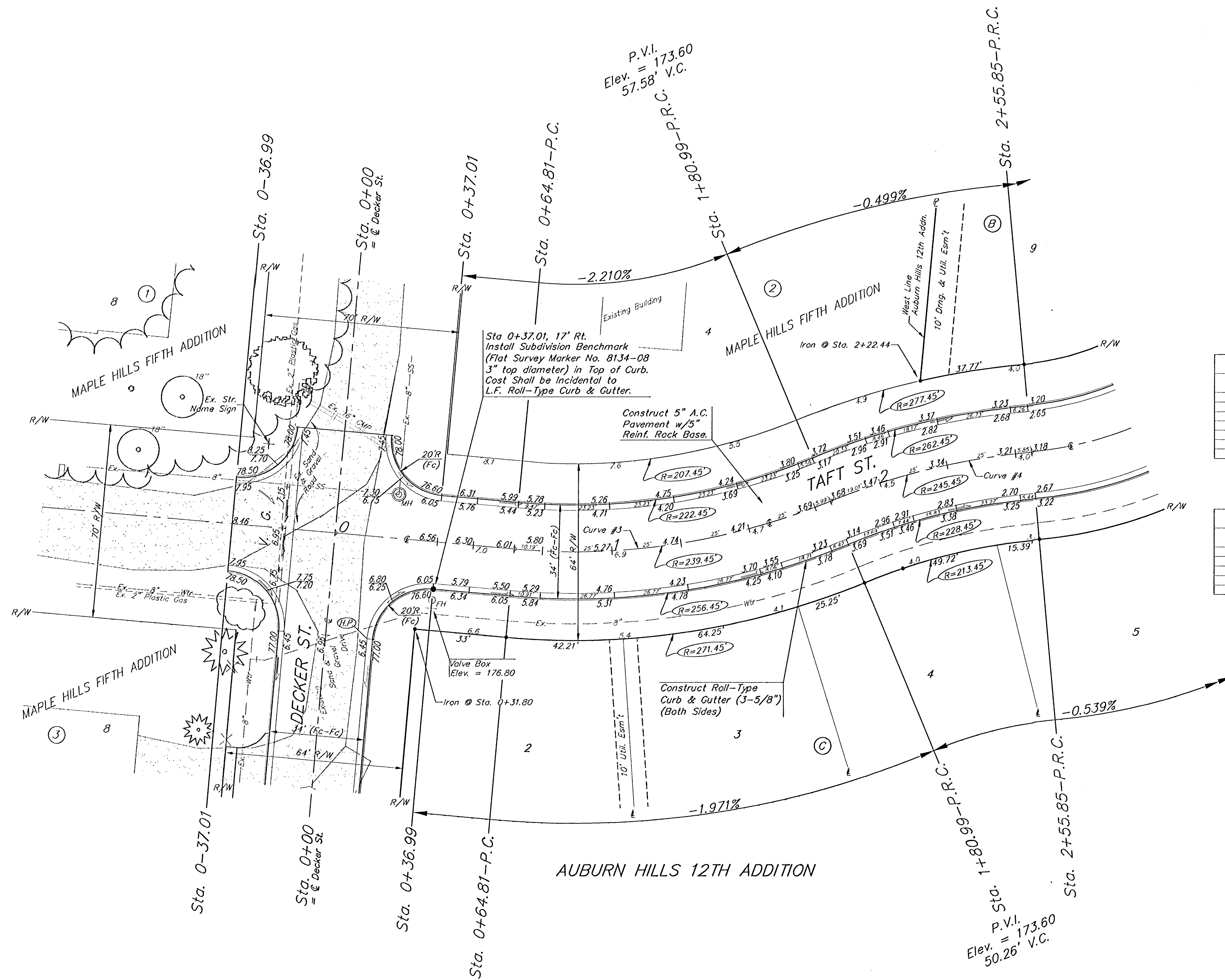

Curve #3  
 Curve Data Based on Centerline  
 Rad. = 239.45' Delta = 27° 48' 00" Tangent = 59.26'  
 Arc = 116.18' L.C. = 115.05' Def/Ft. = 7.17852 Min.

Station	Arc	FACE CHORD LENGTHS		Defl.	T. Defl.
		8' Lt.	8' Rt.		
0+64.81	-	-	-	0°00'00"	0°00'00"
0+75.00	10.19'	9.13'	11.25'	1°13'09"	1°13'09"
1+00.00	25.00'	22.38'	27.60'	2°59'28"	4°12'57"
1+25.00	25.00'	22.38'	27.60'	2°59'27"	7°12'04"
1+50.00	25.00'	22.38'	27.60'	2°59'28"	10°11'32"
1+75.00	25.00'	22.38'	27.60'	2°59'28"	13°11'00"
1+80.99	5.99'	5.36'	6.62'	0°43'00"	13°54'00"

Curve #4  
 Curve Data Based on Centerline  
 Rad. = 245.45' Delta = 17° 28' 35" Tangent = 37.73'  
 Arc = 74.86' L.C. = 74.58' Def/Ft. = 7.00363 Min.

Station	Arc	FACE CHORD LENGTHS		Defl.	T. Defl.
		8' Lt.	8' Rt.		
1+80.99	-	-	-	0°00'00"	0°00'00"
2+00.00	19.01'	20.94'	17.07'	2°13'08"	2°13'08"
2+25.00	25.00'	27.54'	22.45'	2°55'06"	5°08'14"
2+50.00	25.00'	27.54'	22.45'	2°55'05"	8°03'19"
2+55.85	5.85'	6.45'	5.25'	0°40'59"	8°44'18"

AUBURN HILLS ADDITION - PHASE I  
**TAFT STREET**  
 STA. 0+00 TO STA. 2+55.85

**BAUGHMAN COMPANY P.A.**  
 ENGINEERING, SURVEYING, & PLANNING  
 316-262-7271 • 315 ELLIS • WICHITA, KANSAS 67211

PROJECT NUMBER  
**472-83290**

DESIGN: DMV DRAWN: JAK APPROVED: DATE: 3-14-01 SCALE: NOTED SHEET: **9** OF **30**