

SCALE: 1" = 20'

N.E. Corner
Sec. 9, T27S, R1W
of the 6th P.M.
21st St. N. Sta. 1104+03.16

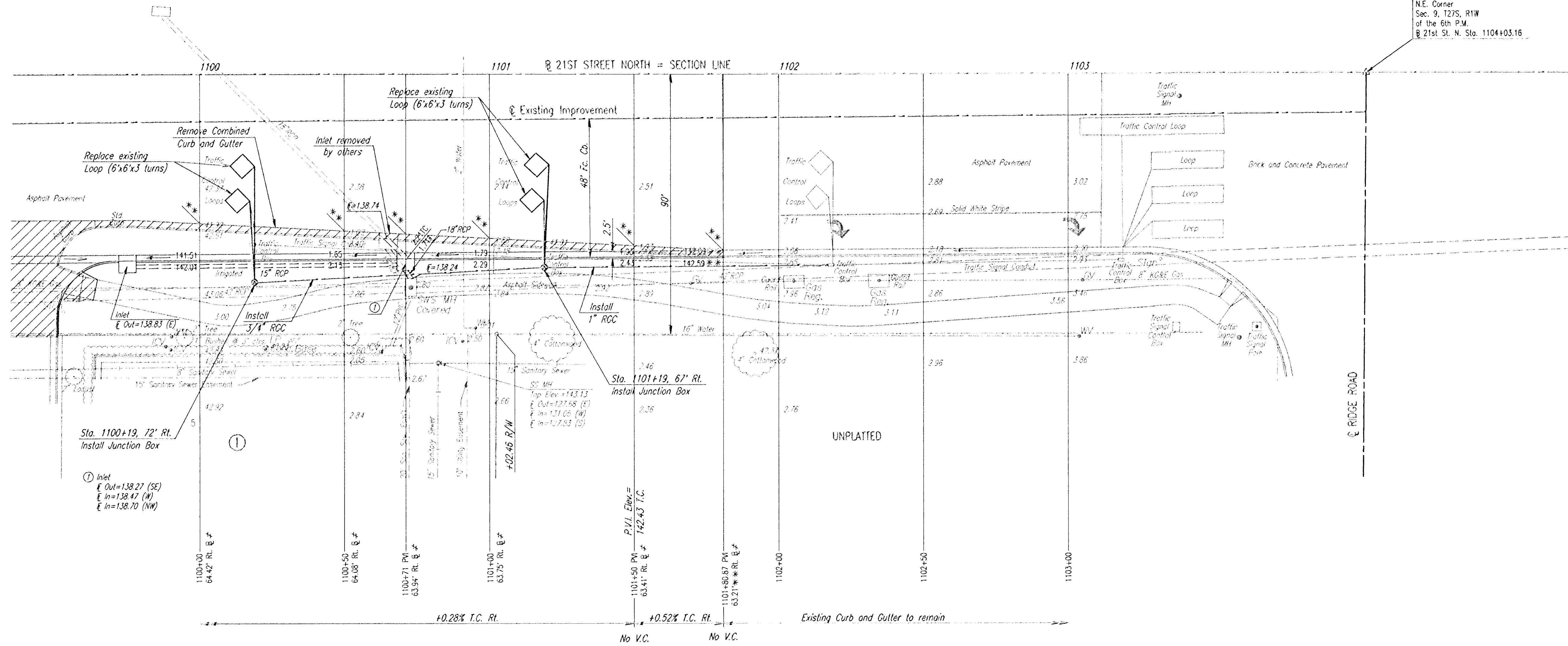

NOTE: STORM WATER SEWER PIPES AND STRUCTURES ARE TO BE CONSTRUCTED BY OTHERS UNDER C.O.M. PROJ. NO. 468-76-245-81911-000-001

THE CONTRACTOR SHALL CONTACT MARK BORST, P.E. AT THE SEDGWICK COUNTY BUREAU OF PUBLIC SERVICES (383-7901) PRIOR TO ANY WORK THAT AFFECTS THE TRAFFIC SIGNAL AT 21ST ST. N. AND RIDGE ROAD.

** MATCH EXISTING
FACE OF CURB

BARRINGTON CORNER DECEL LANE

21ST STREET NORTH

STA 1100+00 TO STA. 1104+00

PROFESSIONAL ENGINEERING CONSULTANTS, P.A.
ENGINEERS
WICHITA, KANSAS

Designed by	BER, GDD	Checked by	
Drawn by	DEP	Date	AUG., 1995
		Job No.	95325

usr:\usr\dmr\1995\95325\plan.dgn
 date plotted: 8/18/95
 deliver to: awc:line dunn