

Scale: 1" = 60'

EROSION CONTROL PLAN LEGEND
(Installation Details Found in the SMP2 Plan)

- LIGHT STONE RIP-RAP
- DROP INLET PROTECTION
- CURB INLET PROTECTION
- STRAW BALE BARRIERS
- SILT FENCING
- EARTH DIKES

NO SCALE

| EROSION CONTROL MEASURE | UNITS | QUANTITY |
|-------------------------|-------|----------|
| SILT FENCE | L.F. | 3965 |
| RIPRAP | S.Y. | SEE PLAN |
| DROP INLET BARRIER | EA. | 8 |
| CURB INLET BARRIER | EA. | 0 |
| STRAW BALE DITCH CHECK | EA. | 32 |
| CUT-OFF TRENCH | L.F. | 1825 |
| CURLEX | S.Y. | 0 |
| POND E.C. BLANKET | S.Y. | 3455 |
| Construction Entrance | EA. | 1 |

QUANTITIES ARE FOR INFORMATION ONLY!

BENCHMARK:
 BM #1: "□" Cut in middle of N headwall of R/CBC on 21st St. North. 1004.3' W & 22.1' N of SE Cor., SE1/4, Sec. 2, T-27-S, R-2-E. Elev. = 173.23 City Datum
 BM #2: "□" Cut at the SE corner of the intersection of Castle Rock & Castle Rock Ct., Krug North Addition. Elev. = 183.50 City Datum

—(185)— Existing Grade
 —185— Proposed Grade
 X X X X Silt Fence

Area to be graded

Maintain one existing construction entrance onto existing paved roadway per detail, sheet 26.

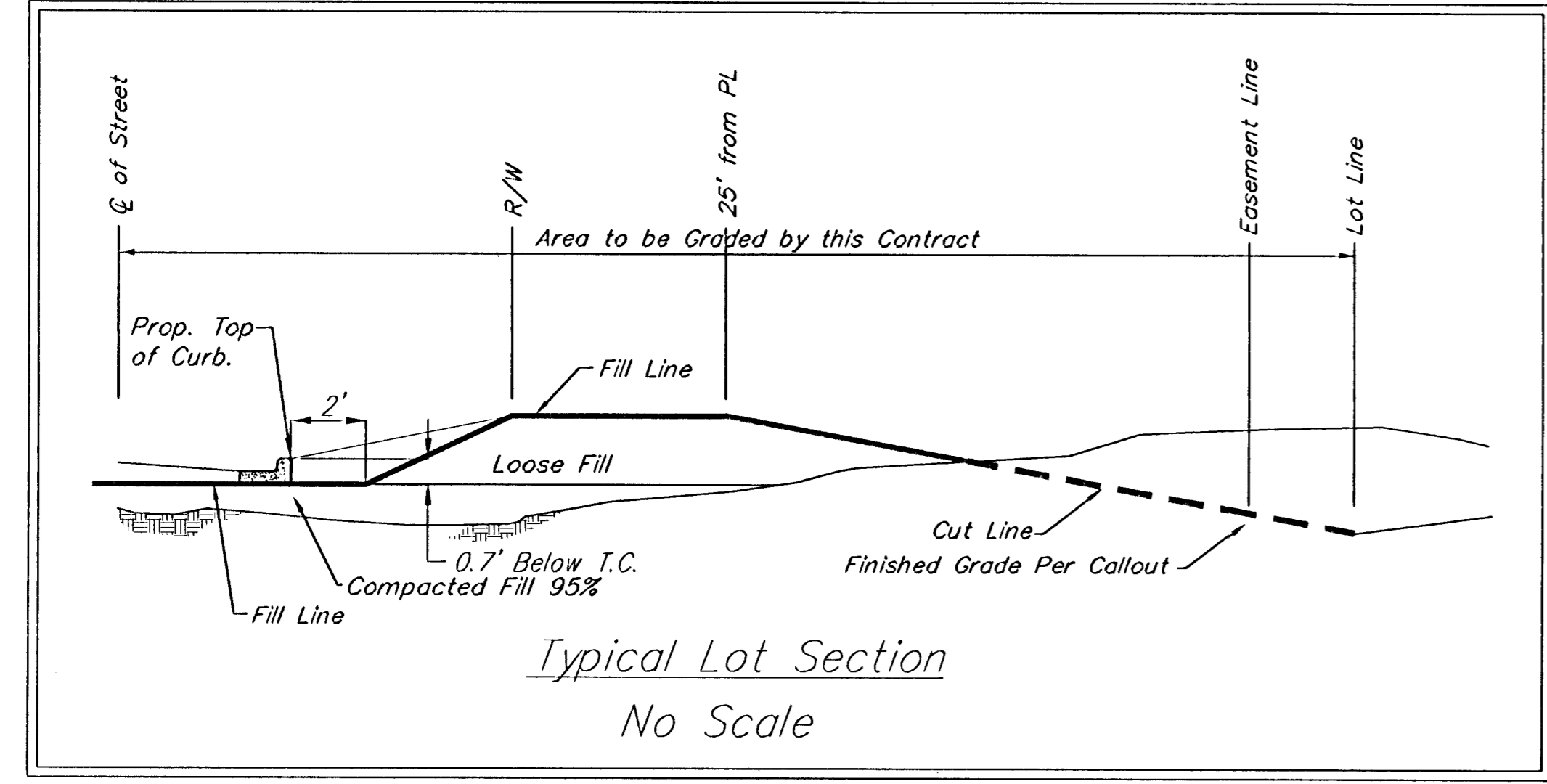

EARTH WORK TOTALS

| | C.Y. Excavation | C.Y. Fill |
|-------------------|-----------------|----------------|
| Mass Grading | 29,517 | 104,290 |
| Pond Construction | 77,774 | 198 |
| Total | 107,291 | 104,488 |

Stockpile excess material on-site at a location determined by the Engineer out of easements and right-of-way. Earthwork quantities are for reference only. All cost associated with mass grading shall be incidental to lump sum bid item "Mass Grading".

- Contractor to strip top 3" of soil within Res. "B" and street R/W before mass grading and stockpile. Top soil stockpile to be redistributed over Reserve "B" above water surface.
- Compaction of 95% shall be obtained in all street R/Ws, 90% in all other areas.
- Only trees within the street R/W or Res. "B" may be removed if necessary for grading. All other trees shall be protected from damage.
- All areas disturbed by construction (except within street R/W) shall be seeded as indicated on Pond Plan
- Area south of the gas pipeline has been rough graded by a previous project, however, area will need to be fine graded with this project along with remaining area north of pipeline.

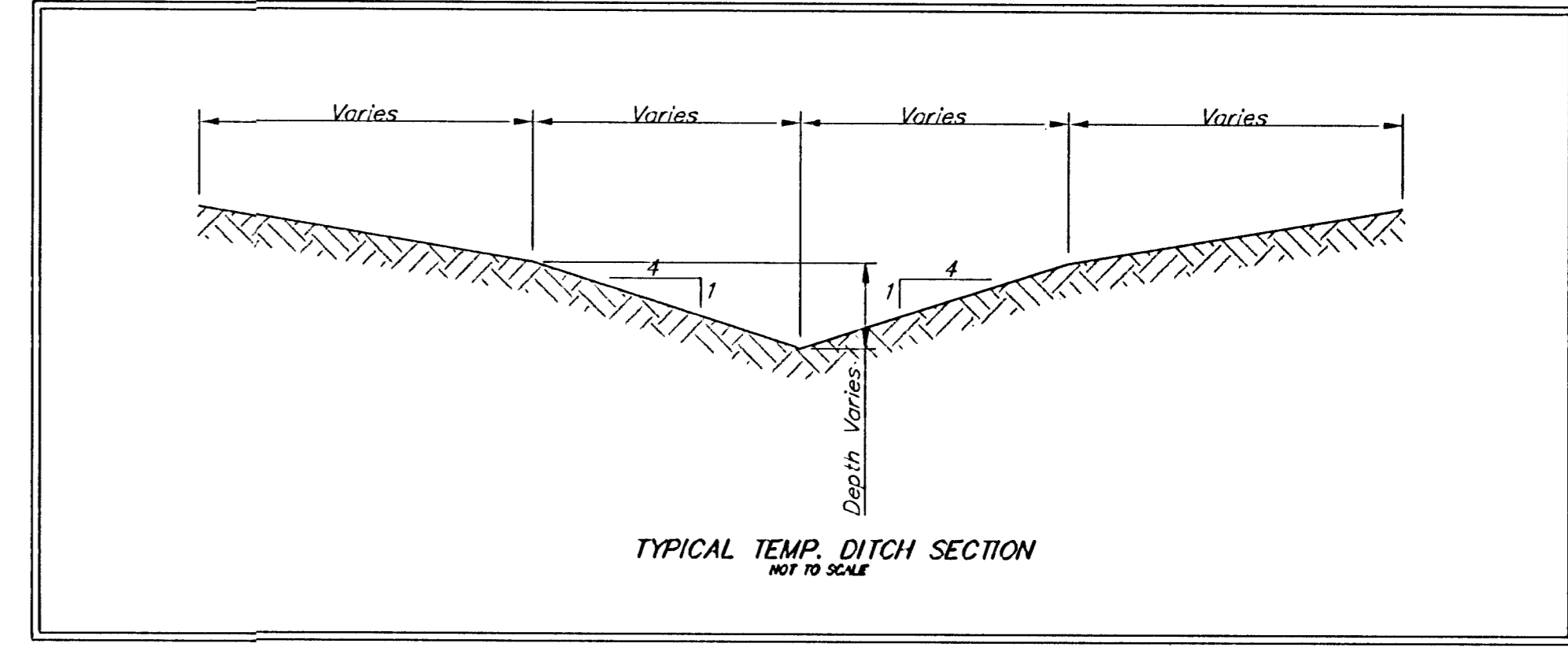

Remove trees only as necessary for construction and only with permission of Developer or Baughman Co. Cost of removal to be incidental to lump sum bid item "Site Clearing & Restoration".

Baughman KRUG NORTH 2ND/KRUG NORTH ADD. - PH. II
MASS GRADING PLAN
 WICHITA, KANSAS

Baughman Company, P.A. 315 Ellis St. Wichita, KS 67211 P 316-262-7111 F 316-262-6149
 ENGINEERING | SURVEYING | PLANNING | LANDSCAPE ARCHITECTURE

| | |
|-----------------------------|----------------|
| PROJECT NUMBER 468-83793 | DESIGN TMS |
| REVISIONS | DRAWN TMS |
| | DATE 07/05 |
| | APPROVED |
| | SCALE Noted |
| | SHEET |

4 OF 28

KrugNorth2nd\Phase1\Mass3 05-04-E228