

Q CURVE DATA
 $A=10^{\circ}58'31''$ $D=9^{\circ}32'57.5''$ $R=600.00'$ $L=114.87'$ $T=57.61'$ $E=2.75'$
 CURVE DATA BASED ON Q radius $\Delta/2=5^{\circ}29'4''$

Q STATION	Q ARC LENGTH	FACE CURB LENGTH		CHORD LENGTH		DEFLECTION ANGLE	Q TOTAL DEFLECTION
		LEFT CURB	RIGHT CURB	8' OFF LEFT FACE CURB	8' OFF RIGHT FACE CURB		
9+95.46						0°00'00.0"	0°00'00.0"
10+00.00	4.54'	4.43'	4.85'	4.37'	4.71'	00°13'4"	00°13'4"
10+05.00	5.00'	4.88'	5.12'	4.82'	5.18'	00°14'19.4"	00°27'19.8"
10+10.00	5.46'	4.83'	5.37'	4.77'	5.64'	00°57'17.7"	01°24'37.6"
10+15.00	5.92'	4.78'	5.62'	4.72'	6.11'	01°11'37.2"	02°38'14.7"
10+20.00	6.38'	4.73'	5.87'	4.67'	6.58'	01°11'37.2"	03°47'51.9"
10+25.00	6.84'	4.68'	6.12'	4.62'	7.05'	00°29'35.6"	05°29'4"
11+10.33	10.33'	10.57'	11.55'	10.70'	10.70'		
TOTAL	114.87'	112.19'	117.55'				

Defl./ft. = 2.864789 min.

WATER VALVE BOX ELEVATIONS

STREET	STATION	OFFSET	PROPOSED ELEVATION
PARKDALE	11+92.2	19.5' LL	174.66
PARKDALE	11+94.7	26.5' LL	175.4

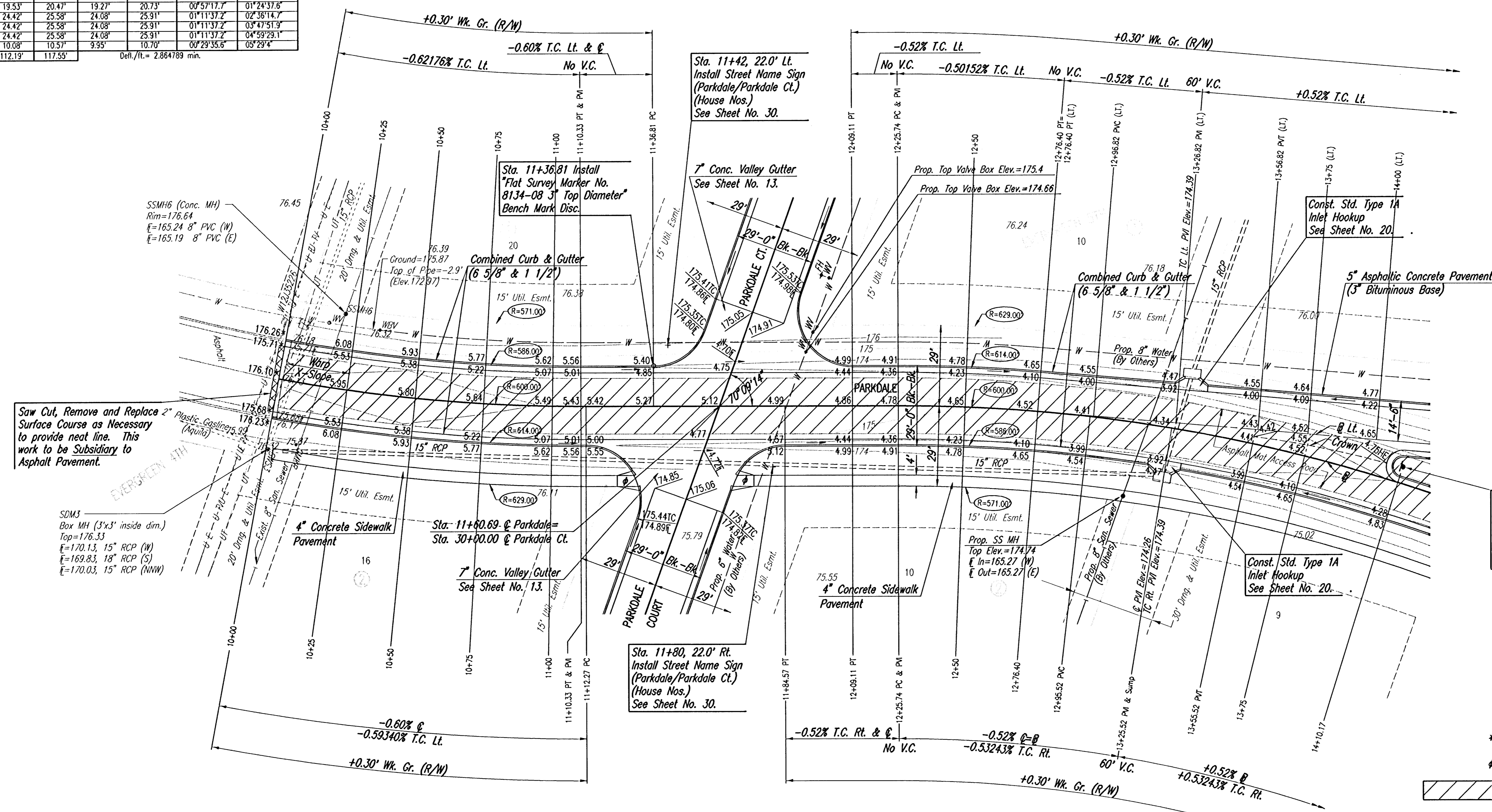
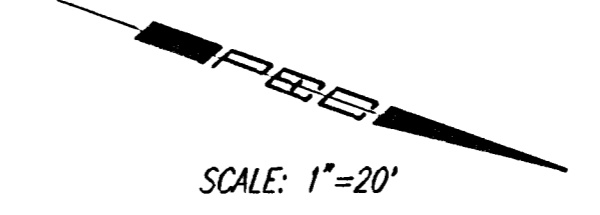

Saw Cut, Remove and Replace 2\"/>

SDM3
Box MH (3'x3' inside dim.)
Top=176.33
E=170.13, 15\"/>

Sta. 11+60.69 @ Parkdale=
Sta. 30+00.00 @ Parkdale Ct.

Sta. 11+80, 22.0' Rt.
Install Street Name Sign
(Parkdale/Parkdale Ct.)
(House Nos.)
See Sheet No. 30.

Q CURVE DATA
 $A=19^{\circ}50'46''$ $D=9^{\circ}32'57.5''$ $R=600.00'$ $L=207.83'$ $T=104.97'$ $E=9.11'$
 CURVE DATA BASED ON Q radius $\Delta/2=9^{\circ}55'23''$

Q STATION	Q ARC LENGTH	FACE CURB LENGTH		CHORD LENGTH		DEFLECTION ANGLE	Q TOTAL DEFLECTION
		LEFT CURB	RIGHT CURB	8' OFF LEFT FACE CURB	8' OFF RIGHT FACE CURB		
12+25.74						0°00'00.0"	0°00'00.0"
12+30.00	4.26'	4.15'	4.57'	4.09'	4.43'	00°09'30.0"	00°09'30.0"
12+35.00	4.72'	4.10'	4.82'	4.04'	4.88'	01°11'37.2"	02°21'07.2"
12+40.00	5.18'	4.05'	5.07'	3.99'	5.33'	00°04'5"	02°25'07.8"
12+45.00	5.64'	4.00'	5.32'	3.94'	5.78'	01°07'36.5"	03°32'44.4"
12+50.00	6.10'	3.95'	5.57'	3.89'	6.23'	01°11'37.2"	04°44'21.8"
12+55.00	6.56'	3.90'	5.82'	3.84'	6.68'	00°01'29.4"	04°45'50.9"
12+60.00	7.02'	3.85'	6.07'	3.79'	7.13'	01°10'07.8"	05°55'58.7"
12+65.00	7.48'	3.80'	6.32'	3.74'	7.58'	01°11'37.2"	07°07'35.9"
12+70.00	7.94'	3.75'	6.57'	3.69'	8.03'	01°11'37.2"	08°19'13.1"
12+75.00	8.40'	3.70'	6.82'	3.64'	8.48'	00°29'08.1"	08°48'21.2"
12+80.00	8.86'	3.65'	7.07'	3.59'	8.93'	01°10'07.8"	09°30'50.3"
12+85.00	9.32'	3.60'	7.32'	3.54'	9.38'	00°42'29.1"	09°30'50.3"
12+90.00	9.78'	3.55'	7.57'	3.49'	9.83'	00°24'33.1"	09°55'23.0"
TOTAL	207.83'	51.84'	202.98'				

Defl./ft. = 2.864789 min.

Sta. 14+10.17, 6.0' Lt.
Install Traffic Sign
(R4-7)(Keep Right)
(OM-1)(Object Marker)
on Single Post
See Sheet No. 30.

* Match Existing

Construct Std. Wheelchair Ramp

Asphalt Mat Removal (5" Thickness)
(Paid for as "Unclassified Excavation")

DSNR: BLS OPER: BJS SCALE: 1"=20.00
 C:\2005\05\15\100108415-00-C-STR10-14 11-28-2005 09:16:24 am

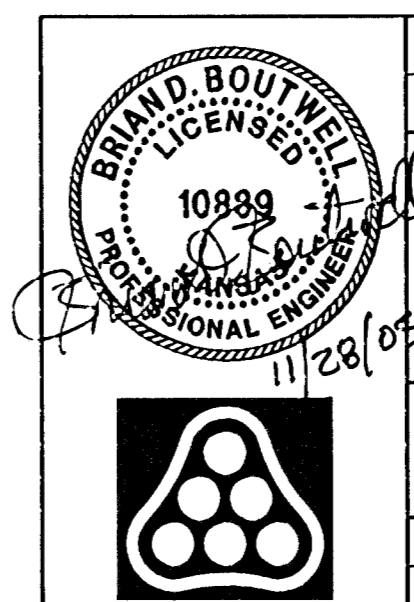

No.	Revision	By	Date
	EVERGREEN 5TH		
PARKDALE			
STA. 10+00 TO STA. 14+00			
JAMES L. ARMOUR, P.E.—CITY ENGINEER CITY OF WICHITA PROJECT NO. 472-84103			
Professional Engineering Consultants, P.A.			
303 S. TOPEKA • WICHITA, KANSAS 67202 316-262-2691 • FAX 316-262-3003			
Designed by	BDB, BMM	Job No.	35-05415-000
Drawn by	BJS, BMM	Date	July 2005
			Sheet 7 of 45