

WICHITA, KANSAS
Pool Improvements
COLLEGE HILL PARK

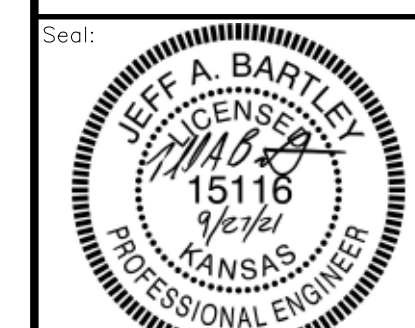

Jeff Bartley - ENGINEER
LICENSE #15116

Date: 09-27-21 Job #: 18-512

Drawn: SRS Checked: JAB

Issue: CONSTRUCTION DOCUMENTS

POOL AREA DETAILS

SP-PM3

LAP LENGTH SCHEDULE		
BAR SIZE	LAP LENGTH	HOOK LENGTH
#3	19"	7"
#4	26"	10"
#5	31"	12"
#6	37"	15"
#7	54"	17"
#8	62"	19"

- NOTES:
- Bar lap length of smaller diameter bar shall be used when splicing different size bars.
 - Lap splices shall be wired in contact.
 - Tabulated values are based on 4000 psi, normal weight concrete with Grade 60 reinf.

CONCRETE PROTECTION FOR REINFORCEMENT

CONDITION	MIN. COVER (INCHES)
Concrete cast against and permanently exposed to earth, subgrade, or granular fill	3"
Formed or top surfaces exposed to weather, submerged, or in contact with earth, including stirrups, ties, or spirals	2"
Formed concrete not exposed to earth, liquids, or weather:	
Slabs, walls, and joists	1 1/2"
Beams and columns primary reinforcement, ties, stirrups, and spirals	1 1/2"

- NOTES:
- The above minimum concrete cover shall be provided for reinforcement unless noted otherwise.
 - Placing reinforcement tolerances:
 - For members less than or equal to 8" Tolerance = (± 1/8")
 - For members greater than 8" Tolerance = (± 1/2")

GENERAL SHEET NOTES

- All El.'s shown (-).xx', are distances down from indicated Water El.
- All El.'s shown (+).xx', are distances up from indicated Water El.
- Form savers may be used at Contractor's option
- Hold waterstop 1 1/2" clear Min. from reinforcing. Tie to reinforcing/tie rod @ 6" O.C.
- All form ties shall be 1 1/2" deep, cone snap type

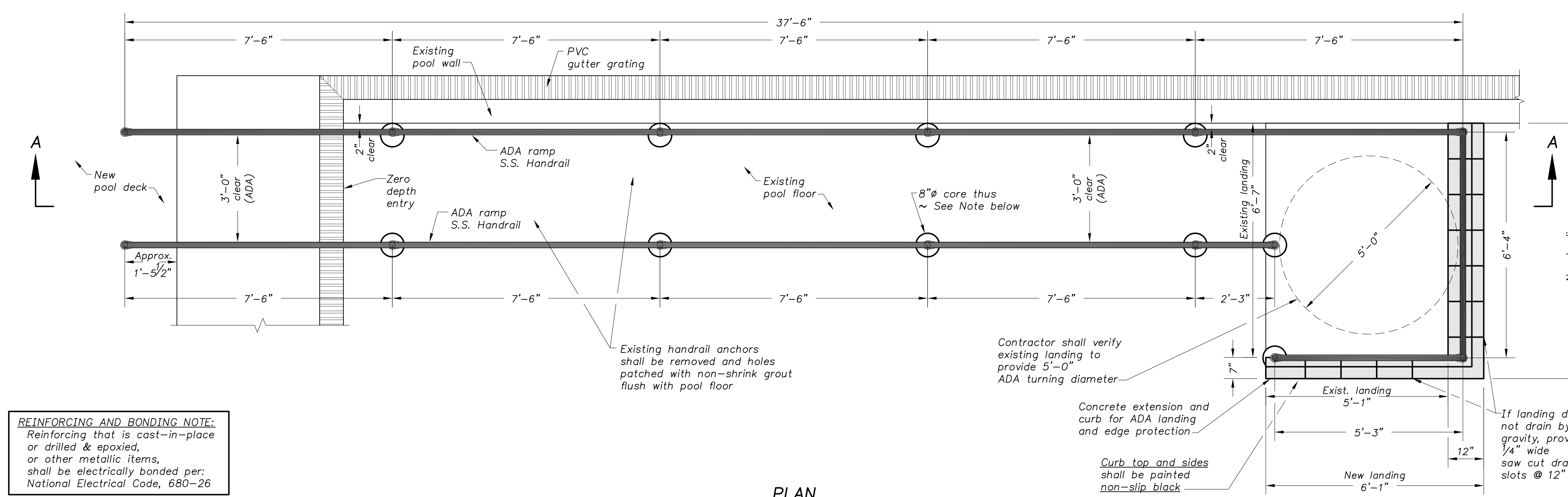

REINFORCING AND BONDING NOTE:
Reinforcing that is cast-in-place or drilled & epoxied, or other metallic items, shall be electrically bonded per: National Electrical Code, 680-26

PLAN

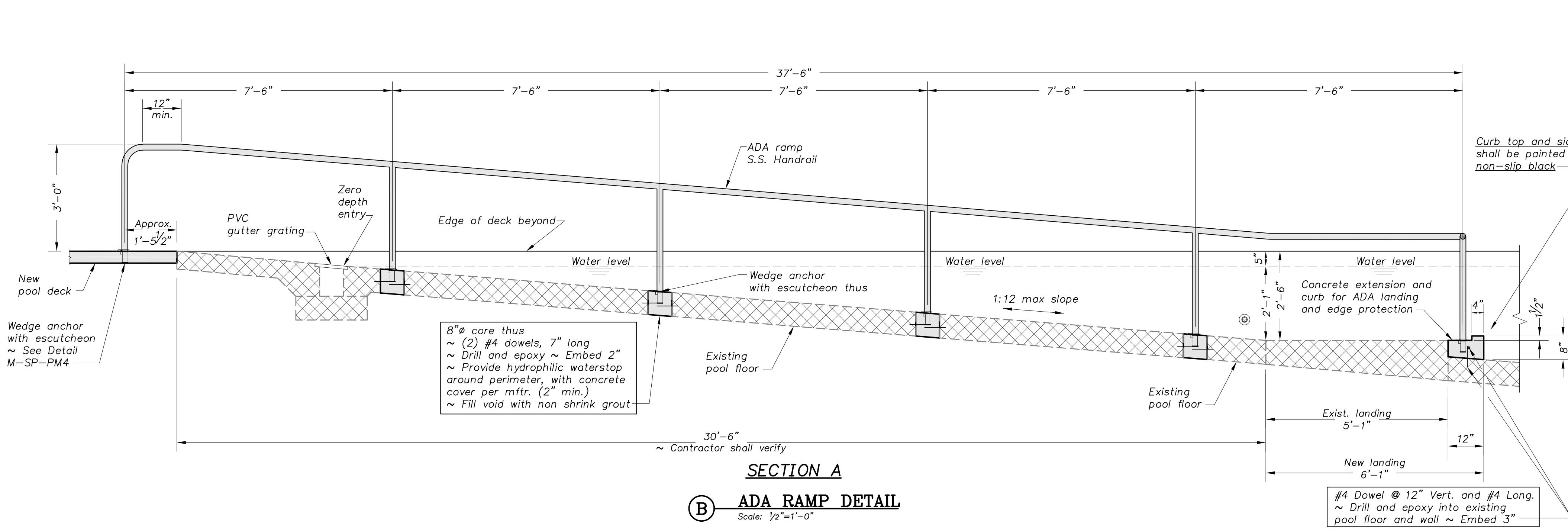

SECTION A

ADA RAMP DETAIL
Scale: 1/2"=1'-0"

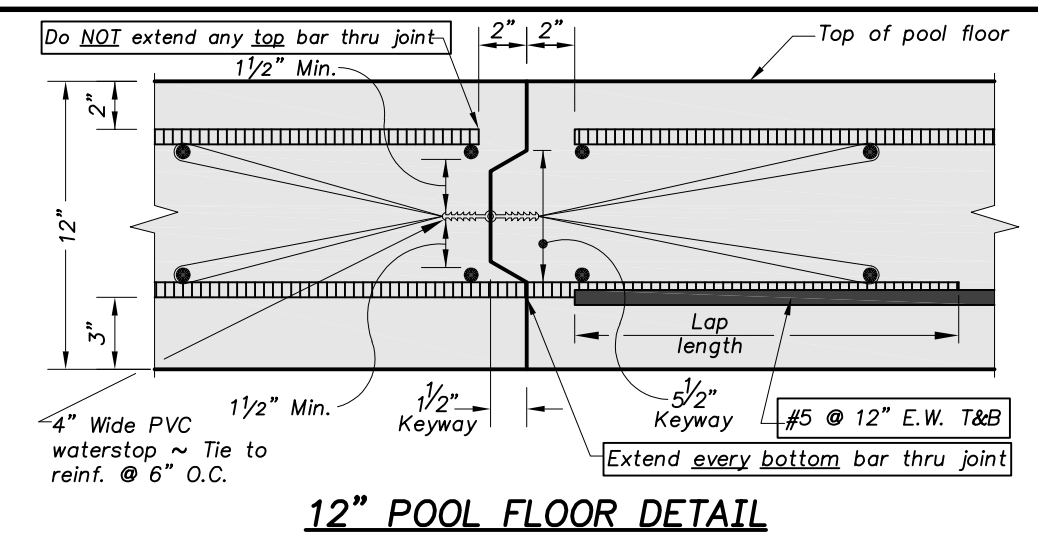

POOL FLOOR DETAILS
Scale: 1/2"=1'-0"

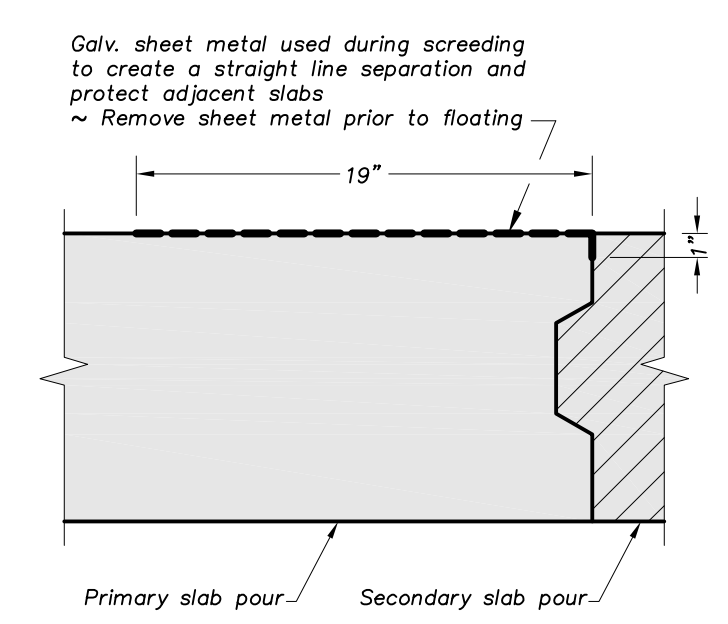

SLAB FINISH PROTECTION STRIP

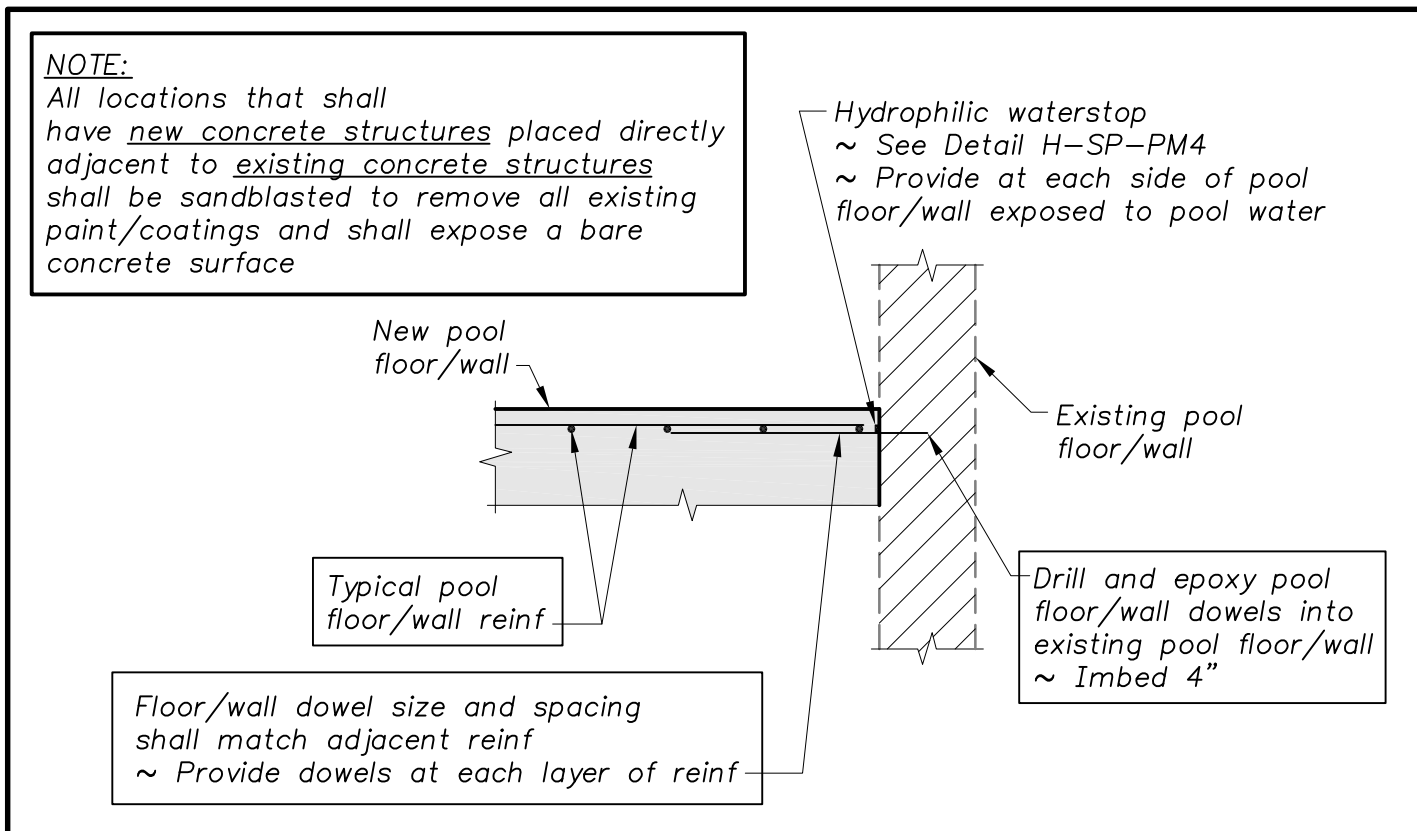

POOL FLOOR/WALL AT EXISTING POOL FLOOR/WALL JOINT DETAIL
Scale: 1/2"=1'-0"

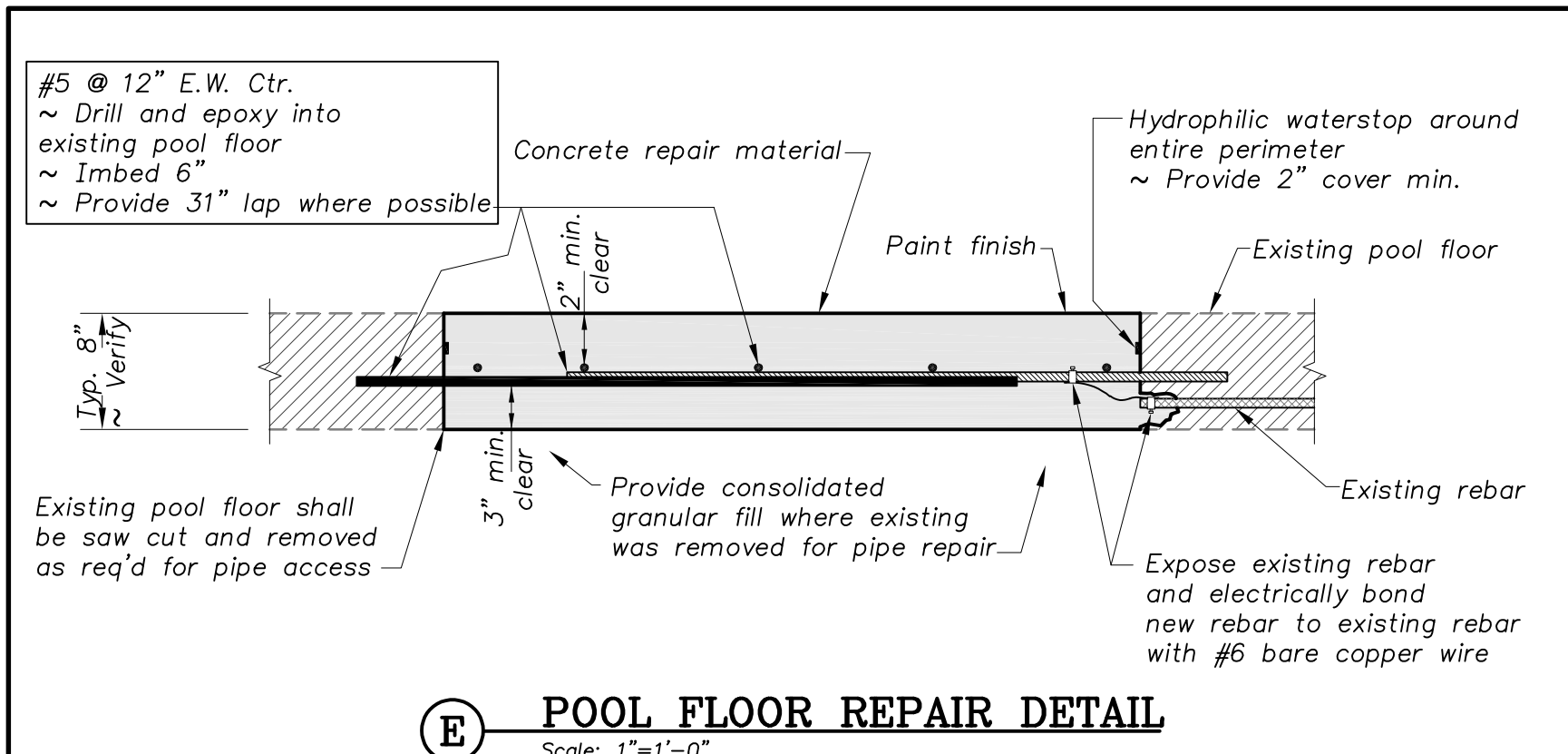

POOL FLOOR REPAIR DETAIL
Scale: 1"=1'-0"