

PAWNEE

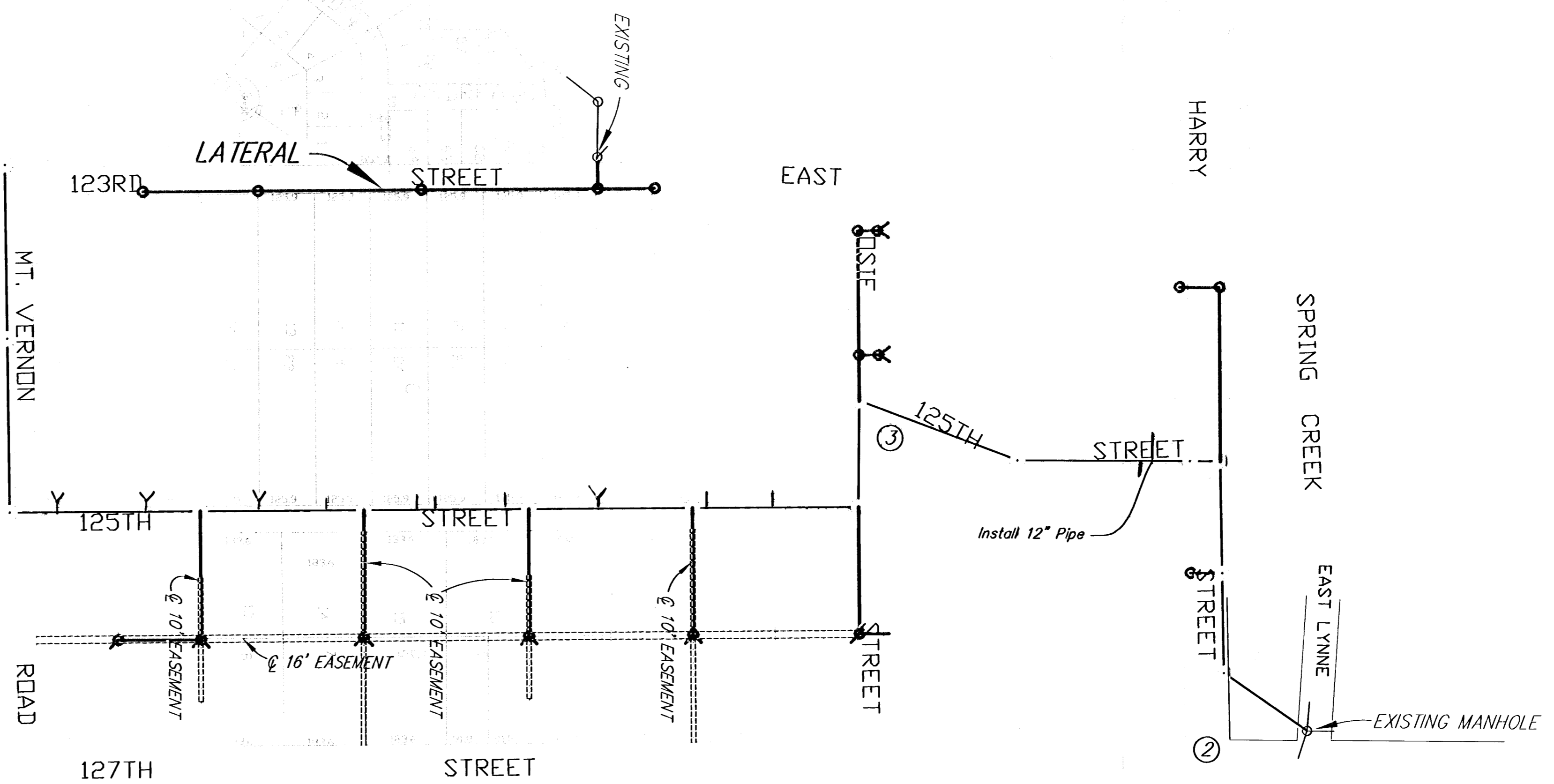
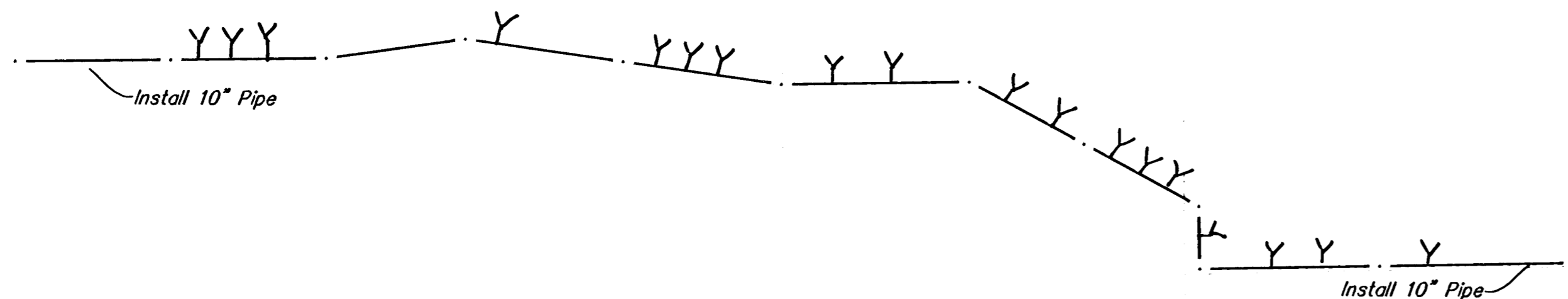
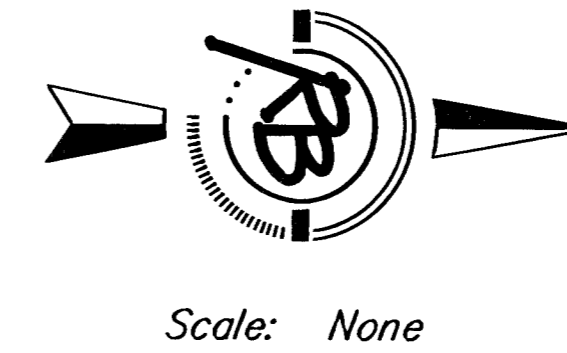

SEWER SERVICE TABLE

NUMBER	TYPE	LOCATION			LINE NO.	STATION	APPROXIMATE LENGTH 4" PIPE		
		LOT NO.	BLOCK NO.	ADDITION NAME			DIRECTION	VERTICAL	HORIZONTAL
1	Single Wye Cleanout w/risers	29	C	McEvoy	1	30+95/Rt. 3	+17.5	11'	
2	Double Wye Cleanout w/risers	27, 28	C	McEvoy	1	33+48/Rt.	14'	-11' 10'	
3	Single Wye Cleanout w/risers	25	C	McEvoy	1	36+40/Rt. 99	12'	-12' 10'	
4	Single Wye Cleanout w/risers	24	C	McEvoy	1	37+64/Lt. 32	11'	-12' 10'	
5	Double Wye Cleanout w/risers	25-22	3	McEvoy	1	39+77/Rt. 71	11'	-13' 10'	
6	Double Wye Cleanout w/risers	19-20	11	McEvoy	1	42+28/Rt. 113	11'	-19' 10'	
7	Single Wye Cleanout w/riser	18	17	20C	McEvoy	1	43+80/Rt. 44	11'	20' 10'
8	Single Wye Cleanout w/risers	2X12	C	McEvoy	1	45+88/Rt. 23	11'	-20' 10'	
9	Double Wye Cleanout w/risers	4, 5	6	Tara Falls	1	55+47/Rt.	8'	5'	
10	Double Wye Cleanout w/risers	3+2	6	Tara Falls	1	56+07/Rt. 57	7'	5'	
11	Double Wye Cleanout w/riser	1, 2	6	Tara Falls	1	56+87/Rt. 57	6'	5'	
12	Double Wye Cleanout w/risers	1	3	Casa Bella	1	60+99/Rt.	4'	5'	
13	Double Wye Cleanout w/risers	2, 3	3	Casa Bella	1	61+96/Rt.	4'	5'	
14	Single Wye Cleanout w/risers	4, 5	3	Casa Bella	1	63+46/Lt.	4'	5'	
15	Double Wye Cleanout w/risers	6, 7	3	Casa Bella	1	64+96/Rt.	4'	5'	
16	Double Wye Cleanout w/risers	8, 9	3	Casa Bella	1	66+70/Rt.	4'	5'	
17	Single Wye Cleanout w/riser	10, 11	3	Casa Bella	1	68+08/Rt.	4'	5'	
18	Single Wye Cleanout w/risers	12, 13	3	Casa Bella	1	69+60/Rt.	6'	5'	
19	Double Wye Cleanout w/risers	1, 2	3	Casa Bella	1	71+40/Rt.	6'	5'	
20	Double Wye Cleanout w/risers	3, 4	3	Casa Bella	1	73+50/Rt.	6'	5'	
21	Double Wye Cleanout w/riser	8	3	Casa Bella	1	74+64/Rt.	6'	5'	
22	Double Wye Cleanout w/risers	1, 2	6	Casa Bella	1	77+32/Rt.	8'	5'	
23	Single Wye Cleanout w/risers	3	6	Casa Bella	1	78+48/Rt.	7'	5'	
24	Double Wye Cleanout w/risers	4, 5	6	Casa Bella	1	79+71/Rt.	6'	5'	

NOTE: Vertical Riser Pipe shall be extended to 2' minimum above ground water elevation and 4' maximum below proposed ground elevation.

25	Single Wye Cleanout w/risers	1	C	McEvoy	1	29+42/Rt.		10'
26	Single Wye Cleanout w/risers	2a	C	McEvoy	1	35+48/Rt.		10'
27	Single Wye Cleanout w/risers	1	B	McEvoy	1	20+11/Rt.		38'
28	Single Wye Cleanout w/risers	3	A	McEvoy	1	20+13/Lt.		12'

Note: Risers in McEvoy Addition (4") are located 7' from main, 3' from C.O.
Risers in Tara Falls and Casa Bella are 2' from main, 3' from B" C.O.

HORIZONTAL CONTROL

MANHOLE NUMBER	STATION	NORTHING	EASTING
MH 1 - 1	STA 12+45.25	N 20,042.08	E 22,406.59
MH 1 - 2	STA 14+24.91	N 20,042.08	E 22,226.93
MH 1 - 3	STA 16+79.39	N 20,042.08	E 21,972.58
MH 1 - 4	STA 18+03.39	N 19,918.08	E 21,972.58
MH 1 - 5	STA 21+44.13	N 19,577.41	E 21,979.28
MH 1 - 6	STA 25+17.13	N 19,232.37	E 21,837.59
MH 1 - 7	STA 27+60.63	N 19,232.37	E 22,081.09
MH 1 - 8	STA 31+32.84	N 18,860.16	E 22,079.31
MH 1 - 9	STA 35+00.04	N 18,492.97	E 22,077.56
MH 1 - 10	STA 38+67.24	N 18,125.78	E 22,075.80
MH 1 - 11	STA 42+39.49	N 17,753.58	E 22,082.12
MH 1 - 12	STA 45+74.44	N 17,418.62	E 22,081.41
MH 1 - 13	STA 46+84.81	N 17,308.26	E 22,081.07
MH 1 - 14	STA 50+74.81	N 17,308.48	E 21,691.07
MH 1 - 15	STA 54+66.40	N 17,308.70	E 21,299.48
MH 1 - 16	STA 56+27.36	N 17,147.74	E 21,299.04
MH 1 - 17	STA 59+37.38	N 16,837.72	E 21,298.20
MH 1 - 18	STA 60+68.47	N 16,714.82	E 21,252.59
MH 1 - 19	STA 61+26.31	N 16,714.87	E 21,194.75
MH 1 - 20	STA 64+23.94	N 16,454.32	E 21,050.88

HORIZONTAL CONTROL

MANHOLE NUMBER	STATION	NORTHING	EASTING
MH 1 - 21	STA 65+65.38	N 16,330.50	E 20,982.51
MH 1 - 22	STA 68+81.29	N 16,014.60	E 20,982.14
MH 1 - 23	STA 70+40.75	N 15,836.99	E 20,957.93
MH 1 - 24	STA 74+00.37	N 15,492.64	E 20,901.95
MH 1 - 25	STA 75+79.04	N 15,324.95	E 20,927.75
MH 1 - 26	STA 76+39.09	N 15,263.10	E 20,932.73
MH 1 - 27	STA 78+91.56	N 15,012.64	E 20,932.30
MH 1 - 28	STA 80+56.56	N 14,847.64	E 20,932.01
MH 1 - 29	STA 81+73.84	N 14,732.68	E 20,908.81

HORIZONTAL CONTROL

Point	Description	Northing	Easting
①	SM 1/2" ip. 1/4 Corner	N 20,000.00	E 20,000.00
②	SM 3/4" ip Northeast Sec. Cor.	N 20,000.01	E 22,658.71
③	SM 1/2" rb	N 19,282.16	E 21,869.25

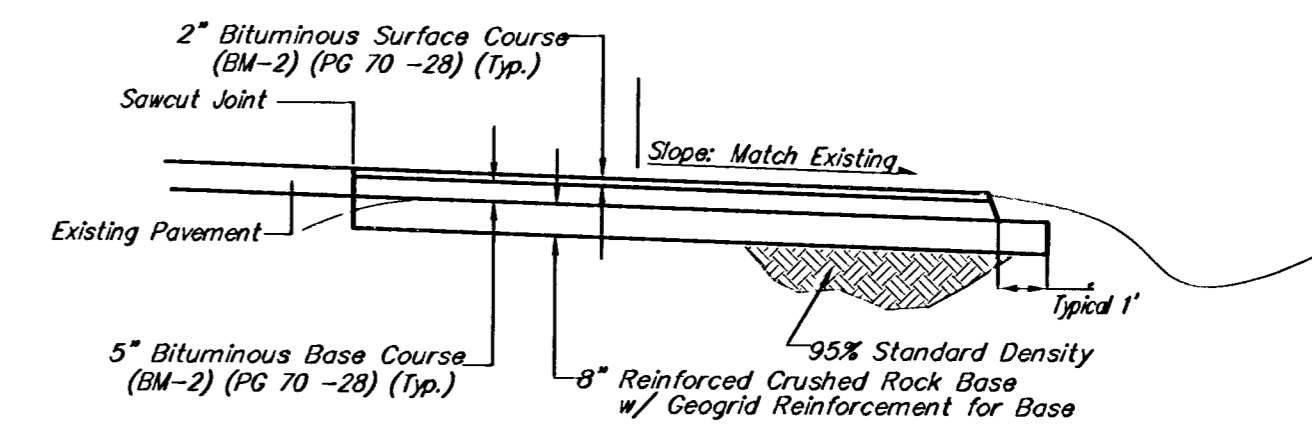

PAVEMENT PLACEMENT DETAIL

MCEVOY SEWER MAIN KEY MAP

Ruggles & Bohm, P.A.
Engineering, Surveying, Land Planning
224 North Main
Wichita, Kansas 67203
www.rkansas.com
(316) 264-0008
(316) 264-4821 fax
E-mail: info@rkansas.com

DATE	PROJECT NUMBER	DATE
12/13/05	468-84026	10/8/05

Sheet 2 of 17