

SE 1/4, SEC. 29, T 26 S, R 1 E

MH 1 - 7
STA. 27+60.63 LINE 1
CONSTRUCT STD TYPE P MH
TOP = 1323.65
8" STUB (E) = 1314.27

STA. 18+75 LINE 1
REMOVE AND REPLACE EXISTING DRIVEWAY
INSTALL 24" X 12" CMP
FL (N) = 1318.89
FL (S) = 1318.88

STA. 21+28 LINE 1
REMOVE AND REPLACE EXISTING DRIVEWAY

MH 1 - 5
STA. 21+44.13 LINE 1
CONSTRUCT STD TYPE P MH
TOP = 1320.22

C-52846
FOSTER, BARBARA M., REVOCABLE TR.
405 CLEVELAND

MH 1 - 4
STA. 18+03.39 LINE 1
CONSTRUCT STD TYPE P MH
TOP = 1320.15

MH 1 - 3
STA. 16+79.39 LINE 1
SEE SHEET NO. 3

STA. 16+99 TO STA. 17+59
THE CONTRACTOR SHALL BORE
HARRY RD.

STA. 17+59 TO STA. 20+16
THE CONTRACTOR SHALL REMOVE
AND REPLACE PAVEMENT.
SEE SHEET NO. 2

C-52847
CRAW, PAUL R. ETUX
12517 E. HARRY

C-52848
CRAW, PAUL R. ETUX
12517 E. HARRY

STA. 21+96 TO STA. 24+61
THE CONTRACTOR SHALL REMOVE
AND REPLACE PAVEMENT.
SEE SHEET NO. 2

MH 1 - 6
STA. 25+17.13 LINE 1
CONSTRUCT STD TYPE P MH
TOP = 1322.68
8" STUB (W) = 1310.11

THE CONTRACTOR SHALL GRADE THE DITCH TO MAINTAIN POSITIVE DRAINAGE.
ALL COSTS SHALL BE SUBSIDIARY TO OTHER BID ITEMS.

THE CONTRACTOR SHALL REMOVE AND REPLACE
THE EXISTING ROADWAY TO CITY STANDARDS.

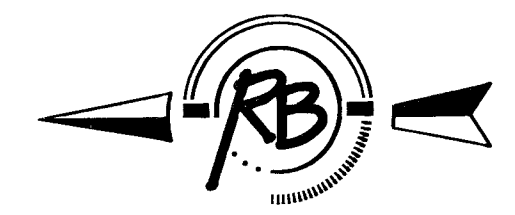

Scale 1" = 40' (Horiz.)
1" = 5' (Vert.)

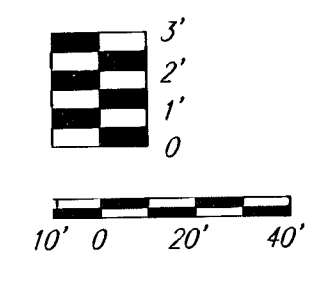

MCEVOY
ADD.

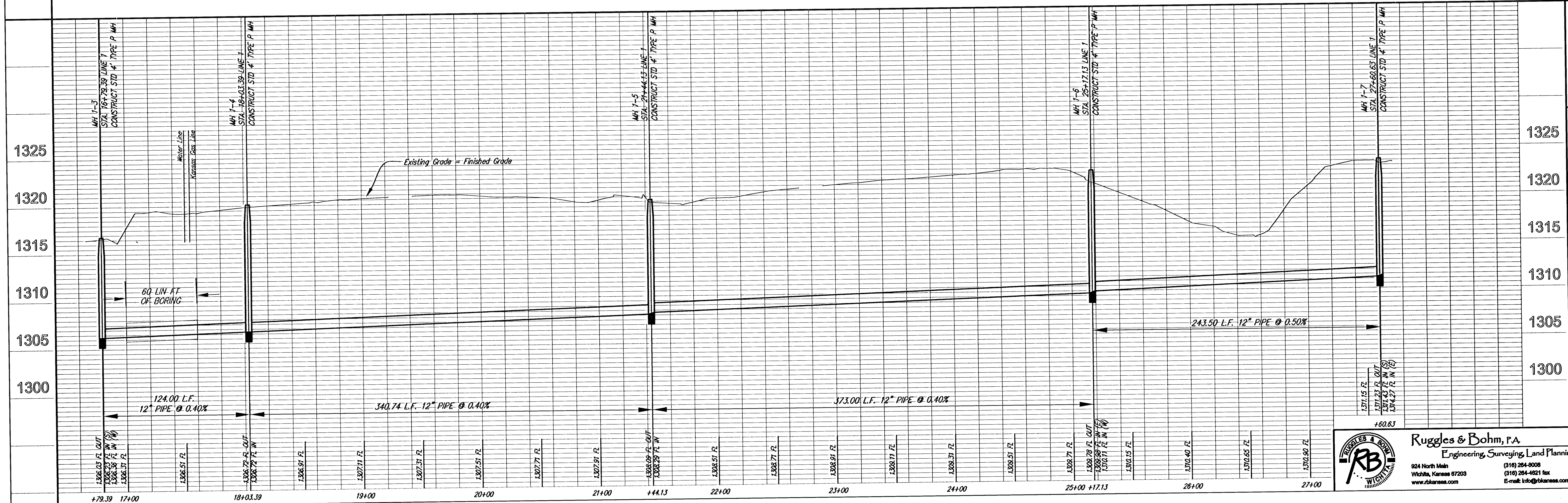

PROJECT NUMBER 468-84026	DESIGN PDC UTILITY	DESIGN PDC DATE 9/26/05	REVISION REVISION 11/17/05
DRAWING FILE enrgp_bose		SANITARY SEWER MAIN LINE 1, MCEVOY WICHITA, KANSAS	
1325			
1320			
1315			
1310			
1305			
1300			

Ruggles & Bohm, P.A.
Engineering, Surveying, Land Planning

824 North Main
Wichita, Kansas 67203
www.rbkansas.com

(316) 264-9008
(316) 264-4821 fax
E-mail: info@rbkansas.com

PROJ NO.
2612X
SHEET
4
OF
17