

**BENCHMARKS:**  
 BM #1: Chiseled square on NW corner of catch basin, 262.2' W. & 35.9' N. of S1/4 Cor., Sec. 1, TWP. 27-S., R-2-E.  
 Elev. = 1361.76 NAVD88

BM #2: Chiseled square on NW corner of catch basin, 962.0' W. & 35.8' N. of S1/4 Cor., Sec. 1, TWP. 27-S., R-2-E.  
 Elev. = 1363.84 NAVD88

BM #3: Chiseled square on NW corner of catch basin, 160.0' E. & 24.3' S. of SW Cor., Lot 13, Block A, NRD Addition.  
 Elev. = 1369.05 NAVD88

WL Sta. 0+00.00 to 5+62.41  
 = Entrance street improvement project.  
 WL Sta. 5+62.41 to 8+01.59  
 = Phase I street improvement project.

Baseline = CL Sagebrush

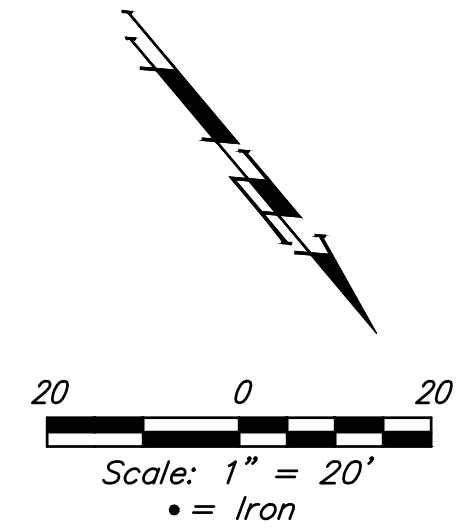

**Curve #3R**  
 Curve Data Based on Face of Curb  
 Rad. = 117.5' Delta = 81°48'32" Tangent = 101.80'  
 Arc = 167.77' L.C. = 153.88' Def./Ft. = 14.62876 Min.

Chord Lengths	Station	Arc	8' Right	Defl.	Total Defl.
D	-	-	-	0°00'00"	0°00'00"
E	6.87'	7.34'	1°40'30"	1°40'30"	1°40'30"
F	28.51'	30.38'	6°57'04"	8°37'34"	8°37'34"
G	28.59'	30.46'	6°58'14"	15°35'48"	15°35'48"
H	28.70'	30.58'	6°59'51"	22°35'39"	22°35'39"
I	14.30'	15.26'	3°29'11"	26°04'50"	26°04'50"
J	14.55'	15.53'	3°32'51"	29°37'41"	29°37'41"
K	29.05'	30.95'	7°04'58"	36°42'39"	36°42'39"
L	13.74'	14.67'	3°21'00"	40°03'39"	40°03'39"
M	3.46'	3.70'	0°50'37"	40°54'16"	40°54'16"

**Curve #3L**  
 Curve Data Based on Face of Curb  
 Rad. = 82.5' Delta = 81°48'32" Tangent = 71.47'  
 Arc = 117.80' L.C. = 108.04' Def./Ft. = 20.83418 Min.

Chord Lengths	Station	Arc	8' Left	Defl.	Total Defl.
N	-	-	-	0°00'00"	0°00'00"
O	5.18'	4.68'	1°47'55"	1°47'55"	1°47'55"
P	21.48'	19.34'	7°27'31"	9°15'26"	9°15'26"
Q	21.42'	19.29'	7°26'16"	16°41'42"	16°41'42"
R	21.30'	19.18'	7°23'47"	24°05'29"	24°05'29"
S	10.52'	9.49'	3°39'10"	27°44'39"	27°44'39"
T	10.63'	9.59'	3°41'28"	31°26'07"	31°26'07"
U	20.95'	18.87'	7°16'29"	38°42'36"	38°42'36"
V	6.32'	5.71'	2°11'40"	40°54'16"	40°54'16"

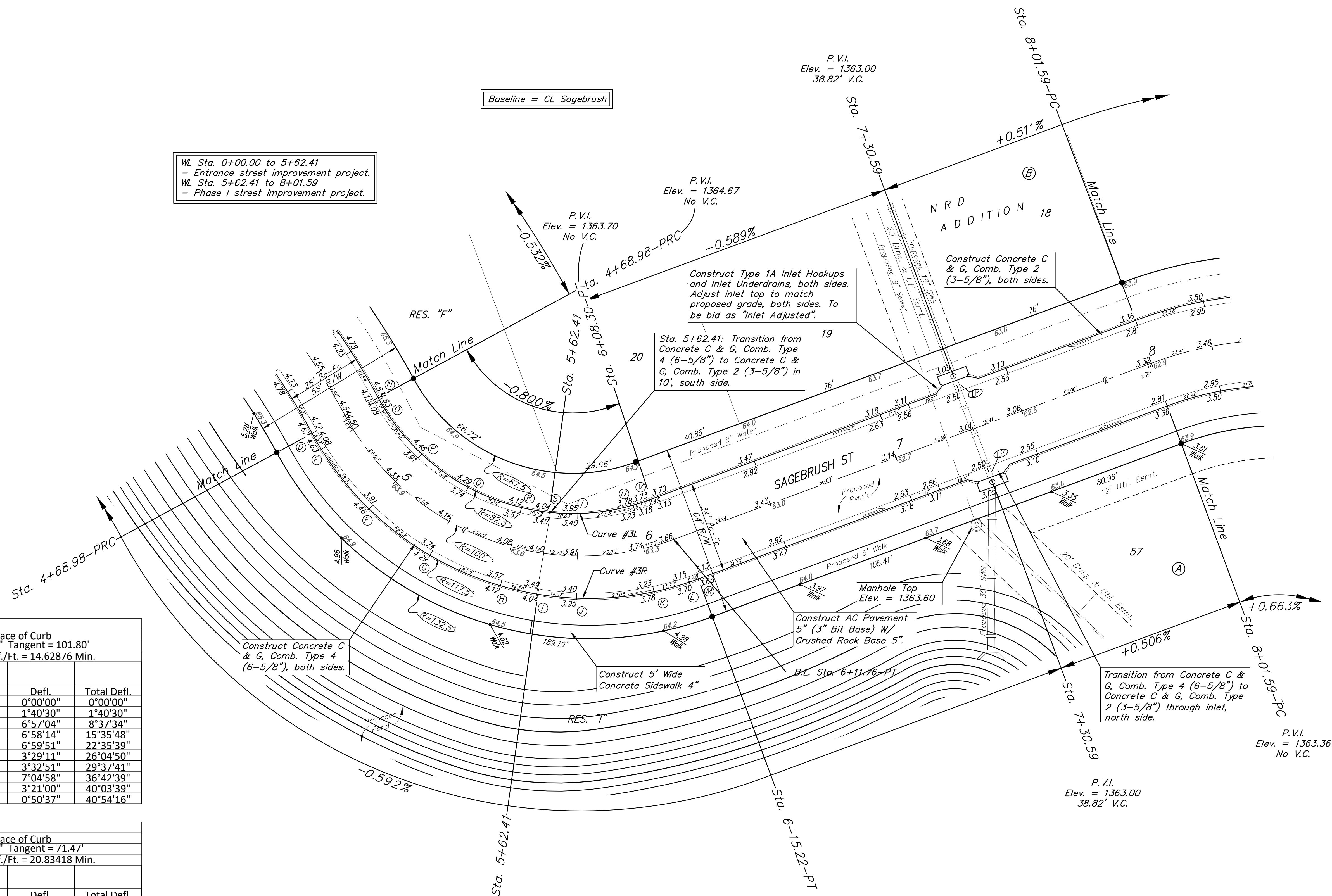

NOTE: ROLL TYPE CURB & GUTTER (TYPE 2) TO BE CONSTRUCTED ON PART OF THE PAVEMENT SHOWN ON THIS SHEET. TOP OF CURB ELEVATIONS ARE GIVEN FOR FULL HEIGHT CURB (TYPE 4).

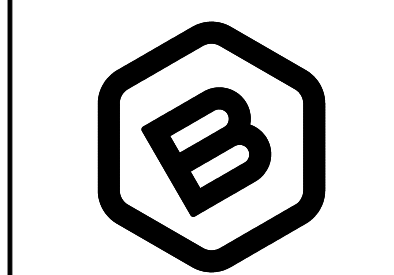

**BAUGHMAN COMPANY**  
 315 Ellis St.  
 Wichita, KS 67211  
 316-262-7271  
 BaughmanCo.com

NRD ADDITION  
 Phase I & Entrance

**SAGEBRUSH**

STREET IMPROVEMENTS

PROJECT NUMBER:  
 21-03-E868 & E869

DESIGN: NBW DRAWN: TMS

DATE: December 6, 2021

SHEET OF  
**3 47**

File: E:\Projects\NRD Addition\_19-04-P448\Engineering\Phase I\STR 21-03-E868 E869\STR.dwg