

WATER VALVE LOCATION TABLE

VALVE NUMBER	STREET	BASELINE STATION	OFFSET DISTANCE	OFFSET DIRECTION
V10	Sandpiper	23+23.78	26'	Lt.
V11	Sandpiper	23+47.43	26'	Lt.

BENCHMARKS:
 BM #1: Chiseled square on NW corner of catch basin, 962.0' W. & 35.9' N. of S1/4 Cor., Sec. 1, TWP. 27-S., R-2-E.
 Elev. = 1361.76 NAVD88

BM #2: Chiseled square on NW corner of catch basin, 962.0' W. & 35.8' N. of S1/4 Cor., Sec. 1, TWP. 27-S., R-2-E.
 Elev. = 1363.84 NAVD88

BM #3: Chiseled square on NW corner of catch basin, 160.0' E. & 24.3' S. of SW Cor., Lot 13, Block A, NRD Addition.
 Elev. = 1369.05 NAVD88

Paving contractor will be responsible to operate all water valves on the project, in the presence of the inspector, to ensure accessibility to the valves, and that all valves (except blowoffs) are left in the "ON" position when the project is completed.

Baseline = CL Sandpiper

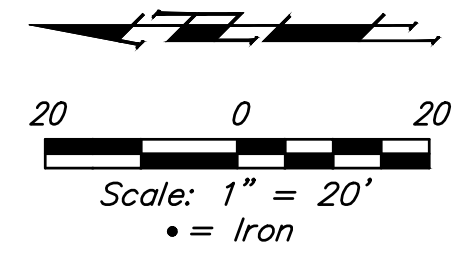

WL Sta. 21+21.17 to 21+94.80
 = Phase I street improvement project.
 WL Sta. 21+94.80 to 23+23.78
 = Entrance street improvement project.

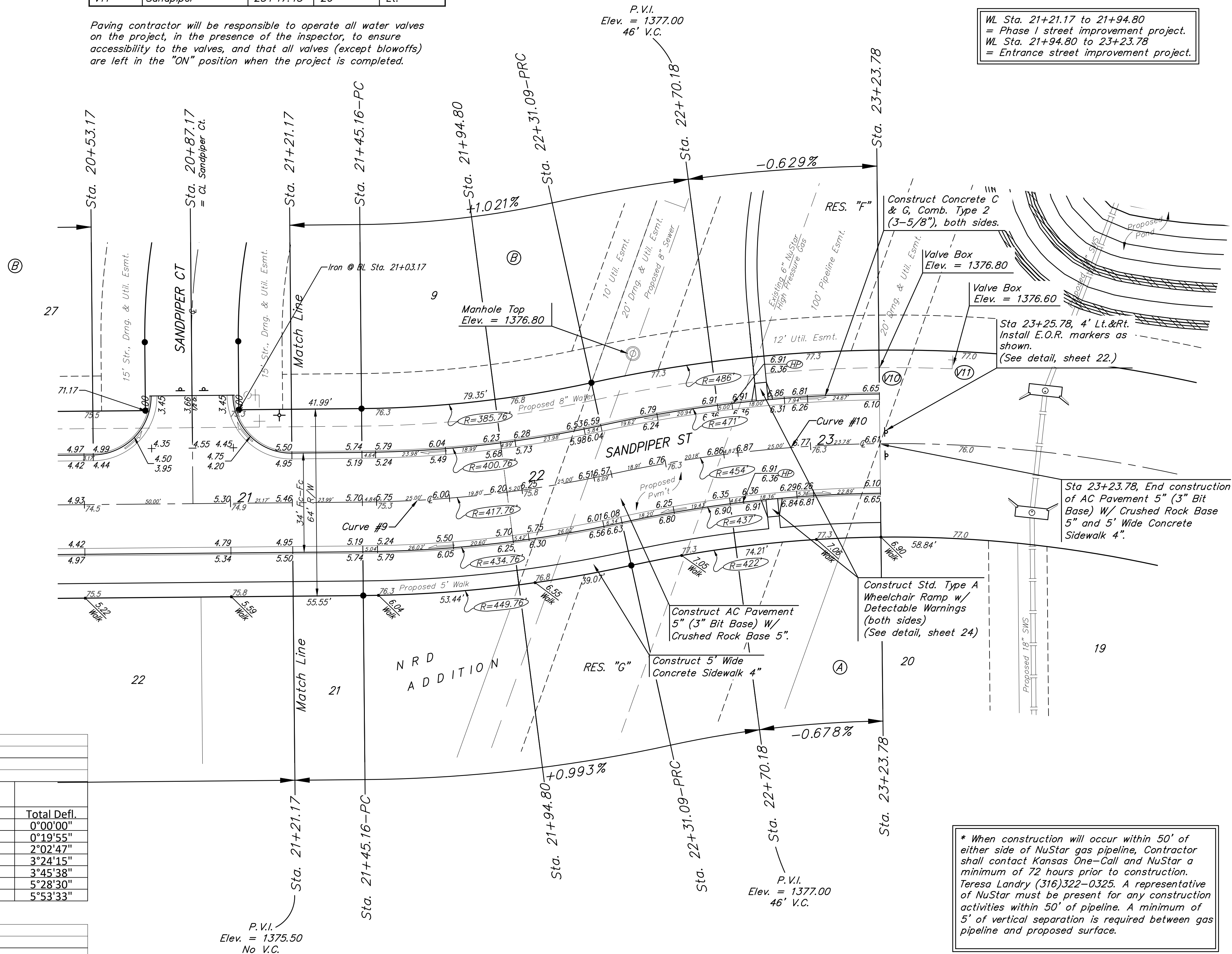

Curve #9
 Curve Data Based on Centerline
 Rad. = 417.76' Delta = 11°47'07" Tangent = 43.12'
 Arc = 85.93' L.C. = 85.78' Def./Ft. = 4.11449 Min.

Face Chord Lengths	Station	Arc	8' Left	8' Right	Defl.	Total Defl.
	21+45.16	-	-	-	0°00'00"	0°00'00"
	21+50.00	4.84'	4.55'	5.13'	0°19'55"	0°19'55"
	21+75.00	25.00'	23.50'	26.49'	1°42'52"	2°02'47"
	21+94.80	19.80'	18.61'	20.98'	1°21'28"	3°24'15"
	22+00.00	5.20'	4.89'	5.51'	0°21'23"	3°45'38"
	22+25.00	25.00'	23.50'	26.49'	1°42'52"	5°28'30"
	22+31.09	6.09'	5.73'	6.45'	0°25'03"	5°53'33"

Curve #10
 Curve Data Based on Centerline
 Rad. = 454' Delta = 11°41'52" Tangent = 46.51'
 Arc = 92.70' L.C. = 92.53' Def./Ft. = 3.78569 Min.

Face Chord Lengths	Station	Arc	8' Left	8' Right	Defl.	Total Defl.
	22+31.08	-	-	-	0°00'00"	0°00'00"
	22+50.00	18.92'	19.96'	17.88'	1°11'38"	1°11'38"
	22+75.00	25.00'	26.37'	23.62'	1°34'38"	2°46'16"
	23+00.00	25.00'	26.37'	23.62'	1°34'39"	4°20'55"
	23+23.78	23.78'	25.08'	22.47'	1°30'01"	5°50'56"

* When construction will occur within 50' of either side of NuStar gas pipeline, Contractor shall contact Kansas One-Call and NuStar a minimum of 72 hours prior to construction. Teresa Landry (316)322-0325. A representative of NuStar must be present for any construction activities within 50' of pipeline. A minimum of 5' of vertical separation is required between gas pipeline and proposed surface.

NOTE: ROLL TYPE CURB & GUTTER (TYPE 2) TO BE CONSTRUCTED ON THE PAVEMENT SHOWN ON THIS SHEET. TOP OF CURB ELEVATIONS ARE GIVEN FOR FULL HEIGHT CURB (TYPE 4).

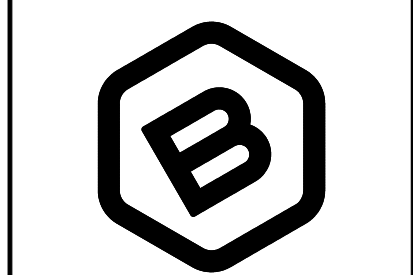
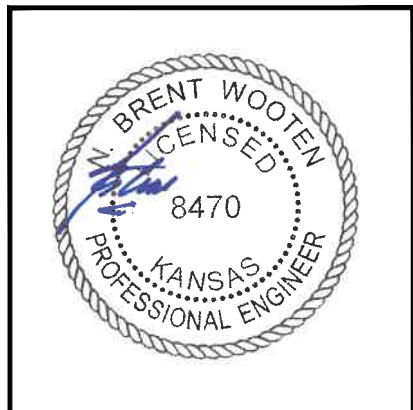

BAUGHMAN COMPANY
 315 Ellis St.
 Wichita, KS 67211
 316-262-7271
 BaughmanCo.com

NRD ADDITION
 Phase I & Entrance

SANDPIPER

STREET IMPROVEMENTS

PROJECT NUMBER:
 21-03-E868 & E869

DESIGN: NBW DRAWN: TMS
 DATE: December 6, 2021

SHEET OF
8 47

File: E:\Projects\NRD Addition_19-04-P448\Engineering\Phase 1\STR 21-03-E868 E869\STRPdm.dwg