

RISER/MANHOLE COORDINATES

POINT NAME	NORTHING	EASTING
MH-54	1709789	1635654
MH-55	1709325	1635584
MH-56	1709044	1635530
MH-57	1708279	1635367
MH-58	1708089	1635354
MH-59	1707187	1635392
MH-60	1706634	1635361
MH-61	1705661	1635142
R-107	1709802	1635656
R-108	1709415	1635599
R-109	1709031	1635528
R-110	1708648	1635450
R-111	1708266	1635364
R-112	1707878	1635382
R-113	1707488	1635409
R-113A	1707174	1635393
R-114	1706709	1635371
R-115	1706321	1635321
R-116	1705942	1635227
R-117	1705567	1635114

RISER/MANHOLE COORDINATES AND TOE-DRAIN PIPE INVERT ELEVATIONS ARE BASED LIDAR TOPOGRAPHIC DATA AND MAY REQUIRE MINOR HORIZONTAL AND VERTICAL ADJUSTMENTS TO BE MADE IN THE FIELD. ANY FIELD CHANGES TO THE TOE-DRAIN ALIGNMENT OR PIPE INVERTS SHALL BE APPROVED BY THE CITY OF WICHITA'S STORMWATER ENGINEER.

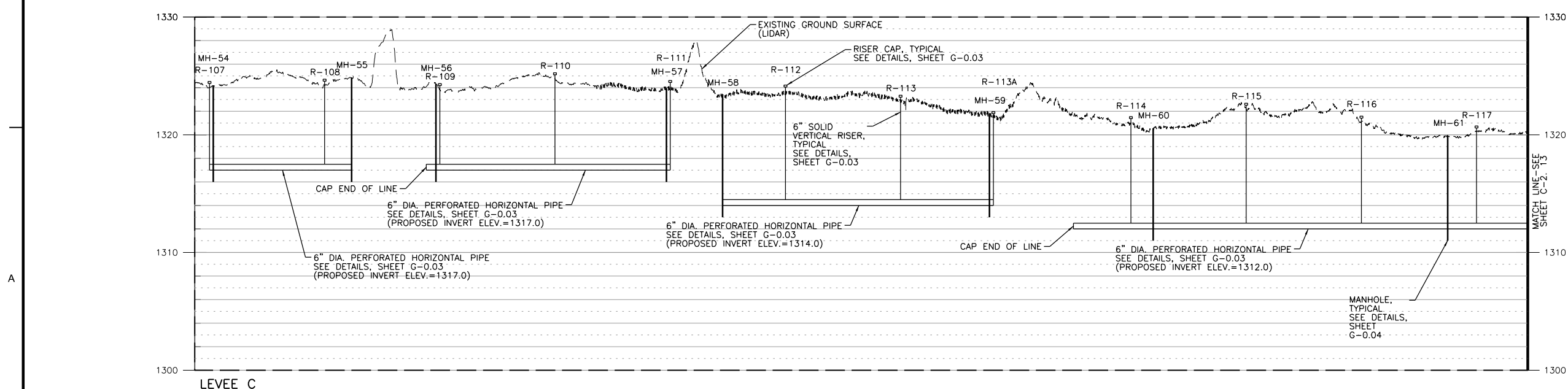

PROFILE SCALE (40:1 EXAGGERATION):  
 HORIZONTAL: 1"=200'  
 VERTICAL: 1"=5'

DATE	APPR
DESCRIPTION	MARK

**ameco**  
 AMEC Earth & Environmental, Inc.  
 1129 SW Winemakers  
 Topeka, Kansas 66604  
 Phone: (785) 272-6830  
 Fax: (785) 272-6878



UPPER LEVEE TOE DRAIN INSTALLATION  
 WICHITA-VALLEY CENTER LOCAL  
 FLOOD PROTECTION PROJECT  
 WICHITA, KANSAS

PREPARED FOR  
 THE CITY OF WICHITA, KANSAS  
 455 N. Main  
 Wichita, KS 67202

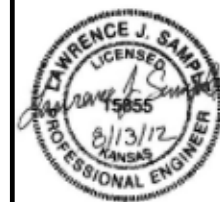

DESIGNED BY: Larry Sample, PE	DATE: 08-13-2012
DWN BY: RES	CKD BY: LBK
APP BY: L. SAMPLE	

FILE NAME:  
18\_C-2\_12.dgn

AMEC PROJ. NO. 5-6150-0001

LEVEE TOE DRAIN PLAN  
 AND PROFILE

**C-2.12**  
 SHEET 13 OF 24