

REFER TO SHEET G-0.01 FOR STANDARD DRAWING LEGEND

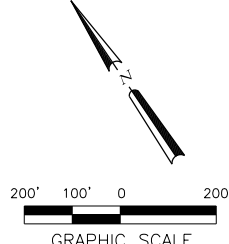

RISER/MANHOLE COORDINATES		
POINT NAME	NORTHING	EASTING
MH-37	1722904	1625869
MH-38	1722667	1626737
MH-39	1722601	1627639
MH-40	1722465	1628027
R-76	1722858	1625958
R-77	1722722	1626330
R-78	1722668	1626723
R-79	1722666	1627120
R-80	1722626	1627514
R-81	1722350	1628255

RISER/MANHOLE COORDINATES AND TOE DRAIN PIPE INVERT ELEVATIONS ARE BASED LIDAR TOPOGRAPHIC DATA AND MAY REQUIRE MINOR HORIZONTAL AND VERTICAL ADJUSTMENTS TO BE MADE IN THE FIELD. ANY FIELD CHANGES TO THE TOE DRAIN ALIGNMENT OR PIPE INVERTS SHALL BE APPROVED BY THE CITY OF WICHITA'S STORMWATER ENGINEER.

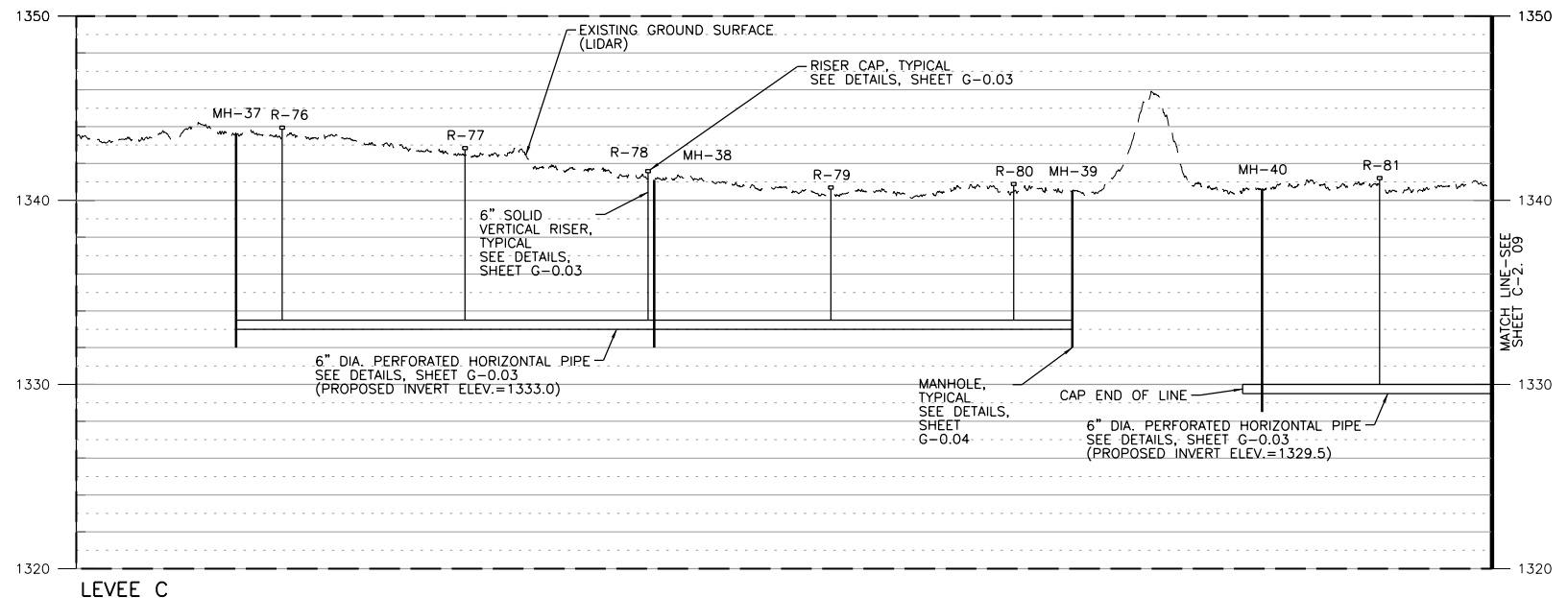

PROFILE SCALE (40:1 EXAGGERATION):
 HORIZONTAL: 1"=200'
 VERTICAL: 1"=5'

DATE	APPR.
DESCRIPTION	MARK

amec
 AMEC Earth & Environmental, Inc.
 1129 SW Winemakers
 Topeka, Kansas 66604
 Phone: (785) 272-6830
 Fax: (785) 272-6878



UPPER LEVEE TOE DRAIN INSTALLATION
 WICHITA-VALLEY CENTER LOCAL
 FLOOD PROTECTION PROJECT
 WICHITA, KANSAS

PREPARED FOR
THE CITY OF WICHITA, KANSAS
 455 N. Main
 Wichita, KS 67202



DESIGNED BY: Larry Sample, PE	DATE: 08-13-2012
DWN BY: RES	CKD BY: LBK
APP BY: L. SAMPLE	

FILE NAME:
14_C-2.08.dgn

AMEC PROJ. NO. 5-6150-0001

LEVEE TOE DRAIN PLAN
 AND PROFILE
C-2.08
 SHEET 14 OF 24