

| ROOM NUMBER | ROOM NAME | FLOOR FINISH | BASE FINISH | WALL FINISH & SUBSTRATE TYPES | | | | CEILING FINISH | REMARKS |
|-------------|---------------------|--------------|-------------|-------------------------------|------------------|-------------------|------------------|----------------|---------|
| | | | | NORTH WALL FINISH | EAST WALL FINISH | SOUTH WALL FINISH | WEST WALL FINISH | | |
| 100 | VESTIBULE | CONC | RB1 | PNT | PNT | PNT | PNT | PNTC | |
| 101A | SOUTH LOCKER ROOM | CONC | RB1 | PNT | PNT | PNT | PNT | PNTC | |
| 101B | RESTROOM | CONC | RB1 | PNT | PNT | PNT | PNT | PNTC | 6.7 |
| 102A | SOUTH LOCKER ROOM | SRF / CONC | SRF/RB1 | PNT | PNT | PNT | PNT | PNTC | |
| 102B | RESTROOM | SRF / CONC | SRF/RB1 | PNT | PNT | PNT | PNT | PNTC | 6.7 |
| 103 | JAM | CONC | RB1 | PNT | PNT | PNT | PNT | PNTC | |
| 104 | REFEREE LOCKER ROOM | CONC | RB1 | PNT | PNT | PNT | PNT | PNTC | |
| 105 | RESTROOM / SHOWER | SRF / CONC | SRF/RB1 | PNT | PNT | PNT | PNT | PNTC | 6.7 |
| 106 | RESTROOM / SHOWER | SRF / CONC | SRF/RB1 | PNT | PNT | PNT | PNT | PNTC | 6.7 |
| 107 | TOILET | CONC | RB1 | PNT | PNT | PNT | PNT | PNTC | |
| 108 | TOILET | CONC | RB1 | PNT | PNT | PNT | PNT | PNTC | |
| 113 | NORTH LOCKER ROOM | CONC | RB1 | PNT | PNT | PNT | PNT | EXIST | 5.8 |
| 114 | NORTH LOCKER ROOM | CONC | RB1 | PNT | PNT | PNT | PNT | EXIST | 5.8 |
| 115 | VESTIBULE | CONC | RB1 | PNT | PNT | PNT | PNT | EXIST | |
| 122 | RESTROOM | CONC | RB1 | PNT | PNT | PNT | PNT | EXIST | 5 |
| 123 | SHOWERS | SRF / CONC | SRF | PNT | PNT | PNT | PNT | EXIST | 5, 6, 7 |
| 125 | RESTROOM | CONC | RB1 | PNT | PNT | PNT | PNT | EXIST | 5 |
| 126 | SHOWERS | SRF / CONC | SRF | PNT | PNT | PNT | PNT | EXIST | 5, 6, 7 |
| 201 | TEAM 1 | CONC | RB1 | PNT | PNT | PNT | PNT | ACT1 | 3 |
| 202 | NEUTRAL PRESS | CONC | RB1 | PNT | PNT | PNT | PNT | ACT1 | 3 |
| 203 | TEAM 2 | CONC | RB1 | PNT | PNT | PNT | PNT | ACT1 | 3 |

FINISH LEGEND

| FLOORS | DESCRIPTION |
|---------|--|
| CONC | SEALED CONCRETE |
| SRF | SEAMLESS RESINOUS FLOORING RUBBER/EPDM GRADE EPOXY MORTAR QUARTZ FLOORING SYSTEM/COLOR TO BE SELECTED BY ARCHITECT/OWNER/ PROVIDE 4" INTEGRAL COVE BASE |
| BASE | DESCRIPTION |
| SRF | SEAMLESS RESINOUS FLOORING INTEGRAL BASE 4" INTEGRAL COVE BASE TO MATCH SRF FLOOR SYSTEM |
| RB1 | RUBBER BASE JOHNSONITE / COLOR TO MATCH EXISTING / 4" COVED TOE |
| CEILING | DESCRIPTION |
| ACT1 | ACOUSTIC CEILING TILE ARMSTRONG / CORTEGA / 24X24" / PRELUDE 1516" GRID |
| EXIST | EXISTING FINISH TO REMAIN TOUCH UP PAINT AS NEEDED IF DAMAGED BY CONSTRUCTION WORK |
| PNTC | EXPOSED TO STRUCTURE (FLAT) STRUCTURE PAINTED SHERWIN WILLIAMS / MATCH EXISTING COLOR IN EXISTING NORTH LOCKER ROOMS *PAINT ALL CONDUIT HVAC TO REMAIN UNPAINTED |
| WALLS | DESCRIPTION |
| PNT1 | PAINT 1 SHERWIN WILLIAMS / TO BE SELECTED BY ARCHITECT |
| PNT2 | PAINT 2 (ACCENT) SHERWIN WILLIAMS / TO MATCH STRYKER BRANDING YELLOW PMS1235U |
| PNT3 | PAINT 3 (ACCENT) SHERWIN WILLIAMS / TO MATCH STRYKER BRANDING BLUE PMS300U |
| PNT4 | PAINT 4 (HM DOORS AND FRAMES) SHERWIN WILLIAMS / TO MATCH EXISTING DOOR AND FRAME COLOR |
| SURFACE | DESCRIPTION |
| PLAM1 | PLASTIC LAMINATE WILSONART/CARBON MESH4880 |
| MISC. | DESCRIPTION |
| L1 | LOCKERS REPUBLIC/VENTILATED LOCKERS/ DOUBLE TIER/ 24"X78"X18" DEEP/ COLOR TO BE SELECTED BY ARCHITECT |
| TPAR | TOILET PARTITIONS SCRANTON/FLOOR MOUNTED/OVERHEAD BRACED/CONTINUOUS HINGE/STAINLESS HAMMERED |

FINISH NOTES

- ACCENT PAINT COLOR LOCATIONS TO BE DETERMINED BY OWNER / ARCHITECT.
- PAINT ALL EXPOSED CONDUIT AND BOXES TO MATCH ADJACENT WALL/CEILING FINISH.
- PROVIDE GROMMETS AT ALL BUILT-IN WORKSURFACE LOCATIONS. COORDINATE LOCATIONS OF GROMMETS WITH OWNER/ARCHITECT.
- EXISTING HM DOORS AND FRAMES TO BE PAINTED, PNT4.
- TOUCH UP EXISTING PAINTED CEILING STRUCTURE AS NEEDED AFTER NEW WORK IS COMPLETE.
- EPOXY PAINT REQUIRED AT ALL SHOWER WALLS.
- SRF FLOORING AND INTEGRAL BASE TO BE INSTALLED ONLY WITHIN THE SHOWER STALLS. TRANSITION TO OCCUR AT EDGE OF SHOWER WING WALLS. CONCRETE TO REMAIN IN CIRCULATION SPACES. SEE DETAIL 1 BELOW FOR TRANSITION TO CONCRETE.
- TOUCH UP PAINT AT ALL EXISTING WALLS IN NORTH LOCKER ROOMS WHERE EXISTING WALLS ARE REMAINING.

GENERAL FINISH NOTES

- COLUMNS AND ALL EXPOSED STRUCTURE TO RECEIVE PAINT, UNO.
- ACCENT PAINT COLOR LOCATIONS TO BE DETERMINED BY OWNER / ARCHITECT.
- HM DOORS AND FRAMES TO BE PAINTED, PNT4, TO MATCH EXISTING HOLLOW METAL DOORS AND FRAMES.
- PAINT PLANS AND ACCENT PAINTS TO BE COORDINATED WITH OWNER. PAINT PLAN TO BE INCLUDED WITH RETURNED SUBMITTAL.
- TOUCH UP ALL EXISTING EXPOSED METAL BRACING. COLOR TO MATCH EXISTING.
- PAINT ALL EXPOSED METAL BRACING. COLOR TO MATCH EXISTING NORTH LOCKER ROOMS.
- TOUCH UP EXISTING HM DOORS AND FRAMES AS NEEDED WHEN CONSTRUCTION DAMAGE MAY OCCUR. COLOR TO MATCH EXISTING.

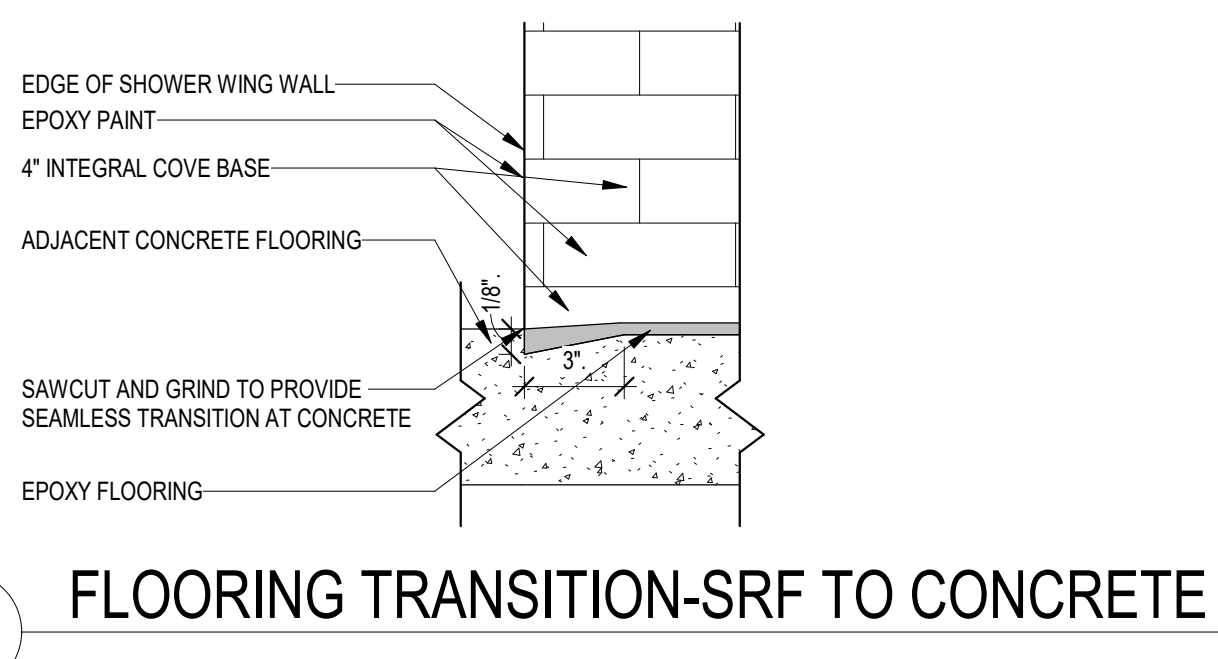

1. FLOORING TRANSITION-SRF TO CONCRETE

SUBSTRATE GENERAL NOTES

- TYPICAL WALL "SUBSTRATE PANEL":**
NON-RATED 5/8" GYP BOARD
OR
5/8" TYPE "X" GYP BOARD
- MOISTURE PRONE AREAS "SUBSTRATE PANEL":**
SHOWER AND BATH ALCOVE SUBSTRATE: 5/8" MOISTURE RESISTANT GYP BOARD
MOP SINK: FRP OVER 5/8" MOISTURE RESISTANT GYP BOARD
PUBLIC RESTROOMS: 5/8" MOISTURE RESISTANT GYP BOARD
- WET WALLS, TOILETS, URINALS, SINKS, LAVATORIES, ETC.:** 5/8" MOISTURE RESISTANT GYP BOARD
- RATED WALLS "SUBSTRATE PANEL":**
TYPICAL RATED WALLS: 5/8" TYPE "X" GYP BOARD
TYPICAL RATED CEILINGS: 5/8" FIRE CODE "C"

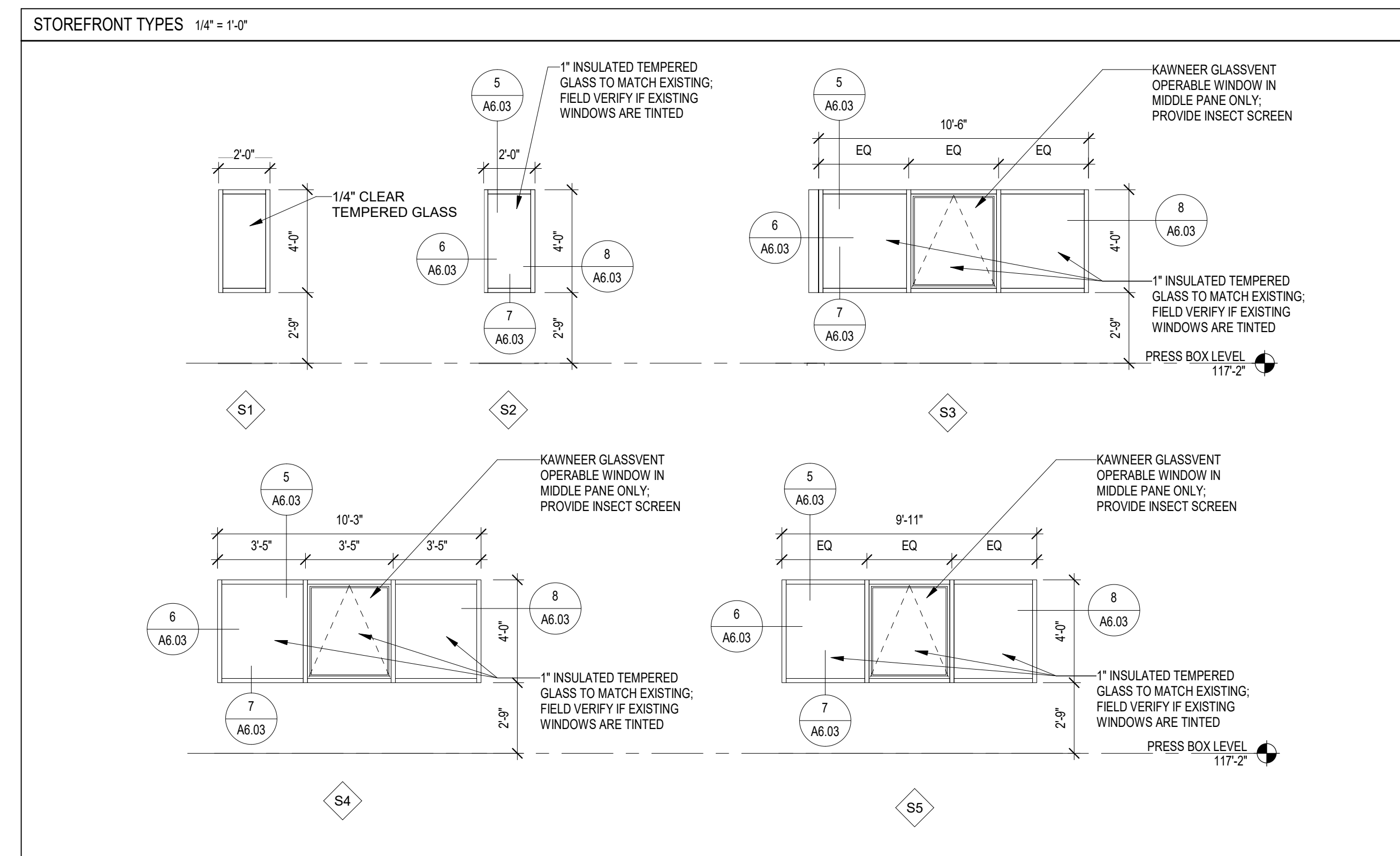
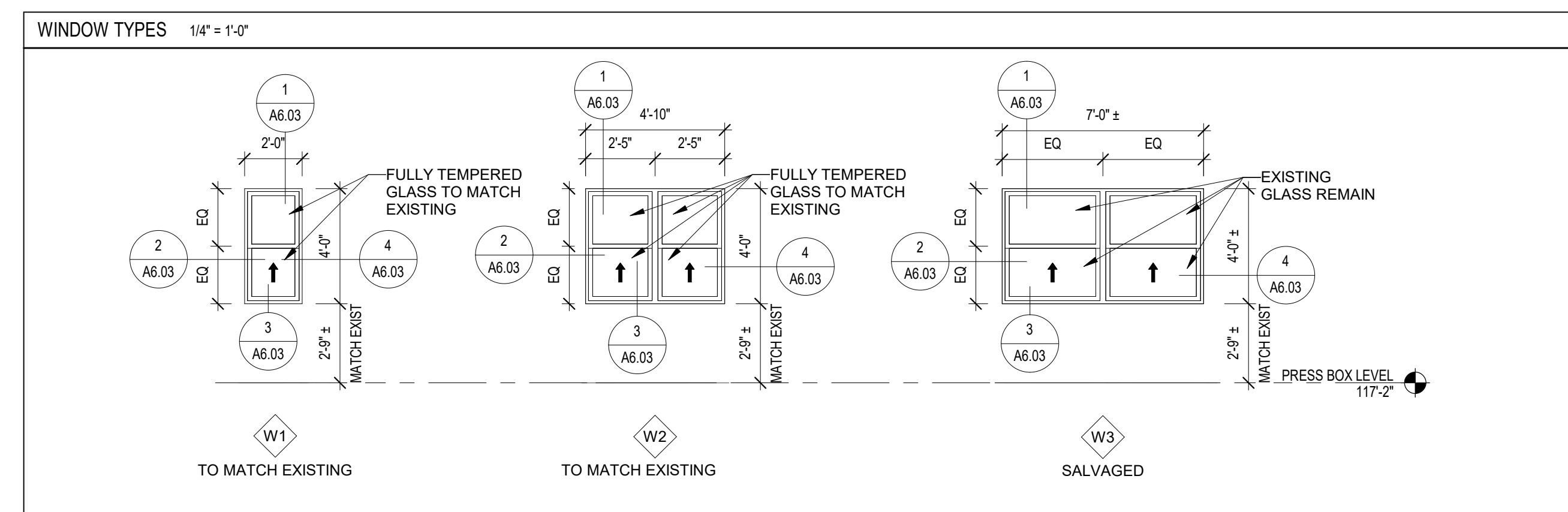
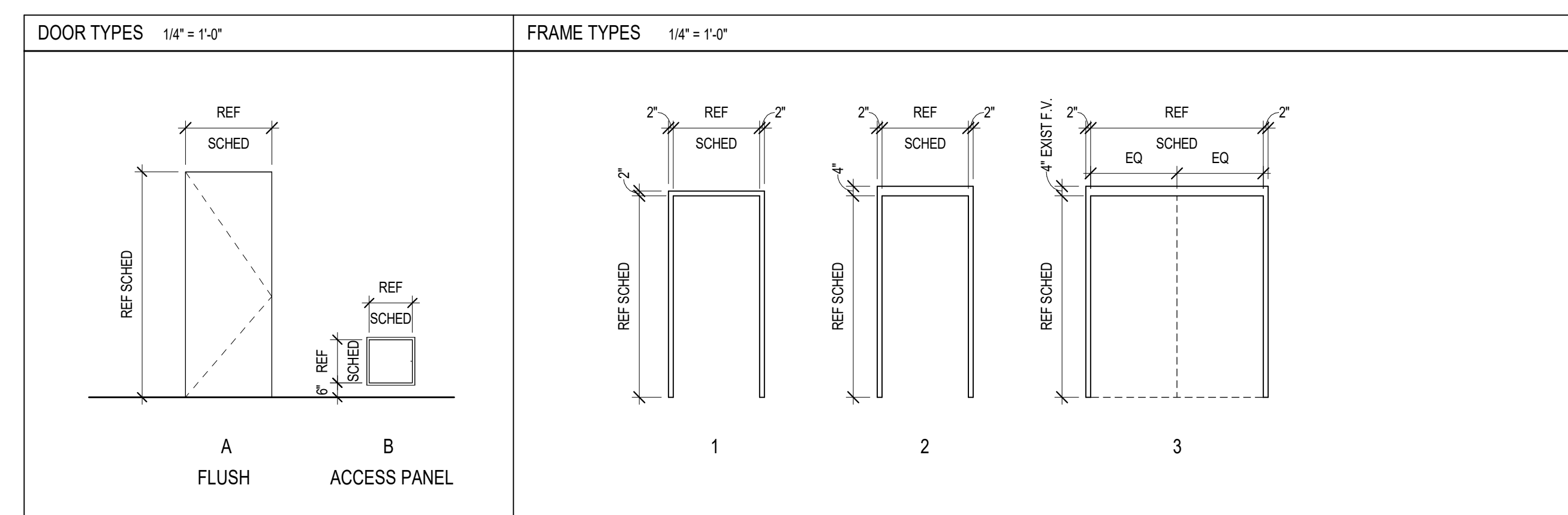

| NORTH LOCKER DOOR SCHEDULE | | | | | | | | | | | | | | | |
|----------------------------|------|------|-------|--------|----------|--------|--------|----------|-------|----------|----------|----------|----------|------|----------|
| NUMBER | TYPE | PAIR | DOOR | | | | RATING | HARDWARE | FRAME | | | HEAD | JAMB | SILL | COMMENTS |
| | | | WIDTH | HEIGHT | MATERIAL | FINISH | | | TYPE | MATERIAL | FINISH | | | | |
| 115 | A | | 3'-0" | 7'-0" | HM | PNT | 1.0 | 2 | HM | PNT | 12/A6.02 | 13/A6.02 | 14/A6.02 | | |

| SOUTH LOCKER DOOR SCHEDULE | | | | | | | | | | | | | | | |
|----------------------------|------|------|-------|--------|----------|--------|--------|----------|-------|----------|----------|----------|----------|----------------------------------|----------|
| NUMBER | TYPE | PAIR | DOOR | | | | RATING | HARDWARE | FRAME | | | HEAD | JAMB | SILL | COMMENTS |
| | | | WIDTH | HEIGHT | MATERIAL | FINISH | | | TYPE | MATERIAL | FINISH | | | | |
| 100 | A | | 3'-0" | 7'-0" | HM | PNT | 1.0 | 2 | HM | PNT | 8/A6.02 | 9/A6.02 | 14/A6.02 | | |
| 101A | A | | 3'-0" | 7'-0" | HM | PNT | 5.0 | 2 | HM | PNT | 1/A6.02 | 2/A6.02 | | | |
| 101B | A | | 3'-0" | 7'-0" | HM | PNT | 6.0 | 2 | HM | PNT | 3/A6.02 | 4/A6.02 | 15/A6.02 | | |
| 102A | A | | 3'-0" | 7'-0" | HM | PNT | 5.0 | 2 | HM | PNT | 1/A6.02 | 2/A6.02 | | | |
| 102B | A | | 3'-0" | 7'-0" | HM | PNT | 6.0 | 2 | HM | PNT | 3/A6.02 | 4/A6.02 | 15/A6.02 | | |
| 103 | A | | 3'-0" | 7'-0" | HM | PNT | 7.0 | 2 | HM | PNT | 1/A6.02 | 2/A6.02 | | | |
| 104A | A | | 3'-0" | 7'-0" | HM | PNT | 2.0 | 2 | HM | PNT | 8/A6.02 | 9/A6.02 | 14/A6.02 | | |
| 104B | A | | 3'-0" | 7'-0" | HM | PNT | 8.0 | 2 | HM | PNT | 3/A6.02 | 4/A6.02 | 15/A6.02 | | |
| 105 | A | | 3'-0" | 7'-0" | HM | PNT | 9.0 | 2 | HM | PNT | 1/A6.02 | 2/A6.02 | | | |
| 106 | A | | 3'-0" | 7'-0" | HM | PNT | 9.0 | 2 | HM | PNT | 1/A6.02 | 2/A6.02 | | | |
| 107 | A | | 3'-0" | 7'-0" | HM | PNT | 3.0 | 2 | HM | PNT | 8/A6.02 | 9/A6.02 | 14/A6.02 | | |
| 108 | A | | 3'-0" | 7'-0" | HM | PNT | 3.0 | 2 | HM | PNT | 8/A6.02 | 9/A6.02 | 14/A6.02 | | |
| 110 | A | X | 8'-0" | 7'-0" | HM | PNT | 4.0 | 3 | HM | PNT | 10/A6.02 | 11/A6.02 | 14/A6.02 | SALVAGED DOOR, FRAME, & HARDWARE | |

| PRESSBOX DOOR SCHEDULE | | | | | | | | | | | | | | | |
|------------------------|------|------|-------|--------|----------|--------|--------|----------|-------|----------|---------|---------|------|----------------------------------|----------|
| NUMBER | TYPE | PAIR | DOOR | | | | RATING | HARDWARE | FRAME | | | HEAD | JAMB | SILL | COMMENTS |
| | | | WIDTH | HEIGHT | MATERIAL | FINISH | | | TYPE | MATERIAL | FINISH | | | | |
| 202 | A | | 3'-0" | 7'-0" | HM | PNT | 10.0 | 2 | HM | PNT | 6/A6.02 | 7/A6.02 | | | |
| 203 | A | | 3'-0" | 7'-0" | HM | PNT | 11.0 | 2 | HM | PNT | 6/A6.02 | 7/A6.02 | | SALVAGED DOOR, FRAME, & HARDWARE | |



©2021 MKEC Engineering All Rights Reserved. www.mkec.com These drawings and their contents, including, but not limited to, all concepts, designs, & ideas are the exclusive property of MKEC Engineering (MKEC), and may not be used or reproduced in any way without the express consent of MKEC.

DOOR, WINDOW, & FINISH SCHEDULE

| | | |
|-------------|-------------|---------|
| PROJECT NO. | 01088R21003 | |
| DATE | 11/23/2021 | |
| SCALE | AS NOTED | |
| DESIGNED | DRAWN | CHECKED |
| MH | SS | MH |

| | | |
|-----|-------------------------|----------|
| 0 | ISSUED FOR CONSTRUCTION | 11-24-21 |
| NO. | REVISION | DATE |

SHEET NO. A6.01

