

PLANS FOR
MACDONALD GOLF COURSE DRAINAGE IMPROVEMENTS
WICHITA, KS

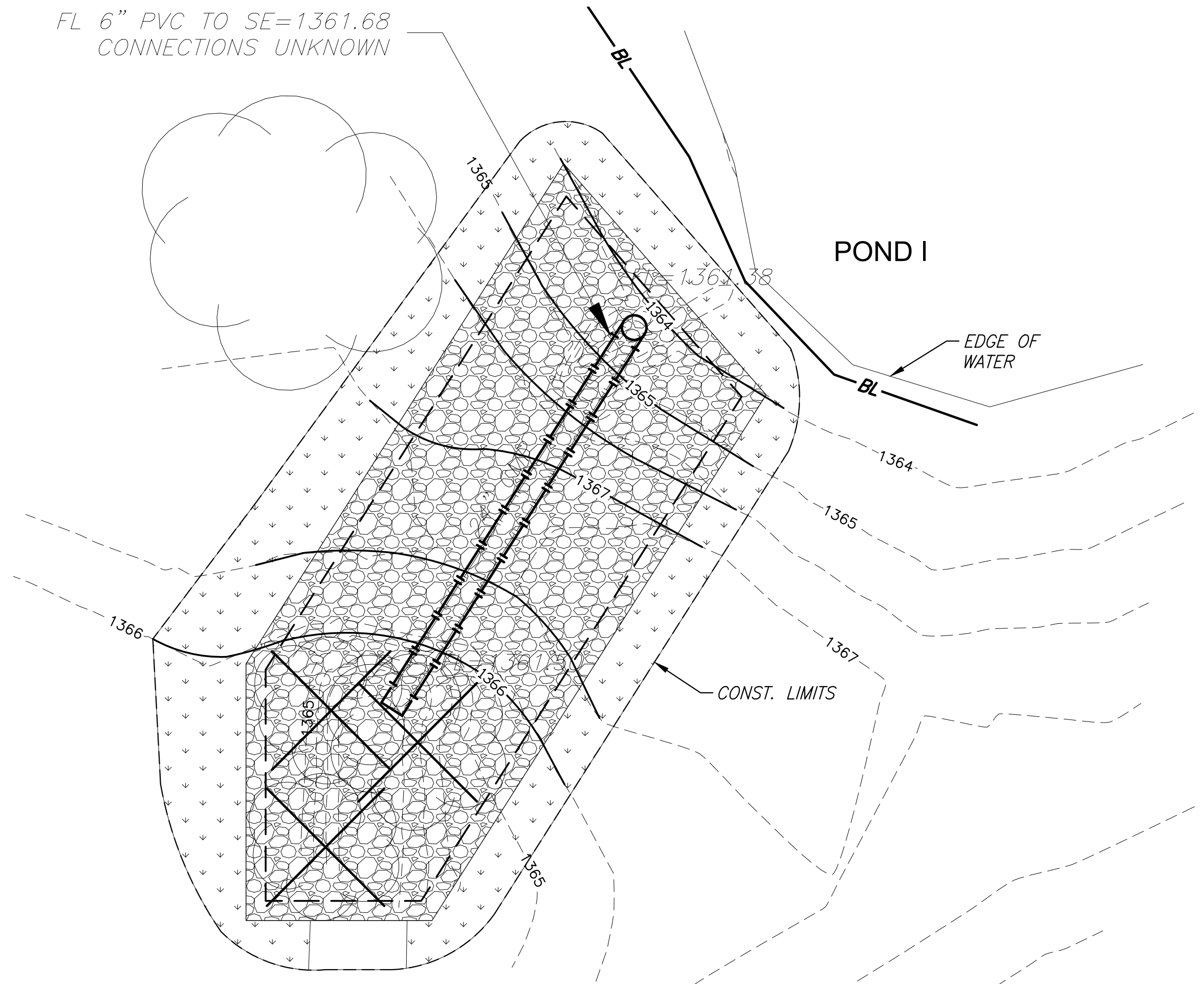

POND I SITE RESTORATION AND EROSION CONTROL PLAN

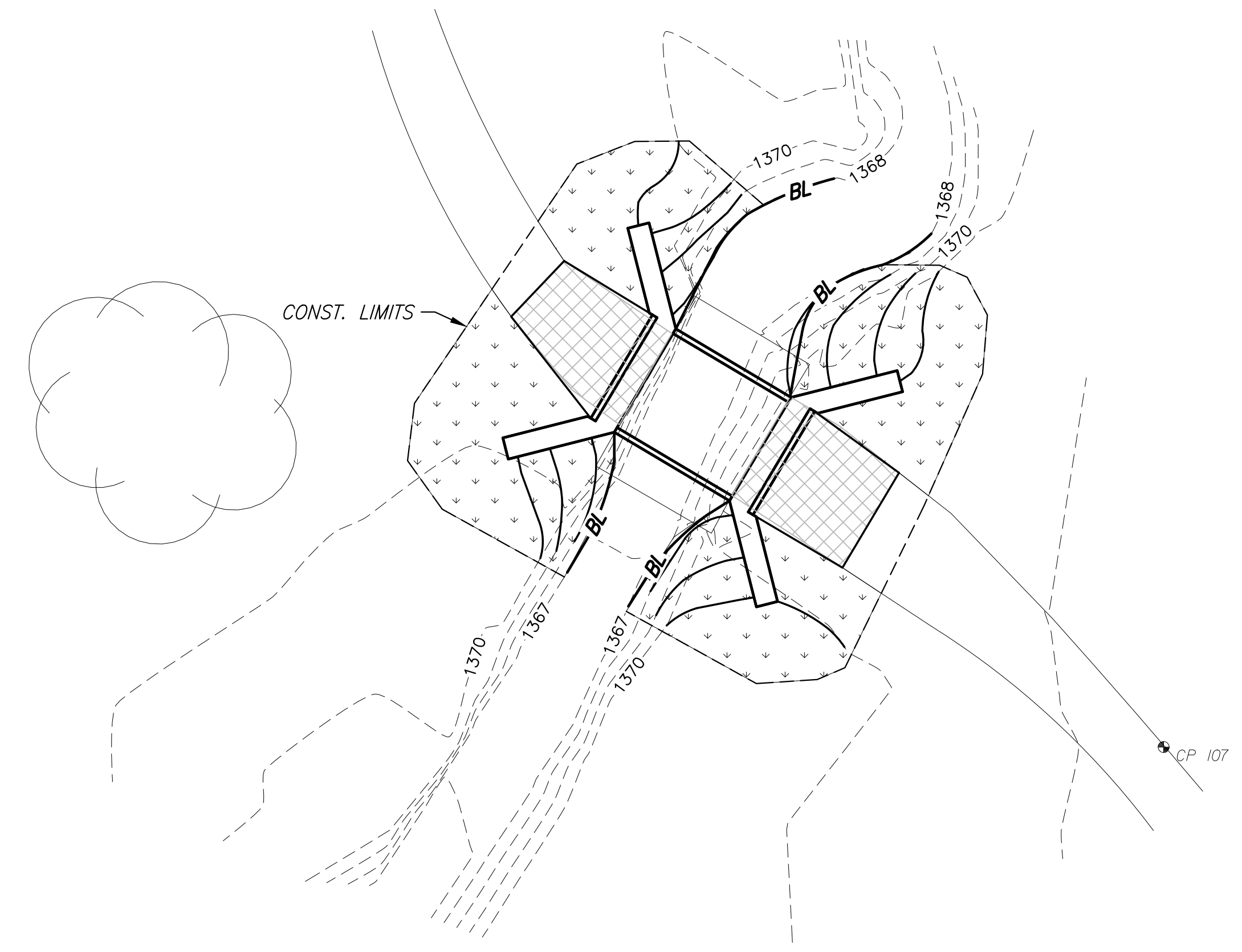

NORTH OF POND I SITE RESTORATION AND EROSION CONTROL PLAN

(Bid as Add Alternate No. 1)

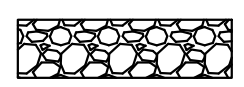
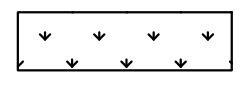
- LEGEND**
- CONST. LIMITS
 -  RIP RAP, LIGHT STONE, GROUTED
(SEE DETAILS ON SHEET 8)
 -  SEEDING AREAS (INCLUDING CURLEX,
TYPE I OR APPROVED EQUAL)
 - BL — BIODEGRADABLE LOG
(SEE DETAILS ON SHEET 14)

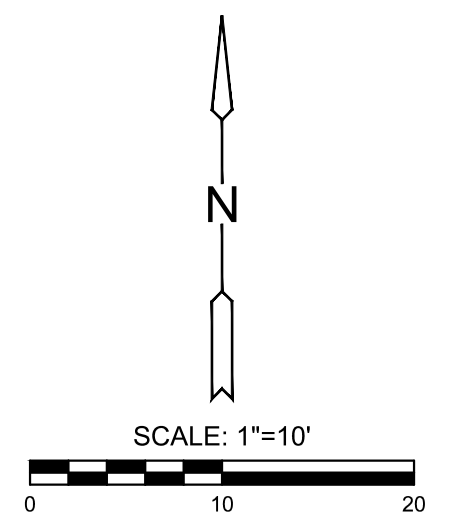

©2022
MKEC Engineering
All Rights Reserved
www.mkec.com
These drawings and their contents, including, but not limited to, all concepts, designs, & ideas are the exclusive property of MKEC Engineering (MKEC), and may not be used or reproduced in any way without the express consent of MKEC.

SITE RESTORATION AND EROSION CONTROL PLANS

PROJECT NO.		
DATE	01/20/2022	
SCALE	1"=10'	
DESIGNED	DRAWN	CHECKED
JRA	RAM	JRA
NO.	REVISION	DATE

SHEET NO.
15 OF 24