

SCALE: 1" = 10'

| TRAFFIC SIGNAL POLE SUMMARY | | | | | | |
|-----------------------------|-----------------|--------------------------|---------------------|----------------------|--------------------------|------------------------|
| POLE # | MAST ARM LENGTH | # OF SIGNALS ON MAST ARM | SIGNAL HEAD SPACING | # OF SIGNALS ON POLE | # OF PUSH BUTTON ON POLE | JOINT USE OR STANDARD* |
| ① | S 42' | 3 | - | 2 | 1 | STANDARD |
| ② | E 48' | 2 | - | 1 | 1 | STANDARD |
| ③ | 54' | 3 | - | 1 | 1 | STANDARD |

| PAY QUANTITY * | | |
|-----------------------|------|-------|
| ITEM | UNIT | TOTAL |
| Traffic Signalization | LS | 1 |

* All Costs associated with installing Traffic Signalization shall be Paid per the Lump Sum Bid Item "Traffic Signalization".

| DETECTION ZONES | | | |
|-----------------|--------|---------------|-------|
| CAMERA # | ZONE # | SIZES (W X L) | PHASE |
| #1 | ① | (6' x 55') | Ø1 |
| #1 | ② | (16' x 6') | Ø6 |
| #1 | ③ | (16' x 6') | Ø6 |
| #3 | ④ | (28' x 6') | Ø2 |
| #3 | ⑤ | (28' x 6') | Ø2 |
| #2 | ⑥ | (6' x 55') | Ø4 |

LEGEND

- SERVICE BOX
- TRAFFIC SIGNAL PEDESTAL
- TRAFFIC SIGNAL POLE W/ MAST ARM (STANDARD)
- TRAFFIC SIGNAL POLE W/ MAST ARM (JOINT USE)
- PEDESTRIAN PUSHBUTTON STATION
- PEDESTRIAN SIGNAL HEAD
- STREET NAME SIGN ON MAST ARM (D3-1)
- SIGNAL HEAD (TYPE A) ON MAST ARM
- SIGNAL HEAD (TYPE A) SIDE OF POLE
- SIGNAL HEAD (TYPE I) ON MAST ARM
- BLANKOUT SIGN
- VIDEO/RADAR DETECTION
- R10-12 (LEFT TURN ON GREEN) SIGN ON MAST ARM
- PROPOSED POWER/METER LOCATION
- RIGID GALVANIZED CONDUIT (RGC)
- TRAFFIC CONTROLLER CABINET
- DETECTION ZONE

NOTES

THE TRAFFIC SIGNAL SYSTEM SHALL BE COMPLETE AND CONTRACTOR SHALL FURNISH AND INSTALL ALL EQUIPMENT AND MATERIALS NECESSARY FOR SATISFACTORY OPERATION OF ELECTRICAL APPARATUS AND FOR COMPLETE OPERATION OF THE TRAFFIC SIGNAL SYSTEM, WHETHER SPECIFICALLY MENTIONED OR NOT.

PHASE DIAGRAM

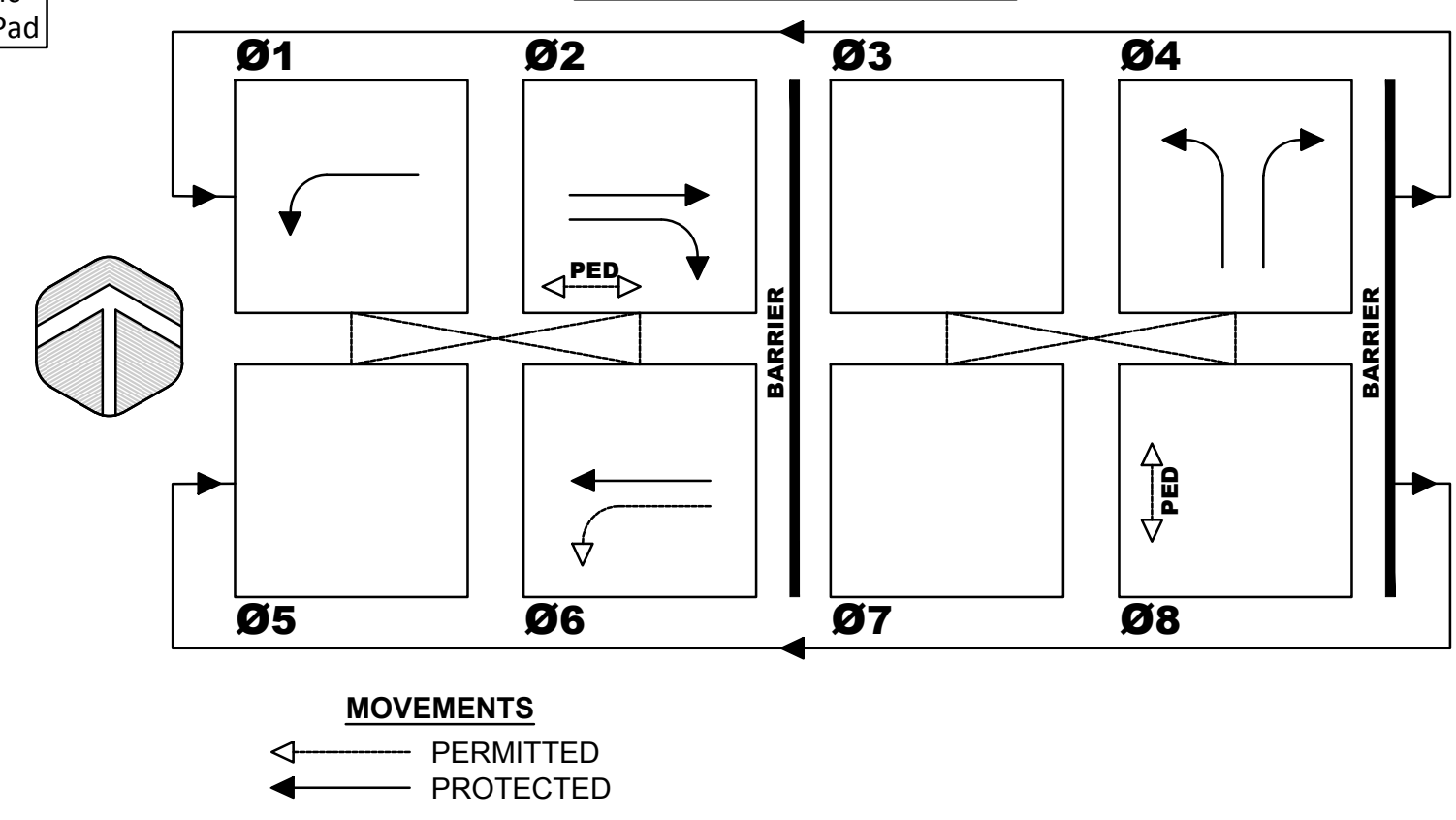

MOVEMENTS
 ◀ PERMITTED
 ▶ PROTECTED

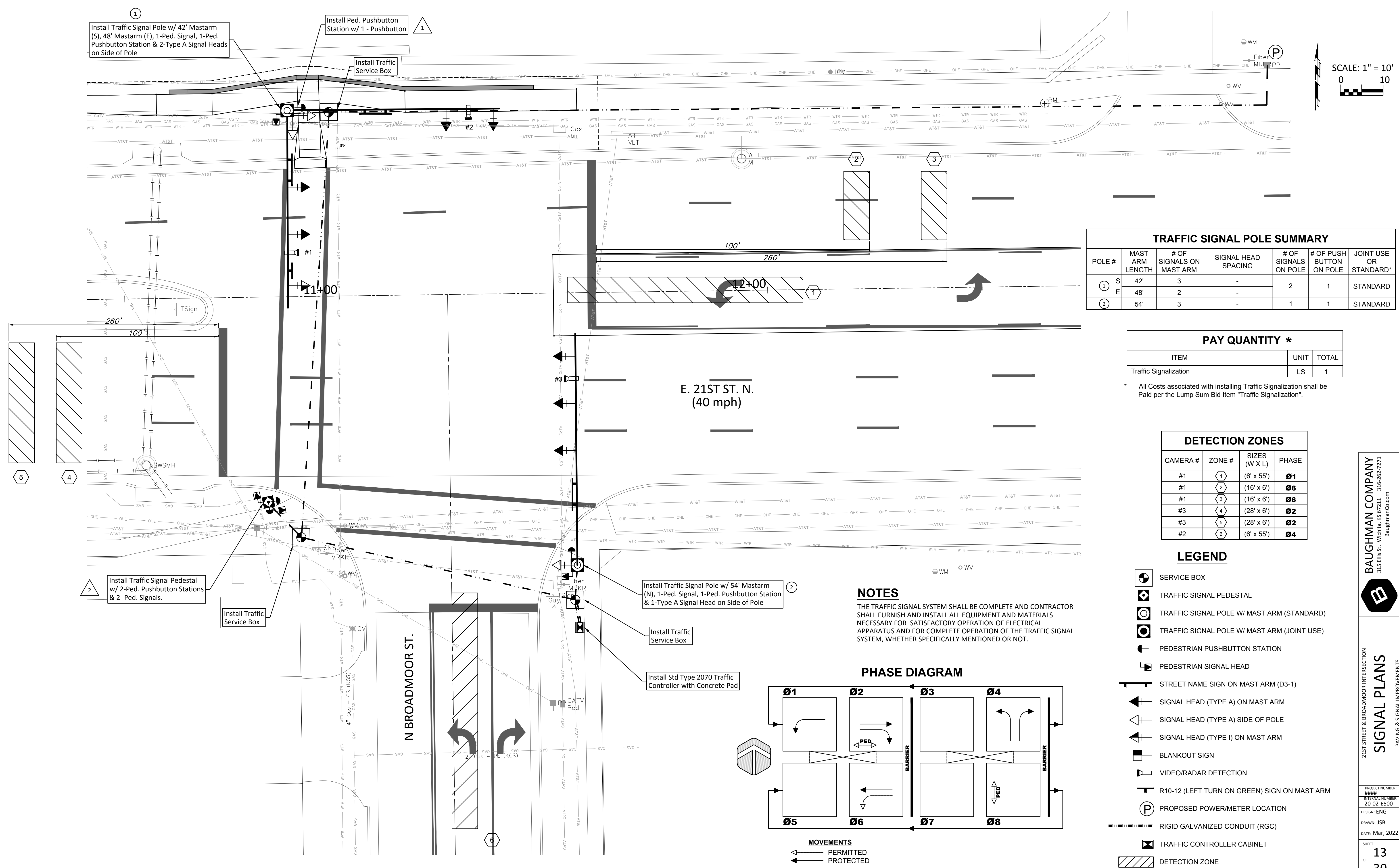

BAUGHMAN COMPANY
 315 Ellis St. Wichita, KS 67211 316-262-7271
 BaughmanCo.com



21ST STREET & BROADMOOR INTERSECTION
SIGNAL PLANS
 PAVING & SIGNAL IMPROVEMENTS

PROJECT NUMBER: #1111
 INTERNAL NUMBER: 20-02-E500
 DESIGN: ENG
 DRAWN: JSB
 DATE: Mar, 2022
 SHEET
 OF 13
 30