

KG20-2
60" x 24"

SCALE: 1" = 20'
0 20

W16-9P
12" x 24"
R9-9
18" x 30"

W16-9P
12" x 24"
R9-9
18" x 30"

R3-2
24" x 24"

R9-9
18" x 30"
W16-9P
12" x 24"

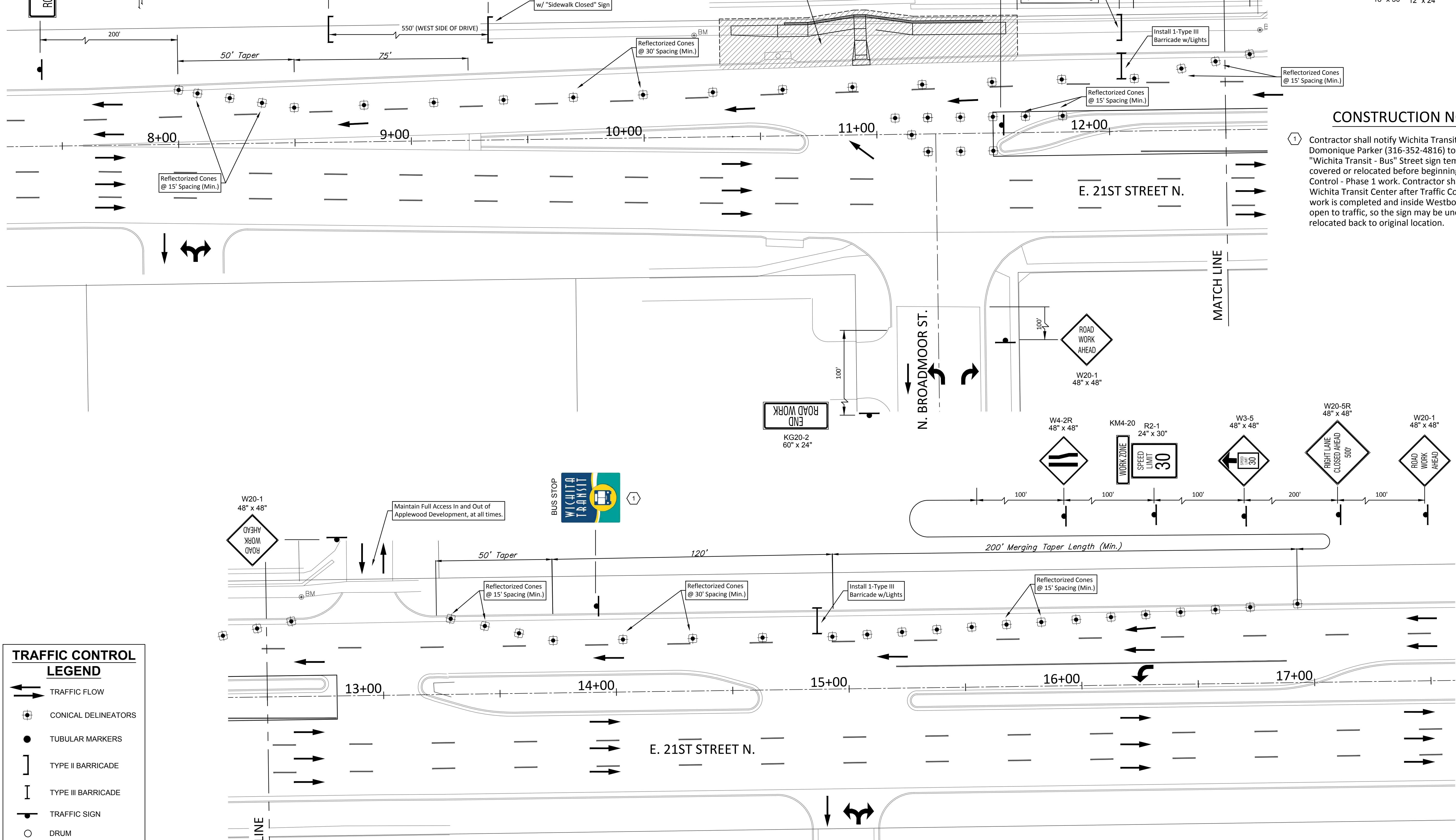

CONSTRUCTION NOTES

1 Contractor shall notify Wichita Transit Center, Domanique Parker (316-352-4816) to have existing "Wichita Transit - Bus" Street sign temporarily covered or relocated before beginning of Traffic Control - Phase 1 work. Contractor shall again notify Wichita Transit Center after Traffic Control - Phase 1 work is completed and inside Westbound lane is open to traffic, so the sign may be uncovered or relocated back to original location.

TRAFFIC CONTROL LEGEND

- TRAFFIC FLOW
- CONICAL DELINEATORS
- TUBULAR MARKERS
- TYPE II BARRICADE
- TYPE III BARRICADE
- TRAFFIC SIGN
- DRUM
- TYPE I BARRICADE
- WORK ZONE

PHASE 1
Remove and Replace Sidewalk & Construct WC Ramp. Maintain One Lane Westbound During Phase.

TRAFFIC CONTROL PLAN

BAUGHMAN COMPANY
315 Ellis St. Wichita, KS 67211 316-262-7271
BaughmanCo.com

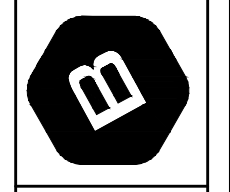

21ST STREET & BROADMOOR INTERSECTION
TRAFFIC CONTROL PLAN
PHASE 1
PAVING & SIGNAL IMPROVEMENTS

PROJECT NUMBER: #1111
INTERNAL NUMBER: 20-02-E500
DESIGN: ENG
DRAWN: JSB
DATE: Mar, 2022
SHEET
OF 18
30