

# STORM WATER DRAIN #614 MAPLE SHADE ADDITION

Project # 468 83995  
OCA# 751407

## GENERAL NOTES

Utility service lines, poles, valve boxes, meters, and et cetera are to be adjusted as necessary by others prior to construction unless the plans specifically call for their adjustment by the Contractor or unless the plans specifically identify a utility to be adjusted by its owner during construction. Existing utilities and their location, as shown on the plans, represent the best information obtainable for design. The Contractor will be required to work around existing utilities within the right-of-way which do not conflict with proposed construction.

Rubble from the removal of miscellaneous structures and excess excavation which is to be wasted shall be disposed of on sites to be provided by the Contractor. These sites shall be approved by the Engineer as to suitability, appearance and site location. Locations that, in the opinion of the Engineer, will leave an unsightly appearance will not be approved.

All disposal sites must be approved by the Kansas Department of Health and Environment. Material either stockpiled or disposed of in a flood plain would require a Kansas State Board of Agriculture permit. Any material dumped in waters of the United States or wetlands is subject to U.S. Corps permitting regulations. Any material buried or stockpiled beyond approved of Engineers construction limits would require additional archeological investigations unless buried in a previously approved borrow location.

Trees and shrubs in public right-of-way which are in direct conflict with proposed new construction shall be removed by the Contractor with the Engineer's approval. Trees and shrubs which are not in direct conflict with proposed new construction shall be saved and protected from damage.

The Contractor shall be responsible for preserving property irons. The Contractor will be required to re-establish any property irons which are damaged or destroyed by his construction operations. Such irons shall be re-established by a licensed land surveyor in accordance with state laws.

Contractor will be required to provide a minimum advance notice of twenty-four (24) hours to utility companies prior to starting any excavation as follows:

Kansas One-Call 687-2470

The Contractor must notify the following in case of an emergency:

Cox Communications	262-0661
Raytheon Pipeline	676-7911
K.G.&E. Electric	383-8600
Southern Star Gas Pipeline	529-6622
SBC	1-800-286-8313
City of Wichita Water Department	262-6000
City of Wichita Sewer Maintenance	262-6000

All disturbed areas are to be seeded, fertilized and mulched per City of Wichita specifications.

All fill placed under future streets shall be compacted to a minimum of 95 percent of standard proctor density (ASTM d-698) from minus 3 to plus 3 percent of optimum moisture content.

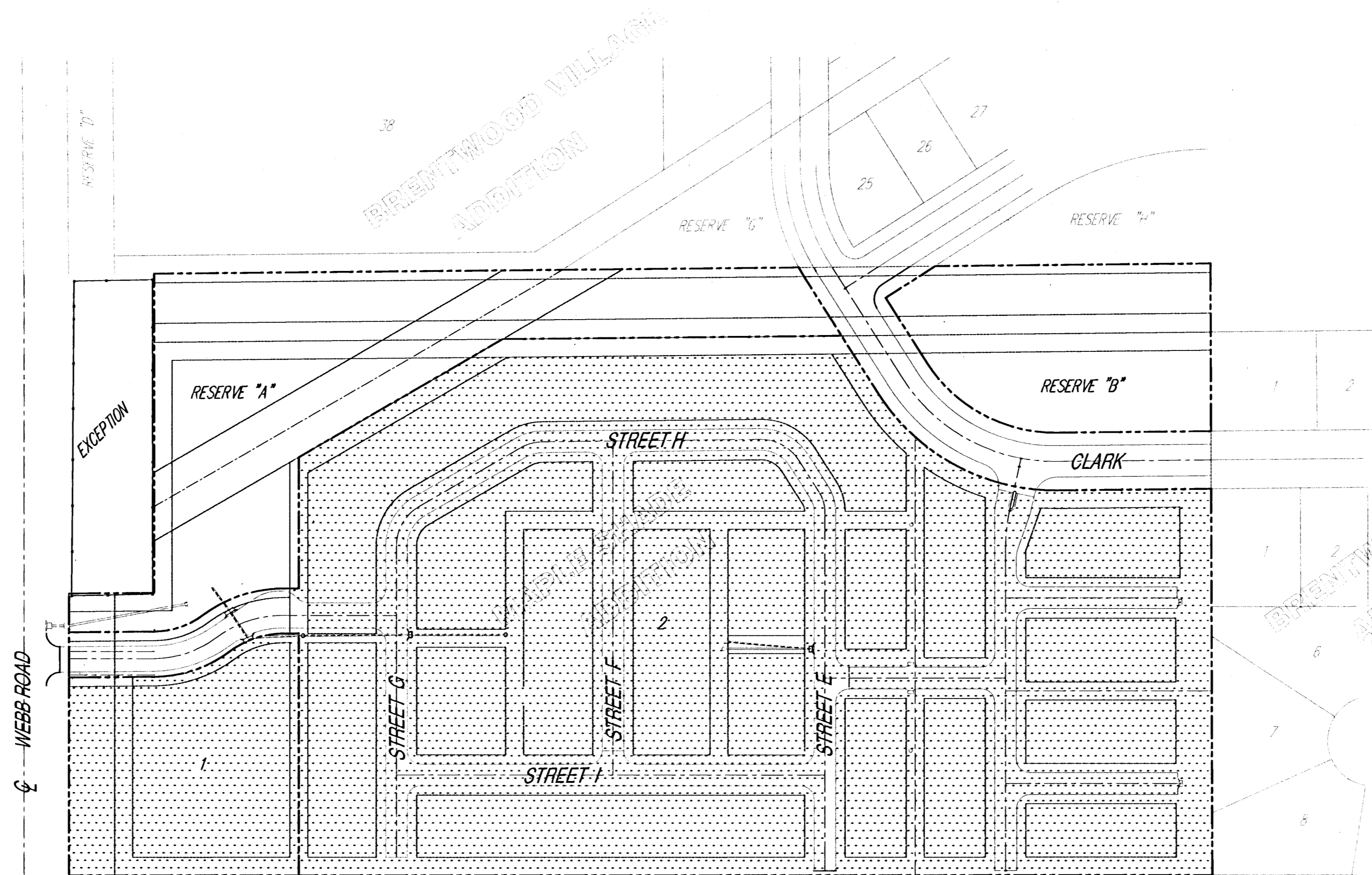

## BENCH MARKS

BENCH MARK #1: USGS BRASS PLUG 28' S. & 530' W. OF CENTERLINE INTERSECTION OF CAPRI & PAWNEE  
ELEV.=1386.25 NGVD

BENCH MARK #2: CITY OF WICHITA STD. DISC 20.8' W & 54.5' S. OF CENTERLINE INTERSECTION DALTON & PAWNEE  
ELEV.=1379.60

## INDEX OF SHEETS

1. Title Sheet
2. Site Grading Contours
3. Site Grading Grade Ticks
4. Pond Plan
- 5-6. Storm Water Sewer Profiles
7. Type 1A Inlet Detail
8. Shallow Type "P" MH Detail
9. BMP Details
10. Plat

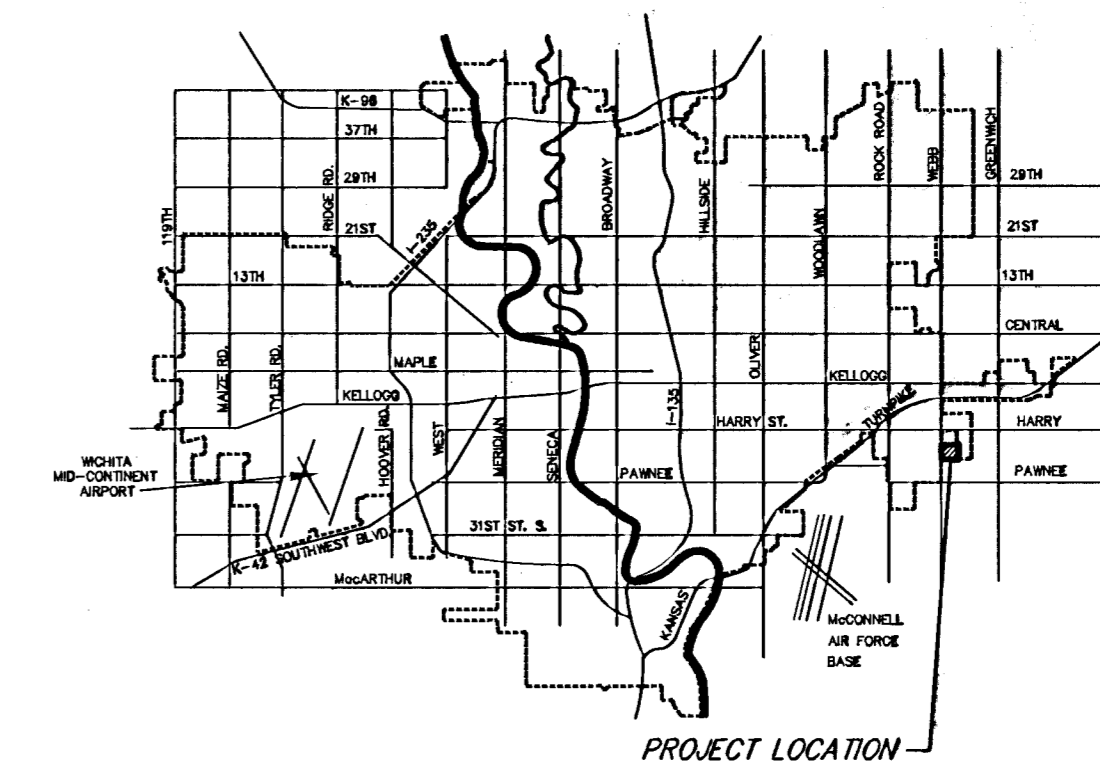

VICINITY MAP

 **IMPROVEMENT DISTRICT**



Scale: 1" = 100'

CITY OF WICHITA, KANSAS  
JAMES ARMOUR, P.E. - CITY ENGINEER



**Ruggles & Bohm, P.A.**  
Engineering, Surveying, Land Planning  
924 North Main (316) 264-8008  
Wichita, Kansas 67203 (316) 264-4621 fax  
www.rbkansas.com E-mail: info@rbkansas.com