

✕ DENOTES PIPE TO BE ABANDONED

M27 & M28 SPUR LINE

UNLESS NOTED OTHERWISE, ELEVATIONS SHOWN ARE TOP OF WATER SUPPLY PIPE

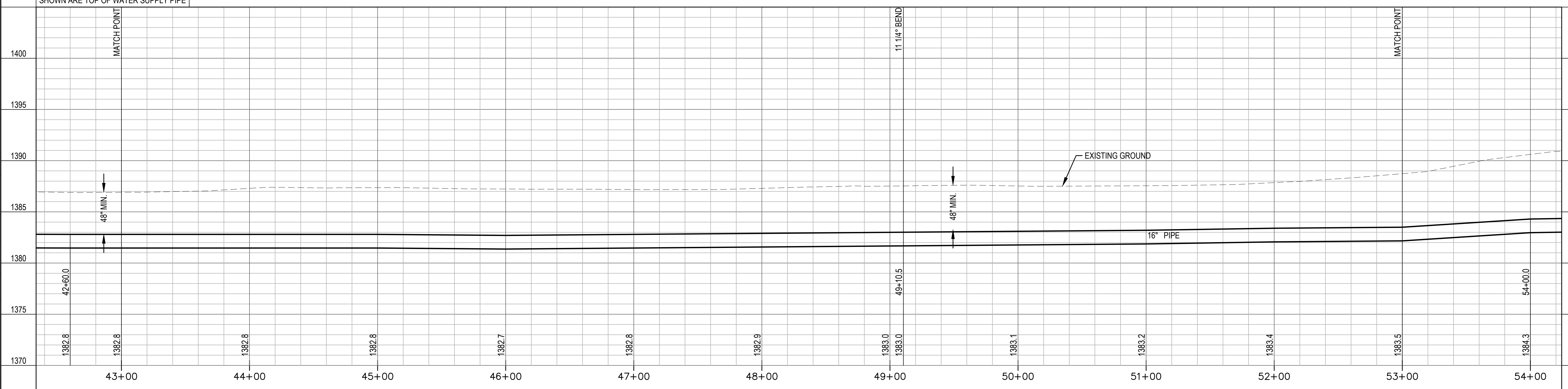

REVISIONS:

Environment & Infrastructure Solutions, Inc.
 245 N. WACO AVENUE, SUITE 110
 WICHITA, KANSAS 67202
 PHONE: 316-448-2711
 FAX: 316-448-2711

M27 & M28 SPURLINE(5)
 EQUUS WELLFIELD SPURLINE REPLACEMENT
 GARY JANZEN, P.E. - CITY ENGINEER
 CITY OF WICHITA

DESIGNED BY: EJB
 DRAWN BY: JAN
 CHECKED BY: ---
 DATE: MAY 24, 2022

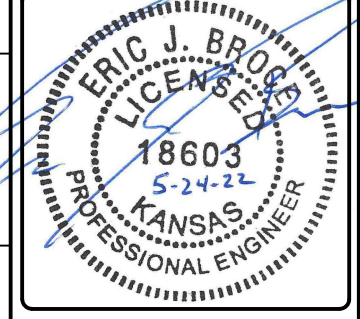

PROJECT NO.
639020

SHEET NO.
10
OF 35

Last saved by: alex.mckeen - Plotted By: Mckean, Alex Plot Date/Time: 5/24/2022 1:29 PM
 File: L:\8275000373 Wichita Spurline\05 CAD\Sheets\Bid Package 3\M28-3.dwg