

* PRIOR TO BEGINNING CONSTRUCTION, THE CONTRACTOR SHALL EXCAVATE THE EXISTING WATERLINE AT STA. 10+00.00 TO VERIFY PIPE SIZE, TYPE, FITTINGS, & HORIZONTAL & VERTICAL LOCATION. THE CONTRACTOR SHALL REPORT HIS FINDINGS TO THE ENGINEER SO THAT ANY NECESSARY PLAN MODIFICATIONS MAY BE MADE. ANY ADDITIONAL LABOR OR MATERIALS NECESSARY TO COMPLETE THE CONNECTION SHALL BE CONSIDERED SUBSIDIARY TO THE PROJECT.

✕ DENOTES PIPE TO BE ABANDONED

** PRIOR TO BEGINNING CONSTRUCTION, THE CONTRACTOR SHALL EXCAVATE THE EXISTING 8" GAS LINE (ABANDONED) AT STA. 17+00.9 AND REPORT VERTICAL INFORMATION TO THE ENGINEER SO THAT ANY NECESSARY PLAN MODIFICATIONS MAY BE MADE. CONTRACTOR SHALL ALSO COORDINATE WITH JAYHAWK PIPELINE AT (316)-755-0241 EXT. 23 FOR CUTTING AND CAPPING THEIR ABANDONED PIPELINE IF NECESSARY.

M33 SPUR LINE

UNLESS NOTED OTHERWISE, ELEVATIONS SHOWN ARE TOP OF WATER SUPPLY PIPE

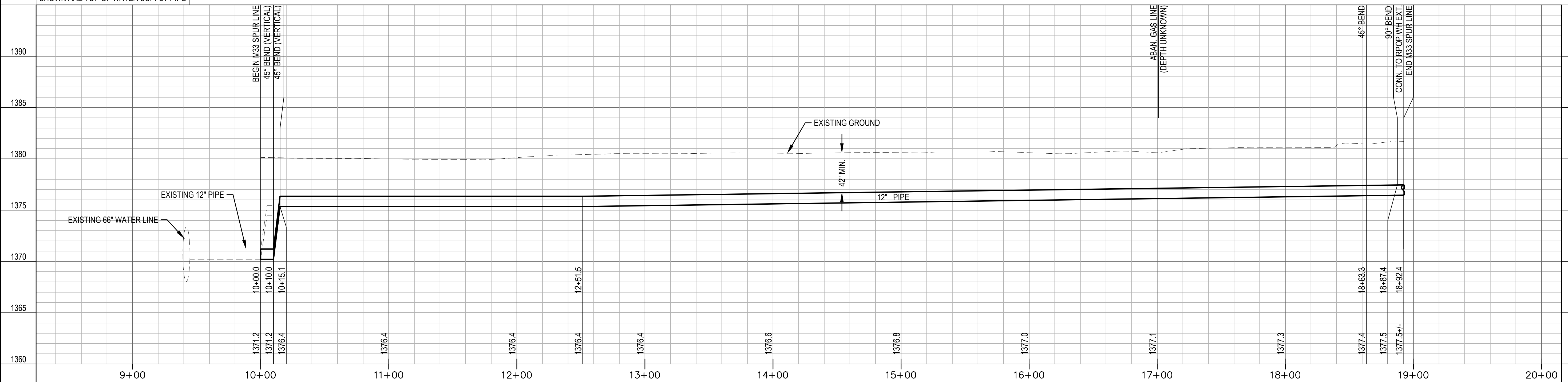
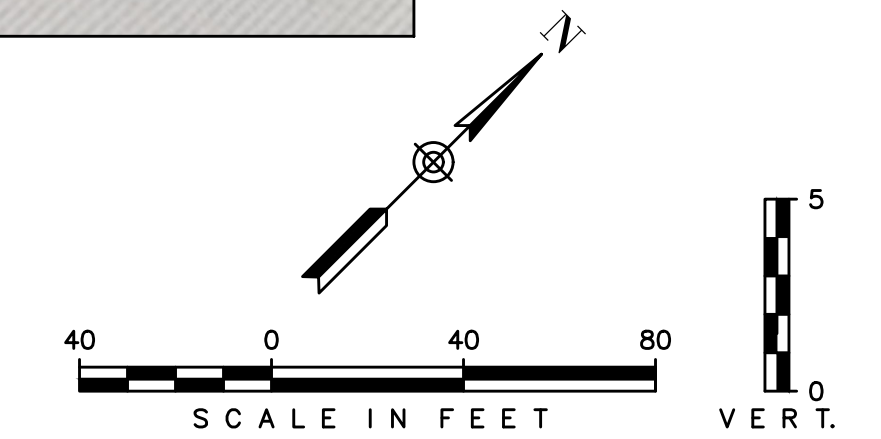

| NO. | DATE | DESCRIPTION |
|-----|------|-------------|
| | | |
| | | |
| | | |
| | | |
| | | |

Environment & Infrastructure Solutions, Inc.
 245 N. WACO AVENUE, SUITE 110
 WICHITA, KANSAS 67202
 PHONE: 316-448-2711
 FAX: 316-448-2711



M33 SPURLINE
 EQUUS WELLFIELD SPURLINE REPLACEMENT
 GARY JANZEN, P.E. - CITY ENGINEER
 CITY OF WICHITA

DESIGNED BY: EJB
 DRAWN BY: JAN
 CHECKED BY: ---
 DATE: MAY 24, 2022

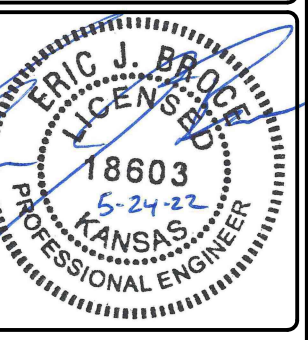

PROJECT NO.
639020

SHEET NO.
12
OF 35

Last saved by: alex.mckeen Plotted By: Mckean, Alex Plot Date/Time: 5/24/2022 1:30 PM File: L:\8275000373 Wichita Spurline\05_CAD\Sheets\Bid Package_6\M33.dwg