

BENCHMARK #1:
Chiseled plus cut inside chiseled square, SE Cor. of catch basin on S. side of Apollo St., 32.5' W. to line of back of east curb of drive north, 11' E. to line of end of curb north, 103.2' ENE. of deflection cor., N. Line. Lot 9, Block A, Abilene Place Add.
Elev. = 1432.98 NAVD88

BENCHMARK #2:
Chiseled plus cut inside chiseled square, top of curb, most southerly SW Cor. of parking lot, 17.6' S. to back of N. curb of Apollo St., 34.7' WSW to centerline of light pole base, 114.3' E. & 143.5' N. of NW. Cor., Reserve "A", Abilene Place Add.
Elev. = 1435.32 NAVD88

Construct 961 L.F. Cut-off Trench & Berm

Install 2,475 S.Y. North American Green Bionet S150BN Biodegradable Erosion Control Mat, or approved equal around pond as indicated (See Detail, this sheet). Erosion control mat shall be installed and anchored per manufacturer's specifications. Note: This quantity is for information only and does not include excess material necessary for overlap and anchoring.

Install 515 S.Y. 6" D-50 Stone Rip-Rap around pond as Indicated. (See pond section, this sheet)

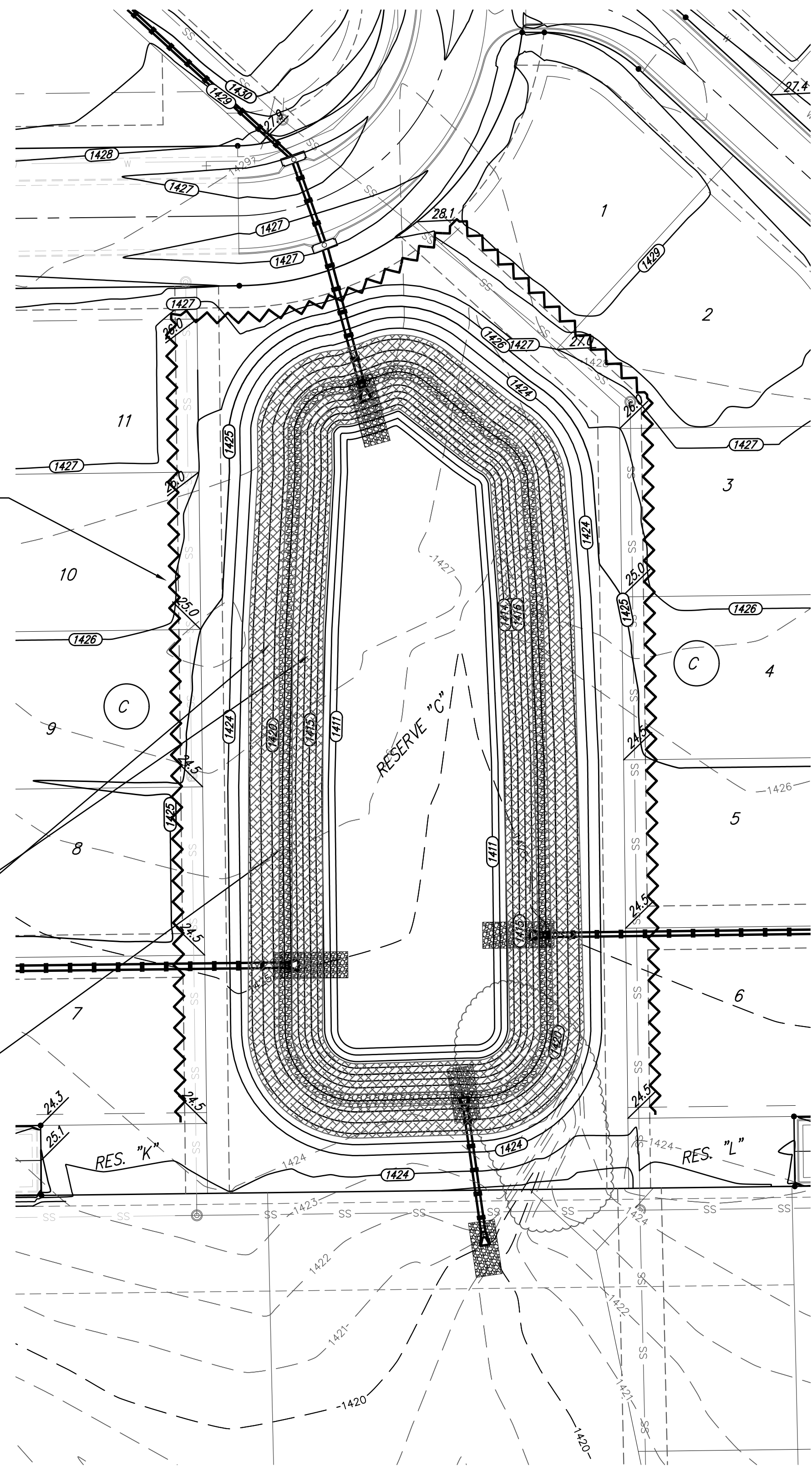

POND DATA:
STATIC POOL ELEVATION: 1419.0
BOTTOM ELEVATION: 1411.0
100 YEAR DWS: 1423.6

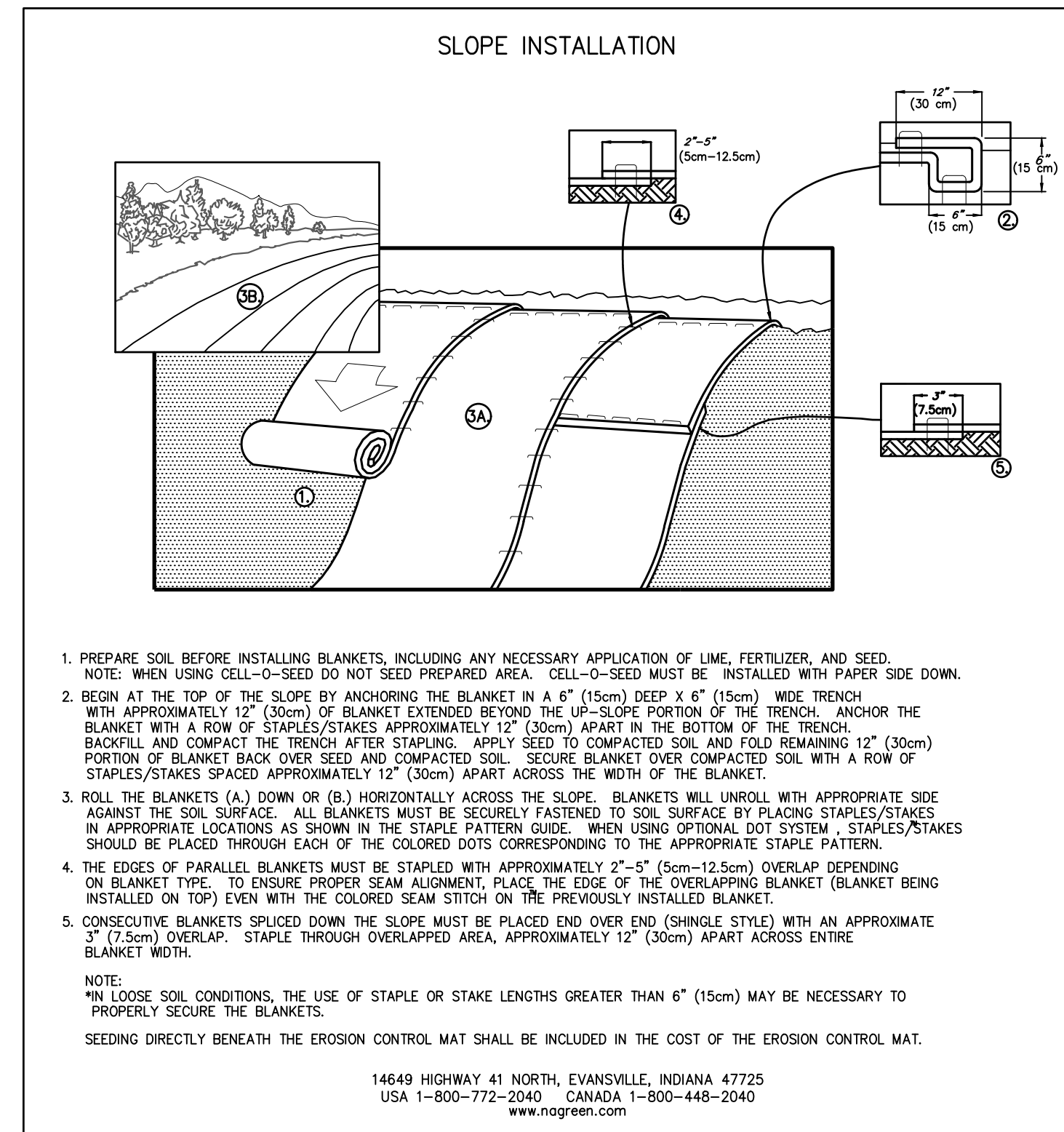

- PREPARE SOIL BEFORE INSTALLING BLANKETS, INCLUDING ANY NECESSARY APPLICATION OF LIME, FERTILIZER, AND SEED. NOTE: WHEN USING CELL-O-SEED DO NOT SEED PREPARED AREA. CELL-O-SEED MUST BE INSTALLED WITH PAPER SIDE DOWN.
 - BEGIN AT THE TOP OF THE SLOPE BY ANCHORING THE BLANKET IN A 6" (15cm) DEEP X 6" (15cm) WIDE TRENCH WITH APPROXIMATELY 12" (30cm) OF BLANKET EXTENDED BEYOND THE UP-SLOPE PORTION OF THE TRENCH. ANCHOR THE BLANKET WITH A ROW OF STAPLES/STAKES APPROXIMATELY 12" (30cm) APART IN THE BOTTOM OF THE TRENCH. BACKFILL AND COMPACT THE TRENCH AFTER STAPLING. APPLY SEED TO COMPACTED SOIL AND FOLD REMAINING 12" (30cm) PORTION OF BLANKET BACK OVER SEED AND COMPACTED SOIL. SECURE BLANKET OVER COMPACTED SOIL WITH A ROW OF STAPLES/STAKES SPACED APPROXIMATELY 12" (30cm) APART ACROSS THE WIDTH OF THE BLANKET.
 - ROLL THE BLANKETS (A) DOWN OR (B) HORIZONTALLY ACROSS THE SLOPE. BLANKETS WILL UNROLL WITH APPROPRIATE SIDE AGAINST THE SOIL SURFACE. ALL BLANKETS MUST BE SECURELY FASTENED TO SOIL SURFACE BY PLACING STAPLES/STAKES IN APPROPRIATE LOCATIONS AS SHOWN IN THE STAPLE PATTERN GUIDE. WHEN USING OPTIONAL DOT SYSTEM, STAPLES/STAKES SHOULD BE PLACED THROUGH EACH OF THE COLORED DOTS CORRESPONDING TO THE APPROPRIATE STAPLE PATTERN.
 - THE EDGES OF PARALLEL BLANKETS MUST BE STAPLED WITH APPROXIMATELY 2"-5" (5cm-12.5cm) OVERLAP DEPENDING ON BLANKET TYPE. TO ENSURE PROPER SEAM ALIGNMENT, PLACE THE EDGE OF THE OVERLAPPING BLANKET (BLANKET BEING INSTALLED ON TOP) EVEN WITH THE COLORED SEAM STITCH ON THE PREVIOUSLY INSTALLED BLANKET.
 - CONSECUTIVE BLANKETS SPICED DOWN THE SLOPE MUST BE PLACED END OVER END (SHINGLE STYLE) WITH AN APPROXIMATE 3" (7.5cm) OVERLAP. STAPLE THROUGH OVERLAPPED AREA, APPROXIMATELY 12" (30cm) APART ACROSS ENTIRE BLANKET WIDTH.
- NOTE:
*IN LOOSE SOIL CONDITIONS, THE USE OF STAPLE OR STAKE LENGTHS GREATER THAN 6" (15cm) MAY BE NECESSARY TO PROPERLY SECURE THE BLANKETS.
SEEDING DIRECTLY BENEATH THE EROSION CONTROL MAT SHALL BE INCLUDED IN THE COST OF THE EROSION CONTROL MAT.
- 14649 HIGHWAY 41 NORTH, EVANSVILLE, INDIANA 47725
USA 1-800-772-2040 CANADA 1-800-448-2040
www.nogreen.com

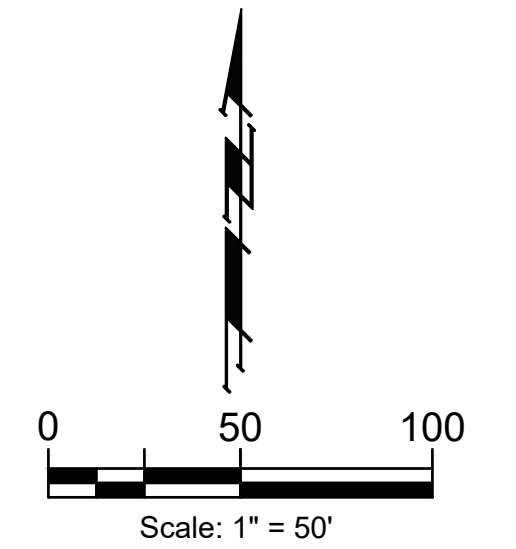
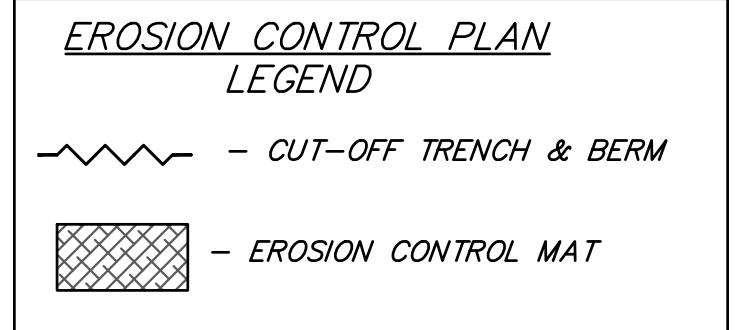
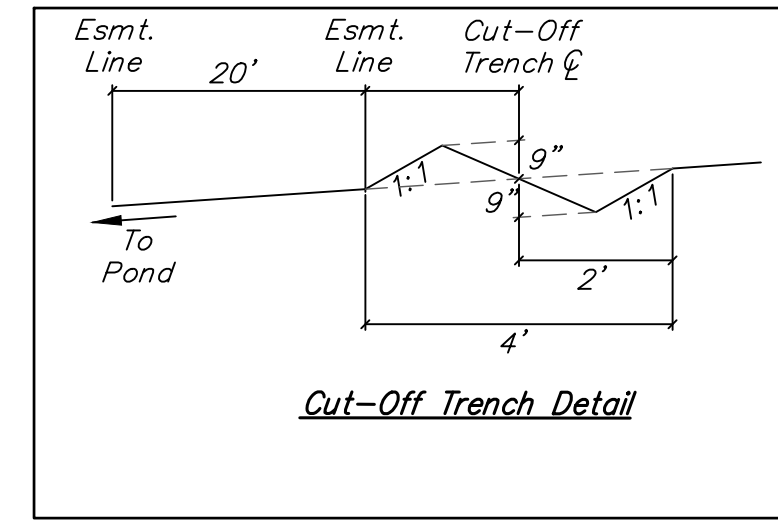
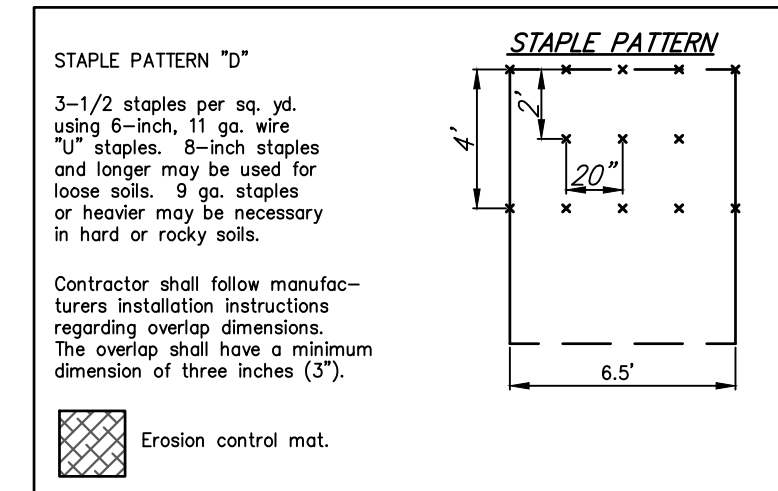

POND NOTES:

- Pond bottom and sideslopes below static pool elevation shall be over-excavated 18" and a 1" clay liner shall be compacted to 95% std. density. An additional 6" of on-site material; shall be placed over liner. The plasticity index (P.I.) shall be at least 27. The compaction and P.I. shall be verified during construction. P.I. determination and compaction testing shall be arranged by the Contractor at the request of the inspector. Cost shall be incidental to "Testing". Cost of over-excavation to install Clay Liner shall be incidental to bid item "Excavation"
- Install Biodegradable Erosion Control Mat (North American Green Bionet S150BN or approved equal) around pond as indicated (cost to be including in "Erosion Control")
- Contractor to strip top 4-6" of soil within street R/W's and Reserve "C" before mass grading and stockpile. Topsoil stockpile to be redistributed over Reserve "C" above water elevation prior to seeding (incidental to C.Y. Excavation).
- Earthwork Quantities reflect the best available topography at time of design. The Contractor shall satisfy himself with the Earthwork Quantities associated with Bid Item "Excavation" prior to bidding. No additional payments or change orders for earthwork will be accepted.

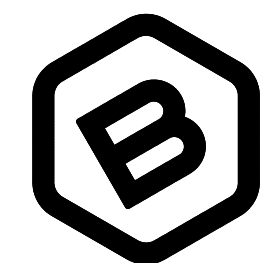
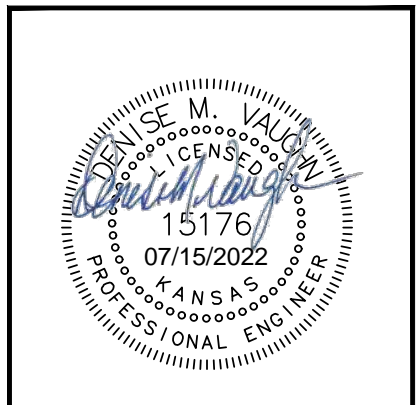
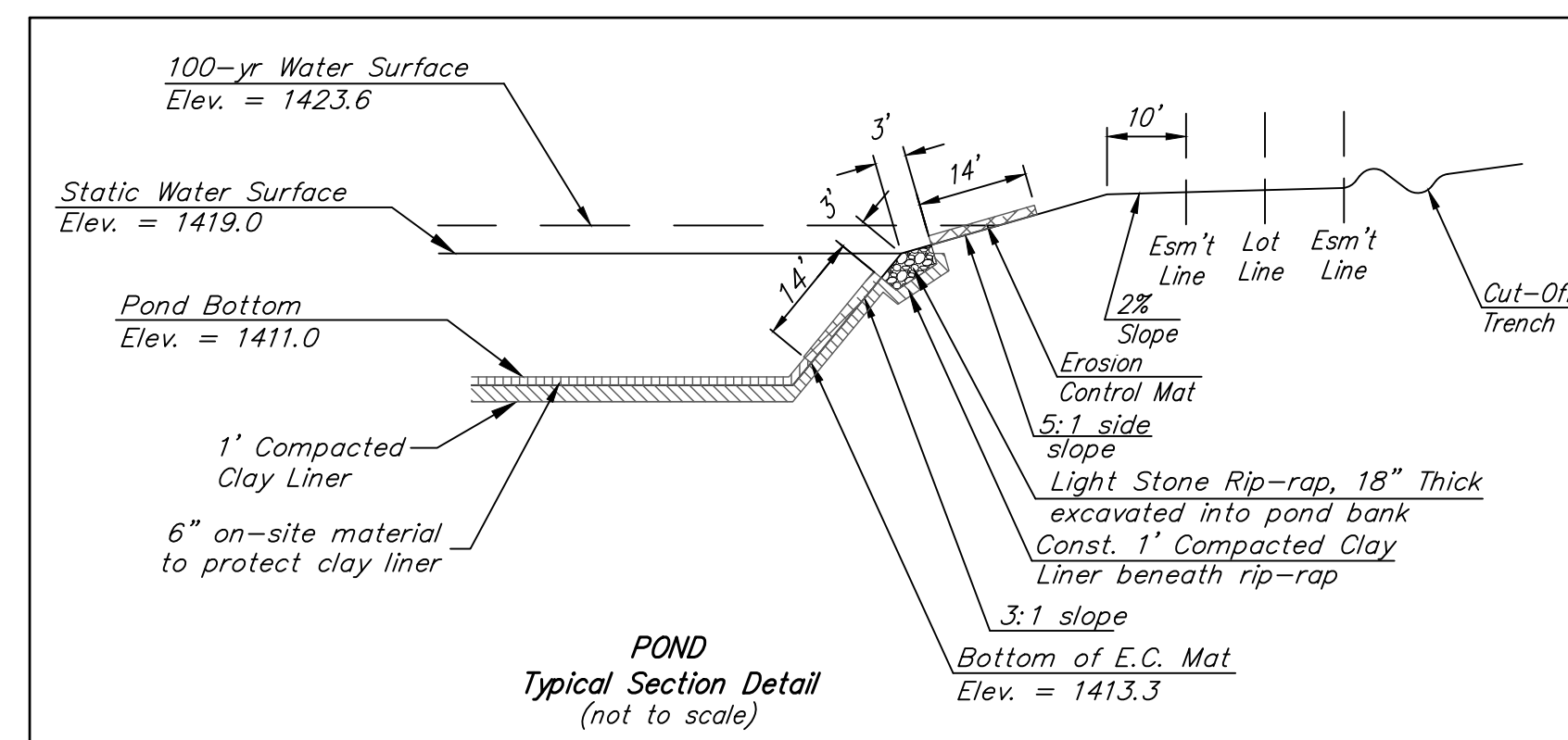

BAUGHMAN COMPANY

315 Ellis St.
Wichita, KS 67211
316-262-7271
BaughmanCo.com

ABILENE PLACE ADDITION

POND PLAN

STORM WATER DRAIN IMPROVEMENTS

PROJECT NUMBER:

DESIGN: DMV DRAWN: JAK

DATE: Apr. 19, 2022

SHEET OF

18 30