

CONSULTANTS:

AMIDON AVE. BRIDGE
 AT ARKANSAS RIVER

WICHITA, KANSAS

REVISIONS:	MARK	DATE	DESCRIPTION

PROJ NO: E1010-4025062
 SCALE:
 DATE: 07/08/2022
 DESIGNED BY: JBM
 DRAWN BY: JBM
 CHECKED BY: WBS

SHEET TITLE:
**ABUTMENT
 SUBSTRUCTURE
 DETAILS**

SHEET NO.
35
 SHEET 35 OF 128

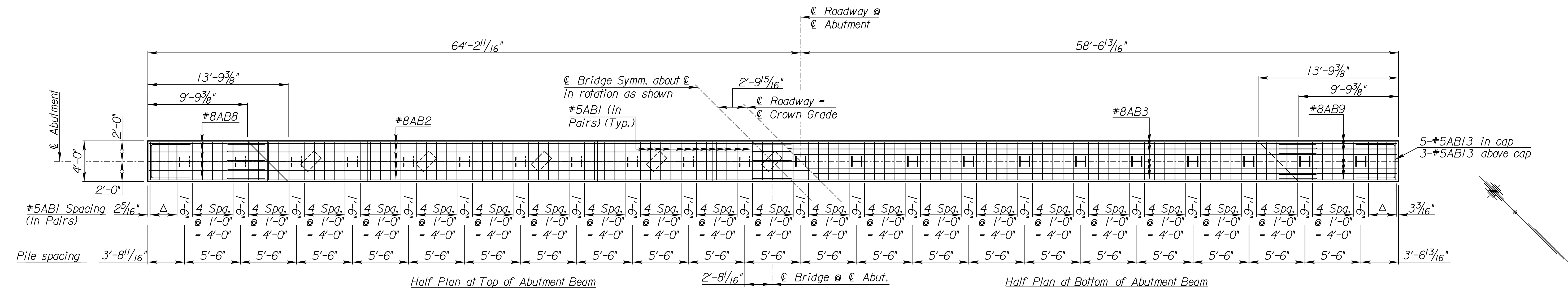

PLAN

(Abut. No. 2 Shown. Abut. No. 1 Similar)

NOTE: \ominus Roadway is not \ominus Bridge

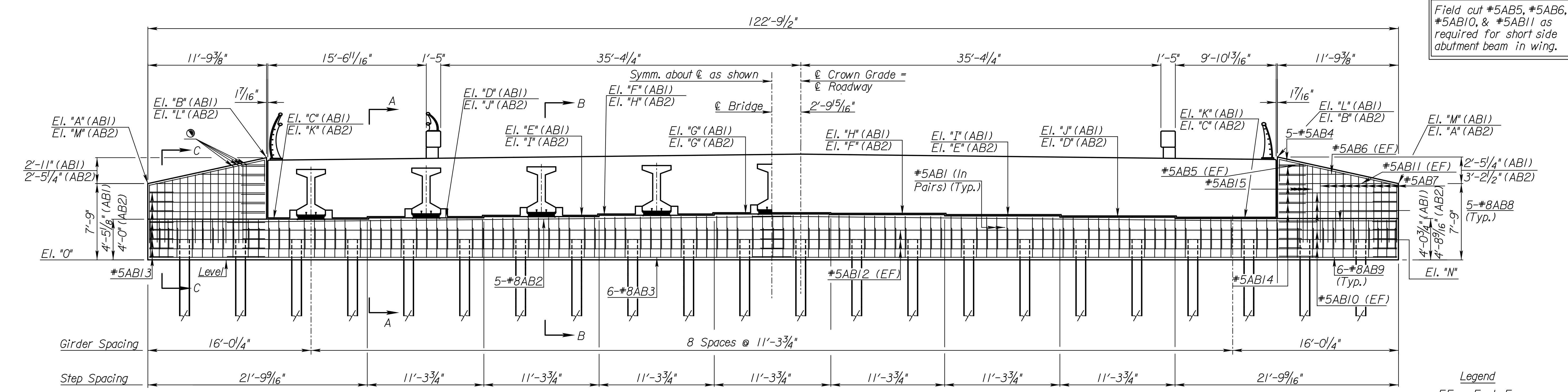

ELEVATION

(Abut. No. 2 Shown. Abut. No. 1 Similar)

Place first bar parallel to abutment wing wall face then rotate subsequent bars 9° until parallel with wing end. See "Abutment Superstructure Details" sheet for spacing.

LRFD DESIGN PILE LOAD:

Design Loading (Tons/Pile)	Strength I	Service I	Phi
Abutments	87	59	.65

Min. lap for a #5 bar is 2'-4" (This sheet only.)
 Min. lap for a #8 bar is 3'-10" (This sheet only.)
 See Sheet "Abutment Sections" for Sections

Note: The elevations shown are theoretical based on 8 1/2" deck + 2" fillet @ \ominus beam + 4'-9" beam + 4 7/8" bearing device. NOTE THAT BEARING RECESSES ARE 1/2" LOWER THAN TOP OF CAP ELEVATIONS LISTED DUE TO THE RECESS.

Abutment	"A"	"B"	"C"	"D"	"E"	"F"	"G"	"H"	"I"	"J"	"K"	"L"	"M"	"N"	"O"
Abutment No. 1 (AB1)	1313.25	1316.17	1309.93	1310.03	1310.13	1310.23	1310.33	1310.19	1309.96	1309.73	1309.50	1315.69	1313.25	1307.50	1305.50
Abutment No. 2 (AB2)	1312.53	1315.74	1309.49	1309.57	1309.66	1309.74	1309.74	1309.50	1309.26	1309.02	1308.78	1314.97	1312.53	1306.78	1304.78

Note: Top of piling Elevations are based on 2'-0" maximum embedment.

