

LEGEND

-  Pavement Removal
-  Tree Removal

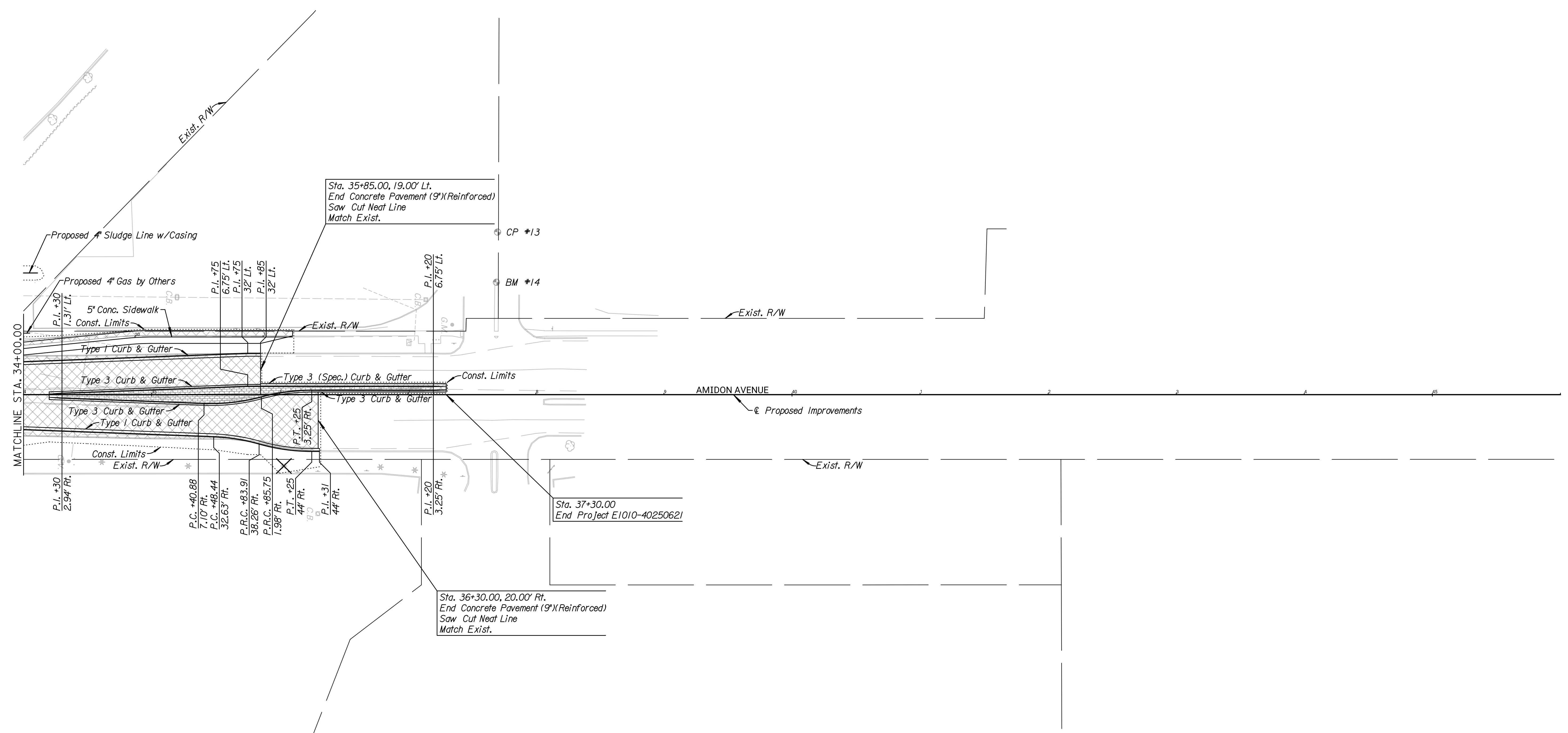
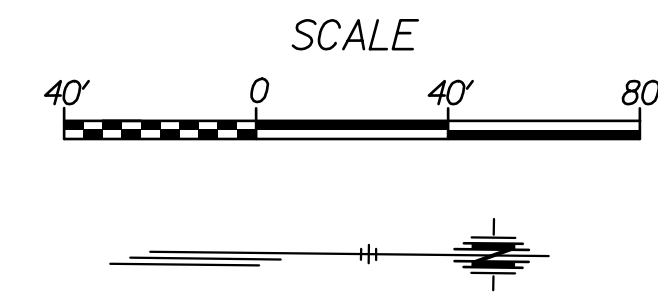

Sta. 35+85.00, 19.00' Lt.  
End Concrete Pavement (9\"/>

Sta. 37+30.00  
End Project E1010-40250621

Sta. 36+30.00, 20.00' Rt.  
End Concrete Pavement (9\"/>

CP - #13  
Set chiseled "X"  
1. In concrete island & of Meridian Ave  
2. 3' E of W end  
N 1641054.79  
E 1697378.48  
126.97' Lt., Sta. 37+70.11, Elev. = 1,310.27

BM - #14  
Set chiseled "□" in sidewalk, 1' W of  
light pole, 55' NE of guy wire.  
N 1641093.80  
E 1697378.27  
87.77' Lt., Sta. 37+69.20, Elev. = 1,310.78

- Utility Owners**
- Power: Evergy
  - Telephone: Cox Communications
  - Telephone: AT&T
  - Gas: Kansas Gas Service
  - Sludge Line: City of Wichita Public Works
  - Water: City of Wichita Water Dept.
  - Storm Water: City of Wichita Storm Sewer
  - Sanitary Sewer: City of Wichita Sanitary Sewer

**Tran Systems**

245 NORTH WACO  
SUITE 222  
WICHITA, KANSAS 67202  
PHONE: 316-303-3000  
FAX: 316-462-5629

CONSULTANTS:

AMIDON AVENUE BRIDGE  
at ARKANSAS RIVER

WICHITA, KANSAS



REVISIONS:	MARK	DATE	DESCRIPTION

PROJ NO: E1010-40250621  
SCALE: 1"=40'  
DATE: 7/13/2022  
DESIGNED BY: CKC  
DRAWN BY: CKC  
CHECKED BY: MDB

SHEET TITLE:  
**AMIDON AVENUE  
PLAN  
STA. 34+00.00 TO  
STA. 37+30.00**

SHEET NO.  
**7**

SHEET 7 OF 128