







SIGN LEGEND

- ① W20-3 ROAD CLOSED 500 FT
- ② W20-3 ROAD CLOSED 1000 FT
- ③ W20-3 ROAD CLOSED 1500 FT
- ④ W20-3 ROAD CLOSED 1/2 MILE
- ⑤ R11-2 ROAD CLOSED
- ⑥ KG20-2 END ROAD WORK
- ⑦ R11-4 ROAD CLOSED AHEAD LOCAL TRAFFIC ONLY
- ⑧ W1-7 BI-DIRECTIONAL ARROW
- ⑨ W20-1 ROAD WORK AHEAD
- ⑩ D3-1 AMIDON AVENUE
- ⑪ D3-1 21st STREET
- ⑫ D3-1 13th STREET
- ⑬ M4-8 **DETOUR**
- ⑭ M6-1R 
- ⑮ M6-1L 
- ⑯ M6-3 
- ⑰ M4-8a **END DETOUR**
- ⑱ W20-2 **DETOUR AHEAD**
- ⑲ M6-4 

LEGEND

-  Traffic Control Sign
-  Type III Barricade
-  Type III Barricade w/ Sign

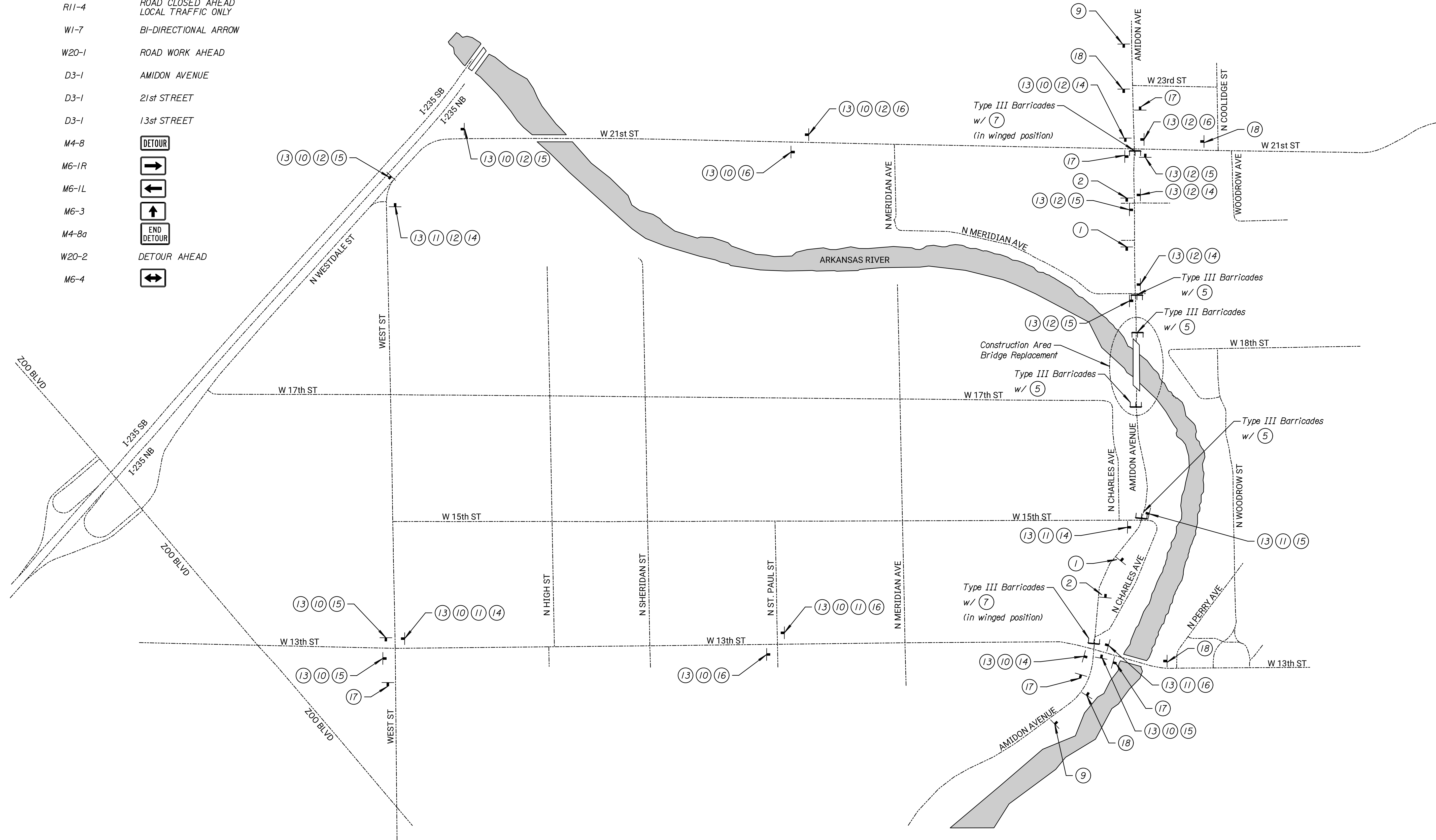

**Tran Systems**  
 245 NORTH WACO  
 SUITE 222  
 WICHITA, KANSAS 67202  
 PHONE: 316-303-3000  
 FAX: 316-462-5629

CONSULTANTS:

**AMIDON AVENUE BRIDGE at ARKANSAS RIVER**  
 WICHITA, KANSAS  

REVISIONS:	MARK	DATE	DESCRIPTION

PROJ NO: E1010-40250621  
 SCALE: 1"=1"  
 DATE: 7/13/2022  
 DESIGNED BY: CKC  
 DRAWN BY: CKC  
 CHECKED BY: MDB

SHEET TITLE:  
**TRAFFIC DETOUR MAP**

SHEET NO.  
**95**  
 SHEET 95 OF 128

danawano 7/13/2022 10:56:30 AM c:\transtransystems\paw\_bocalltransystems\paw\idawarold\08357C-CPP-M01-401.DGN