

d:\navano 7/13/2022 - 10:56:44 AM c:\tran\systems\pwworking\tran\systems\pwworking\dana\arold\108357\C-CPP-M01-101.dgn

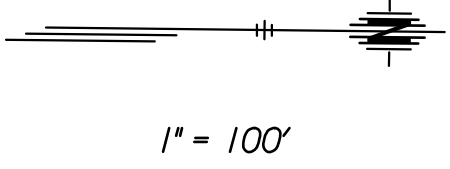
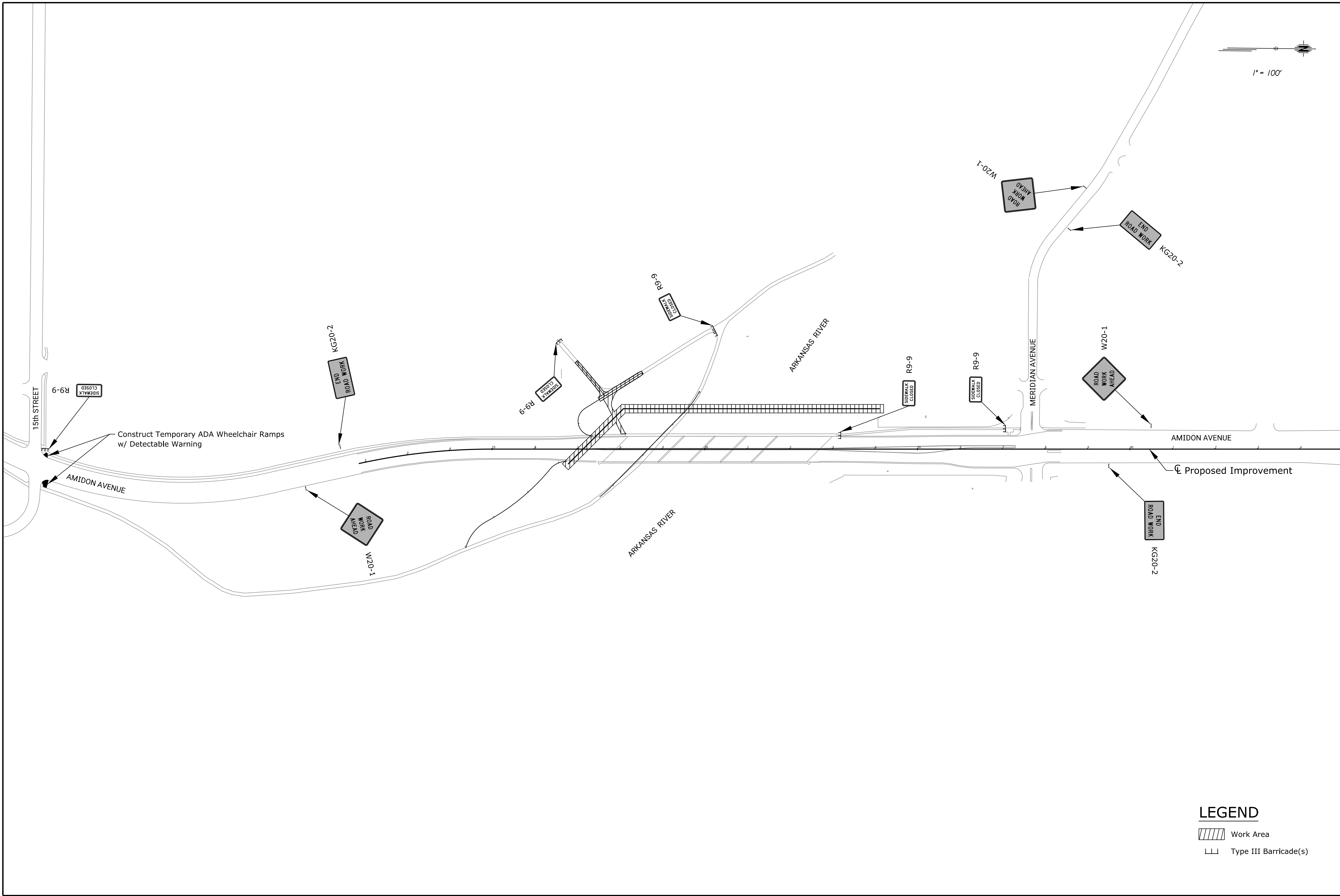

LEGEND

- Work Area
- Type III Barricade(s)

Tran Systems
 245 NORTH WACO
 SUITE 222
 WICHITA, KANSAS 67202
 PHONE: 316-303-3000
 FAX: 316-462-5629

CONSULTANTS:

**AMIDON AVENUE BRIDGE
 at ARKANSAS RIVER**

WICHITA, KANSAS

| REVISIONS: | MARK | DATE | DESCRIPTION |
|------------|------|------|-------------|
| | | | |
| | | | |
| | | | |
| | | | |
| | | | |
| | | | |
| | | | |
| | | | |
| | | | |
| | | | |

PROJ NO: E1010-40250621
 SCALE: 1"=100'
 DATE: 7/13/2022
 DESIGNED BY: JAS
 DRAWN BY: DJB
 CHECKED BY: CKC

SHEET TITLE:
**AMIDON AVENUE
 SEQUENCING PLAN
 PHASE 1**

SHEET NO.
96
 SHEET 96 OF 128