

BENCHMARKS:
 BM #1: "□" Cut in face of curb inlet near SE corner of Lot 30, Block C, Gray's 5th Add.
 Elev. = 1297.86 NAVD88
 BM #2: "□" Cut in top of curb on east side of Flora, ±10' north of south property line of Gray's 5th Add.
 Elev. = 1302.40 NAVD88
 BM #4: "□" Cut in top of curb on east side of Flora, adjacent to common lot line of Lots 3&4, Block C, Gray's 5th Add.
 Elev. = 1305.32 NAVD88

Baseline = ϕ Doris Ct.

WATER VALVE LOCATION TABLE

VALVE NUMBER	STREET	BASELINE STATION	OFFSET DISTANCE	OFFSET DIRECTION
V10	Doris Ct	0+63.0	23'	Lt.
V11	Doris Ct	4+20.6	39.7'	Rt.

Paving contractor will be responsible to operate all water valves on the project, in the presence of the inspector, to ensure accessibility to the valves, and that all valves (except blowoffs) are left in the "ON" position when the project is completed.

NOTE: ROLL TYPE CURB & GUTTER TO BE CONSTRUCTED ON THE PAVEMENT SHOWN ON THIS SHEET. TOP OF CURB ELEVATIONS ARE GIVEN FOR FULL HEIGHT CURB (0.25' DIFFERENCE).

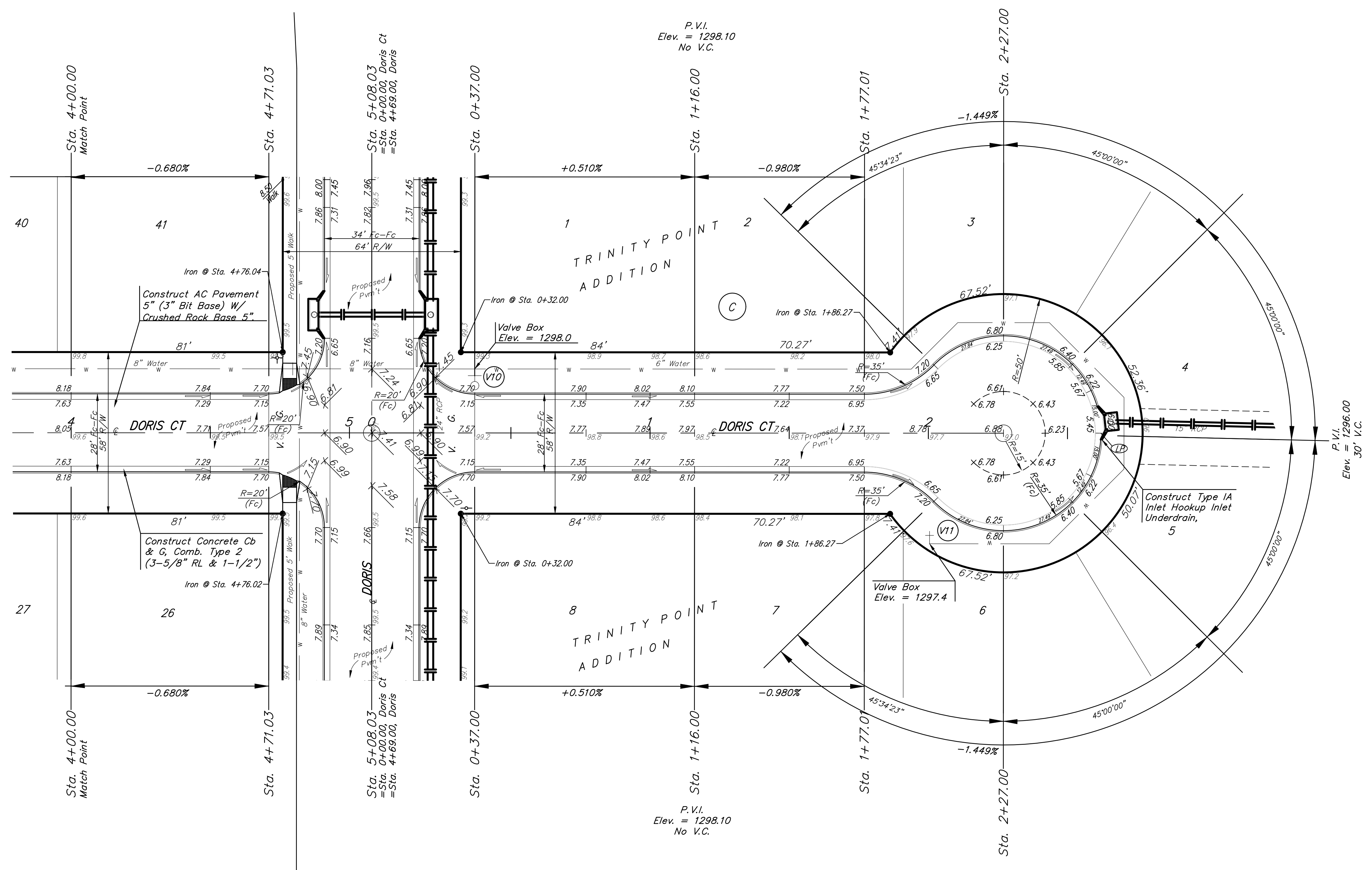
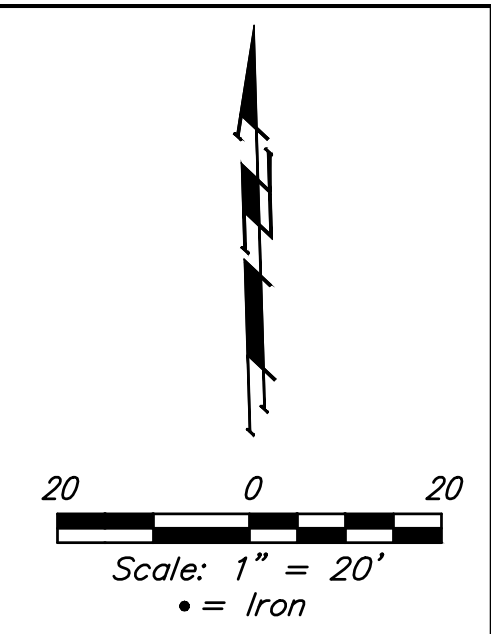

Baughman Company, P.A.
 ENGINEERING, ARCHITECTURE, PLANNING & LANDSCAPE ARCHITECTURE
 1100 W. FLORISSANT AVE., SUITE 200, FORT WORTH, TEXAS 76104
 PHONE: 817.335.1100 FAX: 817.335.1101
 WWW.BAUGHMANCOMPANY.COM
 APPROVED: [Signature] DATE: 07/22

TRINITY POINT ADDITION, PHASE II
 DORIS CT (NW) &
 DORIS CT (NE)
 STREET & SWS IMPROVEMENTS