

J:\PROJECTS\2019\10\10338\_ESTANCIA\_SECOND\_18338\_CAD\SHS\05 CIVIL\PAV\PH2\18338-05-2021.DWG  
 PLOTTED: Monday, August 01, 2022 10:09AM

SUBDIVISION BENCH MARKS				
NO.	STREET AND STATION	FROM CL	DESCRIPTION	ELEVATIONS
1	STREET NAME, STA. XX+XX.XX	XX.X' XT	TOP OF CURB AT FIRE HYDRANT	
2	STREET NAME, STA. XX+XX.XX	XX.X' XT	TOP OF CURB AT W END OF INLET HOOKUP	

NOTE: CONTRACTOR SHALL INSTALL SUBDIVISION BENCH MARKS ("FLAT SURVEY MARKERS NO. 8134-08 3" TOP DIAMETER" PROVIDED BY KANSAS BLUE PRINT CO., INC.) COSTS TO BE CONSIDERED SUBSIDIARY TO CONSTRUCTION OF COMBINED CURB AND GUTTER.

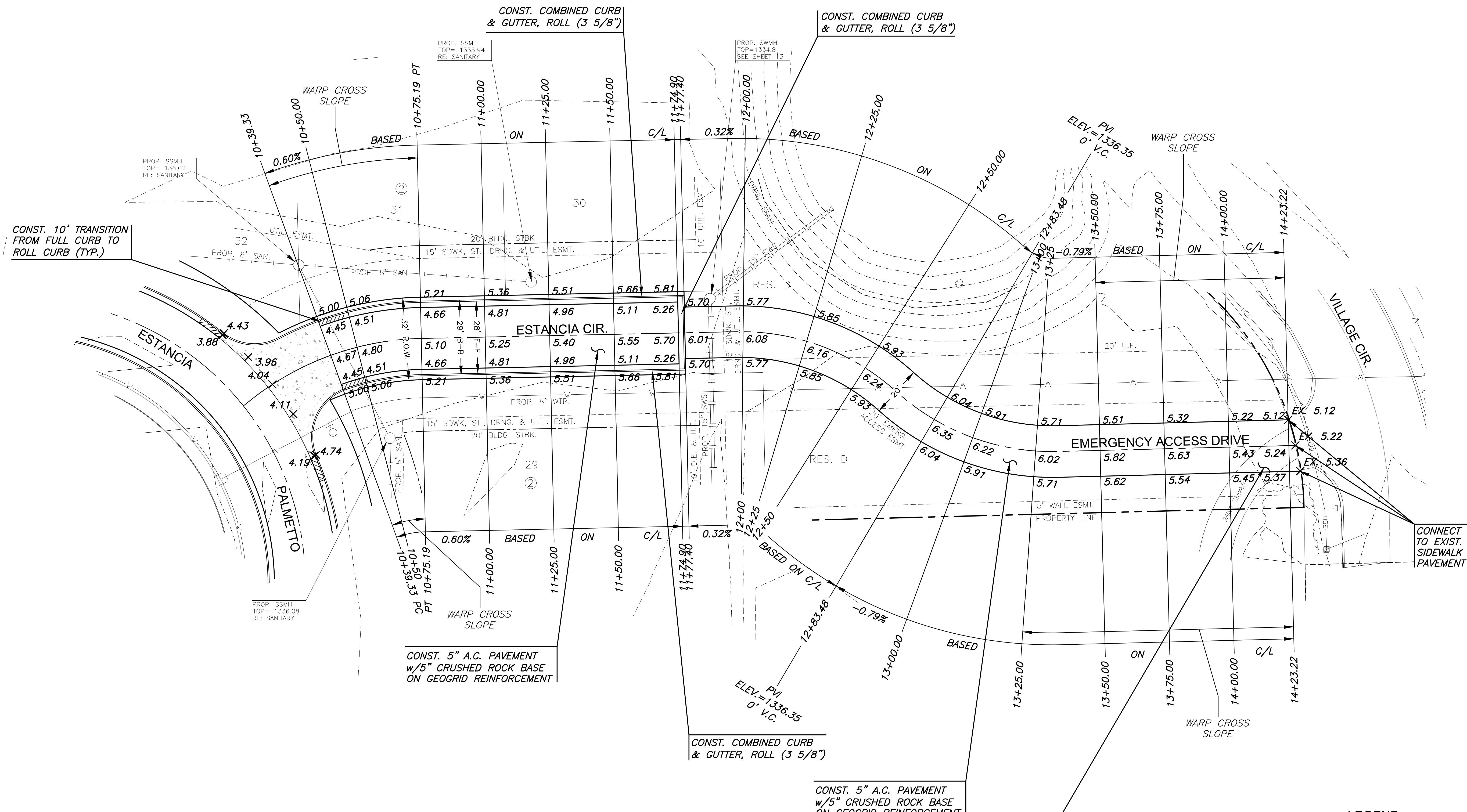

PAVING AND INCIDENTAL DRAINAGE PLANS FOR  
**ESTANCIA 2ND ADDITION**  
 PHASE 2

©2022  
 MKEC Engineering  
 All Rights Reserved  
 www.mkec.com  
 These drawings and their contents, including, but not limited to, all concepts, designs, & ideas are the exclusive property of MKEC Engineering (MKEC), and may not be used or reproduced in any way without the express consent of MKEC.

**ESTANCIA CIR. & EMERGENCY ACCESS DRIVE**

PROJECT NO.	472-2019-085561
DATE	07/28/2022
SCALE	1"=20'
DESIGNED	DFL
DRAWN	C-JL
CHECKED	SPE

NO.	REVISION	DATE

**LEGEND**

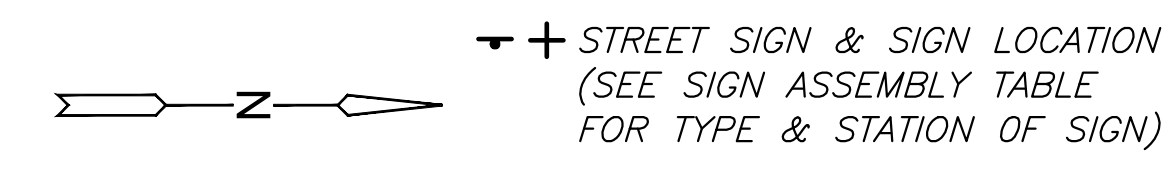

NOTE:  
 TOP OF CURB ELEVATIONS SHOWN ARE FOR FULL CURB. CONSTRUCT CURB AND GUTTER AS NOTED.

RECONSTRUCT GRAVEL DRIVE TO MATCH PROP. ASPHALT PAVEMENT. COST SUBSIDIARY TO PROJECT. COORDINATE WORK IN THIS AREA WITH EXISTING HOMEOWNER TO EAST.