

BENCHMARKS:

BM #1: "+" Cut on N. San. Sewer MH rim approx. 3' S. & 3' W of Lot 2, Block C, Towne Parc 8th Add. Elev. = 1399.12 NAVD88

BM #2: "+" Cut on N. San. Sewer MH rim approx. 21.1' S. & 3' W of Lot 8, Block C, Towne Parc 8th Add. Elev. = 1393.99 NAVD88

BM #3: "□" Cut on top of curb 16.7' N. of NE corner Lot 7, Block 2, Turtle Run 3rd Add. Elev. = 1390.32 NAVD88

BM #4: "+" Cut on E. top of curb Adjacent to Lots 6 & 7, Block A, Towne Parc 4th Add. Elev. = 1397.86 NAVD88

Baseline = ϕ Creed

WATER VALVE LOCATION TABLE

VALVE NUMBER	STREET	BASELINE STATION	OFFSET DISTANCE	OFFSET DIRECTION
V1	Creed	0+00.00	26'	Lt.

Paving contractor will be responsible to operate all water valves on the project, in the presence of the inspector, to ensure accessibility to the valves, and that all valves (except blowoffs) are left in the "ON" position when the project is completed.

NOTE: ROLL TYPE CURB & GUTTER TO BE CONSTRUCTED ON THE PAVEMENT SHOWN ON THIS SHEET. TOP OF CURB ELEVATIONS ARE GIVEN FOR FULL HEIGHT CURB (0.25' DIFFERENCE).

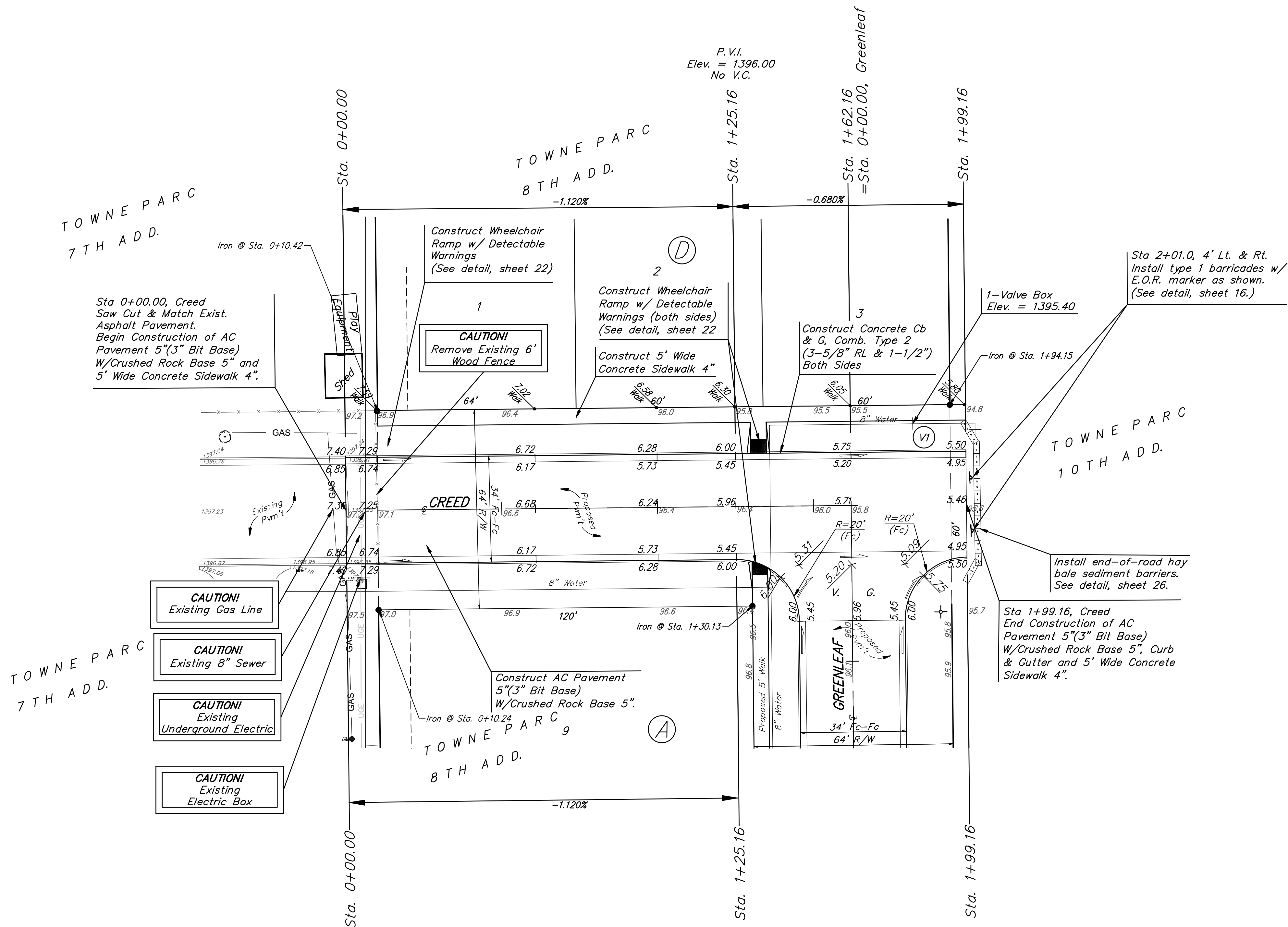
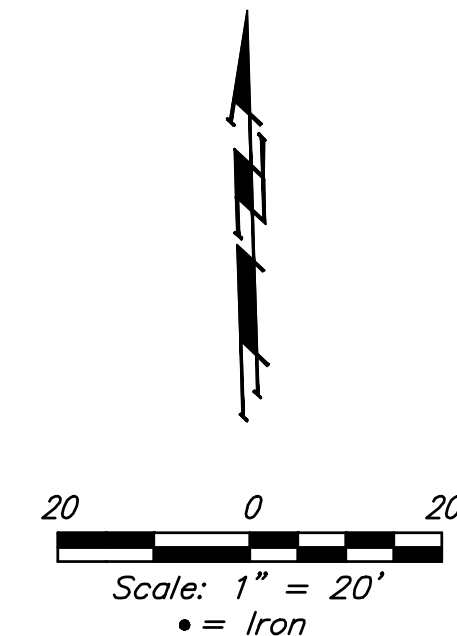

Sta 0+00.00, Creed Saw Cut & Match Exist. Asphalt Pavement. Begin Construction of AC Pavement 5"(3" Bit Base) W/Crushed Rock Base 5" and 5' Wide Concrete Sidewalk 4".

- CAUTION! Existing Gas Line
- CAUTION! Existing 8" Sewer
- CAUTION! Existing Underground Electric
- CAUTION! Existing Electric Box

Sta 2+01.0, 4' Lt. & Rt. Install type 1 barricades w/ E.O.R. marker as shown. (See detail, sheet 16.)

Install end-of-road hay bale sediment barriers. See detail, sheet 26.

Sta 1+99.16, Creed End Construction of AC Pavement 5"(3" Bit Base) W/Crushed Rock Base 5", Curb & Gutter and 5' Wide Concrete Sidewalk 4".

Baughman Company, P.A.
 PROFESSIONAL ENGINEERS
 ENGINEERING LICENSE NO. 11553
 ARCHITECTURE LICENSE NO. 11553
 APPROVED: [Signature] DATE: 07/22

TOWNE PARC 8TH ADDITION
CREED
 STREET & SWS IMPROVEMENTS