

STORM SEWER IMPROVEMENTS

to serve

GILBERT STREET

CITY OF WICHITA, KANSAS

Gary Janzen, P.E. City Engineer
 Project Number 458-2022-085509
 Org Code Number 56092070

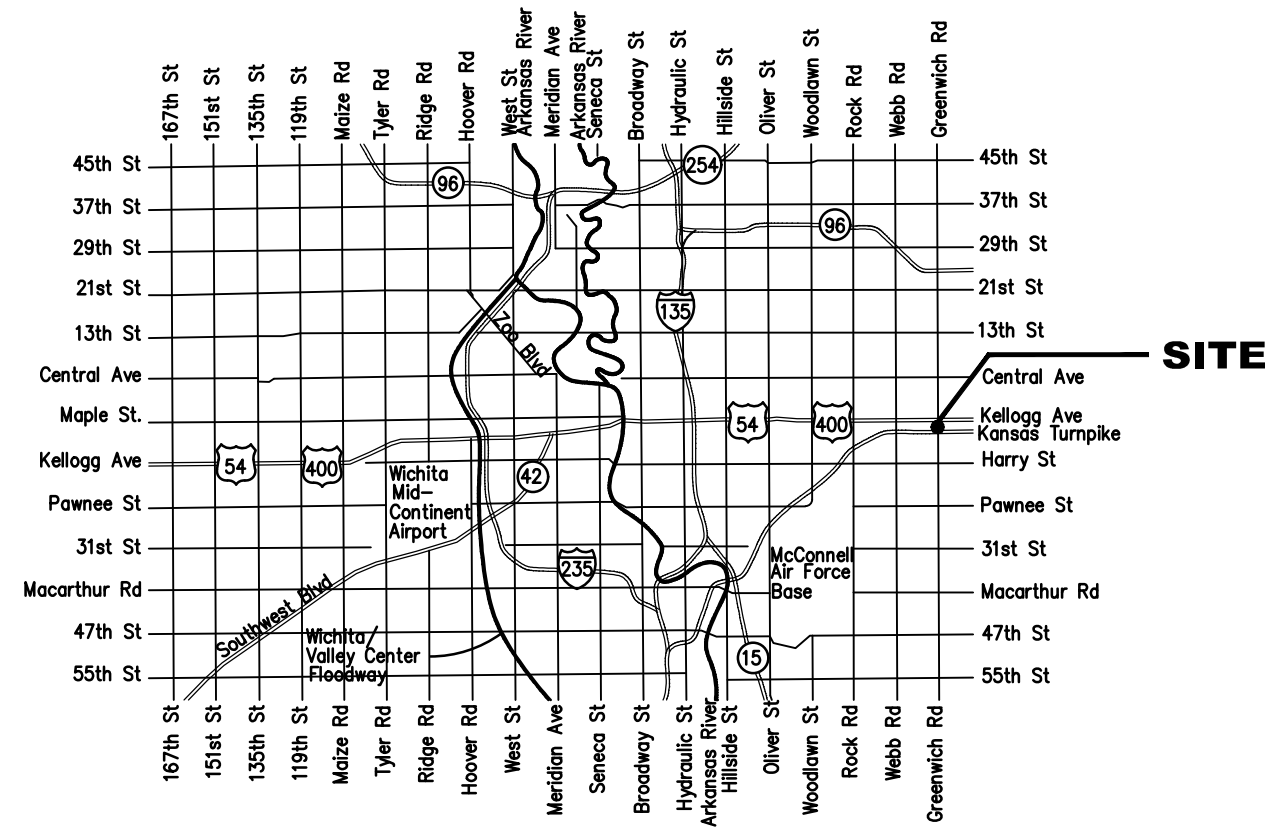

VICINITY MAP

SHEET INDEX

- 1 Title Sheet
- 2 General Notes
- 3 RCBC Plan/Profiles
- 4-5 Standard RCBC Details
- 6-7 Wing Wall Details
- 8 Detour Plan

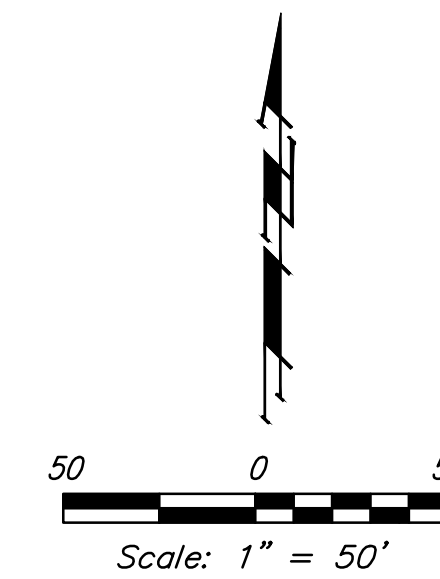
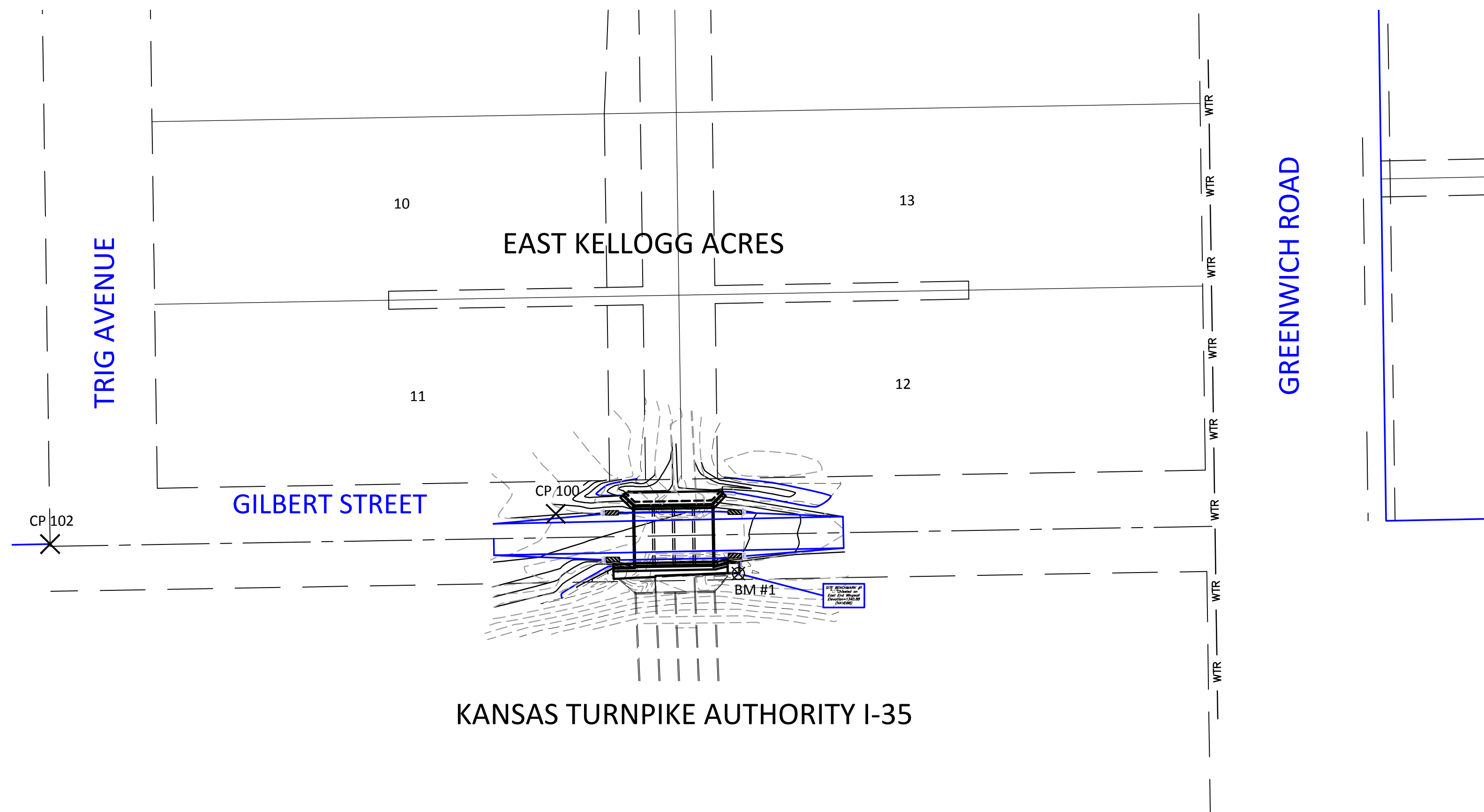

BENCHMARKS

- BM #1 - Chiseled "□" on the East End of the Wingwalls on the South Side of GILBERT STREET.
Elev. = 1340.88 (NAVD 88)
- BM #2 - 60 d Nail in the Northeast Corner of Lot 6, East Kellogg Acres Addition.
Elev. = 1342.54 (NAVD 88)
- BM #3 - Baughman Orange Cap on Rebar.
Elev. = 1344.84 (NAVD 88)

CONTROL POINTS

- CP 100 - #4 Rebar w/ Orange Cap
N-1682521.404
E-1686070.737
- CP 101 - #4 Rebar w/ Orange Cap
N-1682926.955
E-1686211.589
- CP 102 - 3/4" Iron Pipe
N-1682504.628
E-1685789.772

STATE/FED PERMIT:	
KDHE PERMIT NO.:	SSG-0903
USCOE PERMIT NO.:	NWK-2022-00379

Stormwater Certification:	
New Development or Redevelopment	
Stormwater Permit #	N/A
NOI Permit #	N/A



16 August 2022

BAUGHMAN COMPANY
 315 Ellis St. Wichita, KS 67211 316-262-7271
 BaughmanCo.com