

# Material List

R264-78

- 12-Standard RCBC Precast Sections 10' x 5'
- 8-Precast Sections with Precast Hub Guard 10' x 5'
- 8-Straight Wing Mitered End Sections with Toe Wall
- 8-Galvanized Threaded Anchors
- Approx. 43 C.Y. Bedding Rock
- Approx. 97 S.Y. Light Stone Rip-rap

# Loading

AASHTO HL-93  
 (Zero Fill Design)  
 (Thicker cast, no distribution slab)

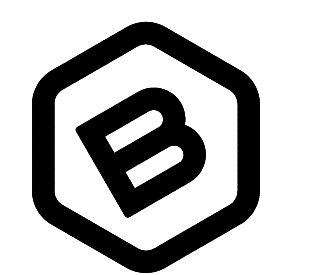
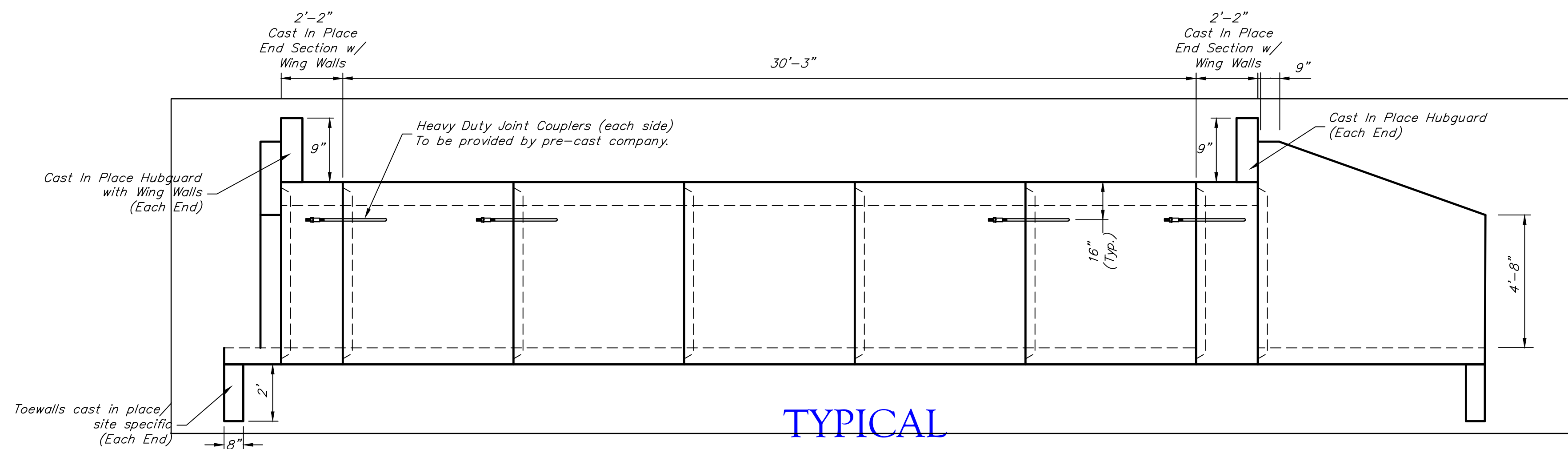
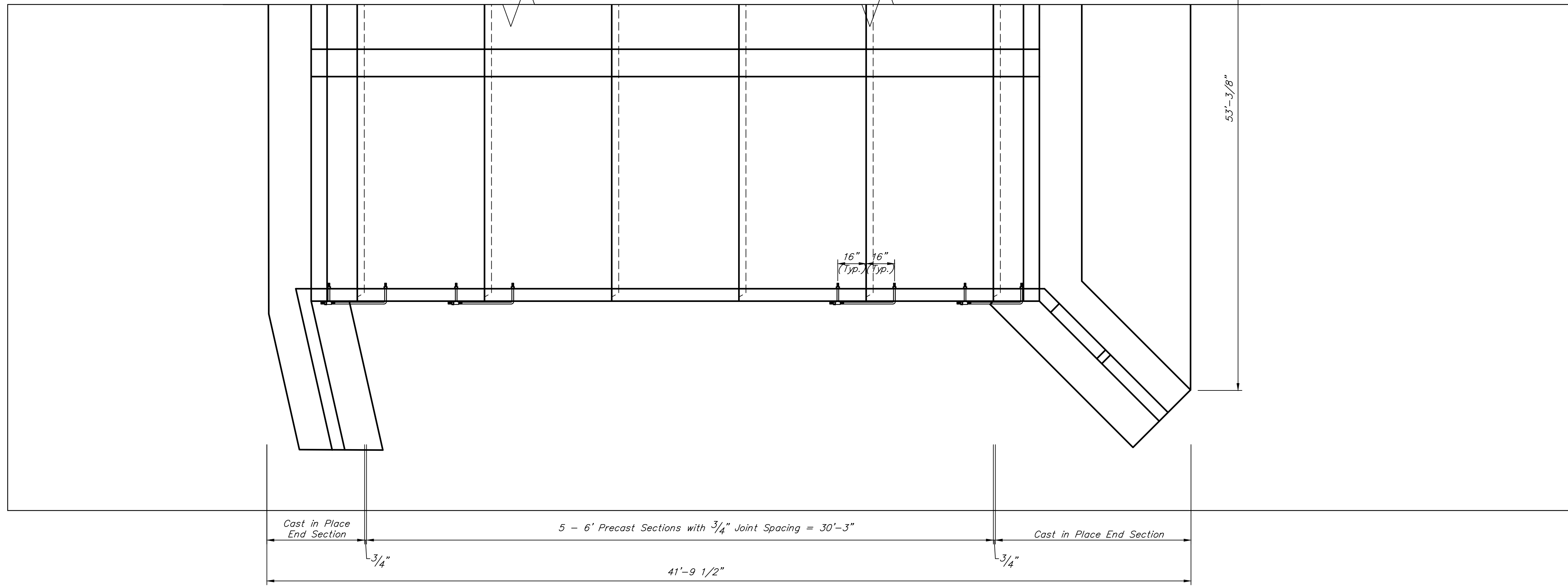
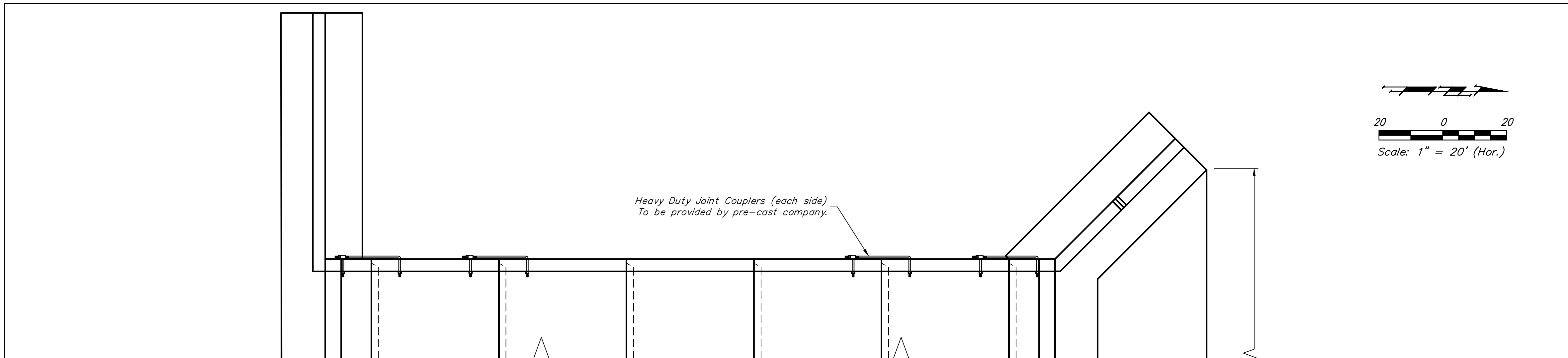
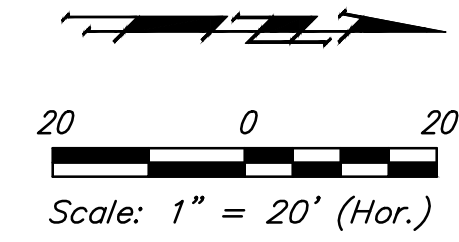

**BAUGHMAN  
 COMPANY**

315 Ellis St.  
 Wichita, KS 67211  
 316-262-7271  
 BaughmanCo.com

GILBERT STREET  
 DRAINAGE IMPROVEMENTS

**PRECAST  
 CONCRETE BOX  
 CULVERT  
 DETAILS**

CAPITOL IMPROVEMENTS  
 PROJECT

PROJECT NUMBER:  
 458-2022-085509

DESIGN: NBW DRAWN: JSB

DATE: August 16, 2022

SHEET **4** OF **8**

File: E:\Projects\Gilbert Avenue Drainage\_19-05-E282\Engineering\Gilbert Drainage.dwg