

- φ Expansion Joint ($\frac{3}{4}$ " board) placed at either back of curb line or at sidewalk back of curb line or at sidewalk line.
- * * Expansion joint ($\frac{3}{4}$ " board) located as shown.
- ◆ Variable width (5'-0" min.). Entrance walk to be same width as approach walk. Use sidewalk width of 4'-0" where existing conditions prohibit use of 5'-0".
- ☆ New construction ramp slopes are 12: 1 or flatter. Desirable ramp slopes for existing sites are 12:1 or flatter. Where space limitations prohibit construction of a 12:1 slope on existing sites, use the following slopes:
8:1 or flatter for a maximum rise of 3 inches
10:1 or flatter for a maximum rise of 6 inches
- ⊕ Use a landing slope of 48: 1 or flatter. Landings are the same width as ramp and a minimum 5'-0" in length.
- ψ Use a counter slope of 20:1 or flatter at the base of sidewalk ramps. See curb and gutter detail sheet.

⊕ Detectable warning installation is typical and required on Sidewalk Ramps Type 1, Type 2, Type 3, median ramp crossings and other locations as shown in the plans. See ramp detail sheet.

TYPICAL SIDEWALK PLAN AND DETAILS

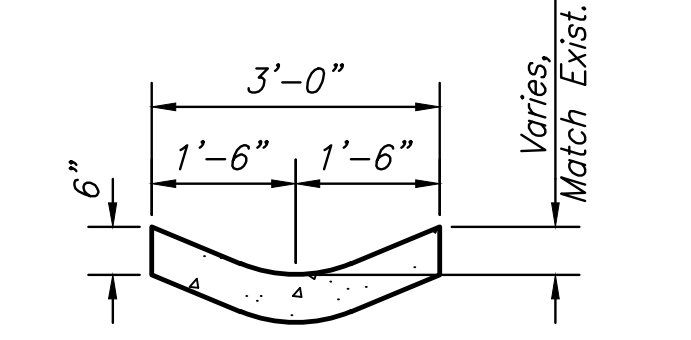
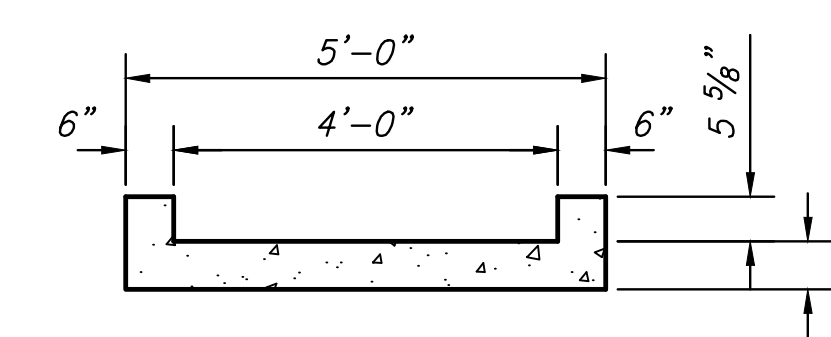
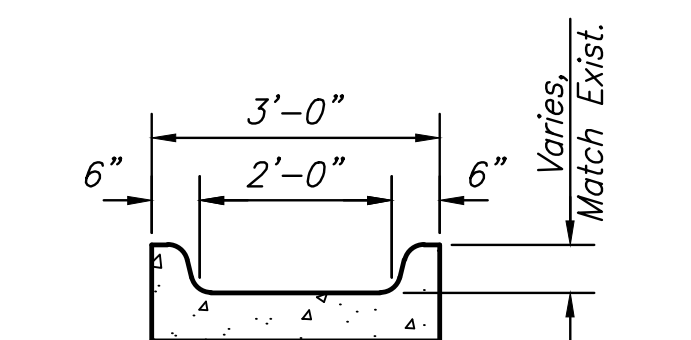
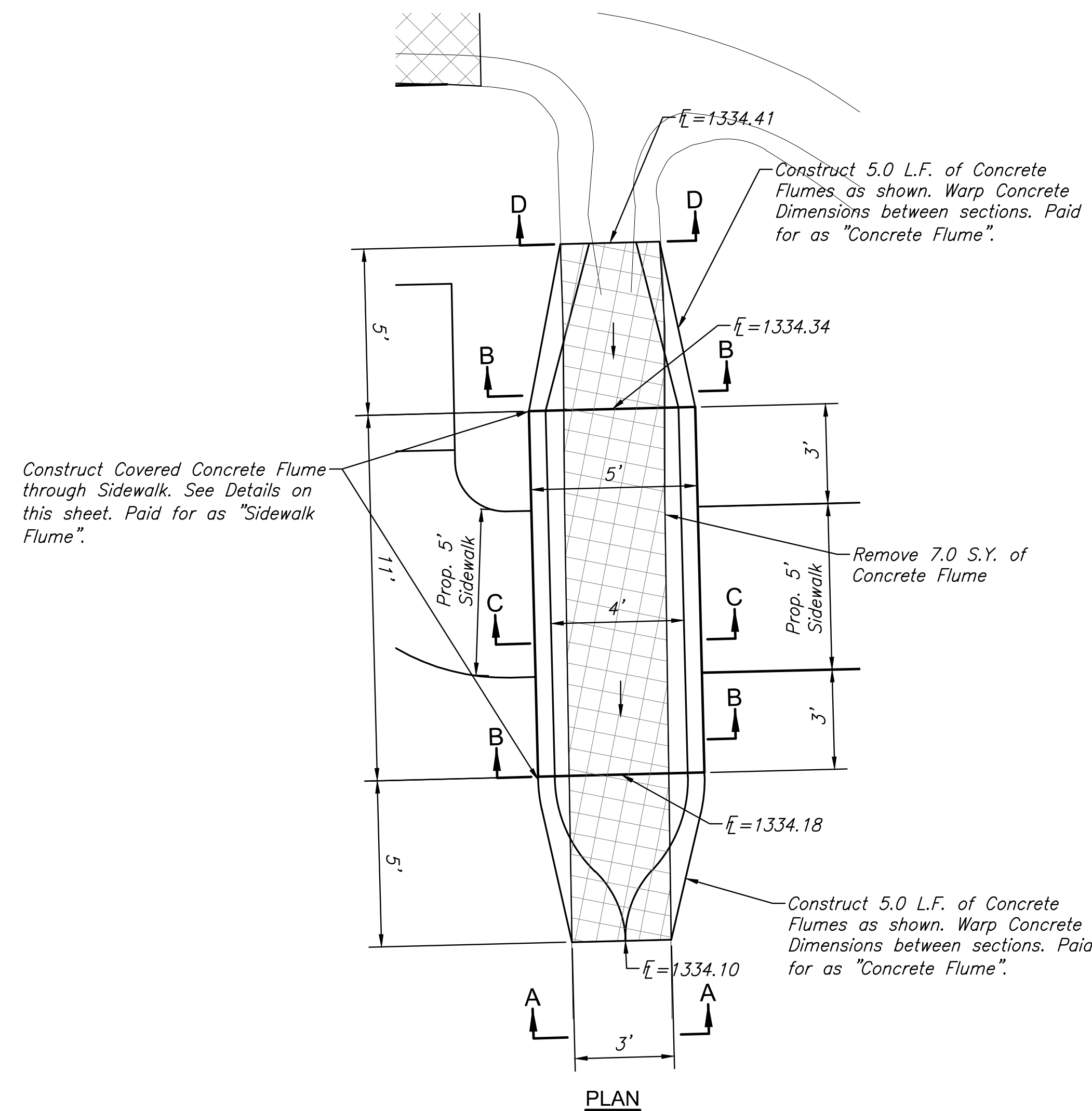
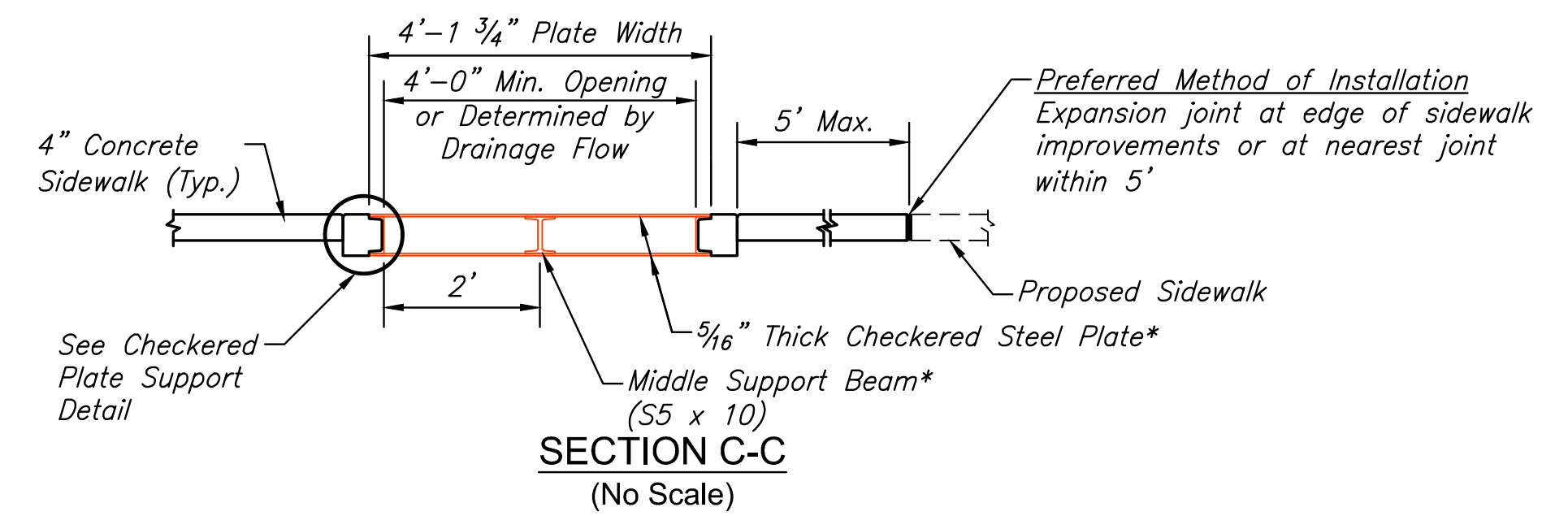
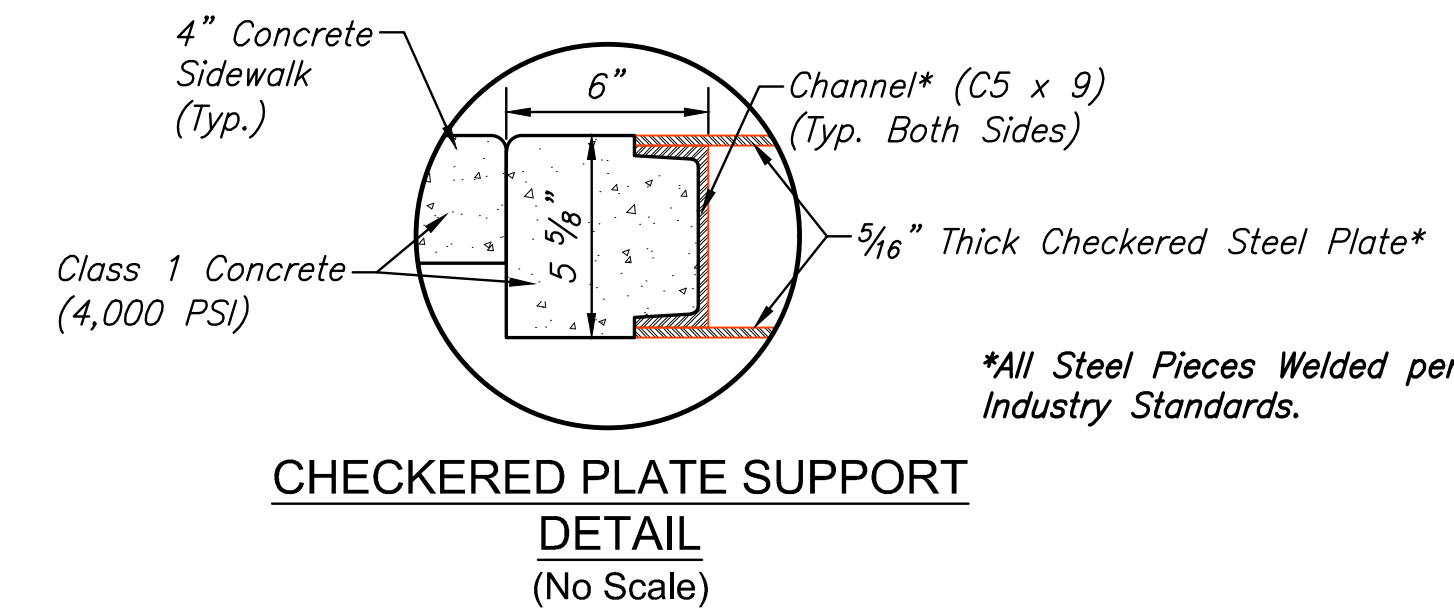

CONCRETE FLUME AND SIDEWALK FLUME DETAILS

©2022 MKEC Engineering All Rights Reserved www.mkec.com
These drawings and their contents, including, but not limited to, all concepts, designs, & ideas are the exclusive property of MKEC Engineering (MKEC), and may not be used or reproduced in any way without the express consent of MKEC.

SIDEWALK DETAILS

PROJECT NO.	472-2021-085741	
DATE	8/8/2022	
SCALE	NTS	
DESIGNED	DRAWN	CHECKED
JRA	RAM	JRA

NO.	REVISION	DATE

SHEET NO.