

SAVED 9/8/2022 2:24:15 PM BY LUKE PETER  
 PLOTTED 9/8/2022 4:09:29 PM BY LUKE PETER  
 U:\WICHITA-CIVIL\2022\1210524\000\PEC\DRAWINGS\210524-000-CG101.DWG

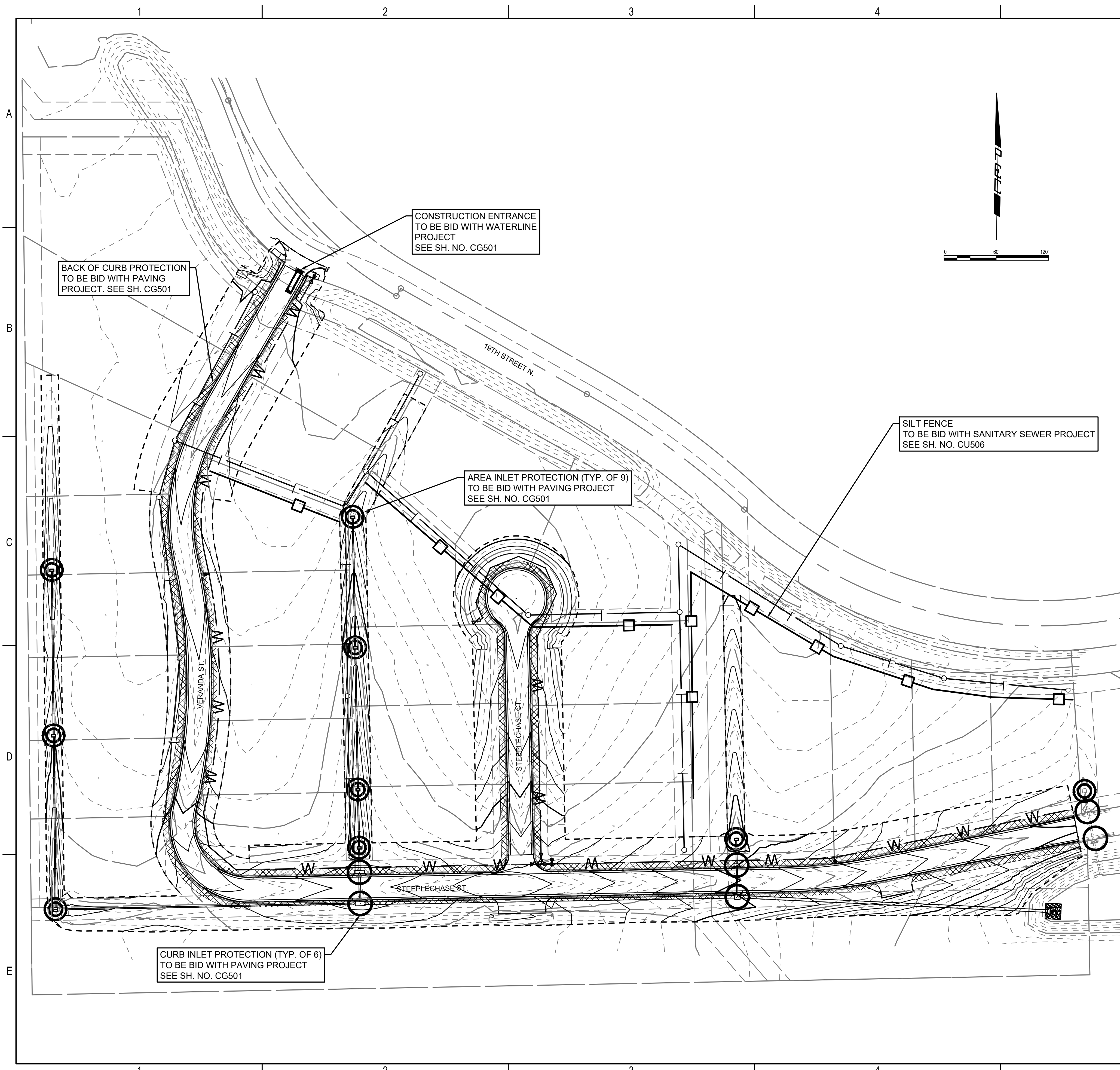

**GENERAL NOTES**

1. CONTRACTOR SHALL INSTALL AND MAINTAIN EROSION PROTECTION THROUGHOUT THE ENTIRE PROJECT. THE FOLLOWING QUANTITIES ARE PROVIDED FOR THE PROJECT.

<b>PAVING AND DRAINAGE</b>		
CURB INLET PROTECTION	6	EACH
AREA INLET PROTECTION	9	EACH
BACK OF CURB PROTECTION	4109.0	L.F.
DITCH CHECK PROTECTION	-	EACH
SILT FENCE PROTECTION	-	L.F.
TEMPORARY SEEDING	4.0	ACRE
PERMANENT SEEDING	4.0	ACRE
<b>WATER LINE</b>		
STABILIZED CONSTRUCTION ENTRANCE	1	EACH
<b>SANITARY SEWER</b>		
SILT FENCE BARRIER	1303.0	L.F.

- THE EROSION CONTROL DEVICES SHOWN ON THIS SHEET ARE CONSIDERED MINIMUM STANDARDS. WHENEVER SEDIMENT ENTERS THE STREETS, STORM SEWERS, DITCHES, OR PONDS, CONTRACTOR WILL INSTALL ADDITIONAL DEVICES, AS NEEDED, TO CORRECT THE PROBLEM.
- THE EROSION CONTROL DEVICES SHOWN HEREON MUST BE IN PLACE AT ALL TIMES DURING CONSTRUCTION UNTIL SUCH TIME AS THE SITE IS REESTABLISHED WITH PAVING OR GRASS. TEMPORARY OR PERMANENT SEEDING AND MULCH WILL BE INSTALLED WHEN EARTHWORK ACTIVITIES CEASE IN AN AREA FOR 14 DAYS OR MORE.
- ANY MUD INADVERTENTLY TRACKED ONTO ANY STREET SHALL BE CLEANED UP BY THE CONTRACTOR, AT THE END OF EACH DAY'S WORK, OR AS DIRECTED BY THE FIELD ENGINEER.
- CONTRACTOR TO FURNISH A TRUCK WASH-OUT PIT TO BE PLACED AT A CONVENIENT LOCATION THAT DOES NOT CONFLICT WITH CONSTRUCTION. CONTRACTOR SHALL CLEAN OUT AND BACKFILL PIT PRIOR TO FINAL INSPECTION. LOCATION SHALL BE APPROVED BY THE FIELD ENGINEER.

**SEEDING NOTES**

THE CONTRACTOR SHALL APPLY TEMPORARY SEED AND MULCH TO ALL UNPAVED AREAS DISTURBED BY CONSTRUCTION. TEMPORARY SEED (ANNUAL RYEGRASS) AND MULCH PER SPECIFICATIONS. TEMPORARY SEEDING AND MULCHING SHALL BE PAID FOR AT THE LUMP SUM PRICE FOR "SEEDING, TEMPORARY".

PERMANENT PROJECT SEEDING: CONTRACTOR SHALL APPLY SEED, FERTILIZER, AND MULCH TO ALL GRASSED AREAS, WITHIN RIGHT-OF-WAY, DISTURBED BY CONSTRUCTION ACTIVITIES. SEED SHALL BE TALL FESCUE GRASS APPLIED PER SPECIFICATIONS. PERMANENT SEEDING AND MULCHING SHALL BE PAID FOR AT THE LUMP SUM PRICE FOR "SEEDING".

**EROSION CONTROL LEGEND**

- PROPOSED SILT FENCE (SANITARY SEWER)
- PROPOSED SILT FENCE (PAVING)
- PROPOSED CURB INLET PROTECTION
- PROPOSED AREA INLET PROTECTION
- PROPOSED DITCH CHECK
- PROPOSED RIP-RAP
- PROPOSED STABILIZED CONSTRUCTION ENTRANCE
- PROPOSED BACK OF CURB PROTECTION

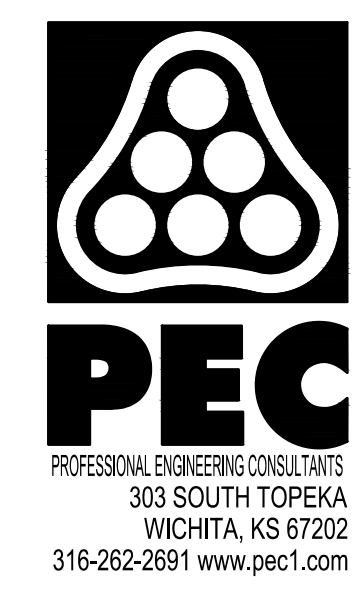

**PAVING IMPROVEMENTS TO SERVE THE VILLAS AT OAK CREEK 3RD ADDITION**  
 GARY JANZEN, P.E. - CITY ENGINEER  
 CITY OF WICHITA ENGINEERING PROJECT NO. 472-2022-085795

JOB NO.	210524-000
DATE	SEPTEMBER 2022
PM	TPA
DESIGNED BY	AKL, LGP
DRAWN BY	CP
CHECKED BY	RJS

EROSION CONTROL PLAN