

SAVED 5/16/2022 11:09:55 AM BY KURTIS DEKAT
 PLOTTED 9/13/2022 11:24:11 AM BY KURTIS DEKAT
 U:\WICHITA-CIVIL\2021\1210253\000\MIDDRAWINGS\210253-000-CU301.DWG

I-135

CL HYDRAULIC AVENUE				
COORDINATE LIST				
POINT	NORTHING	EASTING	STATION	DESCRIPTION
6000	1,706,020.3679	1,654,492.2696	42+00.00	PI
6001	1,706,670.2210	1,654,478.4510	48+50.00	PI
6002	1,707,320.0741	1,654,464.6325	55+00.00	PI

6000 = COORDINATE POINT NO.

WATERLINE NO. 2				
COORDINATE LIST				
POINT	NORTHING	EASTING	STATION	DESCRIPTION
5011	1,706,096.3297	1,654,442.6884	10+00.00	BLOWOFF
5012	1,706,116.2861	1,654,444.0093	10+20.00	FIRE HYDRANT
5013	1,706,293.8890	1,654,455.7642	11+97.99	HORIZ. DEFL.
5014	1,706,313.8841	1,654,456.2063	12+17.99	HORIZ. DEFL.
5015	1,706,411.3568	1,654,454.1122	13+15.49	FIRE HYDRANT
5016	1,707,272.7307	1,654,435.5831	21+77.06	90° BEND
5017	1,707,272.7191	1,654,422.2058	21+90.44	EXIST. WL

5000 = COORDINATE POINT NO.

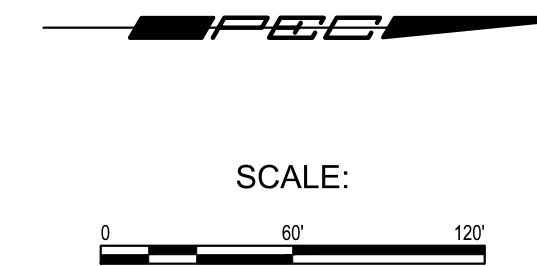

LEGEND

- W — W — EXISTING WATER MAIN
- W — W — PROPOSED WATER MAIN
- W — W — EXISTING WATER VALVE
- W — W — PROPOSED WATER VALVE
- W — W — EXISTING FIRE HYDRANT
- W — W — PROPOSED FIRE HYDRANT
- W — W — EXISTING BLOW OFF
- W — W — PROPOSED BLOW OFF
- W — W — DENOTES CAP OR PLUG
- X — X — ABANDON EXISTING WATER MAIN

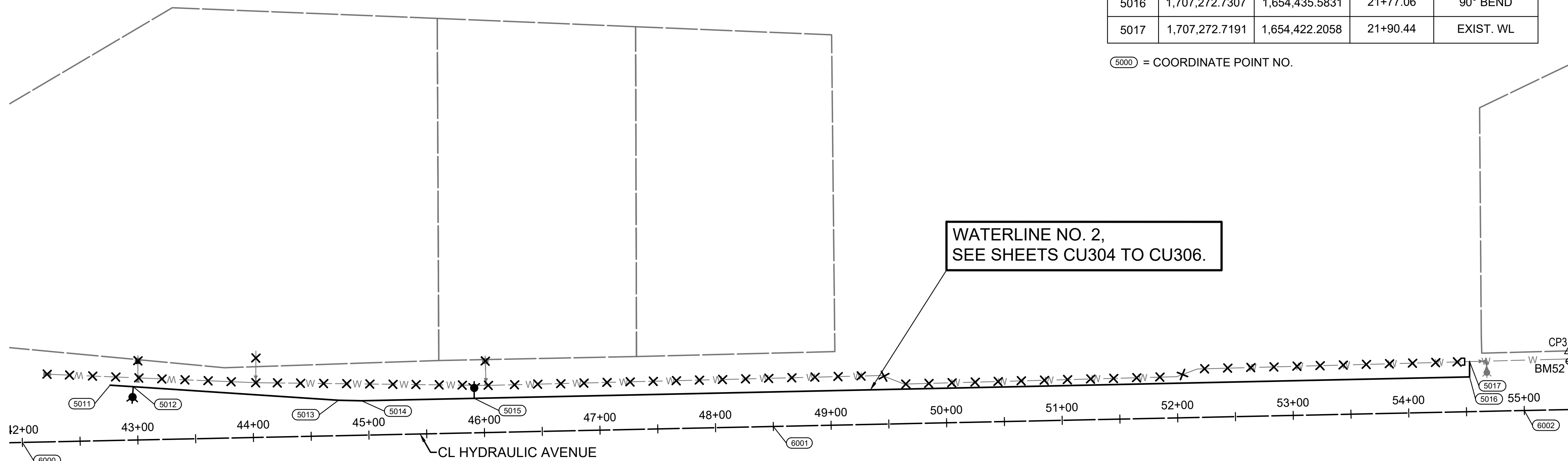

NOTE: WATERLINE VALVES TO BE OPERATED BY CONTRACTOR ONLY IF WATER DEPARTMENT REPRESENTATIVE IS ON SITE.

HORIZONTAL DATUM/COORDINATE SYSTEM: ADJUSTED STATE PLANE
 COORDINATES NAD 83 KANSAS SOUTH ZONE
 PROJECT COORDINATE SYSTEM: (GRID) ON DESCRIBED COORDINATE SYSTEM
 VERTICAL DATUM: NAVD 88

BMK 52
 CHISELED SQUARE ON A RETAINING WALL, NORTH END OF SOUTH ENTRANCE TO FIRST WIRELESS
 EL= 1320.83 (NAVD88)

BMK 53
 CHISELED SQUARE ON THE WEST END OF NORTH RETAINING WALL AT EAST BOUND K-96 RAMP AT HYDRAULIC
 EL= 1319.55 (NAVD88)

BMK 54 (NOT SHOWN)
 CHISELED SQUARE ON THE CENTER OF THE NORTHEAST HEADWALL OF THE ABANDONED SCALE, DIRECTLY SOUTH OF POLE #W7F84558
 EL= 1325.61 (NAVD88)

CP-3
 N: 1707358.366 E: 1654413.525
 MAG NAIL IN THE NORTH SIDE OF THE SOUTH ENTRANCE TO FIRST WIRELESS
 1. 15.0' S TO THE CENTERLINE OF THE ENTRANCE
 2. 26.5' E TO THE W EDGE OF HYDRAULIC
 3. 74.2' SSE TO THE TOP CENTER OF A FIRE HYDRANT

CP-4
 N: 1706668.699 E: 1654538.965
 1/2" REBAR WITH PEC CONTROL POINT CAP, NORTH SIDE OF EAST BOUND K-96 RAMP AT HYDRAULIC
 1. 3.0' E TO A CHISELED SQUARE ON THE WEST END OF THE RETAINING WALL
 2. 36.5' W TO THE EAST EDGE OF HYDRAULIC
 3. 14.5' S TO THE NORTH EDGE OF K-96 ON-RAMP

CP-5 (NOT SHOWN)
 N: 1707245.159 E: 1653219.950
 1/2" REBAR WITH PEC CONTROL POINT CAP
 1. 5.8' E TO A RAILROAD SPIKE IN THE WEST FACE OF A POWER POLE
 2. 30.3' NORTH TO A KDOT RIGHT OF WAY FENCE (EAST/WEST)
 3. 62.34' SSE TO A CHISELED SQUARE ON A RETAINING WALL (BM 54)

CP-6 (NOT SHOWN)
 N: 1707290.5486 E: 1652531.478
 CHISELED CROSS ON THE SOUTHEAST CORNER OF A STORM DRAIN MANHOLE PAD
 1. 22.0' S TO THE CENTERLINE OF HAUL ROAD
 2. 56.5' W TO THE CENTERLINE OF OHIO STREET
 3. 64.9' WSW TO THE NORTHWEST CORNER OF CONCRETE FENCE COLUMN



SANITARY SEWER AND WATERLINE IMPROVEMENTS
 TO SERVE

NORTH JUNCTION UTILITY RELOCATION

GARY JANZEN, P.E. - CITY ENGINEER
 SS: CITY OF WICHITA PROJ. NO. 468-2021-002929
 WL: CITY OF WICHITA PROJ. NO. 448-2021-034139

Issue:		
JOB NO.	35-210253-000-0042	
DATE	01 JUNE 2021	
PM	TBK	
DESIGNED BY	TBK	
DRAWN BY	KTD	
CHECKED BY	RWG	
WATER LINE NO. 2 KEY MAP, CONTROL, & BUBBLE MAP		

CU301