

J:\PROJECTS\2022\12\10\10674_COW RIVERSIDE WATER MAIN REPLACEMENT\DWG\WTR2\1674-05-3300.DWG
 PLOTTED: Tuesday, August 16, 2022 @ 01:56PM

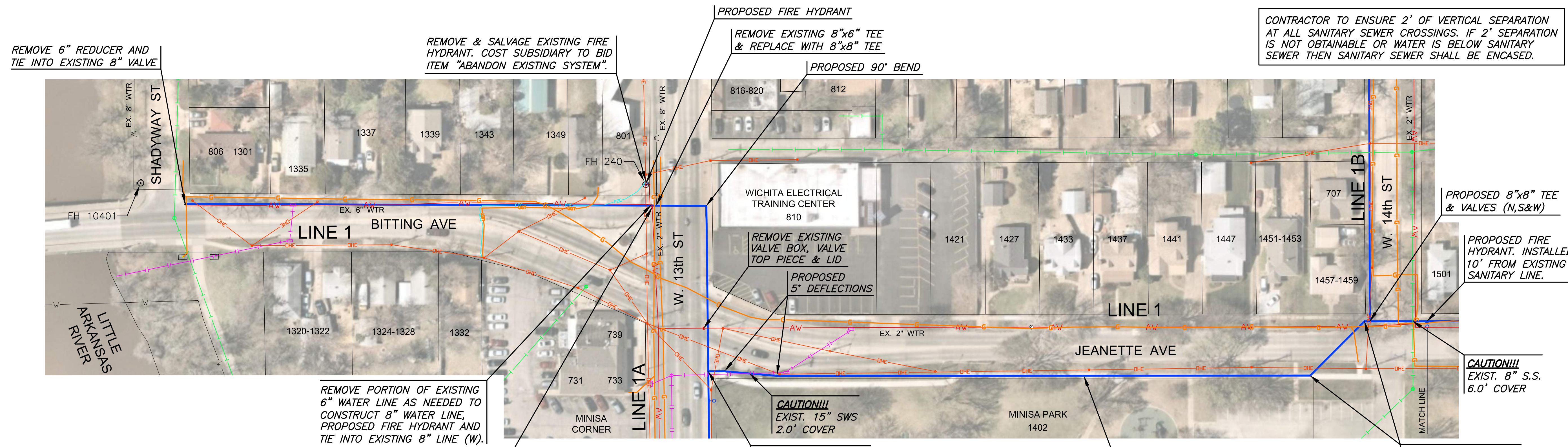

CONTRACTOR TO ENSURE 2' OF VERTICAL SEPARATION AT ALL SANITARY SEWER CROSSINGS. IF 2' SEPARATION IS NOT OBTAINABLE OR WATER IS BELOW SANITARY SEWER THEN SANITARY SEWER SHALL BE ENCASED.

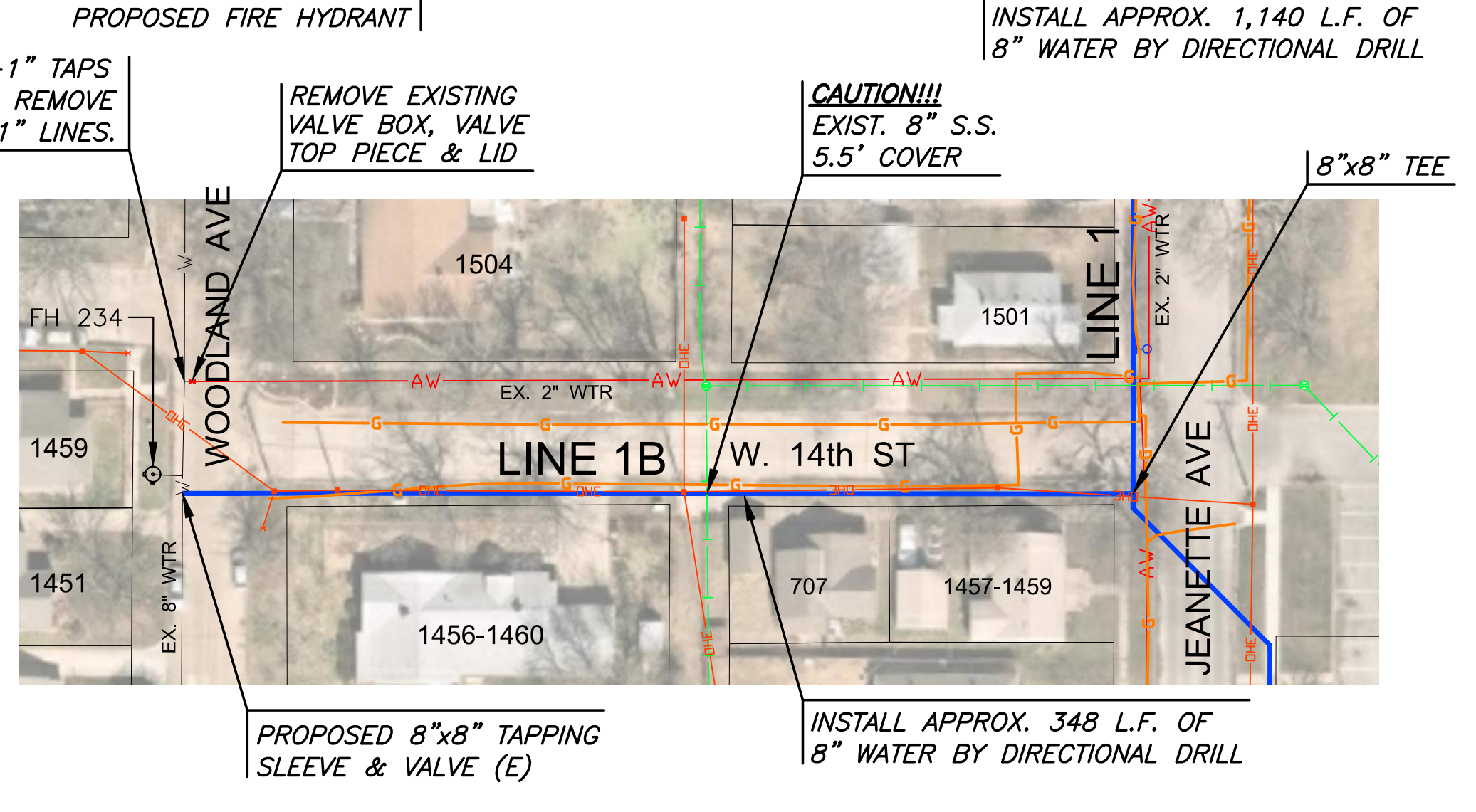
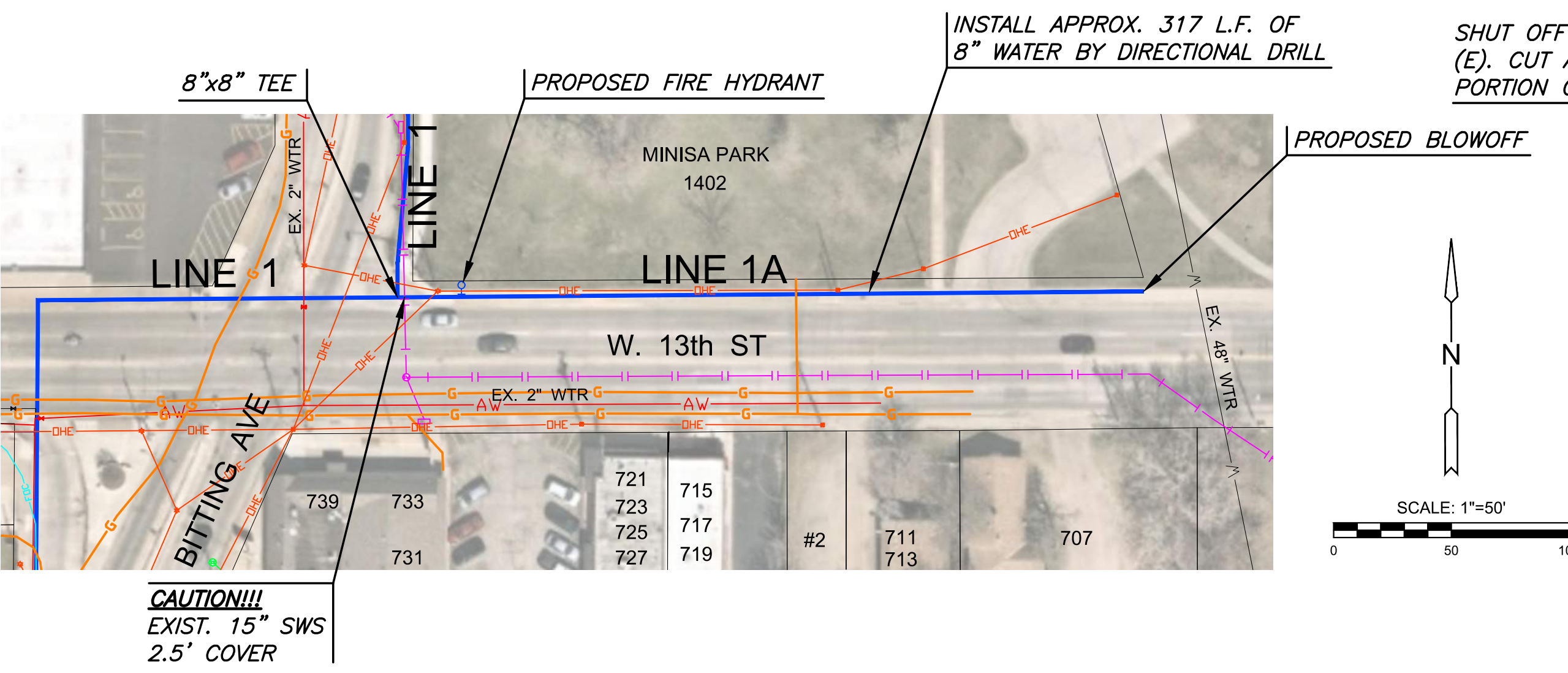
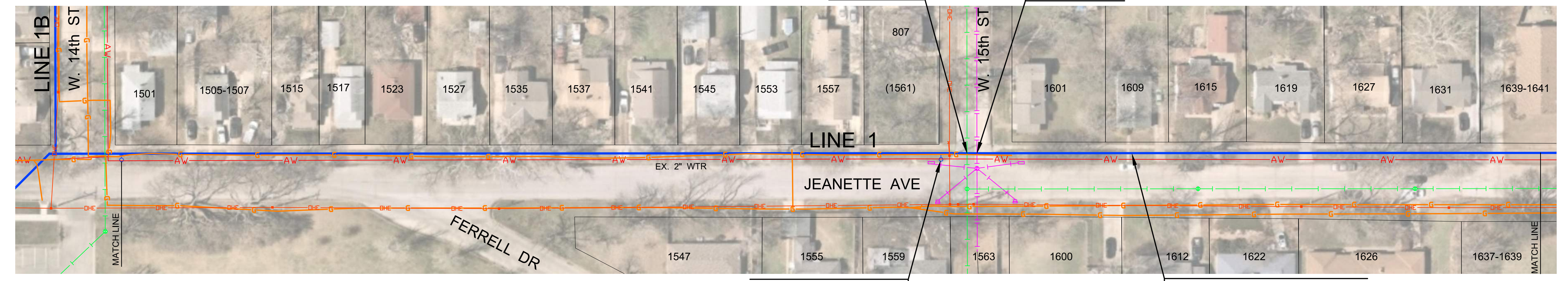
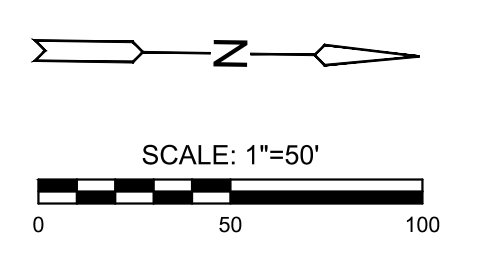

LEGEND

	EXISTING GAS
	EXISTING OVERHEAD ELECTRIC
	EXISTING UNDERGROUND ELECTRIC
	EXISTING SANITARY
	EXISTING STORM DRAIN PIPE
	EXISTING FIBER OPTIC
	EXISTING FENCE
	EXISTING WATER
	EXISTING WATER (TO BE ABANDONED)
	PROPOSED WATER



RIVERSIDE WATER MAIN REPLACEMENT

PHASE 1



©2022 MKEC Engineering All Rights Reserved www.mkec.com
 These drawings and their contents, including, but not limited to, all concepts, designs, & ideas are the exclusive property of MKEC Engineering (MKEC), and may not be used or reproduced in any way without the express consent of MKEC.

LINE 1		
PROJECT NO.	488-2020-035004	
DATE	AUG 2022	
SCALE	1" = 50'	
DESIGNED	DRAWN	CHECKED
DFL	JWC	KDA
ISSUED FOR APPROVAL	08/16/22	
NO.	REVISION	DATE
SHEET NO.	12 OF 31	