

PLOT/DWG: Friday, November 11, 2022 @ 09:09AM

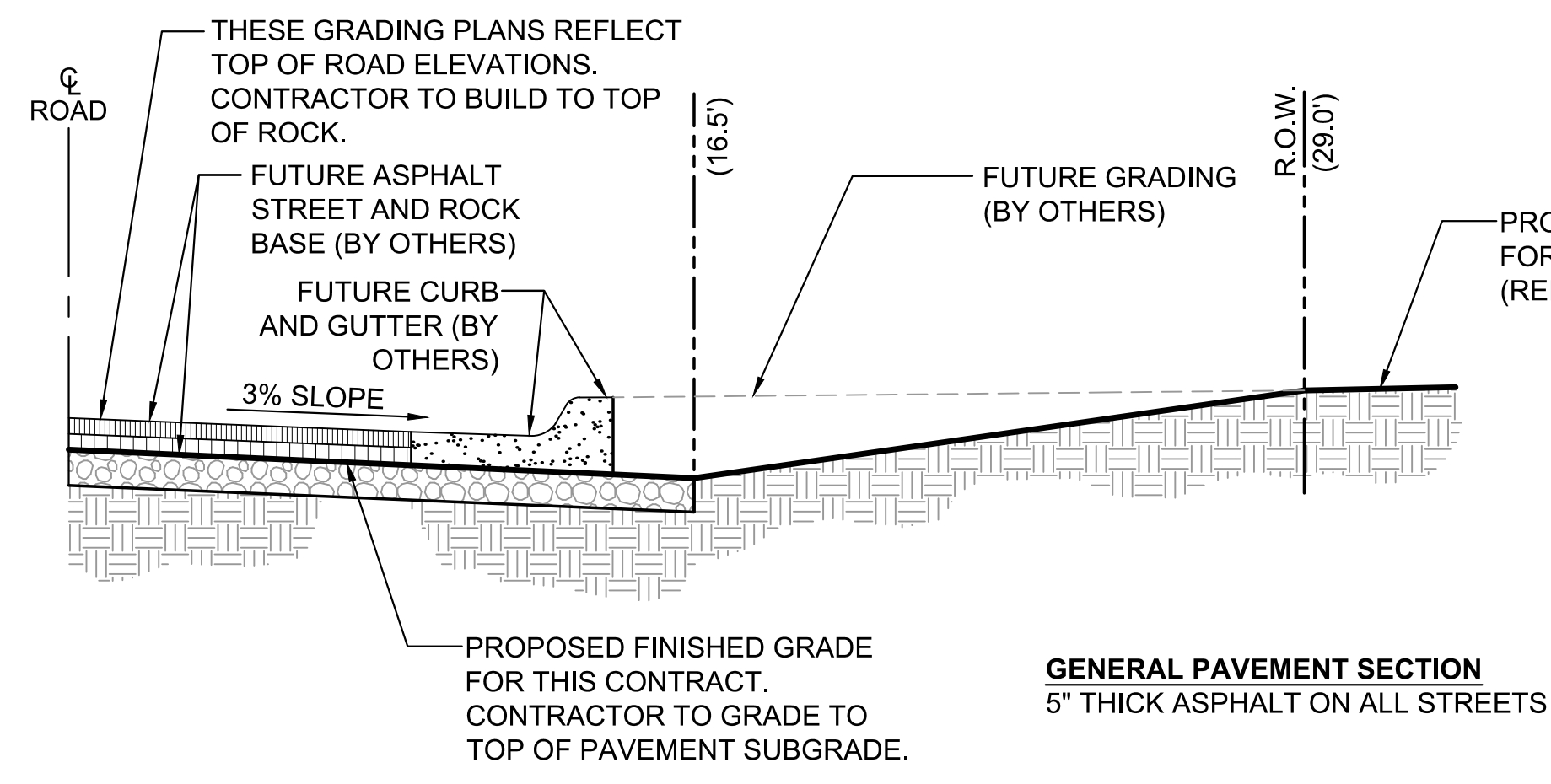

1 TYPICAL ROAD CROSS SECTION DETAIL
SCALE: NTS

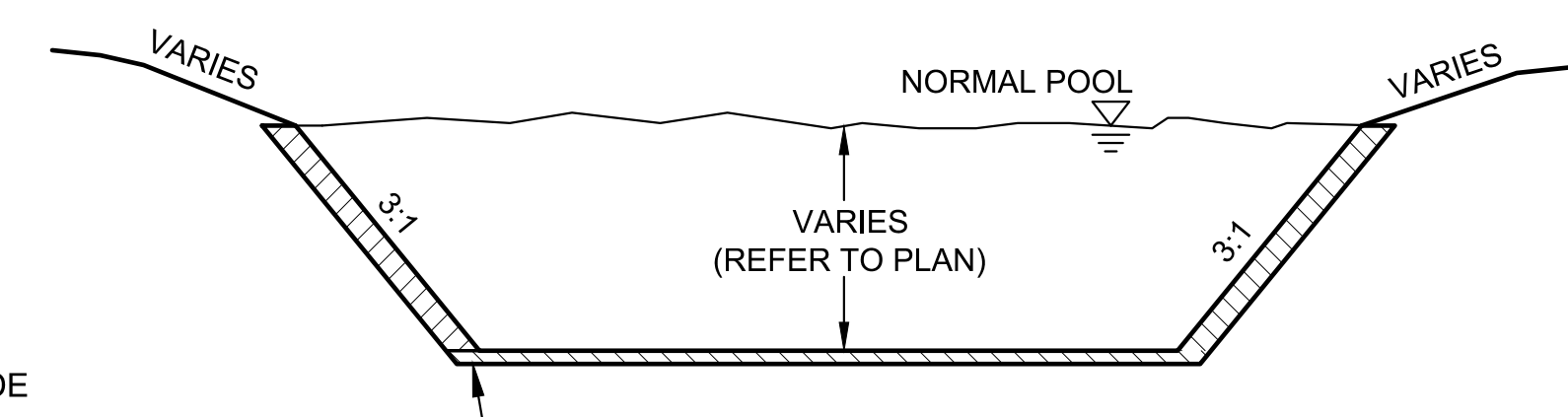

1. OVER EXCAVATE 12" OF SOIL.
2. INSTALL 12" CLAY LINER.
3. COMPACT TO WITHIN +5% OF OPTIMUM MOISTURE CONTENT AT 95% STANDARD PROCTOR DENSITY.
4. PER CITY OF WICHITA SPECIFICATIONS, MATERIAL FOR CLAY LINER MEET THE FOLLOWING PHYSICAL PROPERTIES:
 - 4.1. MIN. % PASSING #200 SIEVE = 80
 - 4.2. MIN. LIQUID LIMIT (LL) = 40
 - 4.3. MIN. PLASTICITY INDEX (PI) = 25
5. A PERMEABILITY TEST OF THE IN-PLACE POND LINER SHALL BE PERFORMED BY A GEOTECHNICAL ENGINEER AT 2 LOCATIONS WITHIN THE POND. THE CLAY LINER SHALL MEET OR EXCEED A PERMEABILITY RATING VALUE OF 1×10^{-6} CM/SEC. COST ASSOCIATED WITH PERMEABILITY TESTING SHALL BE SUBSIDIARY TO EARTHWORK ITEMS.

2 POND LINER DETAIL
SCALE: NTS

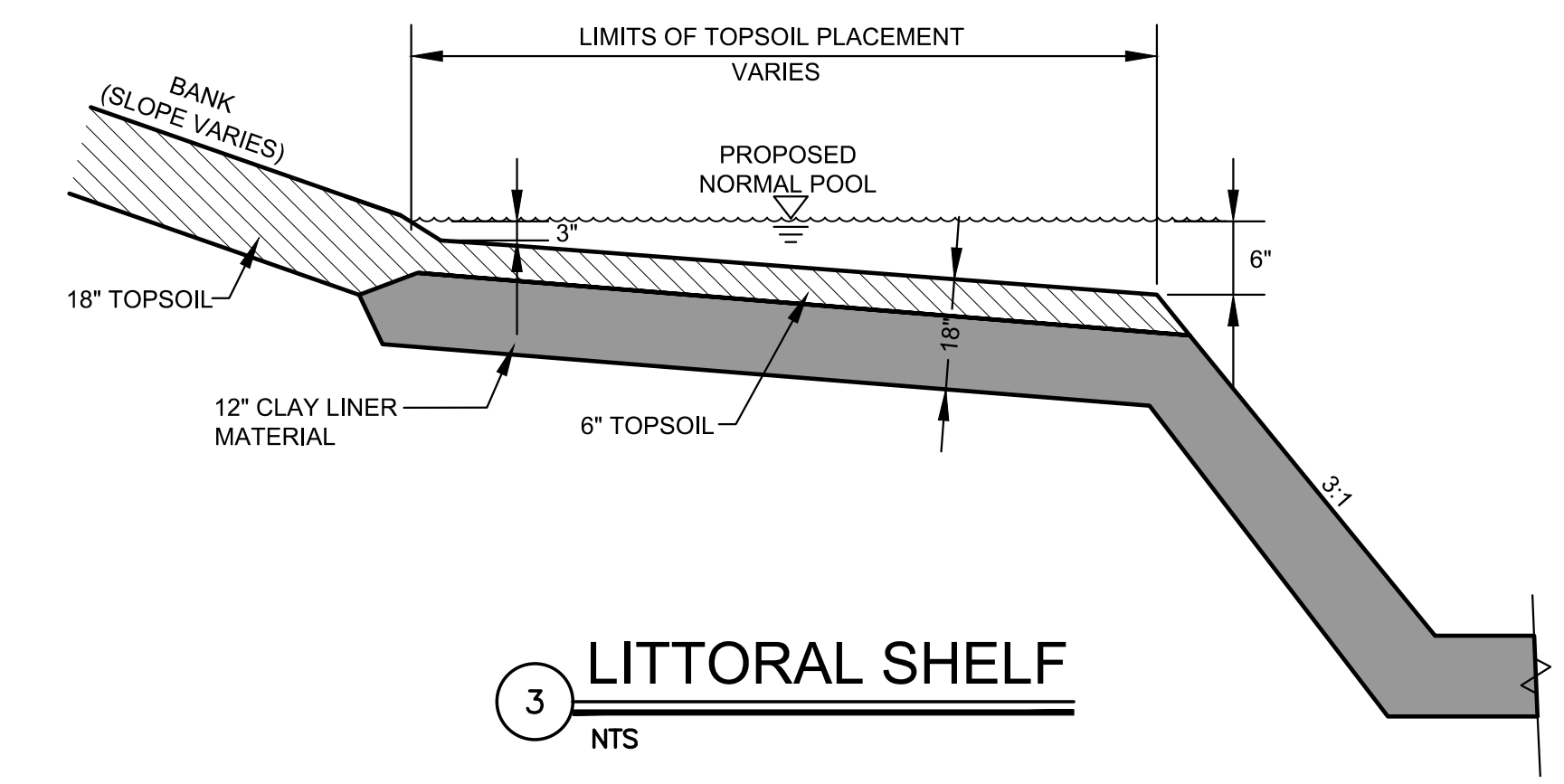

3 LITTORAL SHELF
NTS

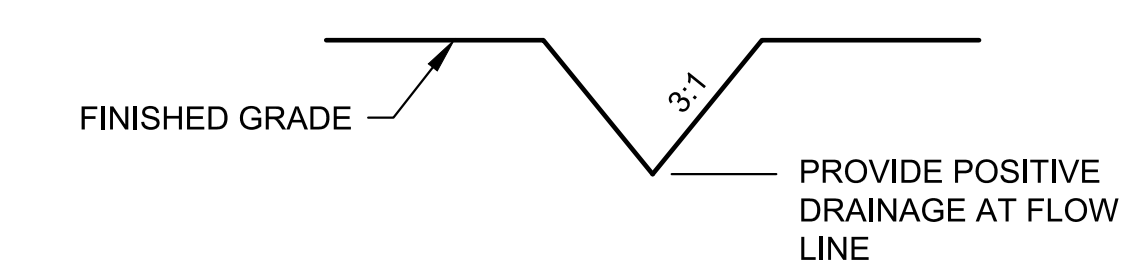

4 TEMP. DRNG. SWALE
NTS

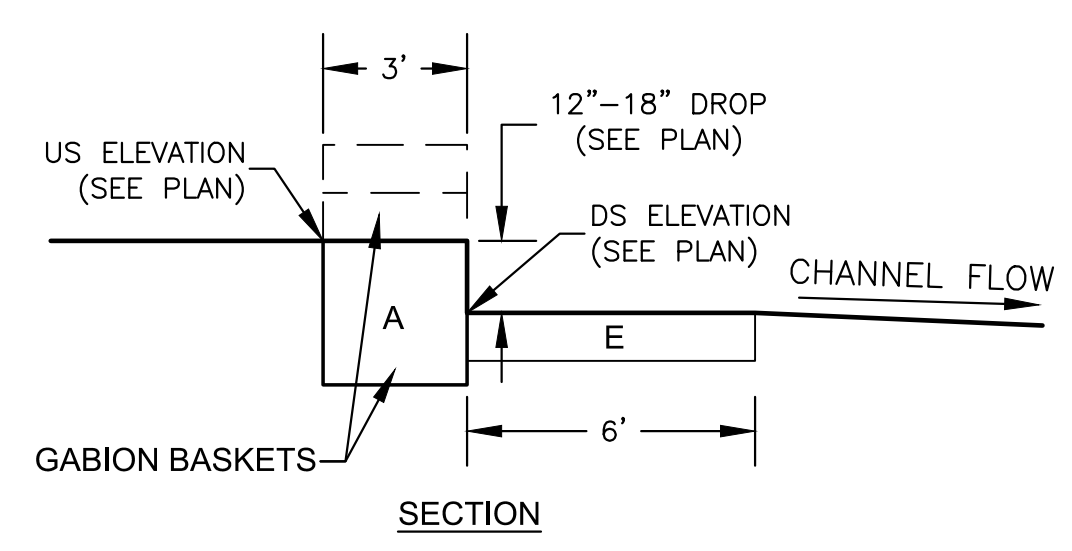
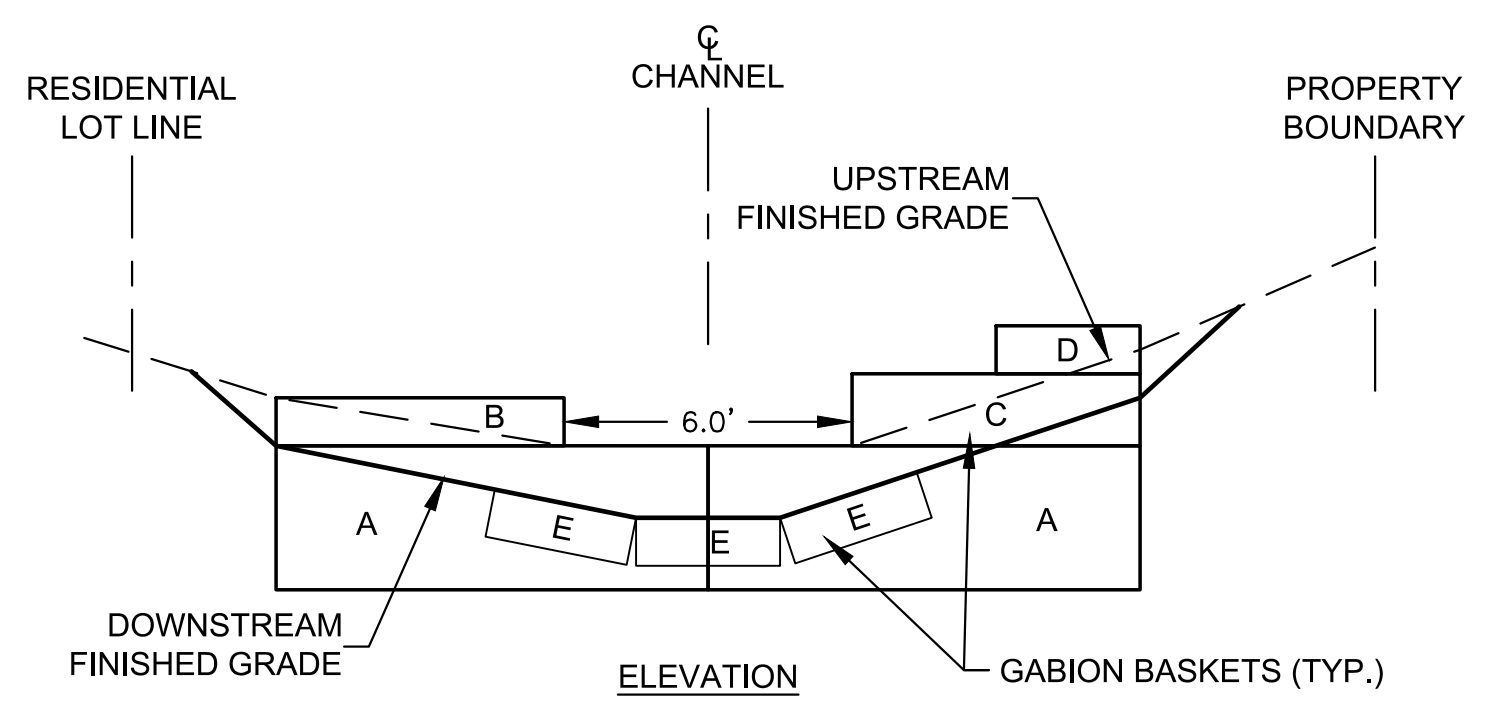

TYPE	DESCRIPTION	L	W	D	# REQ. @ EACH DROP	TOTAL
A	GABION BASKET	9'	3'	3'	2	8
B	GABION BASKET	6'	3'	1'	1	4
C	GABION BASKET	6'	3'	1.5'	1	4
D	GABION BASKET	4.5'	3'	1'	1	4
E	GABION BASKET	6'	3'	1'	3	12

NOTE: GABIONS SHALL BE PVC COATED. INSTALL PER THE MANUFACTURERS RECOMMENDATIONS.

5 GABION DROP STRUCTURE DETAILS
SCALE: NTS

WEIR GENERAL NOTES:

1. ALL CONCRETE TO HAVE MINIMUM COMPRESSIVE STRENGTH OF 4000 PSI AT 28 DAYS. CONTRACTOR SHALL SUBMIT CONCRETE MIX DESIGN TO ENGINEER FOR APPROVAL PRIOR TO CONSTRUCTION.
2. ALL CONCRETE SHALL CONFORM TO THE CURRENT "ACI MANUAL OF CONCRETE PRACTICE".
3. PORTLAND CEMENT SHALL CONFORM TO ASTM C-150, TYPE I.
4. ALL AGGREGATE FOR NORMAL WEIGHT CONCRETE SHALL MEET ASTM C33.
5. CONTRACTOR SHALL APPLY A THIN-SET MORTAR FINISH TO ALL EXPOSED CONCRETE SURFACES.
6. ALL REINFORCING TO MEET ASTM A615, GR. 60.
7. CONCRETE COVER SHALL BE 3" WHEN CAST AGAINST SOIL. ALL OTHER COVER SHALL BE 2".
8. ALL FOOTINGS SHALL BEAR ON UNDISTURBED EARTH OR ENGINEERED FILL AT ELEVATIONS SHOWN ON DETAILS.
9. CONTRACTOR SHALL RECONSTRUCT ANY REMOVED OR DAMAGED EXISTING POND LINER PER POND DETAILS. ONCE COMPLETE, THE POND LINER SHALL BE CONTINUOUS AND FREE OF ANY GAPS. SEE GRADING DETAILS FOR INFORMATION.
10. EARTHWORK AND LINER RECONSTRUCTION SHALL BE CONSIDERED SUBSIDIARY TO WEIR CONSTRUCTION.
11. GABION MATTRESSES SHALL BE PVC COATED. INSTALL PER MANUFACTURERS SPECIFICATIONS. GABION MATTRESS SHALL BE SUBSIDIARY TO WEIR COST.
12. TURF REINFORCEMENT MAT SHALL BE NORTH AMERICAN GREEN SC-250 OR APPROVED EQUAL. REINFORCEMENT MAT SHALL BE SUBSIDIARY TO WEIR COST.
13. ALL BACKFILL OF THE WEIR SHALL BE COMPACTED TO 95% OF ASTM D698.

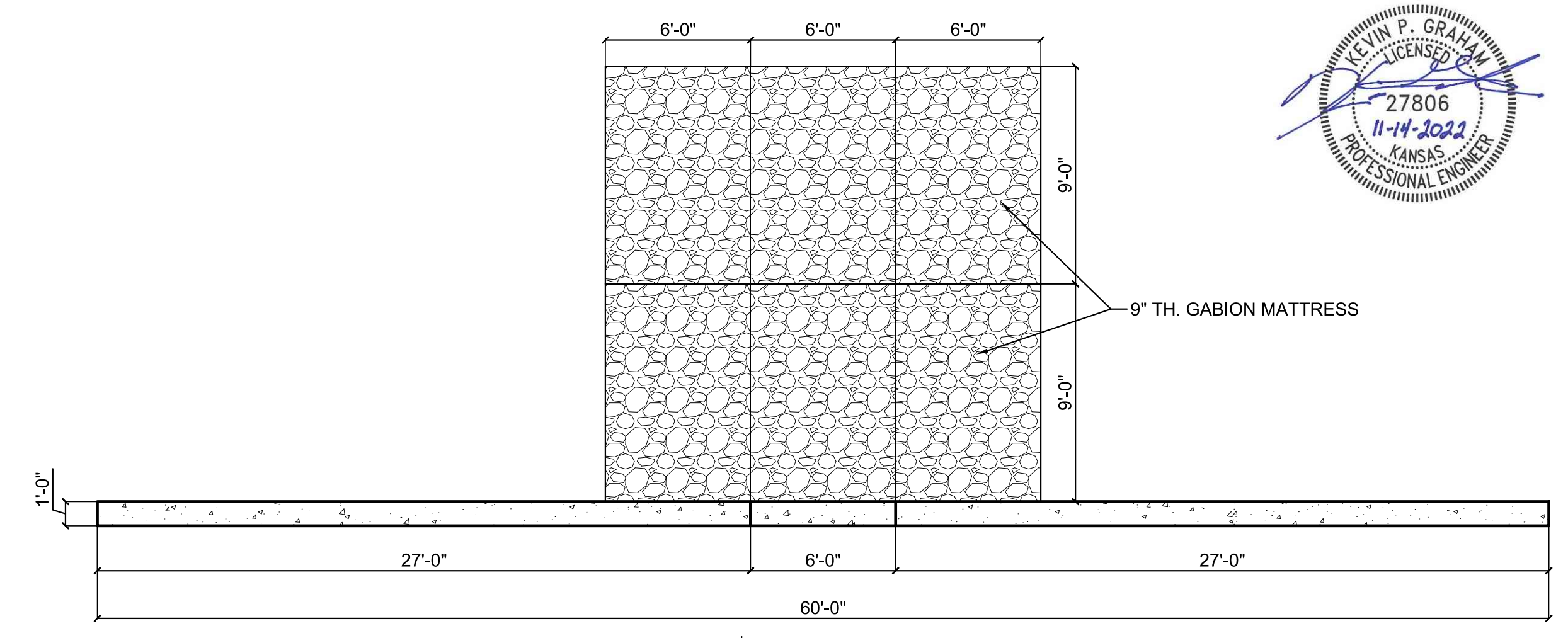
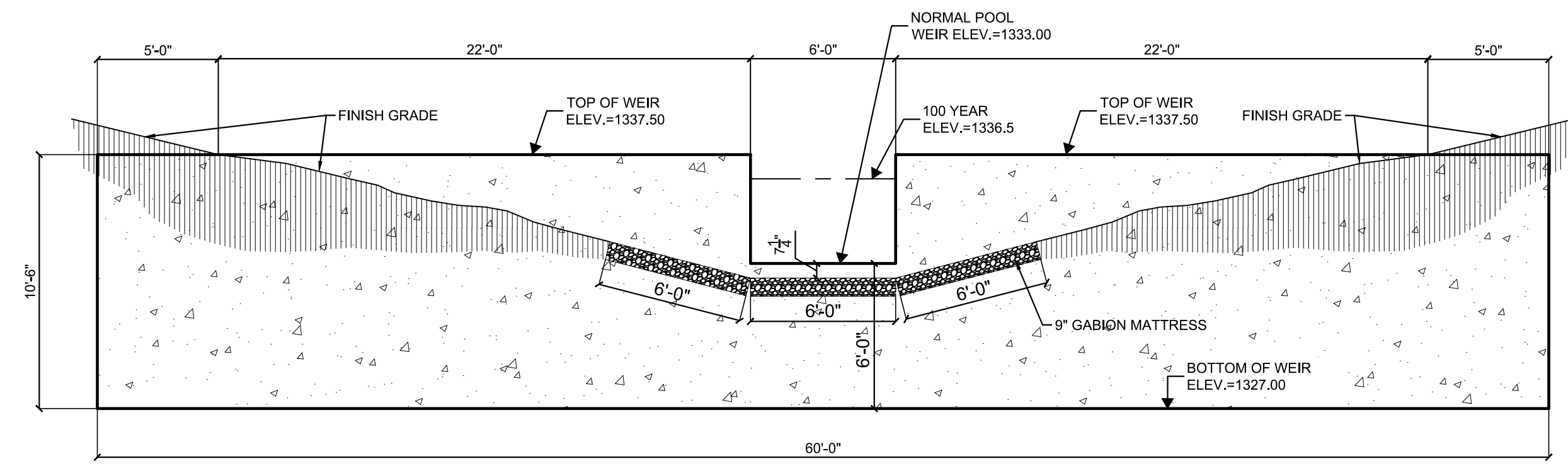
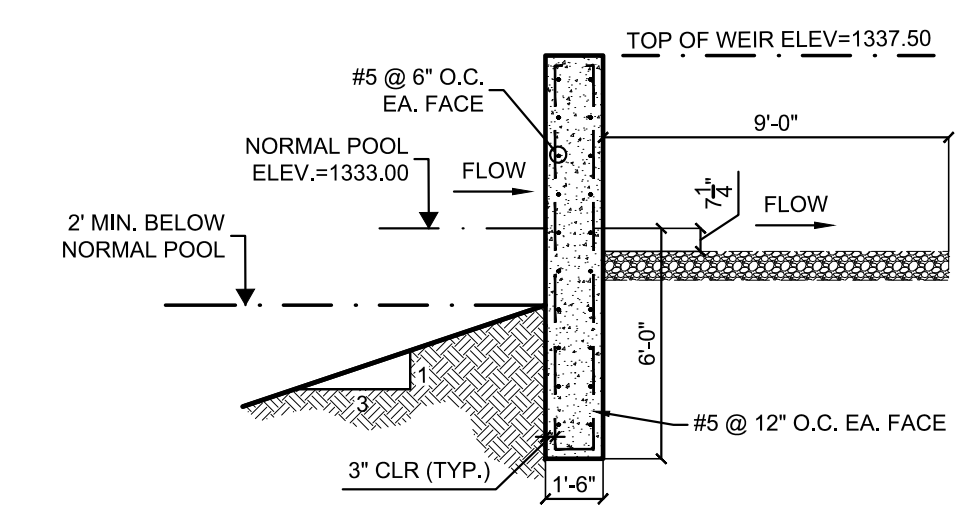

6 POND WEIR DETAIL
SCALE: NTS



©2022 MKEC Engineering All Rights Reserved www.mkec.com
These drawings and their contents, including, but not limited to, all concepts, designs, & ideas are the exclusive property of MKEC Engineering (MKEC), and may not be used or reproduced in any way without the express consent of MKEC.

GRADING DETAILS

PROJECT NO.	458-2022-085514	
DATE	NOV 2022	
SCALE	N.T.S.	
DESIGNED	DRAWN	CHECKED
KPG	MKEC	KPG
NO.	REVISION	DATE

J:\PROJECTS\2022\00101706_SCHROEDER_127TH AND PAWNEE\00_20706_CAD\SHS105_CIVIL\GRD\20706_GRD_DETAILS.DWG