

J:\PROJECTS\2022\2021010706_SCHROEDER_127TH AND PAWNEE\00_20706 CAD\SHOTS\05 CIVIL\GRD\20706_GRD_GRADING PLAN 3.DWG
 PLOTTED: Friday, November 11, 2022 @ 09:41 AM

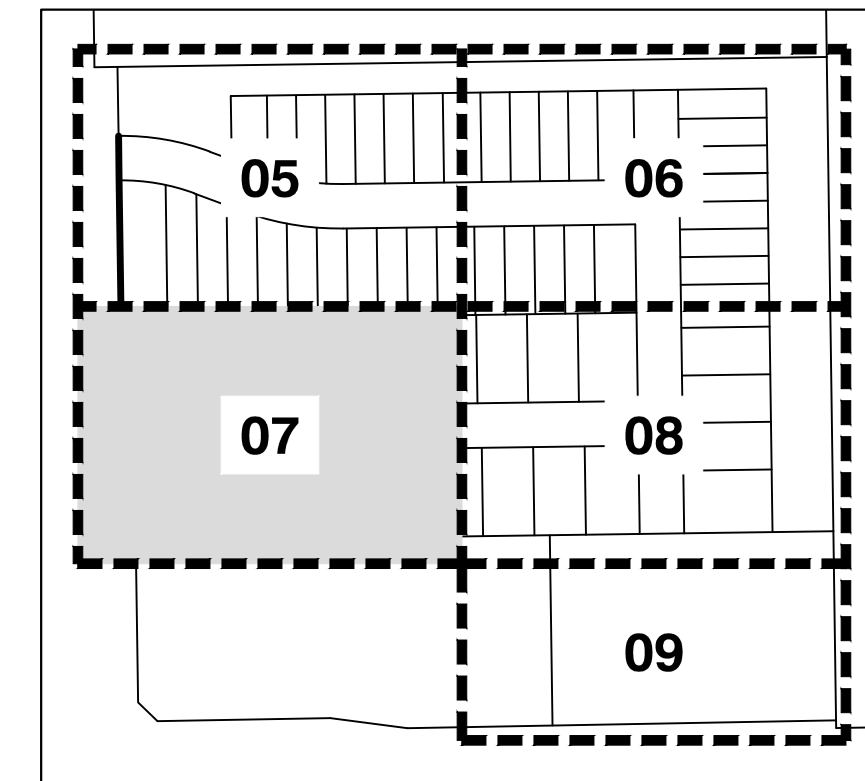
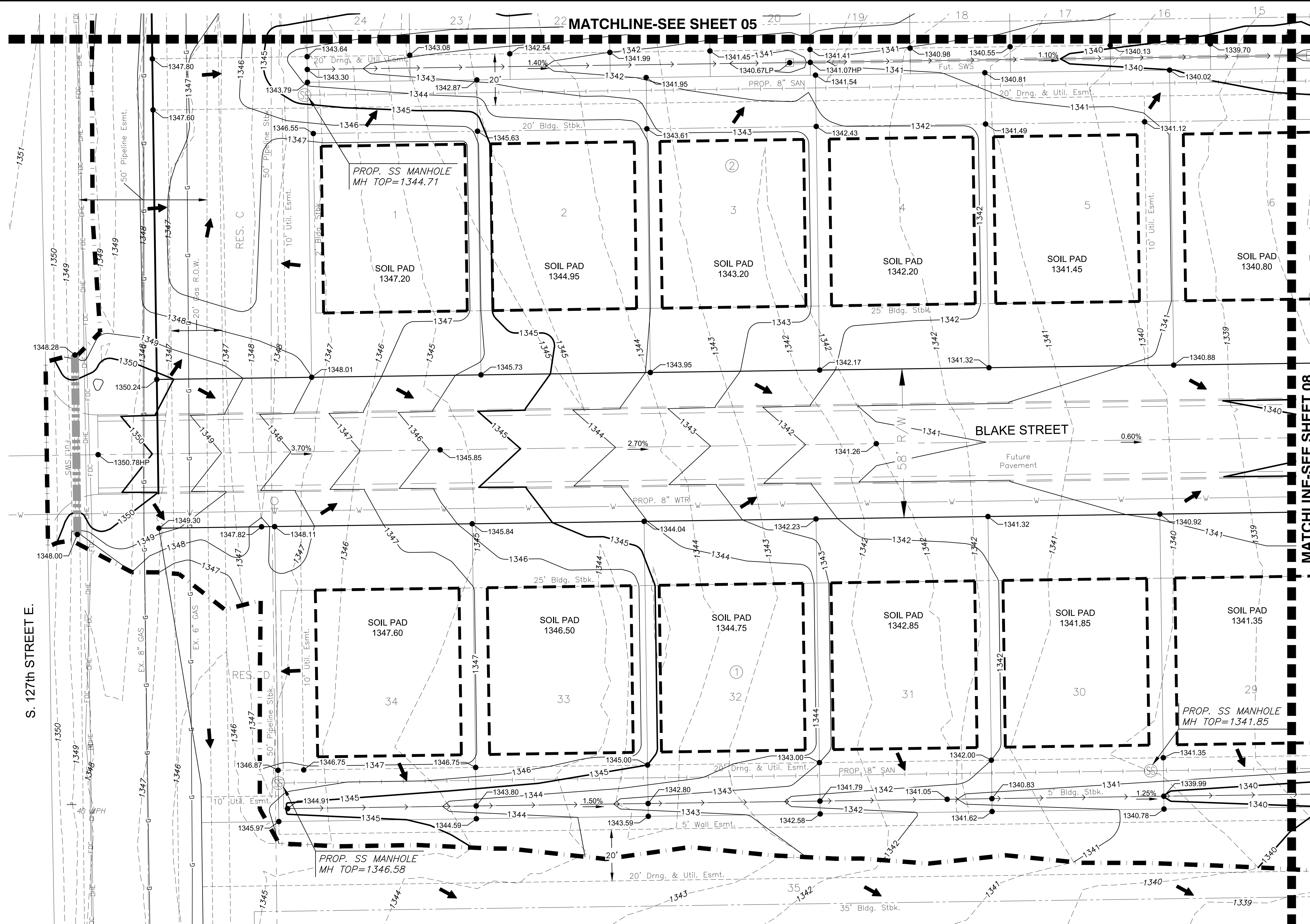

- LEGEND**
- 1250--- EXISTING MAJOR CONTOUR
 - 1250--- EXISTING MINOR CONTOUR
 - 1250- PROPOSED MAJOR CONTOUR
 - 1250- PROPOSED MINOR CONTOUR
 - WATER LINE
 - SANITARY SEWER
 - EXISTING STORM SEWER
 - FUTURE STORM SEWER
 - LIMITS OF GRADING
 - 1329.86 SPOT ELEVATIONS
 - FLOW ARROWS
 - PERMANENT SWALE FLOWLINE
 - TEMPORARY DRAINAGE SWALE (REF: DTL 04, SHT 3)

GRADING NOTES

- CONTOURS SHOWN WITHIN THE STREET PAVEMENT SECTION REPRESENT THE FINISHED PAVEMENT GRADE. REFER TO THE TYPICAL CROSS SECTION DETAIL ON SHEET 03.

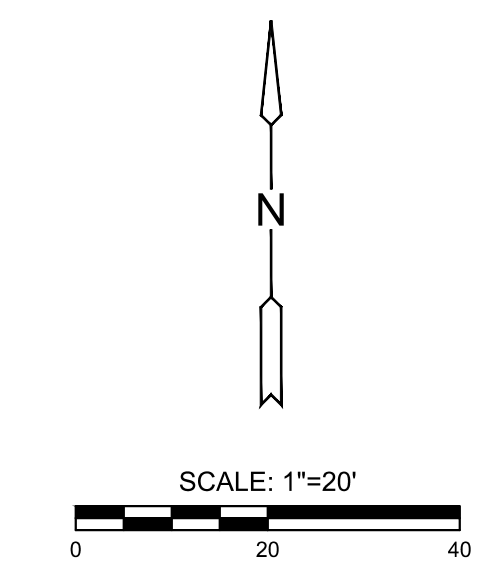

BENCHMARKS

BM & CP-100
 N:1673873.821 E:1691836.443 EL:1356.26
 MAG NAIL SET IN A FOUND SQUARE CUT ON SOUTH END OF WEIR WALL, 572' NORTH AND 77' WEST OF THE CENTERLINE OF 127TH ST. E. & PAWNEE

CP-101
 N:1674242.41 E:1691958.454 EL:1353.155
 5/8" REBAR WITH ALUMINUM CONTROL CAP

DATUM

The Horizontal Datum is based on the Kansas Coordinate System of 1983, NAD83(2011), EPOCH:2010.0000, South Zone. Coordinates shown have been modified to the ground using a combined adjustment factor of 1.0001200144. State Plane coordinates can be calculated by multiplying the shown values by 0.99998.

All elevations shown are based on the NAVD 88 vertical datum, Geoid12b.

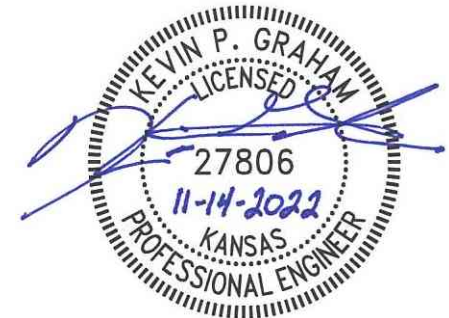

GRADING PLANS FOR
BUFFALO GROVE ADDITION
 WICHITA, KANSAS

©2022 MKEC Engineering All Rights Reserved www.mkec.com
 These drawings and their contents, including, but not limited to, all concepts, designs, & ideas are the exclusive property of MKEC Engineering (MKEC), and may not be used or reproduced in any way without the express consent of MKEC.

GRADING PLAN		
PROJECT NO.	458-2022-085514	
DATE	NOV 2022	
SCALE	1" = 20'	
DESIGNED	KPG	
DRAWN	MKEC	
CHECKED	KPG	
NO.	REVISION	DATE
SHEET NO.		
07 OF 17		