

# RECAPITULATION OF QUANTITIES

-FOR INFORMATION ONLY-

ITEM	TOTAL	UNIT
Pavement Markings (Left Turn Arrow)	6	EA.
Pavement Markings (24") (White)	125	L.F.
Pavement Markings (12") (Yellow)	40	L.F.
Pavement Markings (12") (White)	580	L.F.
Pavement Markings (6") (White)	200	L.F.
Pavement Markings (4") (Yellow)	400	L.F.
Wheelchair Ramp w/ Detectable Warnings	1	EA.
Concrete Sidewalk (4") Removed & Replaced	315	S.F.
Concrete C & G Removed & Replaced (Type I)	25	L.F.

All New Pavement Marking and Removal of Existing Pavement Marking Shall be Paid for by the Lump Sum bid item "Pavement Markings."

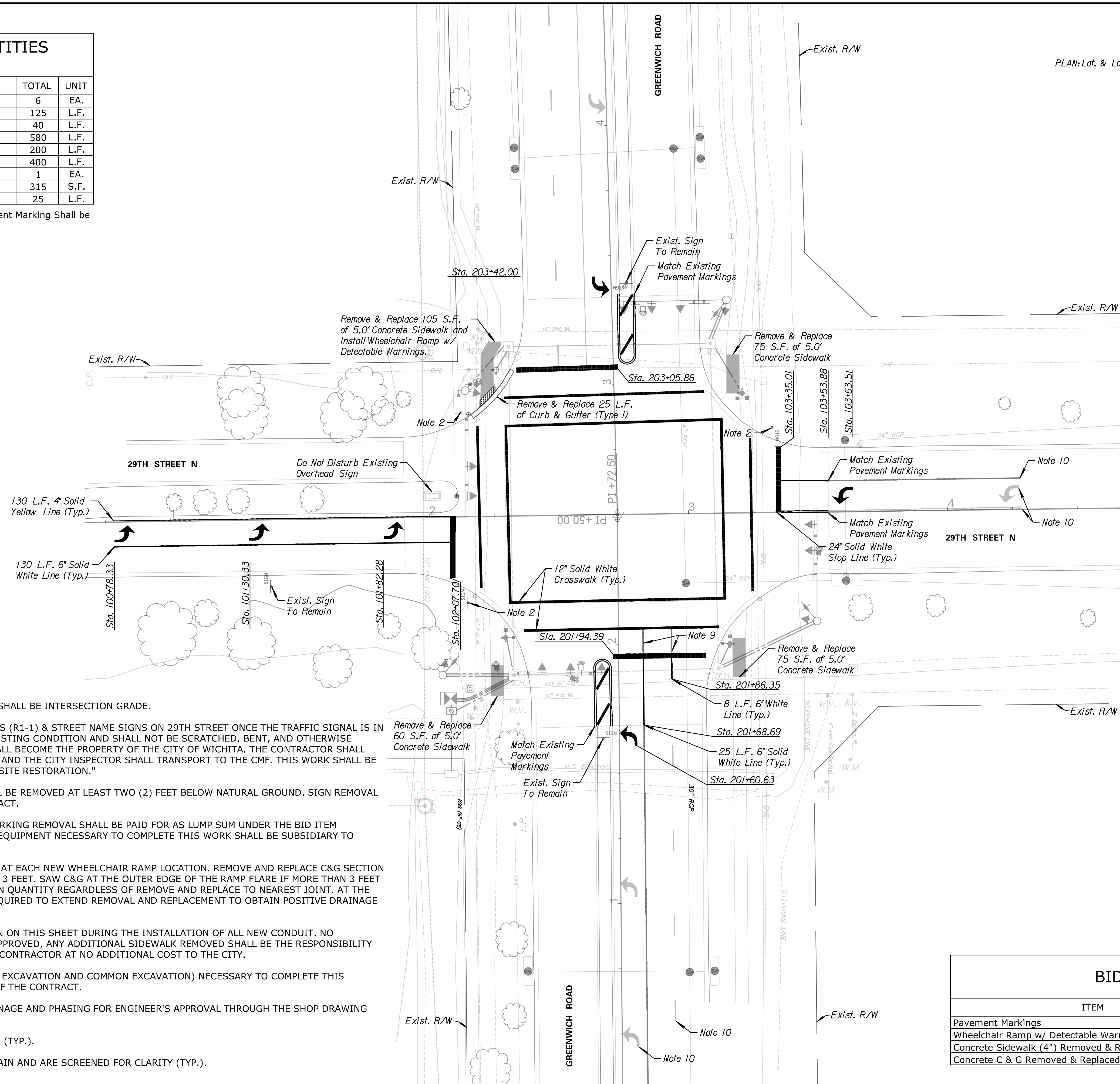
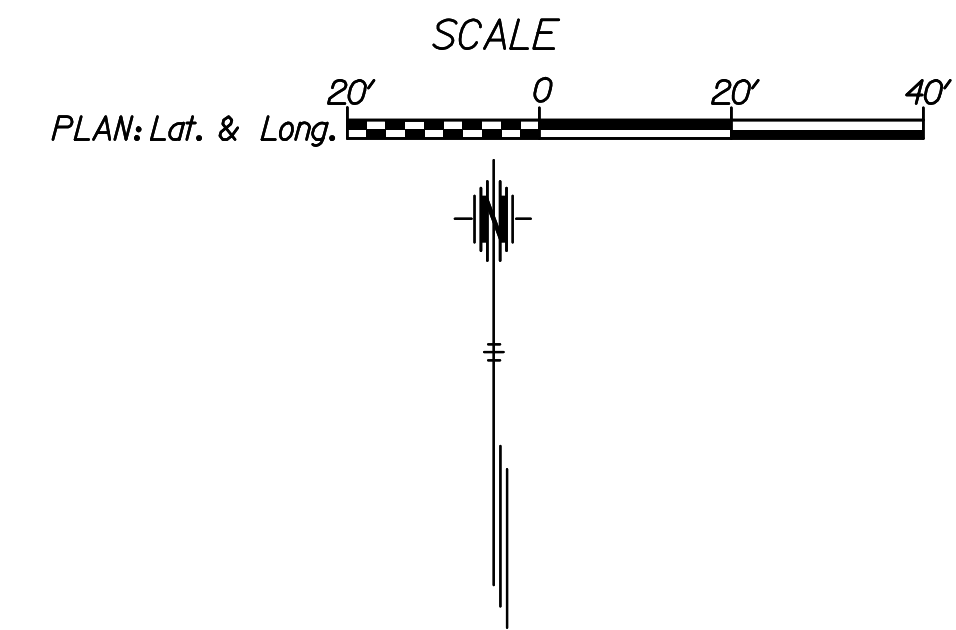

### GENERAL NOTES:

- ALL 24" SOLID WHITE STOP BAR PAVEMENT MARKINGS SHALL BE INTERSECTION GRADE.
- CONTRACTOR SHALL REMOVE THE EXISTING STOP SIGNS (R1-1) & STREET NAME SIGNS ON 29TH STREET ONCE THE TRAFFIC SIGNAL IS IN PLACE AND ACTIVE. SIGNS SHALL BE PRESERVED IN EXISTING CONDITION AND SHALL NOT BE SCRATCHED, BENT, AND OTHERWISE DAMAGED DURING REMOVAL AND STORAGE. SIGNS SHALL BECOME THE PROPERTY OF THE CITY OF WICHITA. THE CONTRACTOR SHALL STOCKPILE THE SALVAGED MATERIAL ON PROJECT SITE AND THE CITY INSPECTOR SHALL TRANSPORT TO THE CMF. THIS WORK SHALL BE SUBSIDIARY TO THE BID ITEMS "SITE CLEARING" AND "SITE RESTORATION."
- ALL SIGN FOOTINGS AND POSTS TO BE REMOVED SHALL BE REMOVED AT LEAST TWO (2) FEET BELOW NATURAL GROUND. SIGN REMOVAL SHALL BE SUBSIDIARY TO OTHER ITEMS OF THE CONTRACT.
- NEW PAVEMENT MARKING AND EXISTING PAVEMENT MARKING REMOVAL SHALL BE PAID FOR AS LUMP SUM UNDER THE BID ITEM "PAVEMENT MARKINGS". ALL MATERIALS, LABOR, AND EQUIPMENT NECESSARY TO COMPLETE THIS WORK SHALL BE SUBSIDIARY TO OTHER ITEMS OF THE CONTRACT.
- REMOVE AND REPLACE CURB & GUTTER (C&G) SECTION AT EACH NEW WHEELCHAIR RAMP LOCATION. REMOVE AND REPLACE C&G SECTION AND TRANSITION TO THE NEAREST JOINT IF LESS THAN 3 FEET. SAW C&G AT THE OUTER EDGE OF THE RAMP FLARE IF MORE THAN 3 FEET TO THE NEAREST JOINT. C&G WILL BE PAID FOR BY PLAN QUANTITY REGARDLESS OF REMOVE AND REPLACE TO NEAREST JOINT. AT THE ENGINEER'S DISCRETION THE CONTRACTOR MAY BE REQUIRED TO EXTEND REMOVAL AND REPLACEMENT TO OBTAIN POSITIVE DRAINAGE DUE TO CURB & GUTTER FLOWLINE DIFFERENCES.
- REMOVE AND REPLACE CONCRETE SIDEWALK AS SHOWN ON THIS SHEET DURING THE INSTALLATION OF ALL NEW CONDUIT. NO ADDITIONAL SIDEWALK SHALL BE REMOVED. UNLESS APPROVED, ANY ADDITIONAL SIDEWALK REMOVED SHALL BE THE RESPONSIBILITY OF THE CONTRACTOR AND SHALL BE REPLACED BY THE CONTRACTOR AT NO ADDITIONAL COST TO THE CITY.
- ANY EARTHWORK (COMPACTION OF EARTHWORK, ROCK EXCAVATION AND COMMON EXCAVATION) NECESSARY TO COMPLETE THIS PROJECT SHALL BE SUBSIDIARY TO OTHER BID ITEMS OF THE CONTRACT.
- CONTRACTOR SHALL PROVIDE SIDEWALK CLOSURE SIGNAGE AND PHASING FOR ENGINEER'S APPROVAL THROUGH THE SHOP DRAWING PROCESS.
- REMOVE EXISTING PAVEMENT MARKINGS AND SYMBOLS (TYP.).
- EXISTING PAVEMENT MARKINGS AND SYMBOLS TO REMAIN AND ARE SCREENED FOR CLARITY (TYP.).

BID ITEM		
ITEM	TOTAL	UNIT
Pavement Markings	1	LSUM
Wheelchair Ramp w/ Detectable Warnings	1	EA
Concrete Sidewalk (4") Removed & Replaced	315	SF
Concrete C & G Removed & Replaced (Type I)	25	LF

**Tran Systems**  
 245 NORTH WACO  
 SUITE 222  
 WICHITA, KANSAS 67202  
 PHONE: 316-303-3000  
 FAX: 316-462-5629

CONSULTANTS:

29TH STREET N & GREENWICH ROAD  
 TRAFFIC SIGNALIZATION  
 WICHITA, KANSAS

REVISIONS:	MARK	DATE	DESCRIPTION

PROJ NO: 472-085773  
 SCALE: 1:20  
 DATE: 12/20/2022  
 DESIGNED BY: SSP  
 DRAWN BY: SSP  
 CHECKED BY: SGE

SHEET TITLE:  
**PAVEMENT MARKING AND SIGNING PLAN SHEET**

SHEET NO.  
**13**  
 SHEET 13 OF 17

sepall 12/20/2022 7:22:47 PM - c:\tran\systems\paw\_bocall\tran\sysop\paw\1spall\11764391c-pmk-m01-101.dgn