

©2022
MKEC Engineering
All Rights Reserved
www.mkec.com
These drawings and their contents, including, but not limited to, all concepts, designs, & ideas are the exclusive property of MKEC Engineering (MKEC), and may not be used or reproduced in any way without the express consent of MKEC.

**STORM SEWER
PLAN & PROFILE
LINE 1 & 2**

PROJECT NO. 472-2021-085733

DATE 12/28/2022

SCALE 1"=20'

DESIGNED DRAWN CHECKED
SLF BKS JRA

NO. REVISION DATE

SHEET NO.

STA. 10+17.2, PH. 1-LINE 1
ST. STA. 84+10.88, 25.50' RT.
INSTALL TYPE 1 CURB INLET
(10'X3')
INLET TOP=1306.35
SEE SH. NO. 29

STA. 10+00.00, PH. 1-LINE 1=
ST. STA. 84+10.88, 42.73' RT.
INSTALL 5' DIA. SHALLOW MH
DOGHOUSE. CONNECT EXIST.
24" RCP (E&W)
MH TOP=1307.0
SEE SH. NO. 33

STA. 10+65.7, PH. 1-LINE 1
ST. STA. 84+10.88, 22.94' LT.
INSTALL 2-TYPE 2 CURB INLETS
(DOUBLE)
INLET TOP=1306.35
SEE SH. NO. 31

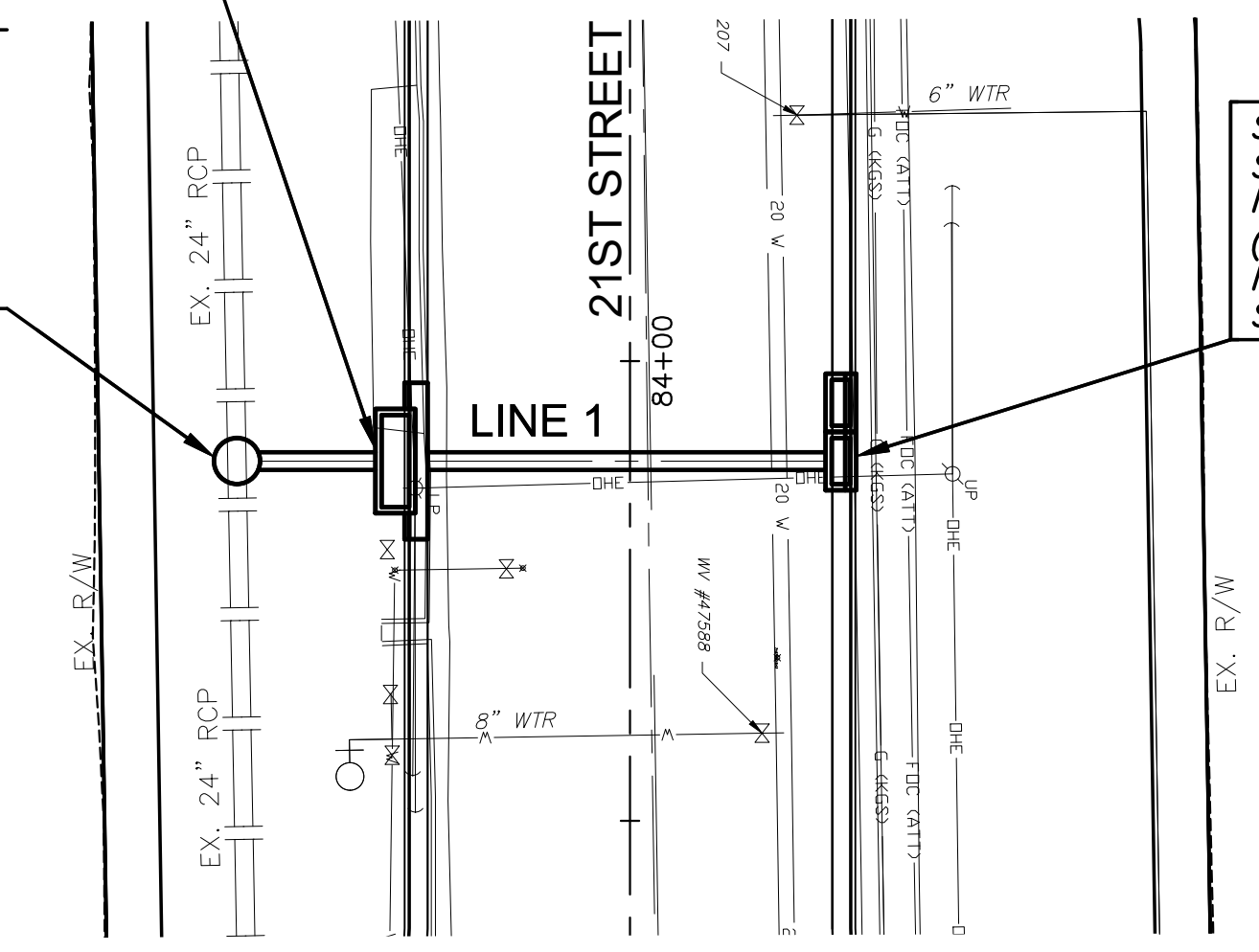

STA. 10+10.8, PH. 1-LINE 2
ST. STA. 86+00.11, 31.50' RT.
INSTALL TYPE 1 CURB INLET
(10'X3')
INLET TOP=1306.99
SEE SH. NO. 29

STA. 10+00.00, PH. 1-LINE 2=
ST. STA. 86+00.07, 42.30' RT.
INSTALL 5' DIA. SHALLOW MH
DOGHOUSE. CONNECT EXIST.
24" RCP (E&W)
MH TOP=1307.9
SEE SH. NO. 33

STA. 10+71.2, PH. 1-LINE 2
ST. STA. 86+00.34, 28.94' LT.
INSTALL 2-TYPE 2 CURB INLETS
(DOUBLE)
INLET TOP=1306.99
SEE SH. NO. 31

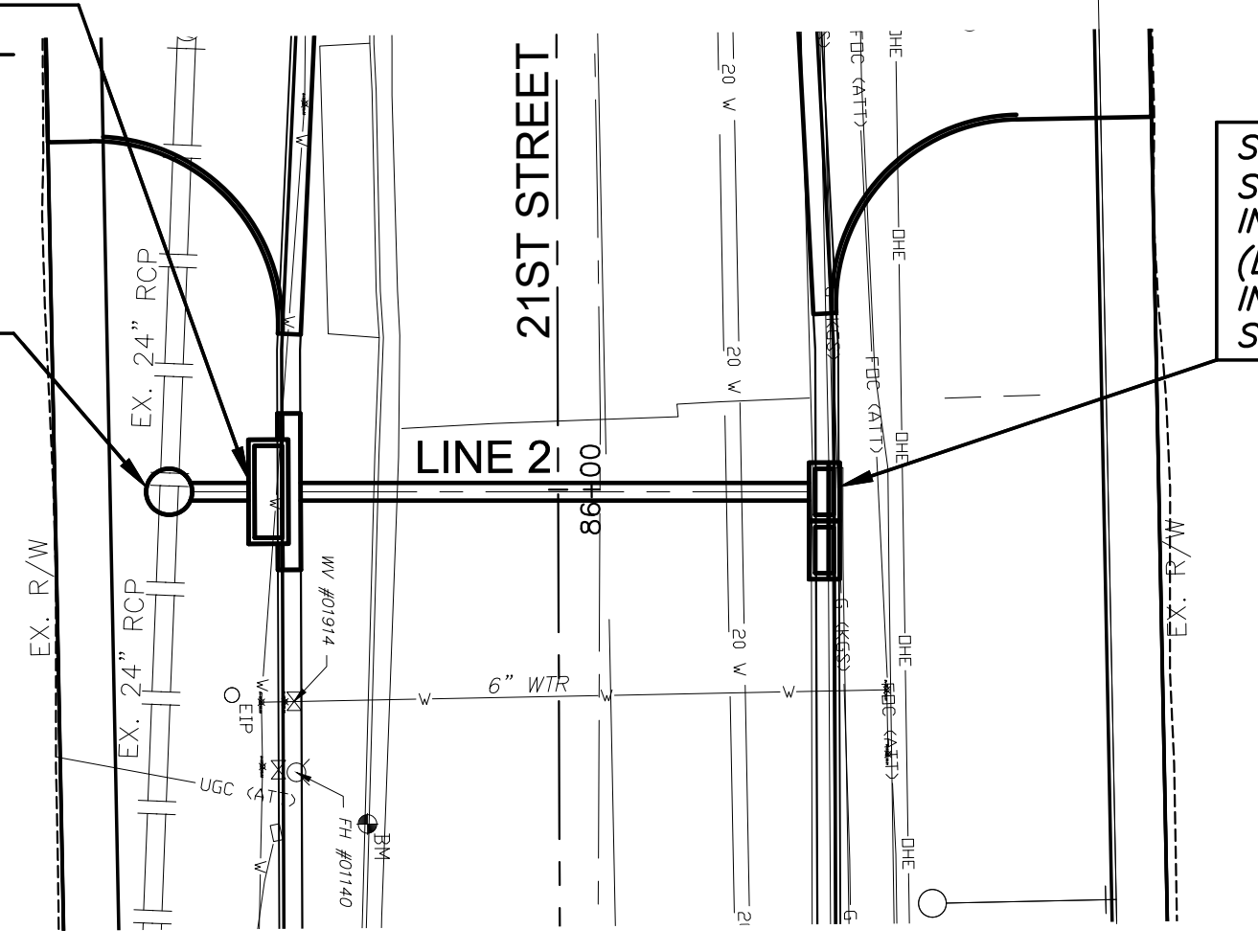

PLAN PH. 1-LINE 1 SWS
PROFILE PH. 1-LINE 1 SWS

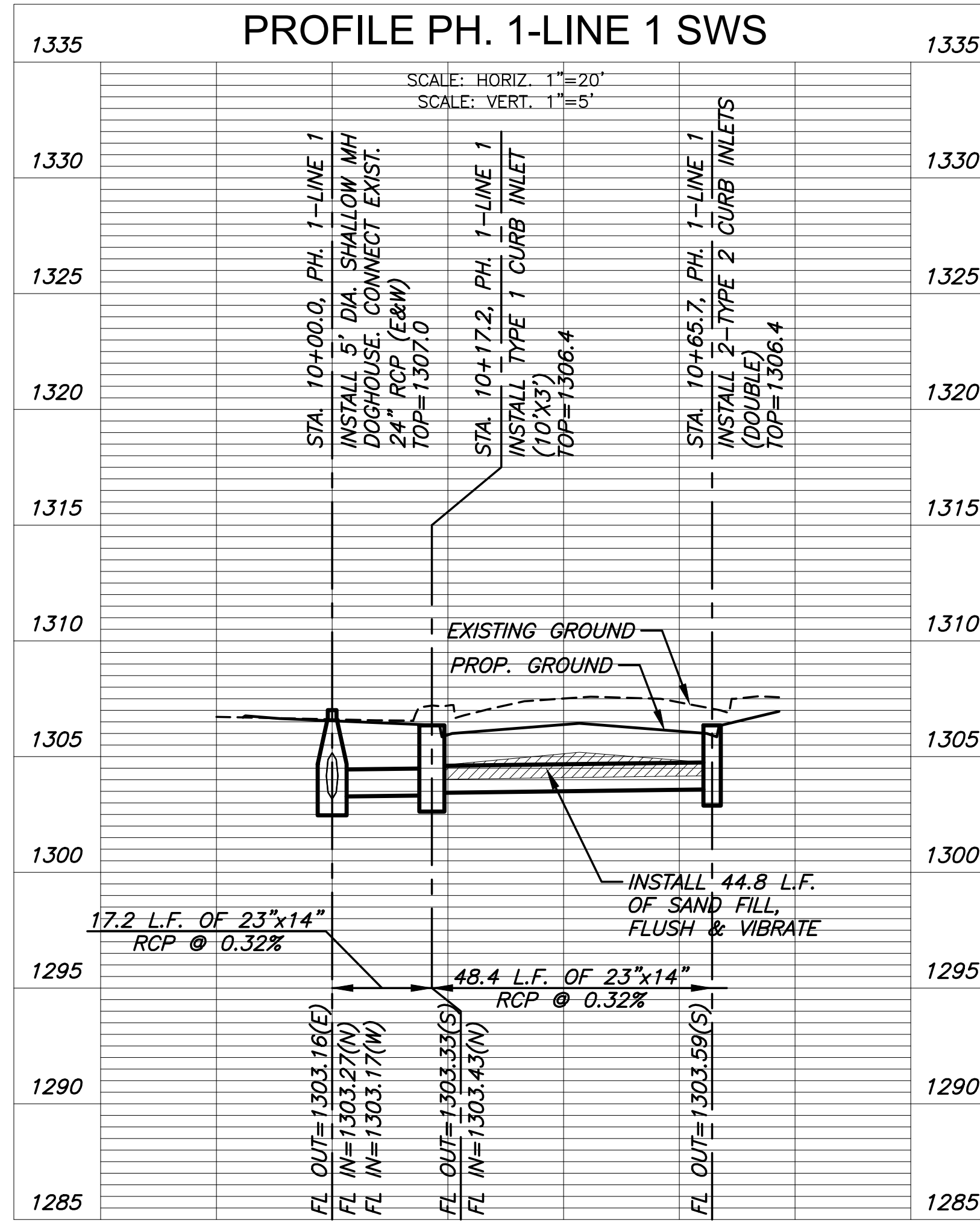

10

PLAN PH. 1-LINE 2 SWS
PROFILE PH. 1-LINE 2 SWS

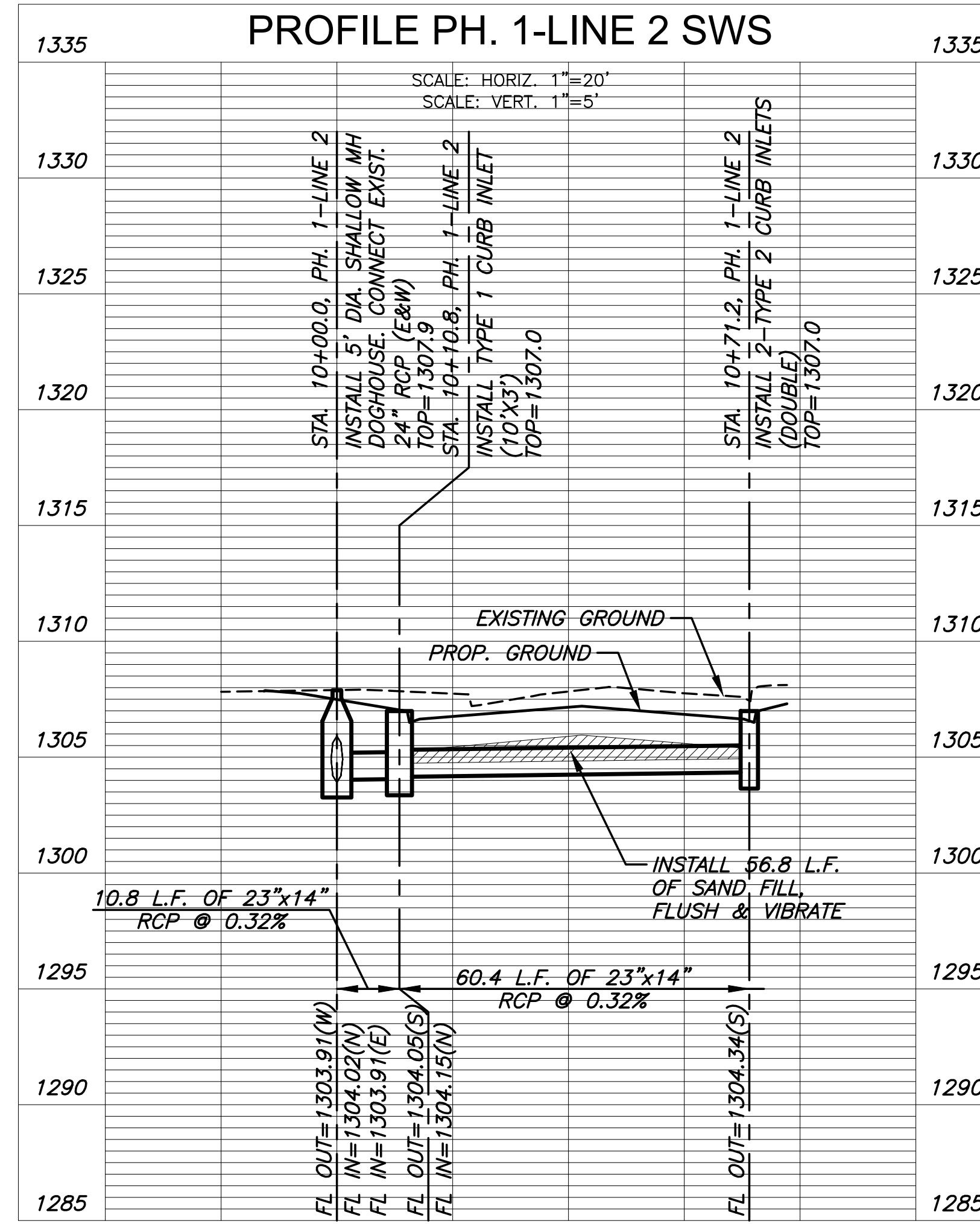

10

J:\PROJECTS\2022\12\10\10465_COW_21ST STREET FROM MOSLEY TO I-135\00210465 CAD\SHS\PHASE 1\210465 SWS PP 1.DWG PLOTTED: Wednesday, December 28, 2022 @ 10:58AM