

PLOTTED: Wednesday, December 28, 2022 @ 11:02AM  
 J:\PROJECTS\2021\10101045\_COW\_21ST STREET FROM MOSLEY TO I-135\00210455 CIVIL\PAVPHASE 1\210455 INTERSECT CLEVELAND.DWG

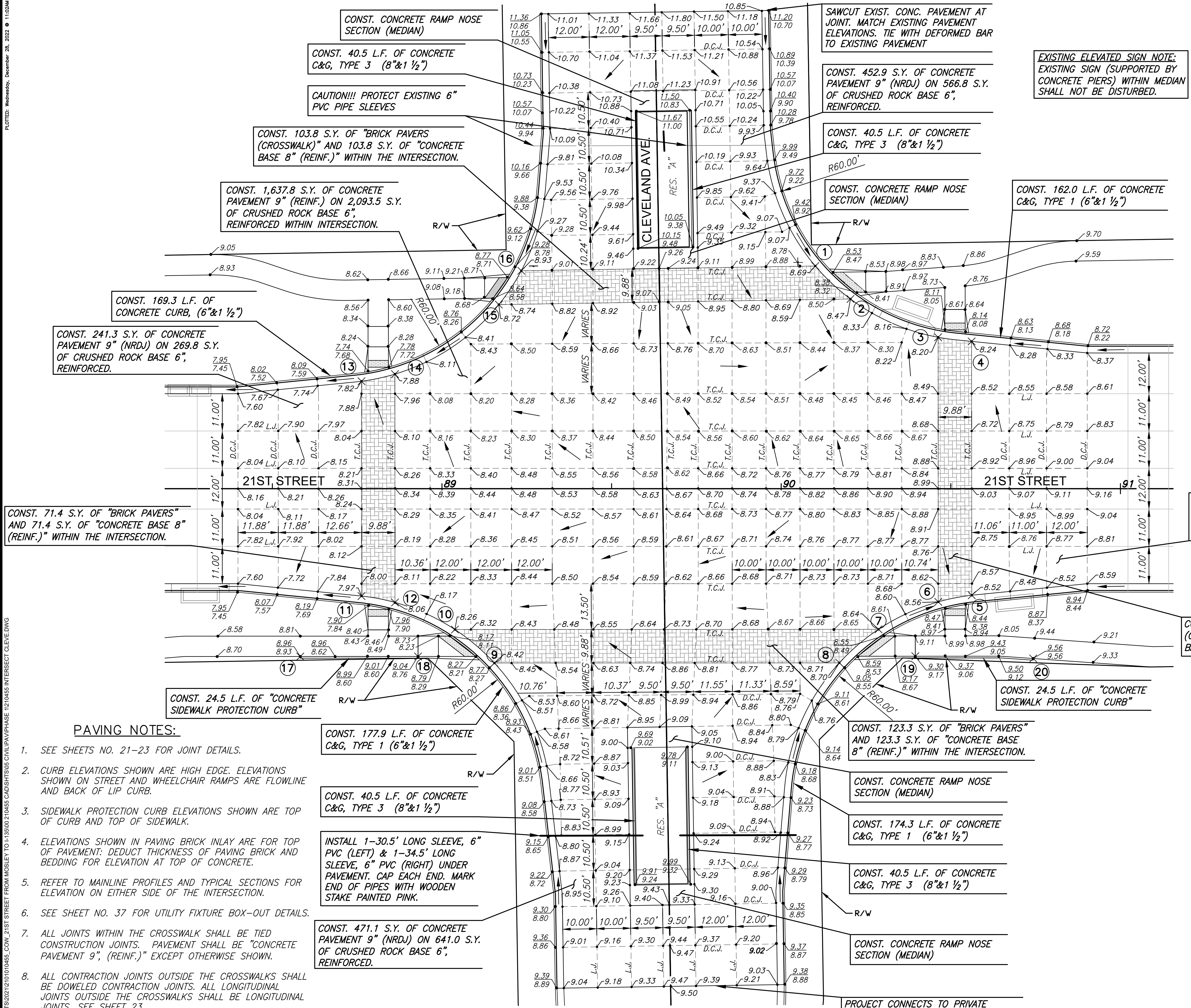

STREET IMPROVEMENTS FOR  
**21ST STREET - MOSLEY TO I-135**  
 PHASE 1

MISCELLANEOUS PAVING POINTS			
PT NO.	NORTHING	EASTING	REMARKS
1	1699254.04	1653310.13	X-WALK PAVERS
2	1699244.30	1653320.45	X-WALK PAVERS
3	1699232.93	1653346.27	X-WALK PAVERS
4	1699231.69	1653356.14	X-WALK PAVERS
5	1699156.87	1653355.97	X-WALK PAVERS
6	1699154.95	1653346.09	X-WALK PAVERS
7	1699146.90	1653328.45	X-WALK PAVERS
8	1699137.06	1653316.89	X-WALK PAVERS
9	1699137.29	1653215.21	X-WALK PAVERS
10	1699147.19	1653203.59	X-WALK PAVERS
11	1699157.14	1653176.07	X-WALK PAVERS
12	1699155.23	1653185.94	X-WALK PAVERS
13	1699220.45	1653176.25	X-WALK PAVERS
14	1699222.53	1653186.13	X-WALK PAVERS
15	1699242.93	1653216.79	X-WALK PAVERS
16	1699252.89	1653223.45	X-WALK PAVERS
17	1699139.37	1653157.97	PROTECTION CURB
18	1699139.28	1653192.69	PROTECTION CURB
19	1699138.94	1653339.28	PROTECTION CURB
20	1699138.17	1653374.03	PROTECTION CURB



- PAVING NOTES:**
- SEE SHEETS NO. 21-23 FOR JOINT DETAILS.
  - CURB ELEVATIONS SHOWN ARE HIGH EDGE. ELEVATIONS SHOWN ON STREET AND WHEELCHAIR RAMPS ARE FLOWLINE AND BACK OF LIP CURB.
  - SIDEWALK PROTECTION CURB ELEVATIONS SHOWN ARE TOP OF CURB AND TOP OF SIDEWALK.
  - ELEVATIONS SHOWN IN PAVING BRICK INLAY ARE FOR TOP OF PAVEMENT. DEDUCT THICKNESS OF PAVING BRICK AND BEDDING FOR ELEVATION AT TOP OF CONCRETE.
  - REFER TO MAINLINE PROFILES AND TYPICAL SECTIONS FOR ELEVATION ON EITHER SIDE OF THE INTERSECTION.
  - SEE SHEET NO. 37 FOR UTILITY FIXTURE BOX-OUT DETAILS.
  - ALL JOINTS WITHIN THE CROSSWALK SHALL BE TIED CONSTRUCTION JOINTS. PAVEMENT SHALL BE "CONCRETE PAVEMENT 9", (REINF.)" EXCEPT OTHERWISE SHOWN.
  - ALL CONTRACTION JOINTS OUTSIDE THE CROSSWALKS SHALL BE DOWELED CONTRACTION JOINTS. ALL LONGITUDINAL JOINTS OUTSIDE THE CROSSWALKS SHALL BE LONGITUDINAL JOINTS. SEE SHEET 23.
  - SEE SHEET NO. 21 FOR CROSSWALK DETAILS AND NOTES.

CONST. 270.3 S.Y. OF CONCRETE PAVEMENT 9" (NRDJ) ON 297.0 S.Y. OF CRUSHED ROCK BASE 6", REINFORCED.

CONST. 83.6 S.Y. OF "BRICK PAVERS (CROSSWALK)" AND 83.6 S.Y. OF "CONCRETE BASE 8" (REINF.)" WITHIN THE INTERSECTION.

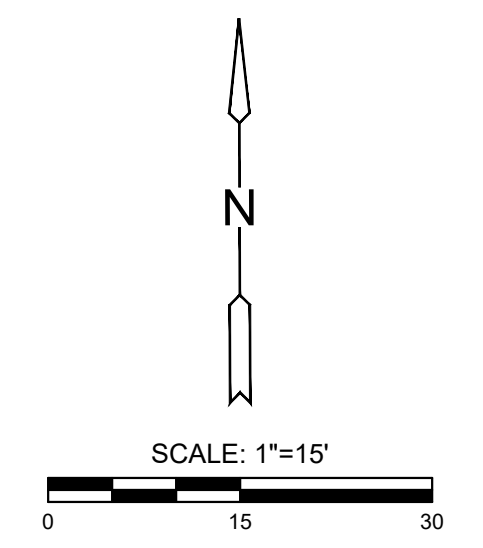

- LEGEND**
- T.C.J. Tied Construction Joint
  - D.I.J. Doweled Isolation Joint
  - D.C.J. Doweled Contraction Joint
  - L.J. Longitudinal Joint
  - x Surface Spot Elevation
  - Direction of Surface Flow
  - ⊕ Manhole Lid

**INTERSECTION PLAN - 21ST & CLEVELAND**

PROJECT CONNECTS TO PRIVATE PAVING PROJECT: 472-2021-085727 (BAUGHMAN COMPANY)

©2022 MKEC Engineering All Rights Reserved www.mkec.com  
 These drawings and their contents, including, but not limited to, all concepts, designs, & ideas are the exclusive property of MKEC Engineering (MKEC), and may not be used or reproduced in any way without the express consent of MKEC.

INTERSECTION PLAN - 21ST & CLEVELAND	
PROJECT NO.	472-2021-085733
DATE	12/28/2022
SCALE	1"=15'
DESIGNED	DRAWN
SLF	BKS
CHECKED	JRA
NO.	REVISION
DATE	
SHEET NO.	
20 OF 92	