

J:\PROJECTS\2022\2001010706\_SCHROEDER\_127TH AND PAWNEE\00\_20766 CAD\SHTS\05 CIVIL\PAV\20766\_PAV\_BLAKE.DWG  
 PLOTTED: Thursday, January 12, 2023 @ 08:15AM

SUBDIVISION BENCH MARKS				
NO.	STREET AND STATION	FROM CL	DESCRIPTION	ELEVATIONS
1	BLAKE STREET, STA. 15+27.10	15.5' RT	TOP OF CURB AT FIRE HYDRANT	1340.24

NOTE: CONTRACTOR SHALL INSTALL SUBDIVISION BENCH MARKS ("FLAT SURVEY MARKERS NO. 8134-08 3" TOP DIAMETER" PROVIDED BY KANSAS BLUE PRINT CO., INC.) COSTS TO BE CONSIDERED SUBSIDIARY TO CONSTRUCTION OF COMBINED CURB AND GUTTER.

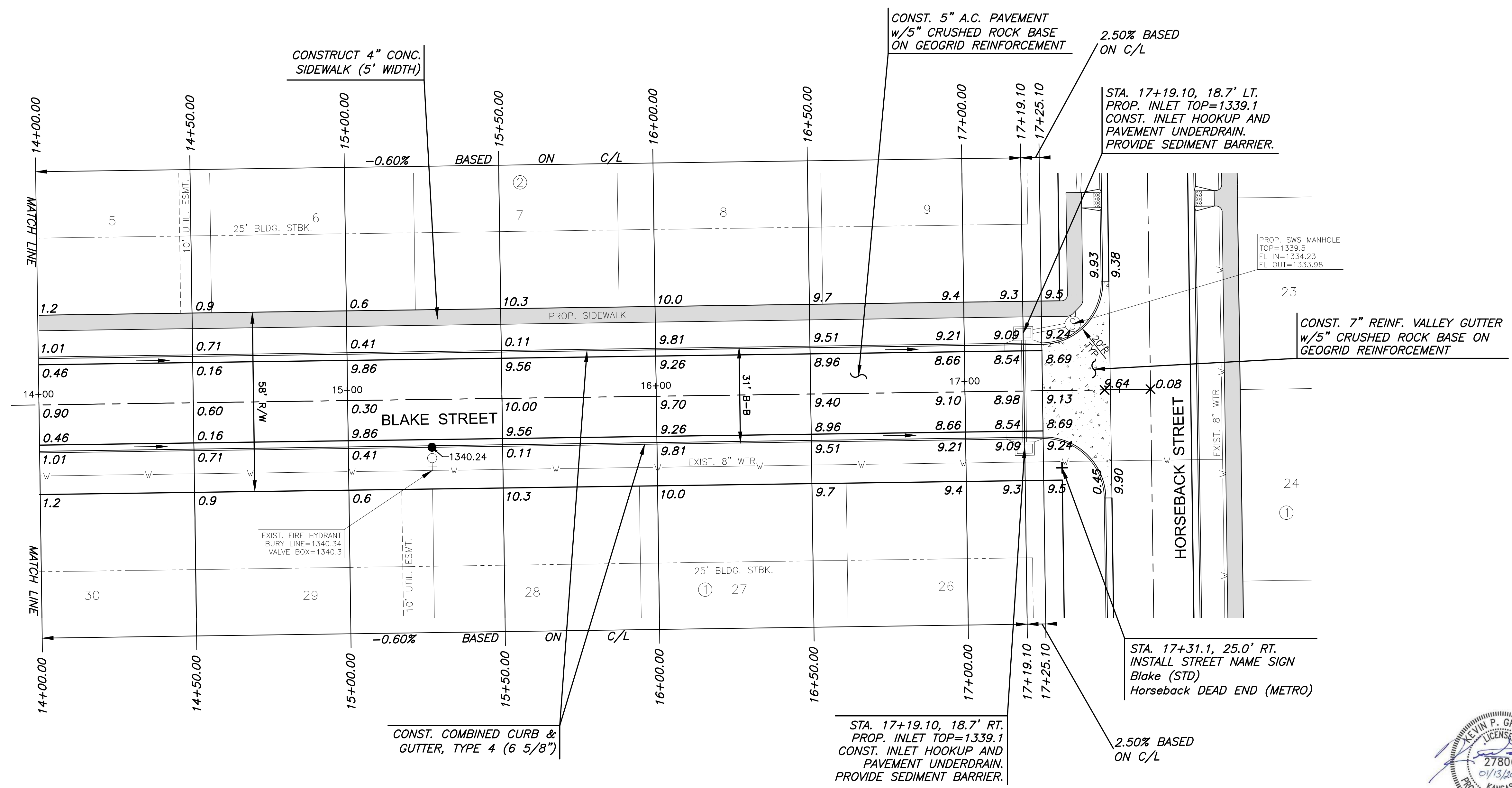

PAVING IMPROVEMENTS FOR  
**BUFFALO GROVE ADDITION**  
 WICHITA, KANSAS

©2023  
 MKEC Engineering  
 All Rights Reserved  
 www.mkec.com  
 These drawings and their contents, including, but not limited to, all concepts, designs, & ideas are the exclusive property of MKEC Engineering (MKEC), and may not be used or reproduced in any way without the express consent of MKEC.

**BLAKE STREET (CONT.)**

PROJECT NO.	472-2022-085818	
DATE	JAN 2023	
SCALE	1" = 20'	
DESIGNED	KPG	
DRAWN	MKEC	
CHECKED	KPG	
NO.	REVISION	DATE



**LEGEND**

+ STREET SIGN & SIGN LOCATION  
 (SEE SIGN ASSEMBLY TABLE  
 FOR TYPE & STATION OF SIGN)

NOTE:  
 TOP OF CURB ELEVATIONS SHOWN  
 ARE FOR FULL CURB. CONSTRUCT  
 CURB AND GUTTER AS NOTED.

