

PLOTTED: Friday, January 06, 2023 @ 08:22PM

J:\PROJECTS\2022\12\10\10427_PERFECTION_COURTYARDS AT MOORINGS\DWG\12\10427 CAD\SH1\12\10427-05-4217.DWG

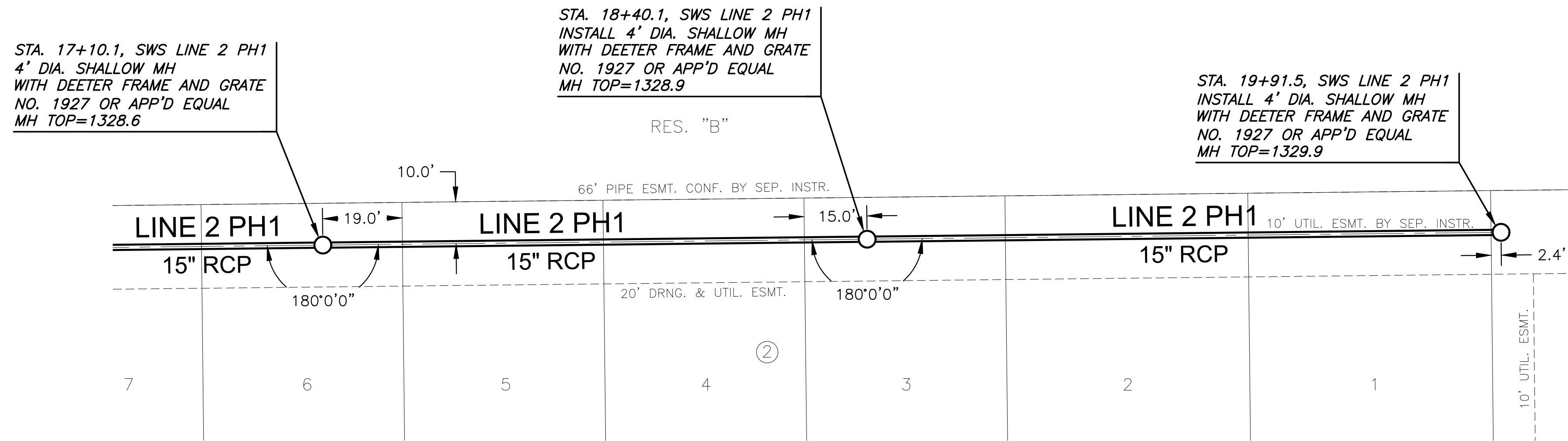

NOTE:
CONTRACTOR TO VERIFY THE
DEPTH AND LOCATION OF EXISTING
UTILITIES PRIOR TO CONSTRUCTION.

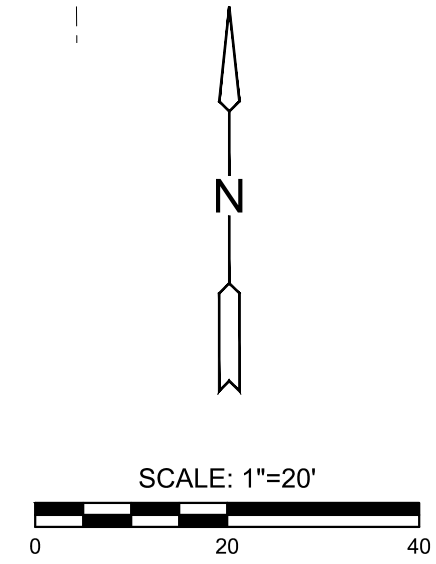

PLAN SWS LINE 2 PH1 (CONT. 2)
PROFILE SWS LINE 2 PH1 (CONT. 2)

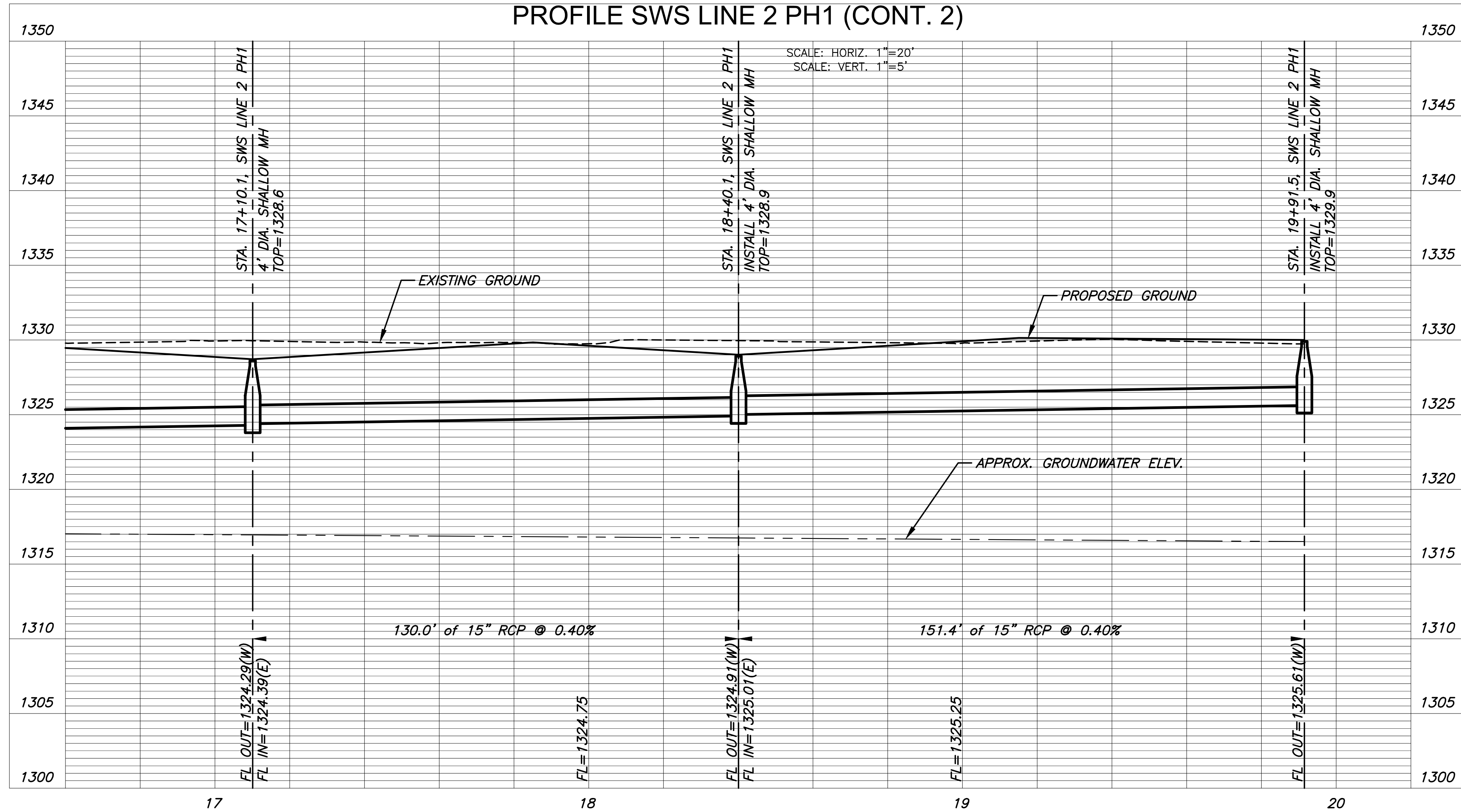

©2023
MKEC Engineering
All Rights Reserved
www.mkec.com
These drawings and their contents,
including, but not limited to, all concepts,
designs, & ideas are the exclusive
property of MKEC Engineering (MKEC),
and may not be used or reproduced in any
way without the express consent of MKEC.

SWS LINE 2
(CONT.)

PROJECT NO.	472-2022-085820A	
DATE	JAN. 2023	
SCALE	1" = 20'	
DESIGNED	DRAWN	CHECKED
DFL	JWC	SPE

NO.	REVISION	DATE

SHEET NO.