

BENCHMARKS

BM- #1:
Square cut on top of South curb of 21st St. N.
334± West and 32± South of the intersection of
21st St. N. and Cleveland Ave.
Elev. = 1307.56(NAVD88)

BM- #2:
Square cut on top of South concrete pad of
monitoring well 26± East and 51± South of the
intersection of 21st St. N. and Cleveland Ave.
Elev. = 1308.70(NAVD88)

BM- #3:
C.O.W BM Disc on top of South concrete wall
918± West and 147± North of the intersection
of 21st St. N. and Cleveland Ave.
Elev. = 1312.58(NAVD88)

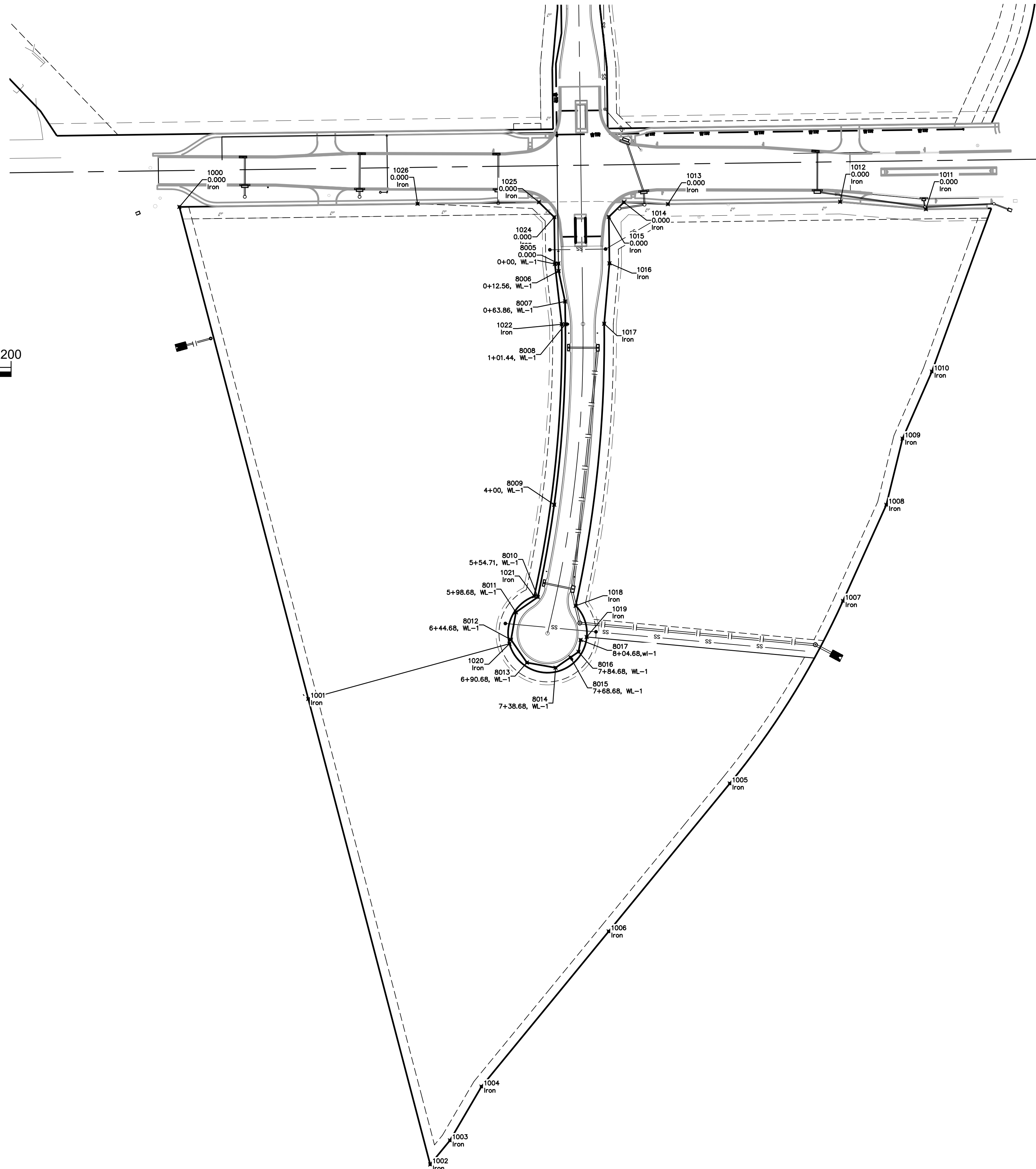
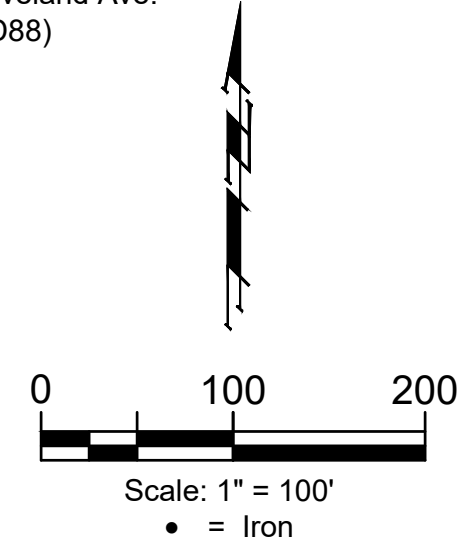

Point #	Northing	Easting	Description
1000	1698927.04	1652404.35	Iron
1001	1698115.52	1652616.93	Iron
1002	1697347.67	1652818.00	Iron
1003	1697387.30	1652850.56	Iron
1004	1697476.03	1652902.53	Iron
1005	1697976.02	1653311.96	Iron
1006	1697731.97	1653112.28	Iron
1007	1698277.09	1653498.56	Iron
1008	1698435.65	1653570.12	Iron
1009	1698544.87	1653596.86	Iron
1010	1698655.38	1653645.18	Iron
1011	1698923.31	1653635.38	Iron
1012	1698935.44	1653493.90	Iron
1013	1698931.68	1653209.93	Iron
1014	1698934.55	1653137.17	Iron
1015	1698910.54	1653112.52	Iron
1016	1698833.99	1653113.54	Iron
1017	1698734.36	1653104.85	Iron
1018	1698269.08	1653057.81	Iron
1019	1698217.65	1653076.06	Iron
1020	1698206.45	1652948.65	Iron
1021	1698284.90	1652989.62	Iron
1022	1698733.44	1653034.86	Iron
1023	1698832.80	1653023.54	Iron
1024	1698910.21	1653022.52	Iron
1025	1698934.87	1652997.19	Iron
1026	1698932.23	1652797.11	Iron
8005	1698833.83	1653029.33	0+00, WL-1
8006	1698821.27	1653029.69	0+12.56, WL-1
8007	1698771.10	1653040.36	0+63.86, WL-1
8008	1698733.52	1653040.86	1+01.44, WL-1
8009	1698435.81	1653022.46	4+00, WL-1
8010	1698283.51	1652995.46	5+54.71, WL-1
8011	1698258.42	1652959.35	5+98.68, WL-1
8012	1698213.14	1652951.20	6+44.68, WL-1
8013	1698175.37	1652977.46	6+90.68, WL-1
8014	1698166.87	1653024.70	7+38.68, WL-1
8015	1698183.99	1653049.33	7+68.68, WL-1
8016	1698193.12	1653062.47	7+94.68, WL-1
8017	1698212.81	1653066.01	8+04.68, WL-1

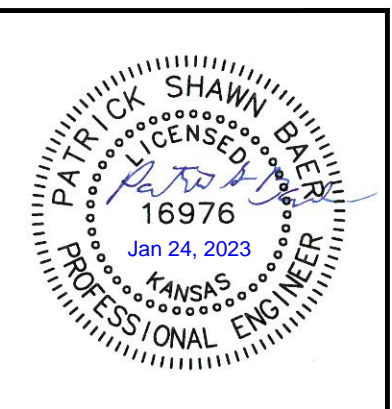

**BAUGHMAN
COMPANY**

315 Ellis St.
Wichita, KS 67211
316-262-7271
BaughmanCo.com

Cornejo Industrial District 2nd

Coordinate

Water Line
Improvements

PROJECT NUMBER:
448-2021-017261

DESIGN: PSB DRAWN: JA

DATE: Jan 23, 2023

SHEET OF
14 15

File: E:\Projects\Cornejo Industrial District_2nd (21-10-P717)\Engineering\Phase 1\WTRCID PPW 2nd Petition.dwg